

THE CURRENTS

AT RIVERFRONT PLACE



FOR LEASE

The Currents is a new 270,000 square feet, 5 story mixed-use development located in the heart of Uptown Columbus and RiverFront Place. In addition to the street-level retail space, the development includes a 400+ adjacent parking deck and 226 luxury apartment units. The development also consists of the adjacent RiverFront Center, which is a 14-story professional office center that will consist of the new corporate headquarters for Synovus Financial and its 900+ local employees.

PROPERTY DETAILS



DAILY POPULATION

Located adjacent to the new Synovus Corporate Headquarters and its 900+ local employees, and steps away from Global Payments - Columbus Campus and its 2,000+ local employees



PARKING

On-site parking structure with over 1,150 spaces and 400+ spaces immediately adjacent to the retail spaces.



OUTSIDE AMENITIES

Located adjacent to Mat Swift Park, steps away from the RushSouth Whitewater Park and 22.6 mile DragonFly Trail.

For More Information:
706.365.0700



**COLDWELL BANKER
COMMERCIAL**

KENNON, PARKER,
DUNCAN & DAVIS

THE CURRENTS

AT RIVERFRONT PLACE



1	Columbus State University Uptown Columbus Campus	5	Global Payments - TSYS Campus 2,000+ Employees
2	Eagle & Phenix 180 Luxury Condos/Apartments	6	Truist Bank Columbus Center
3	Riverfront Place - Currents/Rapids 500+ Luxury Apartment Units	7	Highside Market Upscale Retail/Boutique Center
4	Synovus Corporate HQ 900+ On-Site Employees	8	Columbus City Hall City Services / Employees

For More Information:
706.365.0700



**COLDWELL BANKER
COMMERCIAL**
KENNON, PARKER,
DUNCAN & DAVIS

The Currents - Broadway Retail

Suite A - ±3,851 SF

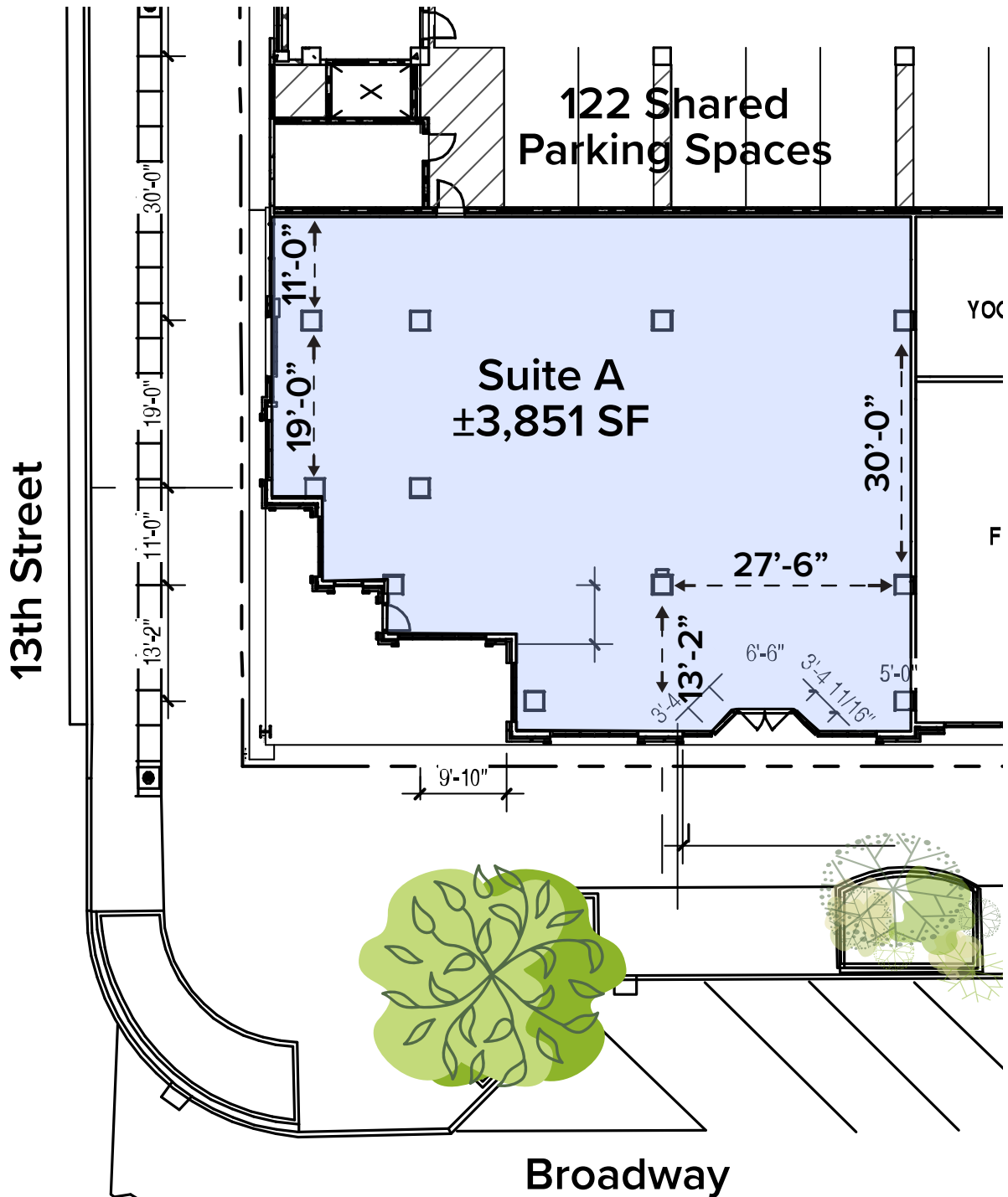

For More Information:
706.365.0070



**COLDWELL BANKER
COMMERCIAL**
KENNON, PARKER,
DUNCAN & DAVIS

Information above obtained from sources believed to be reliable. CBC-KPDD, its agents or affiliates make no guarantee, warranty or representation as to the accuracy of the information on this page. All plans, specifications, references, prices or representations are subject to change with (or without) notice from Seller or its representatives.

The Currents - Broadway Retail

Suite B - ±4,756 SF

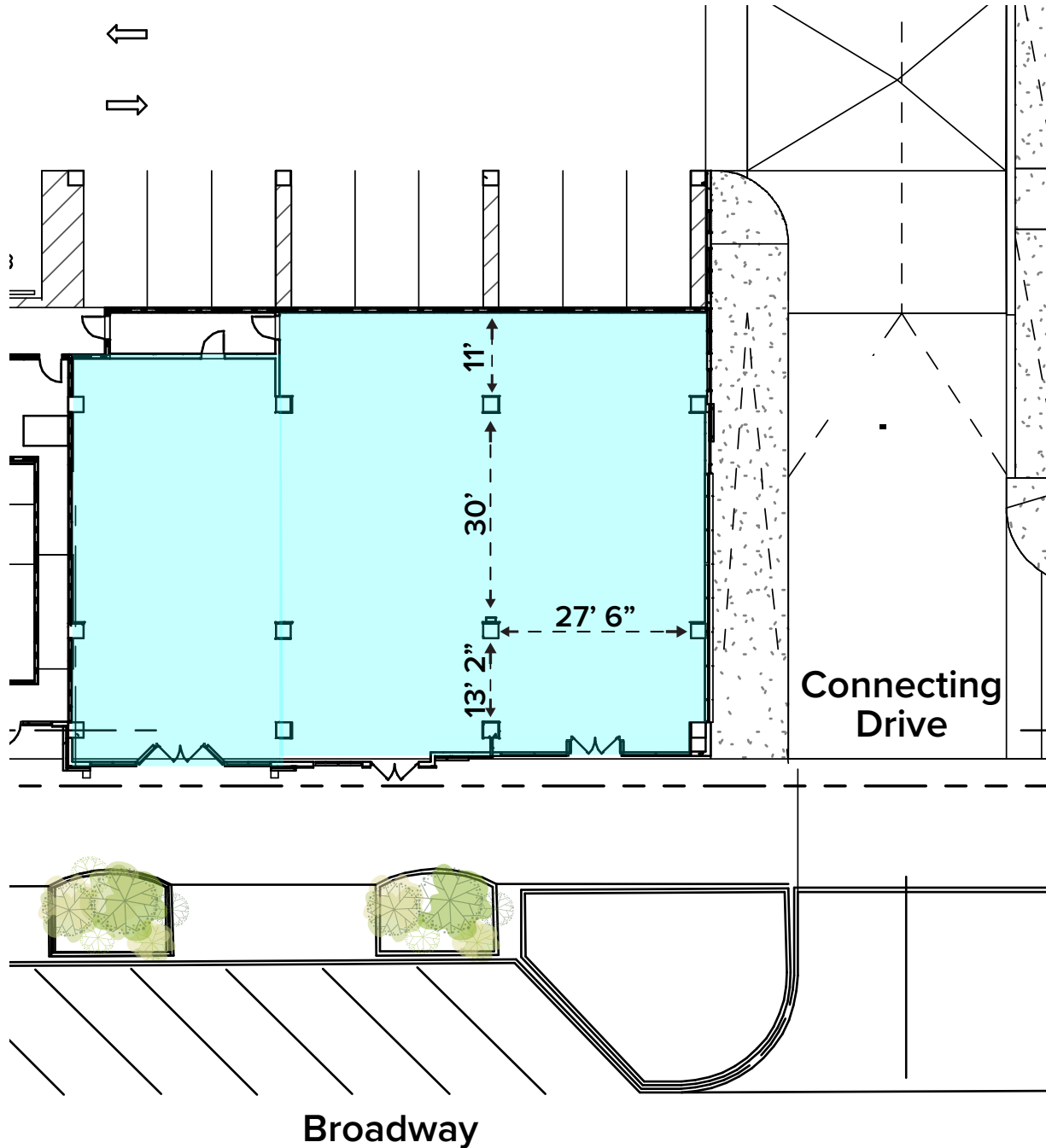

For More Information:
706.365.0070



**COLDWELL BANKER
COMMERCIAL**
KENNON, PARKER,
DUNCAN & DAVIS

Information above obtained from sources believed to be reliable. CBC-KPDD, its agents or affiliates make no guarantee, warranty or representation as to the accuracy of the information on this page. All plans, specifications, references, prices or representations are subject to change with (or without) notice from Seller or its representatives.