

281 BROADWAY

LOCATED DIRECTLY IN FRONT OF THE ENTRANCE TO THE MARCY AVENUE SUBWAY STATION





281 BROADWAY

Premises

Size: 3,286 SF
Frontage: 24 FT
Ceiling Height: 15-19 FT

Key Details

Possession: January, 2027

Space Highlights

- Prime South Williamsburg location, positioned between the Williamsburg Bridge and a short walk from key transit nodes
- Prominent frontage on Broadway, the neighborhood's most heavily trafficked retail corridor
- Steps from the Marcy Avenue subway station and the Williamsburg bus terminal
- Strong, consistent foot traffic driven by subway riders and multiple bus lines
- Dense and rapidly growing residential and office base

Key Neighbors

blink

Walgreens

**TACO
BELL**

 **CHIPOTLE**

Wendy's

**DUNKIN'
DONUTS**

FLOOR PLAN

GROUND FLOOR - +/- 3,286 SF

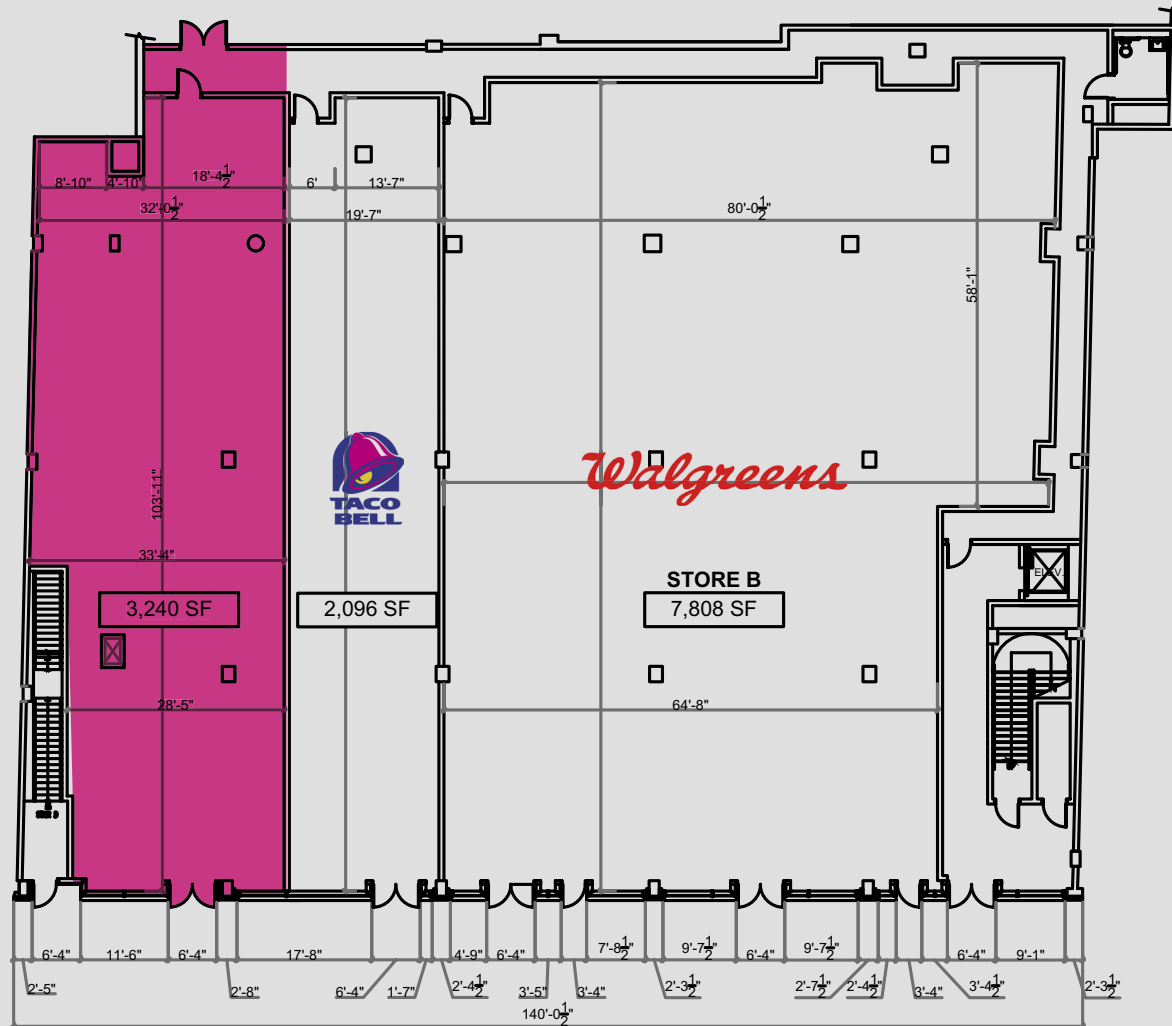

BROADWAY STREET

NEIGHBORHOOD MAP



CONTACT US

For questions or for more information about this property, please contact a member of the Capricorn Retail Advisors team.

Ryan Schimel
Senior Managing Director
rschimel@capricornre.com

Andrew Schulman
Principal
aschulman@capricornre.com

More from Capricorn Retail Advisors here
www.capricornre.com