

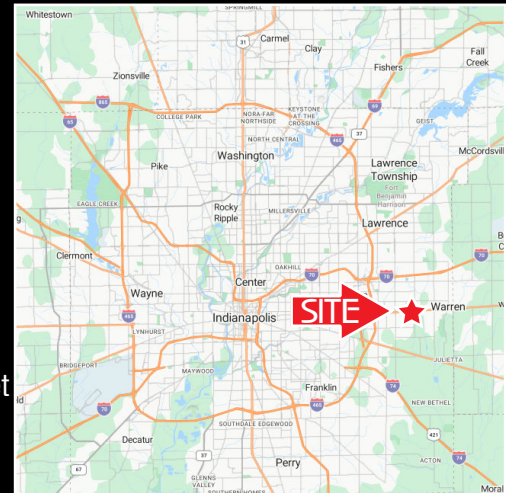

## PROPERTY FEATURES

- Rare Small Retail Building For Sale
- Approximately 5,400 S.F. Single Tenant | Owner Operator Retail
- Building Can Also Be Divided to 3 or 4 Tenants
- Redevelopment Can Provide Huge Upside For Investors
- Tremendous visibility to Highly Trafficked E Washington Street
- 32,701 ADT On E Washington Street
- Large Pylon Panel Available
- 60 Parking Spots Available With 4 Curb Cuts and Great Access
- Marion County C-4 Zoning Allows For Retail & Automotive Uses



### Traffic Counts:

E Washington St	32,701 ADT
Mitthoeffer Rd	9,588 ADT
Post Rd	12,509 ADT

**David Simons** [simons@velocitycre.com](mailto:simons@velocitycre.com)

8103 E US Hwy 36, Ste 278, Avon, IN 46123 | PH: 317.942.1141 | [www.velocitycre.com](http://www.velocitycre.com)

The information contained herein was obtained from sources we consider reliable. We cannot be responsible, however, for errors, omissions, prior sale, withdrawal from the market or change in price. Seller and broker make no representation as to the environmental condition of the property and recommend purchaser's independent investigation.





The information contained herein was obtained from sources we consider reliable. We cannot be responsible, however, for errors, omissions, prior sale, withdrawal from the market or change in price. Seller and broker make no representation as to the environmental condition of the property and recommend purchaser's independent investigation.





**David Simons** [simons@velocitycre.com](mailto:simons@velocitycre.com)

8103 E US Hwy 36, Ste 278, Avon, IN 46123 | PH: 317.942.1141 | [www.velocitycre.com](http://www.velocitycre.com)

The information contained herein was obtained from sources we consider reliable. We cannot be responsible, however, for errors, omissions, prior sale, withdrawal from the market or change in price. Seller and broker make no representation as to the environmental condition of the property and recommend purchaser's independent investigation.



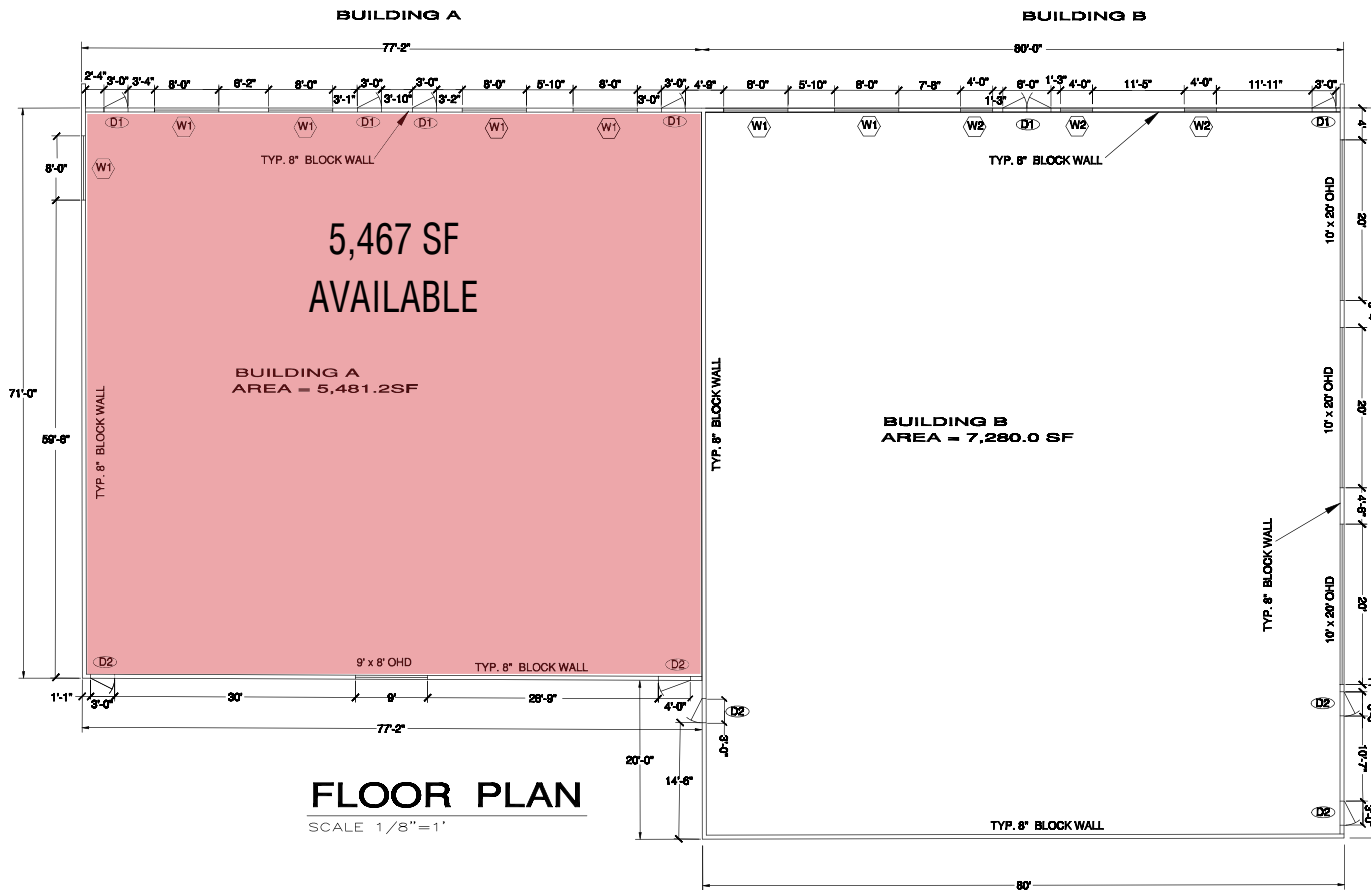

## DEMOGRAPHICS

### 1 MILE

- Population Estimated: 5,532
- Daytime Population: 4,458
- Estimated Households: 2,160
- Est. Avg. HH Income: \$110,457

### 3 MILE

- Population Estimated: 54,038
- Daytime Population: 34,517
- Estimated Households: 21,280
- Est. Avg. HH Income: \$97,049

### 5 MILE

- Population Estimated: 136,521
- Daytime Population: 86,550
- Estimated Households: 52,792
- Est. Avg. HH Income: \$85,564



**David Simons** [simons@velocitycre.com](mailto:simons@velocitycre.com)

8103 E US Hwy 36, Ste 278, Avon, IN 46123 | PH: 317.942.1141 | [www.velocitycre.com](http://www.velocitycre.com)

The information contained herein was obtained from sources we consider reliable. We cannot be responsible, however, for errors, omissions, prior sale, withdrawal from the market or change in price. Seller and broker make no representation as to the environmental condition of the property and recommend purchaser's independent investigation.