



Office

Coral Reef Plaza

For More Information

Sherry Halstead

+1 305 775 6953

shalstead@naimiami.com

OFFICE SPACES FOR LEASE

15315 South Dixie Highway | Palmetto Bay, FL 33157

Lease Rate: **\$35.00 SF, Full Service**

Total Traffic Count: **95,500 VPD**

To view this listing, visit: naimia-ftl.com/properties

NAI Miami
Fort Lauderdale

Coral Reef Plaza

15315 South Dixie Highway | Palmetto Bay, FL 33157

Property Features

- Immediately available; Move-in ready
- Rooftop parking - covered walkway connects directly to available offices spaces

Office Availability

Suite 201	1,365 SF	\$35.00 SF, Full Service	Available 12/1/2025
Suite 202	780 SF	\$35.00 SF, Full Service	Available Immediately
Suite 304	512 SF	\$35.00 SF, Full Service	Available 2/1/2026



Location Features

- South Dixie Highway (US 1) frontage
- Easy access to South Dixie Highway (US 1) and Florida's Turnpike
- New South Miami-Dade Busway right across the street

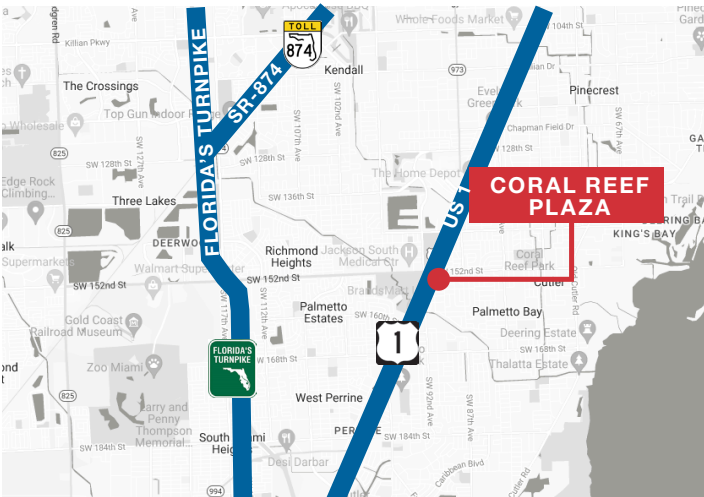

Traffic Count



Intersection of

South Dixie Highway (US 1)	60,500
SW 152nd Street	35,000
Total	95,500

Floor Plan

15315 South Dixie Highway | Palmetto Bay, FL 33157

Suite 202 - ± 780 SF

Note: Not to scale. For conceptual layout purposes only.

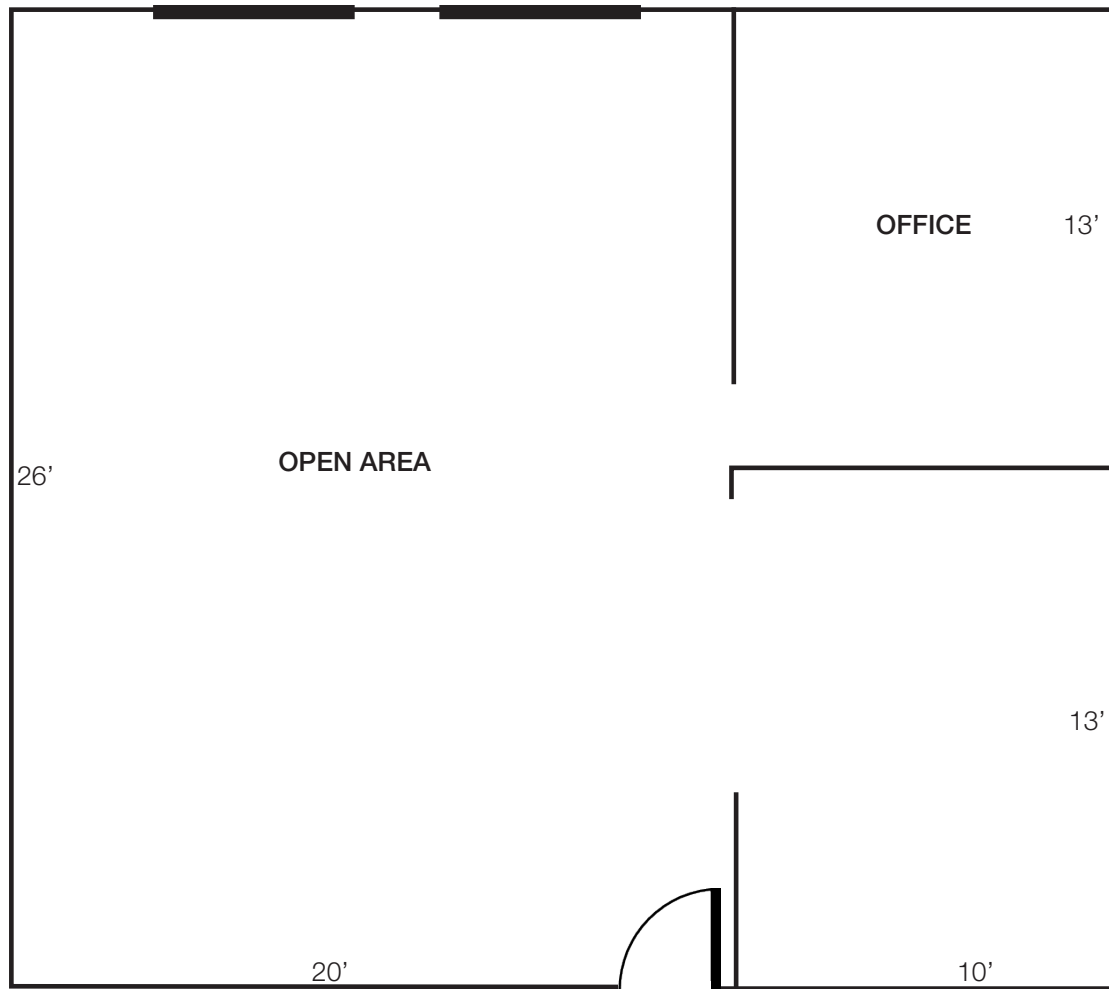

Aerial Map

15315 South Dixie Highway | Palmetto Bay, FL 33157



Demographic Summary



RADIUS

	1 Mile	3 Miles	5 Miles
Population	12,741	95,821	295,100
Households	4,819	31,929	105,229
Average Household Income	\$153,390	\$162,011	\$130,844
Employees	6,339	40,936	140,934

Walkability Score



83

Very Walkable

For More Information

Sherry Halstead

+1 305 775 6953

shalstead@naimiami.com



9655 South Dixie Highway, Suite 300, Miami, FL 33156

+1 305 938 4000

naimia-ftl.com

NO WARRANTY OR REPRESENTATION, EXPRESS OR IMPLIED, IS MADE AS TO THE ACCURACY OF THE INFORMATION CONTAINED HEREIN, AND THE SAME IS SUBMITTED SUBJECT TO ERRORS, OMISSIONS, CHANGE OF PRICE, RENTAL OR OTHER CONDITIONS, PRIOR SALE, LEASE OR FINANCING, OR WITHDRAWAL WITHOUT NOTICE, AND OF ANY SPECIAL LISTING CONDITIONS IMPOSED BY OUR PRINCIPALS NO WARRANTIES OR REPRESENTATIONS ARE MADE AS TO THE CONDITION OF THE PROPERTY OR ANY HAZARDS CONTAINED THEREIN ARE ANY TO BE IMPLIED.