



NEWLY CONSTRUCTED WAREHOUSE | FOR LEASE

16300 W HWY 66, YUKON, OK

KRIS DAVIS, SIOR
kgdavis@newmarkrp.com
C: 405.202.9525

BRETT PRICE, CCIM, SIOR
bprice@newmarkrp.com
C: 405.613.8380

KARLEY HARPER, CCIM
kharper@newmarkrp.com
C: 405.371.3498

NEWMARK
ROBINSON PARK

16300 W HWY 66 / FOR LEASE

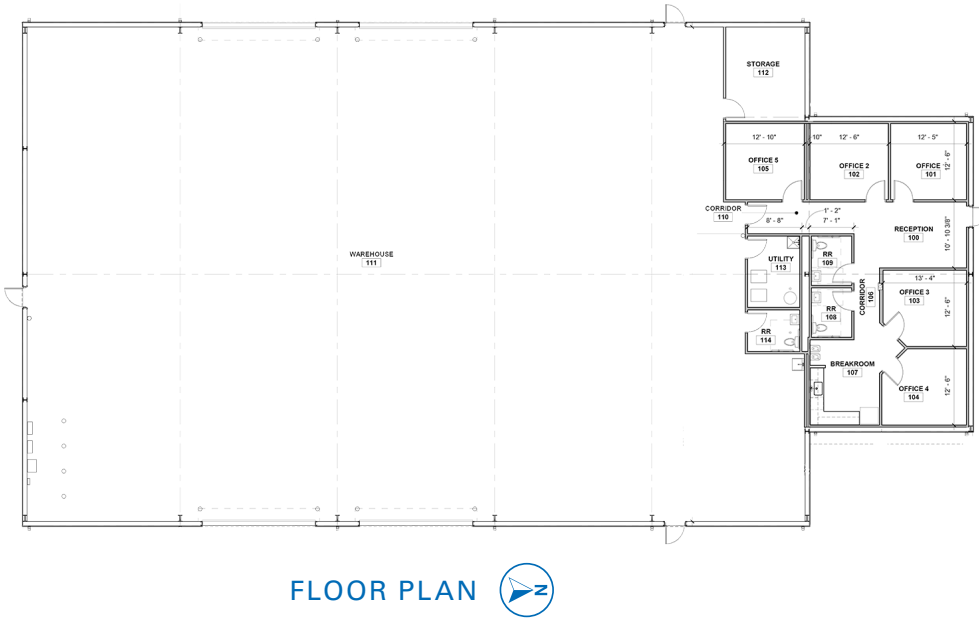

DETAILS

Available SF	10,817 SF
Lease Rate	\$16,500/MO (NNN)
Building Size	10,817 SF
Lot Size	5.51 expandable to 11.58 Acres±
Submarket	Yukon / Canadian County
Cross Streets	Hwy 66 & Gregory Rd.

HIGHLIGHTS

9,135 SF warehouse/storage
1,682 SF office
(4) 18' x 18' overhead doors
28' clear height
(1) 10-ton crane
Fenced & graveled yard

PROPERTY OVERVIEW

New industrial building under construction located in a well-established and expanding industrial corridor servicing Canadian and Kingfisher counties. The property is less than 1 mile to I-40, with easy access to STACK & SCOOP oil plays.

Available 12/1/2025.