

BARRISTER

EXECUTIVE SUITES, INC.

CENTURY PARK PLAZA

1801 Century Park East, 24th & 25th Floors

Los Angeles, CA 90067

(310) 552-0700/http://www.barrister-suites.com

800-576-0744

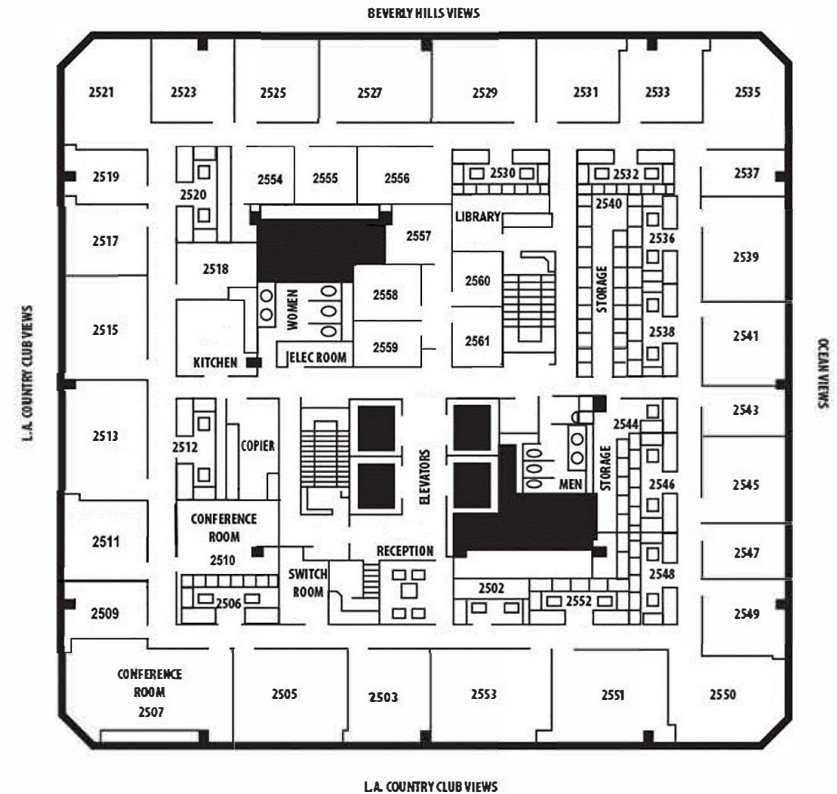
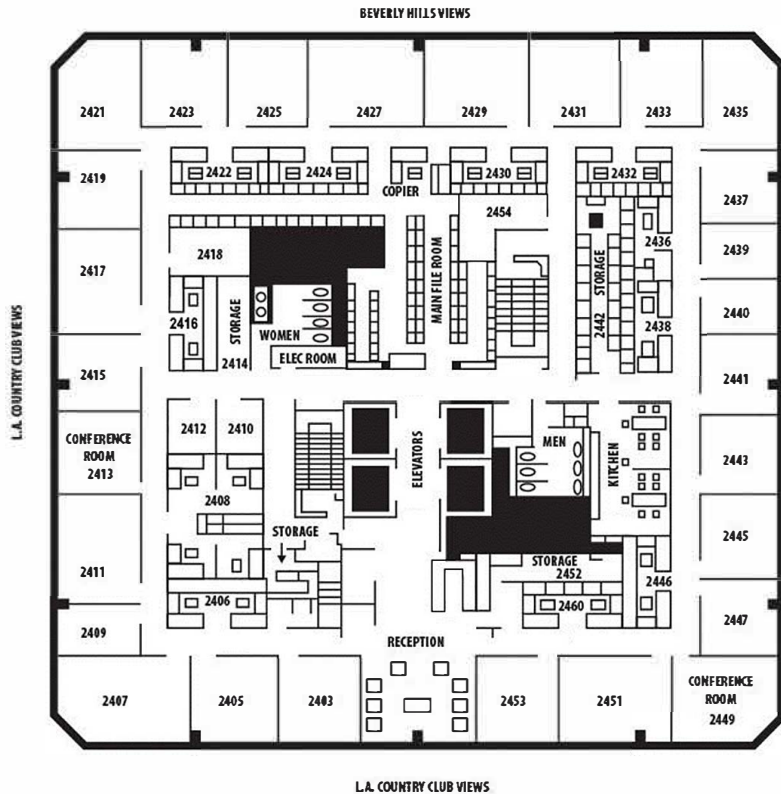
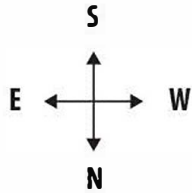

Suite Managers: Jacqueline Jansen
Hours of Operation: 8:30am to 5:00pm

DIRECTIONS: 405 Fwy to Santa Monica Blvd.
Corner of Little Santa Monica and Century Park East

PARKING: \$315 - \$345 Unreserved
\$415 - \$450 Reserved

AMENITIES: Views, High-Speed Internet Access,
Voice Mail, Facsimile, Photocopiers, Postage, Four (4)
Conference Rooms, Law Library, Rental Furniture

POINTS OF INTEREST: Four Star Hotels, Food Court,
Theaters, Century City Shopping, Fine Dining