



Tamana Fields

For Sale | TBD University Blvd.
& Yellowstone Highway | Rexburg, ID

Don Zebe
+1 208 403 1973
don.zebe@colliers.com

Mike Zebe
+1 208 705 6453
mike.zebe@colliers.com

Jared Zebe
+1 208 709 7311
jared.zebe@colliers.com



Parcel A
2.06 Acres

National QSR
Under Contract

Parcel 2
1.2 Acres ±

Parcel 4
17.03 Acres ±

National Grocer
Under Contract

Parcel 3
5.17 Acres ±

Mikan Dr

Wendy's

Goldenwest
CREDIT UNION

SPRINGHILL
SUITES
BY MARRIOTT

Hampshire
Home & Suites

Zupas

Jack-in-the-Box

Wingstop

Domino's

Olive Garden

ZUPAS

McDonald's

Property Overview

Property Type	Retail/Commercial pads
Land Size	59 Acres
Price	Contact agent
Parcel	RPRXBCA0367207

Demos

	1 Mile	3 Miles	5 Miles
Population*			
2024 Estimated	12,176	42,934	49,691
2029 Projected	12,288	43,931	51,455
Households			
2024 Estimated	3,784	10,368	12,219
2029 Projected	4,005	11,198	13,344
Income			
2024 Average HH	\$45,628	\$71,214	\$75,578
2024 Median HH	\$35,189	\$48,763	\$53,568

* *BYU-Idaho's combined on-campus and married student population exceeds 30,000 each year.*



Site Plan

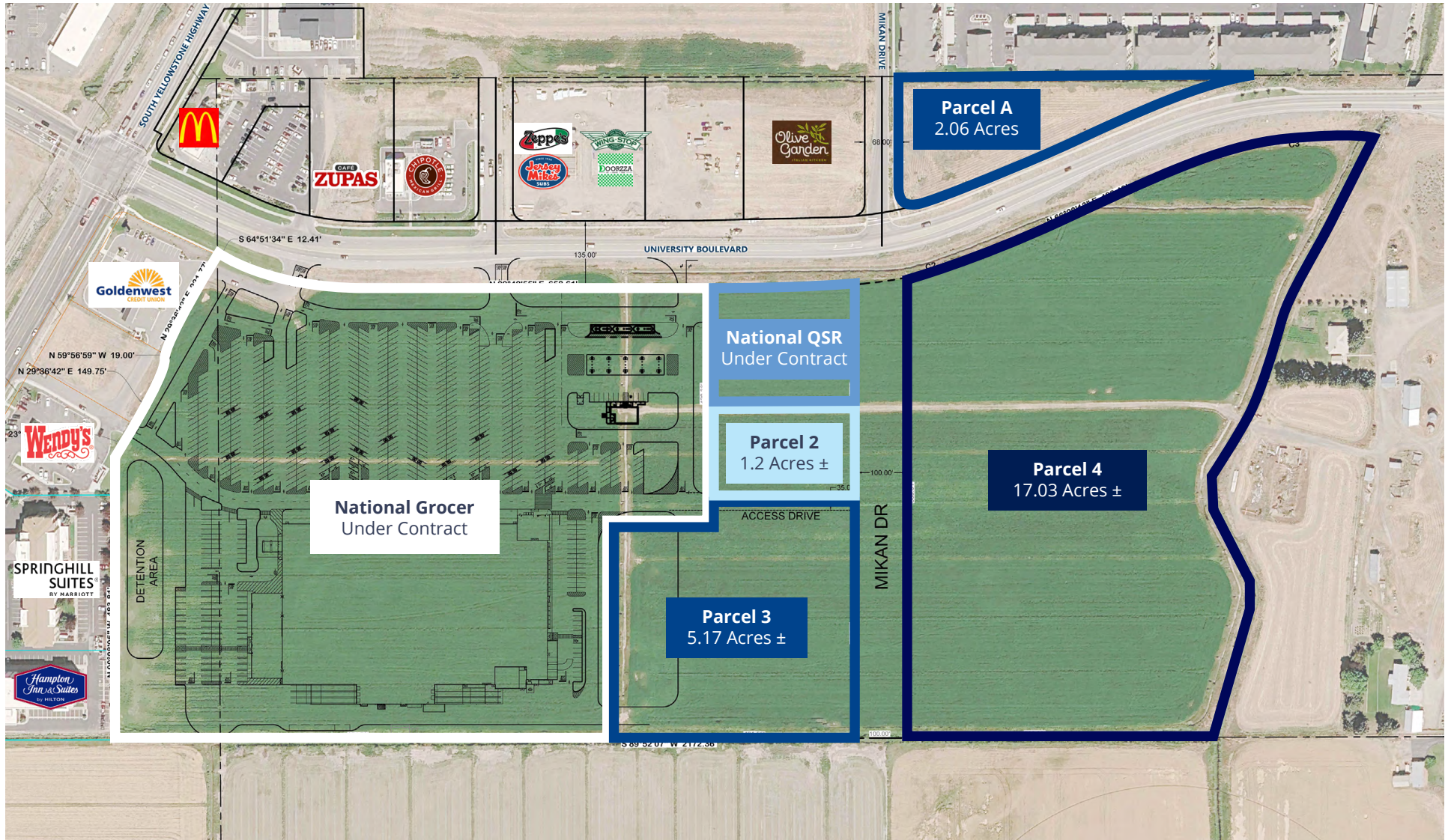

Local Overview | Rexburg, ID

Rexburg, Idaho Trade Area

The City of Rexburg is the commercial center for the 140,000 residents from Salmon, ID to Jackson Hole, WY.

Welcome! to Rexburg, Idaho, America's Family Community. You are about to discover what we already know: Rexburg is a great place to work, live, and raise a family. As of the 2020 Census, Rexburg has a population of over 39,000, making Rexburg the 4th Fastest Growing Small City in the nation. Rexburg is among the youngest city in America; home to Brigham Young University-Idaho, Idaho's largest university; its public school system ranks among the best in the state; in 2023 Rexburg was named the 10th Safest City in America, and the Safest City in Idaho.

From low property taxes (Rexburg has some of the lowest property tax rates in Eastern Idaho) to a highly educated workforce, low cost of living, and amazing surroundings, Rexburg is an ideal city to build, grow, or expand a business.

Resources:
www.rexburg.org/

Rexburg's Trade Area encompasses a region that includes the cities of Rigby in the south, to West Yellowstone, MT in the north to Jackson Hole, Wyoming in the east, and Salmon and Challis to the west. Together this region encompasses 19 incorporated cities and a population of over 140,000.



2024
population

39,975



2024 Average Household
Income

\$71,244

BYU-Idaho is the largest undergraduate university in Idaho, with more than 36,000 students attending on campus annually across three semesters.

#3

Best State to Move to
in the U.S. - Idaho

JUL 2024 ConsumerAffairs

Colliers



"Whether you have been here all your life, are here for a short visit, or considering making Rexburg your new home, Welcome."

- Mayor Jerry Merrill

Major Employers



Notable Locations Near Rexburg

Grand Teton National Park
Jackson Hole Wyoming
Yellowstone National Park

Local Overview | Rexburg, ID

High-Traffic, High-Growth Market

Rexburg, Idaho is among the fastest-growing small cities in the U.S.

- Located in Rexburg, Idaho—population 39,400+ and consistently one of the **fastest-growing small cities in the U.S.**
[crexi.com](https://www.crexi.com)+8en.wikipedia.org+7rexburg.org+7en.wikipedia.org+7datausa.io
- **Median age ~22** driven by 40,000 annual BYU-Idaho enrollment
[businessviewmagazine.com](https://www.businessviewmagazine.com)+1en.wikipedia.org+1
- **Retail, food & accommodation** rank among the top employment sectors
[rexburg.org](https://www.rexburg.org)
- Proximity to major residential corridors, commuter routes, and University Towne Center



Property Aerial



2043 E Center Street
 Pocatello, Idaho 83201
 +1 208 951 2100
 colliers.com/idaho

This document has been prepared by Colliers for advertising and general information only. Colliers makes no guarantees, representations or warranties of any kind, expressed or implied, regarding the information including, but not limited to, warranties of content, accuracy and reliability. Any interested party should undertake their own inquiries as to the accuracy of the information. Colliers excludes unequivocally all inferred or implied terms, conditions and warranties arising out of this document and excludes all liability for loss and damages arising there from. This publication is the copyrighted property of Colliers and/or its licensor(s). © 2025. All rights reserved. This communication is not intended to cause or induce breach of an existing listing agreement. Colliers Portneuf Valley, LLC.