

Up to ±9.80 Acres - Retail/Commercial Site

Kanner Hwy, Stuart, FL

NAI Southcoast



±2.50 to 9.80 ACRES
AVAILABLE - CAN BE
SUBDIVIDED AS NEEDED

**±2.50 ACRE
CORNER**

Road Scheduled for
Completion June 2024



Presented by
Nikolaus M. Schroth, CCIM
Principal | Broker Associate
+1 772 286 6292
nikschroth@naisouthcoast.com
www.naisouthcoast.com

J. Jeffery Allman, Jr.
Sales Associate
+1 772 286-6292 c +1 772 283 1555
jeff@naisouthcoast.com
www.naisouthcoast.com

James McKinney
Sales Associate
+1 772 349 3414
jamesmckinney@naisouthcoast.com
www.naisouthcoast.com

FOR SALE: \$5,975,000

2.5 ACRE CORNER - \$2,750,000
7.3 ACRES - \$4,250,000

Up to ±9.80 Acres - Retail/Commercial Site

Kanner Hwy, Stuart, FL

Property Details

- Address: Kanner Hwy, Stuart, FL
- Offering: 9.80 Acres - \$5,975,000
7.30 Acres - \$4,250,000
2.50 Acres - \$2,750,000
- Zoning: PUD
- Land Use: Retail/Commercial
- Retention: Off Site Retention (net site)
- Jurisdiction: Martin County
- Utilities: Martin County
- Parcel ID(s): 13-39-40-010-000-00020-0

Property Overview

Nestled within the fully approved South Florida Gateway Planned Unit Development (PUD), this 9.80-acre development site on the west side of Kanner Highway offers an ideal location for diverse uses. Zoned for up to 114,000 SF of retail space, or industrial development, life science, technology and research (LSTAR), targeted industries business (TIB), the property is a prime investment opportunity. Its strategic positioning within the South Florida Gateway PUD provides a comprehensive zoning framework, catering to a variety of business interests.

Kolter Land is advancing the approval process for Waterside PUD, a major new residential upscale development of approximately 1,000 residential units. Simultaneously, DiVosta is navigating approvals for Storie, an expansive 2,700-acre development set to include around 4,000 residential units to the East. Beyond the residential projects, the area boasts three major golf club developments - Florida Club, Rollings Sands and Apogee, offering recreational amenities for residents and potential employees. Additionally, the proximity to major industrial developments from Foundry Commercial and Karis Cold further solidifies this site as a strategic and desirable location.



Nearby Projects

- **Storie:** 2,727 Acres /4,000 residential units
- **Highpointe by Pulte Homes:** 63 Residential Units (Phase I)
- **Publix**
- **The Ranch:** 3,902 Acres/175 proposed residential units
- **The Rolling Sands:** 240 Acres/ golf course
- **The Apogee Club (formerly Three Lakes Golf Club):** 1,218 Acres/ 3 golf courses
- **Winemiller Farms:** 1,909 Acres/702 proposed residential units
- **Waterside:** 375 Acres/1,000 proposed residential units
- **Lone Oak Bridge Road LLC:** 2,962 Acres/2 golf courses
- **Atlantic Fields:** 1,530 Acres /golf course/317 home sites
- **Grove XXIII:** 225 Acres/golf course
- **The Backyard:** 519 Acres/golf course

Up to ±9.80 Acres - Retail/Commercial Site

Kanner Hwy, Stuart, FL

Proposed Waterside PUD 1,000 Units

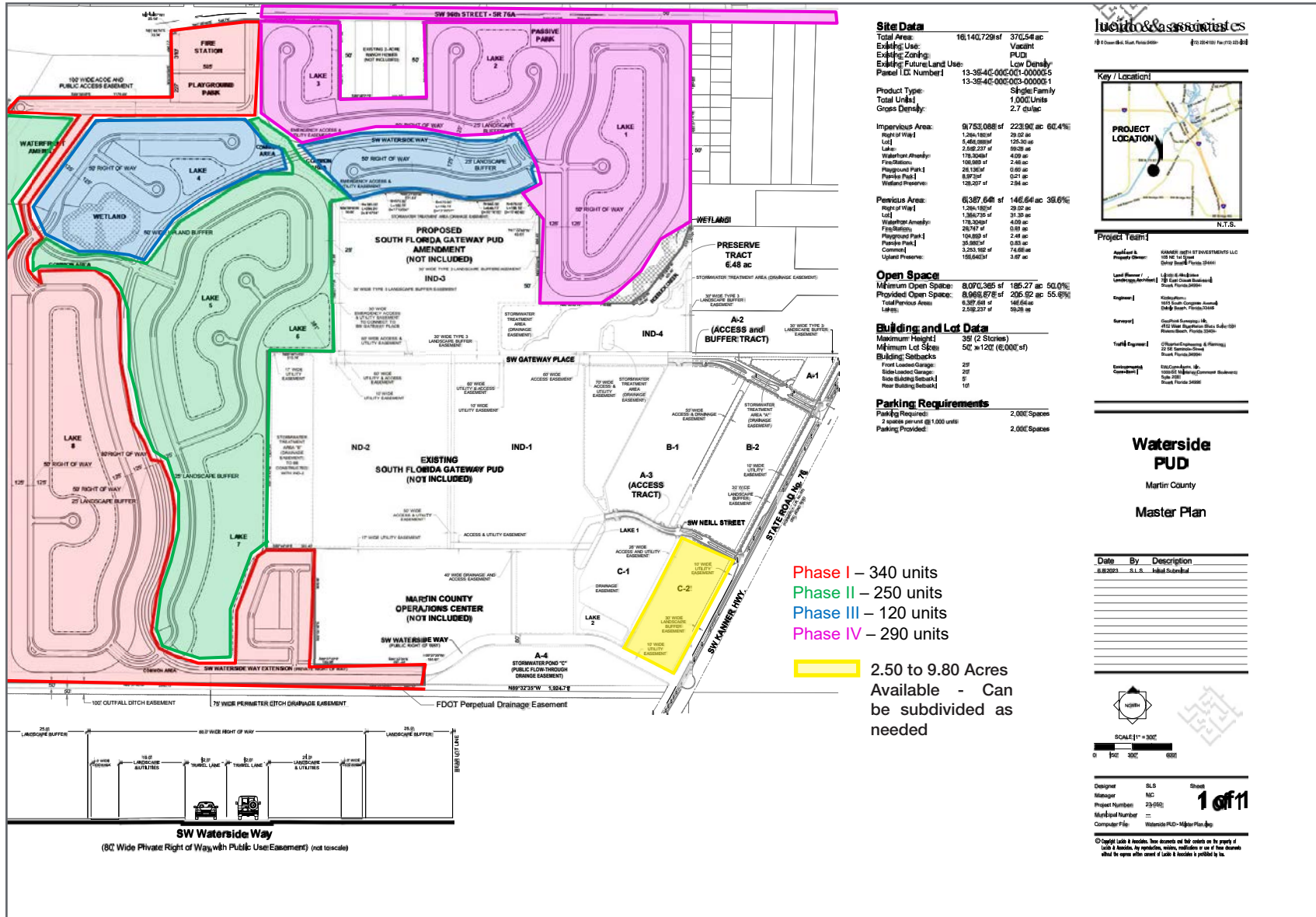

North & Associates
1000 E. 1st Street, Suite 100, Stuart, FL 34954
Tel: (888) 888-8888 Fax: (888) 888-8888



Project Team

Applicant / Property Owner:	KANNER NORTH INVESTMENTS LLC 1310 NE 141 Street Orlando, Florida 32816
Lead Planner / Landmark Architect:	1810 E. 1st Street Stuart, Florida 34954
Engineer:	Kellerstrom 3015 Lake Cypress Avenue Orlando, Florida 32816
Surveyor:	Coastal Surveying, Inc. 410 West Broadway, Suite 100 Stuart, Florida 34954
Trail Engineer:	City of Stuart Planning & Planning 22 1/2 Central Street Stuart, Florida 34954
Environment Consultant:	ERC Consultants, Inc. 10025 E. Highway 17 Stuart, Florida 34954

Waterside PUD

Martin County

Master Plan

Date	By	Description
5.8.2023	S.L.S.	Initial Submittal

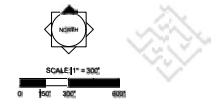

Designer: S.L.S. Sheet
 Manager: MC
 Project Number: 23-198
 Master Plan Number: 1
 Computer File: Waterside PUD - Master Plan.dwg

© Digital Lake & Associates, Inc. No portion of this document may be reproduced or transmitted in any form or by any means, electronic, mechanical, photocopying, recording, or by any information storage and retrieval system, without the prior written permission of Digital Lake & Associates, Inc.

Up to ±9.80 Acres - Retail/Commercial Site

Kanner Hwy, Stuart, FL

Conceptual Site Plan









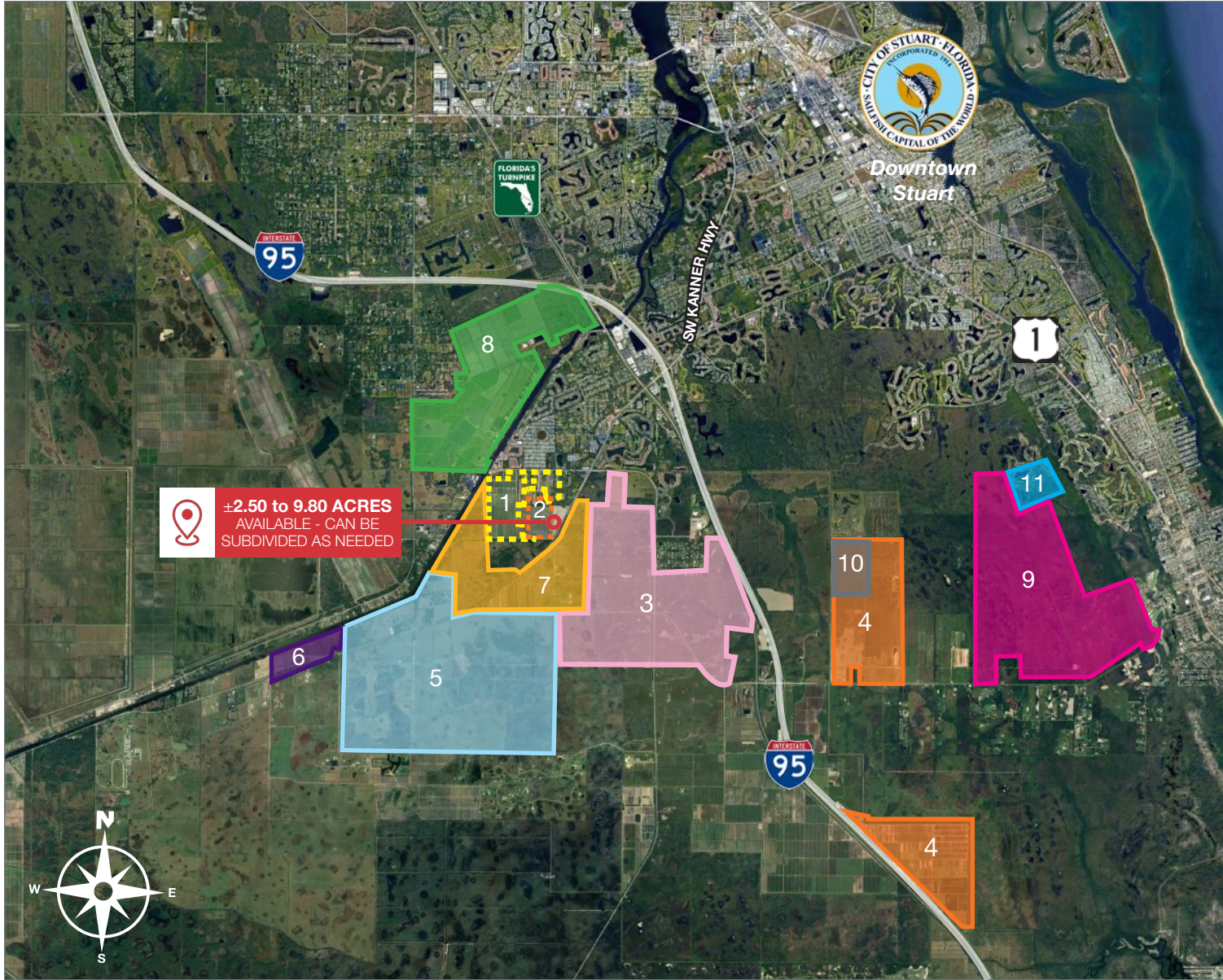





Up to ±9.80 Acres - Retail/Commercial Site

Kanner Hwy, Stuart, FL

Area Development Map



KEY

- 
2.50 TO 9.80 ACRES AVAILABLE
 Can be subdivided as needed
- 
1 **Waterside by Kolter**
 375 Acres/ 1,000 Proposed Residential Units
kolter.com/portfolio/waterside
- 
2 **South Florida Gateway, LLC**
 66 Acres
gatewaydistributioncenter.com
- 
3 **Storie**
 2,727 Acres/4,000 Residential Units
storiefl.com
- 
4 **Atlantic Fields**
 1,530 Acres/Golf Course
 317 Home Sites
- 
5 **The Ranch**
 3,902 Acres/2 Golf Courses
 175 Residential Units
- 
6 **The Rolling Sands**
 240 Acres/Golf Course
- 
7 **The Apogee Club (formerly Three Lakes Golf Club)**
 1,218 Acres
apogeeclub.com
- 
8 **Winemiller Farms**
 1,909 Acres/702 Proposed Residential Units/2 Golf Courses
- 
9 **Lone Oak Bridge Road LLC**
 2,962 Acres/2 Golf Courses
- 
10 **Grove XXIII by Michael Jordan**
 225 Acres/Golf Course
grovexxiii.com
- 
11 **The Backyard**
 518 Acres/Golf Course

Up to ±9.80 Acres - Retail/Commercial Site

Kanner Hwy, Stuart, FL



Up to ±9.80 Acres - Retail/Commercial Site

Kanner Hwy, Stuart, FL

Aerial Views



Up to ±9.80 Acres - Retail/Commercial Site

Kanner Hwy, Stuart, FL

Aerial Views



Up to ±9.80 Acres - Retail/Commercial Site

Kanner Hwy, Stuart, FL

Aerial Views



Up to ±9.80 Acres - Retail/Commercial Site

Kanner Hwy, Stuart, FL

Aerial Views



Up to ±9.80 Acres - Retail/Commercial Site

Kanner Hwy, Stuart, FL

Drive Time

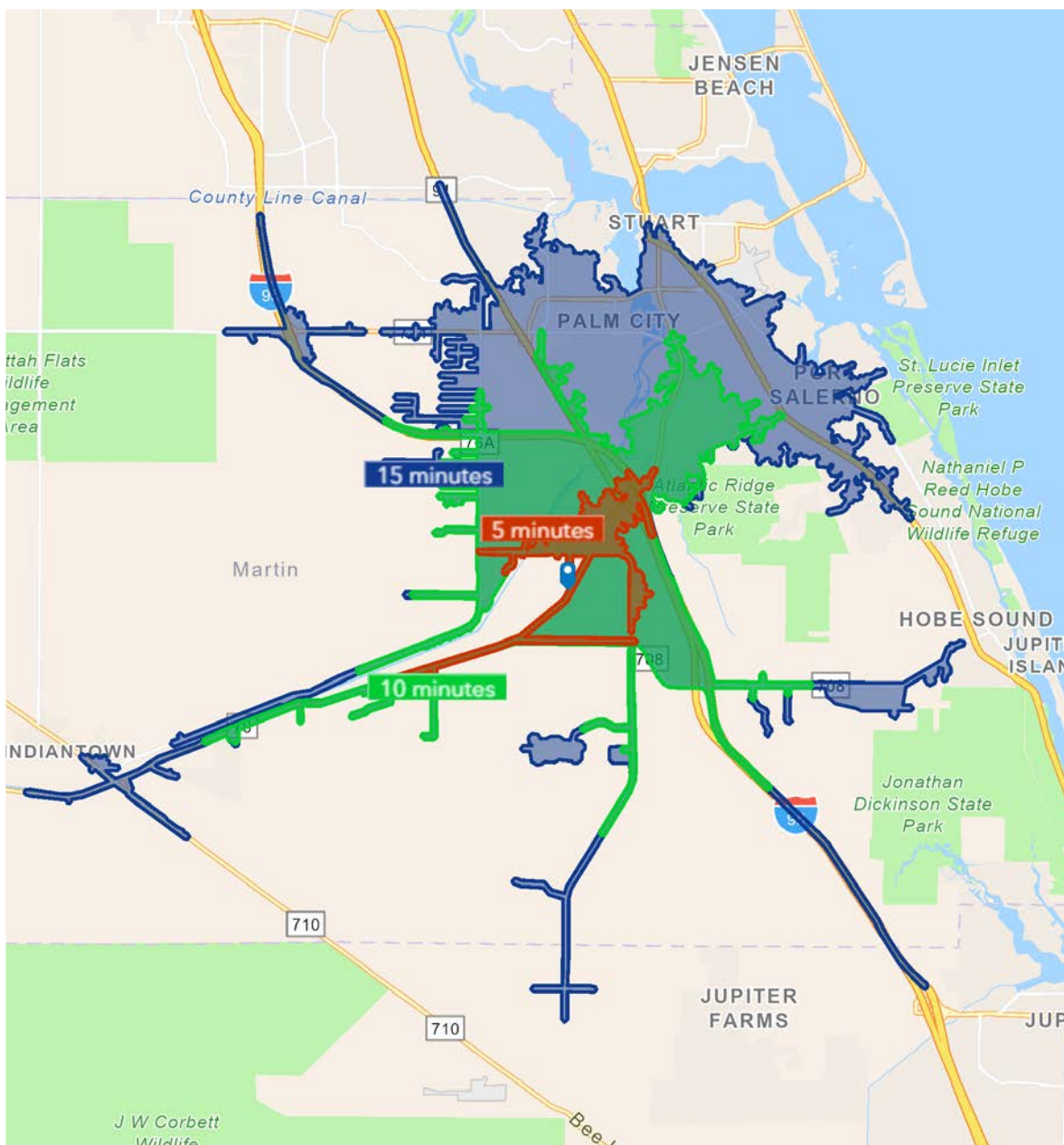

5 Minutes	10 Minutes	15 Minutes
3,618 2010 Population	15,016 2010 Population	64,049 2010 Population
4,311 2023 Population	17,016 2023 Population	71,866 2023 Population
17.48% 2010-2023 Population Growth	12.48% 2010-2023 Population Growth	11.50% 2010-2023 Population Growth
(.10)% 2023-2028(Annual) Est. Population Growth	(.08)% 2023-2028(Annual) Est. Population Growth	.17% 2023-2028(Annual) Est. Population Growth
52.4 2023 Median Age	51.4 2023 Median Age	51.2 2023 Median Age
\$132,379 Average Household Income	\$131,212 Average Household Income	\$117,648 Average Household Income
52.7% Percentage with Associates Degree or Better	46.0% Percentage with Associates Degree or Better	46.1% Percentage with Associates Degree or Better
71.2% Percentage in White Collar Profession	64.6% Percentage in White Collar Profession	61.2% Percentage in White Collar Profession

Up to ±9.80 Acres - Retail/Commercial Site

Kanner Hwy, Stuart, FL

Area Maps

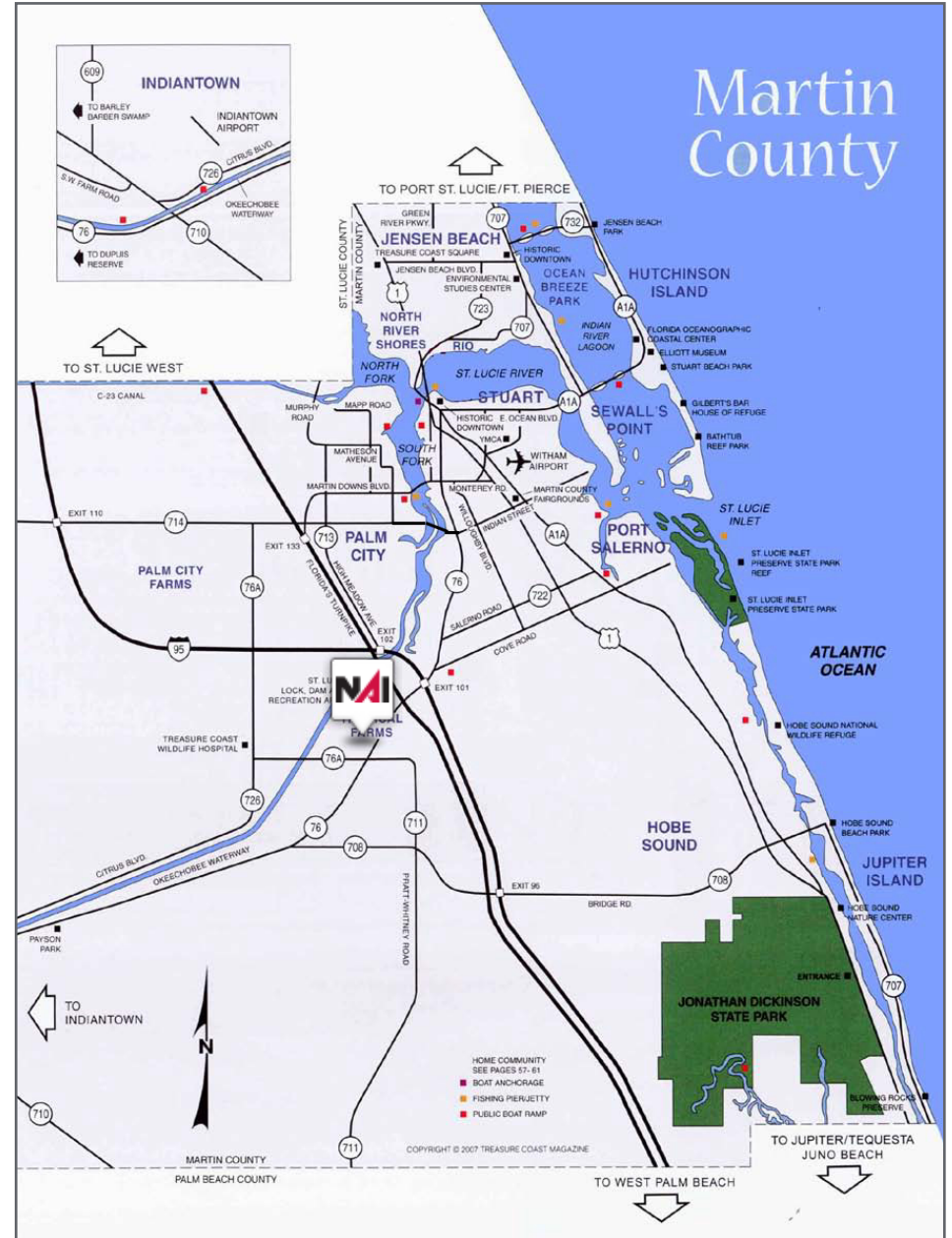
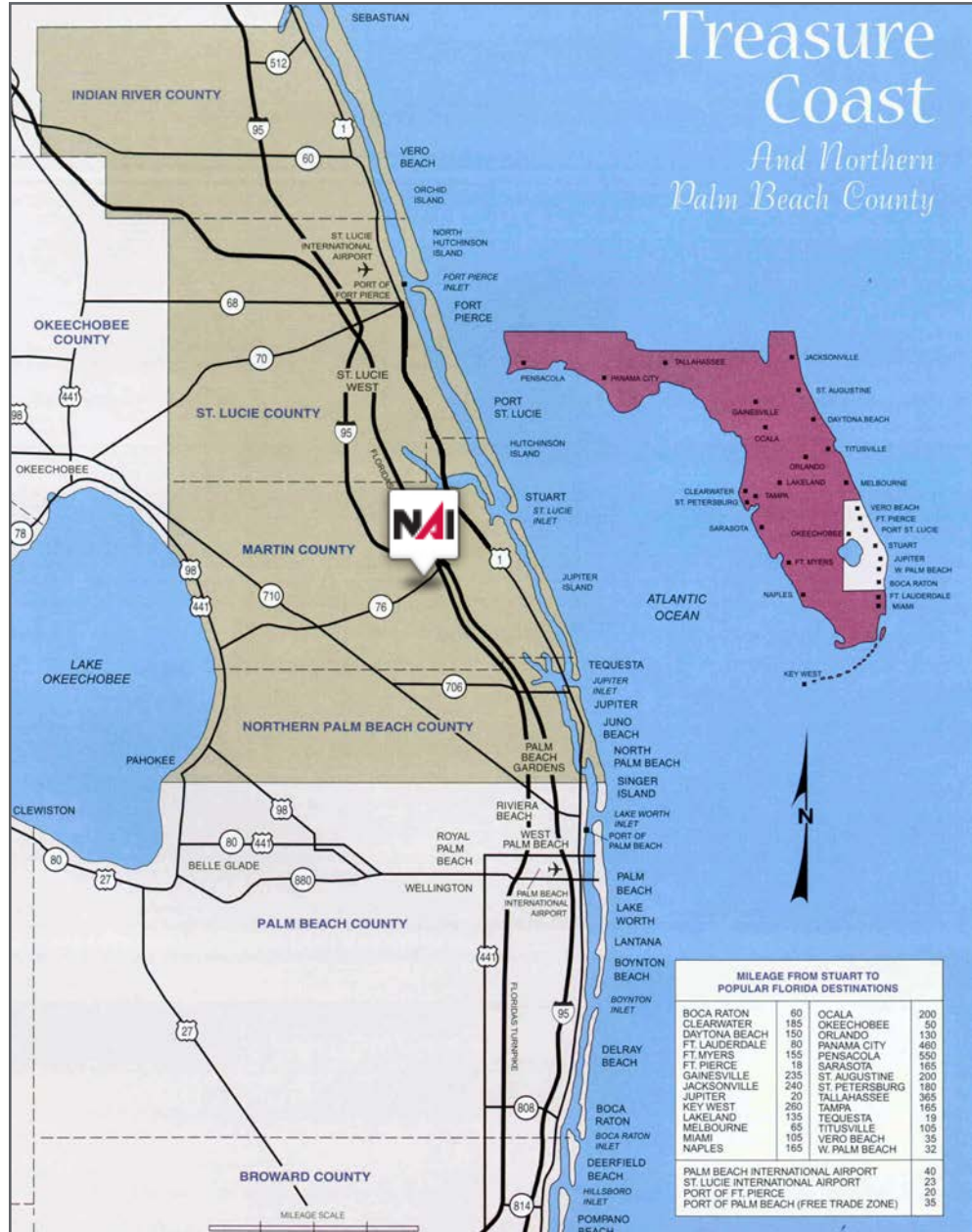

Up to ±9.80 Acres - Retail/Commercial Site

Kanner Hwy, Stuart, FL

The cities that make up Martin County are Jensen Beach/Rio, Stuart/Sewall's Point, Hutchinson Island, Hobe Sound, Jupiter/ Tequesta, Palm City, Port Salerno and Indiantown. Martin County is a wonderful place to visit and live, with beaches, golf, fishing and boating. The County boasts arts amenities, quaint downtowns with shops, gourmet dining and galleries, museums, historic places, festivals and more.

Martin County is for...

The golf enthusiast... Martin County is home to over 35 world-class golf courses all within a 15-mile radius. The sun worshiper... The County offers its visitors and residents alike some of the finest beaches on the east coast. The discriminating arts shopper... More than 20 galleries participate in a monthly First Thursday gallery night. Many of these galleries are in the historic downtowns of Stuart, Jensen Beach, Port Salerno and Hobe Sound. The music lover... The historic Lyric Theatre offers a wide-array of fist class talent nearly 300 days a year... This acoustically amazing theatre features concerts for all music lovers, from classical to rock and roll, and theatrical performances by local and national talent.

Mark your calendars for a plethora of events to look forward to in Martin County, Florida. The Stuart Air Show, Stuart Boat Show, ArtsFest, and the Martin County Fair are some of the many events taking place throughout the year. The Treasure Coast Children's Museum is a great place for the kids located at Indian Riverside Park which has a fabulous water play area, fishing, and a riverfront view. Often, there are events in the park including concerts, orchid shows, and more. Indian Riverside Park also features the Maritime and Yachting Museum. Hutchinson Island houses the Elliott Museum which focuses on art, history and technology. Named after prolific inventor Sterling Elliott, the museum houses permanent exhibits including Model A Trucks, early transportation, history of Stuart and surrounding regions and baseball memorabilia. For the more scientifically minded and curious kids, the Florida Oceanographic Coastal Center which offers a fun opportunity to learn more about our local ecosystem and even feed a stingray!





Nikolaus M. Schroth, CCIM
Principal | Broker Associate
+1 772 286 6292
nikschroth@naisouthcoast.com



J. Jeffery Allman, Jr.
Sales Associate
+1 772 286-6292 c +1 772 283 1555
jeff@naisouthcoast.com



James McKinney
Sales Associate
+1 772 349 3414
jamesmckinney@naisouthcoast.com

Up to ±9.80 Acres - Retail/Commercial Site Kanner Hwy, Stuart, FL



FOR SALE: \$5,975,000

2.5 ACRE CORNER - \$2,750,000

7.3 ACRES - \$4,250,000