



City Ridge

PRODUCTS

OFFICES | ACCESS | VIRTUAL

14 Ridge Square
Washington, D.C. 2016

City Ridge reinvents the urban residential experience and cultivates a vibrant community through shared amenities, cultural programming, and curated retail and dining. Sitting adjacent to Glover Archbold Park, this brand new development with housing, offices, retailers, and restaurants is reimaging city life. Our thoughtfully-designed workspace has a warm and welcoming interior and is complete with best-in-class services and amenities to support your most productive workday, every day.

40K

Rentable Sqft

13

Conference Rooms

130

Offices



INCLUDED SERVICES

- Dedicated On-Site Staff
- Daily Breakfast & Snacks
- Craft Coffee & Tea
- Mail & Packaging
- Community Events
- Weekly Happy Hours
- Wellness Room
- Unlimited Color Printing
- Fast, Secure Wi-Fi
- Office Supplies
- Professional-Grade Cleaning
- 24/7 Access

BUILDING DETAILS

- Walkable Dining
- Shopping Options
- Wegman's Grocery Store
- Equinox Gym

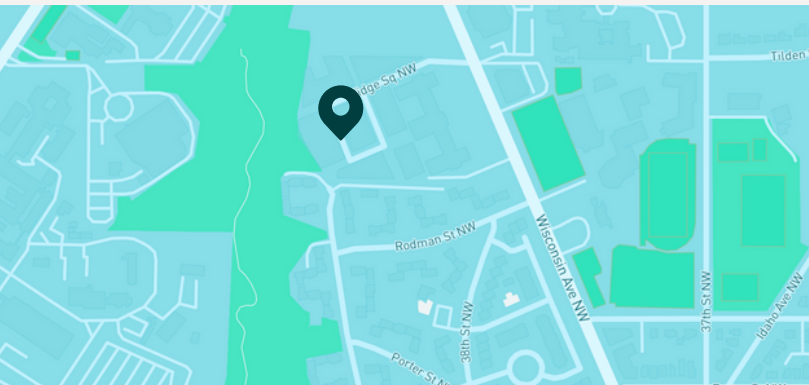

TRANSIT

- Bus at Wisconsin Ave & Upton St X 1 block
- Capital Bikeshare station at 39th & Veazy St NW 3 blocks
- Parking On-Site

LEGEND

- Access Office
- Small Office (1-2)
- Medium Office (3-4)
- Large Office (5-8)
- XLarge Office (9+)
- Executive Office

MEETING SPACES

Phone Booths	22
Conference Rooms	14

3RD FLOOR

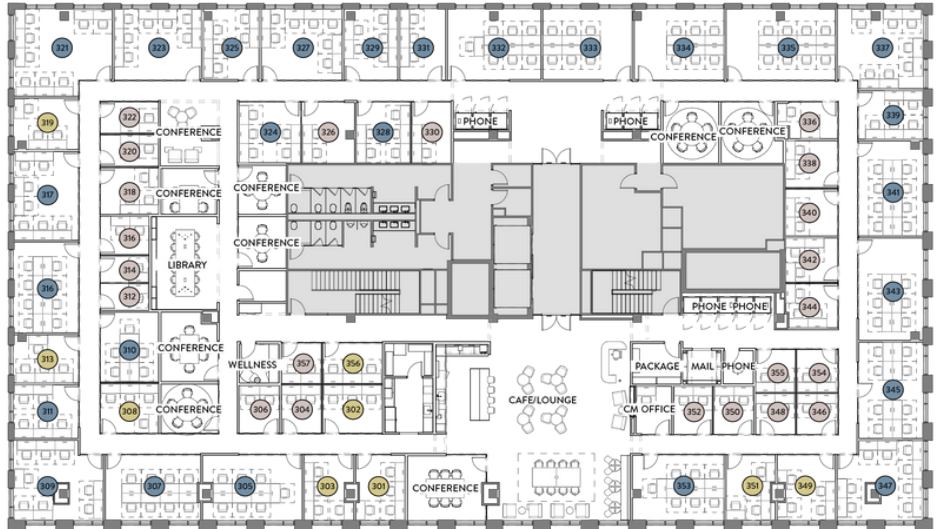

4TH FLOOR

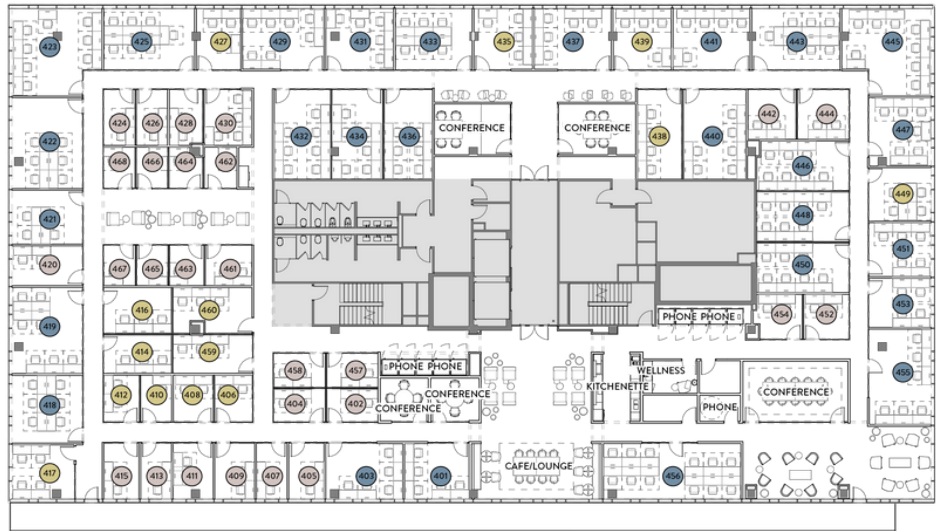

Cafe (example only)



Private office (example only)



Conference room (example only)