



**± 16,845 SF**  
**FOR SALE**  
**OR LEASE**



**1610 NE 4TH STREET**  
OKLAHOMA CITY, OK 73117

## PROPERTY FEATURES

BUILDING SIZE:	± 16,845 SF
WAREHOUSE:	± 13,548 SF
OFFICE:	± 3,297
SITE AREA:	± 1.33 Acres   Paved & Fenced
CLEAR HEIGHT:	10' - 16'
DRIVE-INS:	(2) 14' x 10'
STORAGE SHED:	± 400 SF
POWER:	Heavy
LEASE RATE:	<b>\$6.25 NNN</b>
SALES PRICE:	<b>\$1,750,000</b>



**COMMERCIAL  
OKLAHOMA**

# INDUSTRIAL WAREHOUSE

1610 NE 4TH STREET  
OKLAHOMA CITY, OK 73117



CUSHMAN &  
WAKEFIELD

COMMERCIAL  
OKLAHOMA

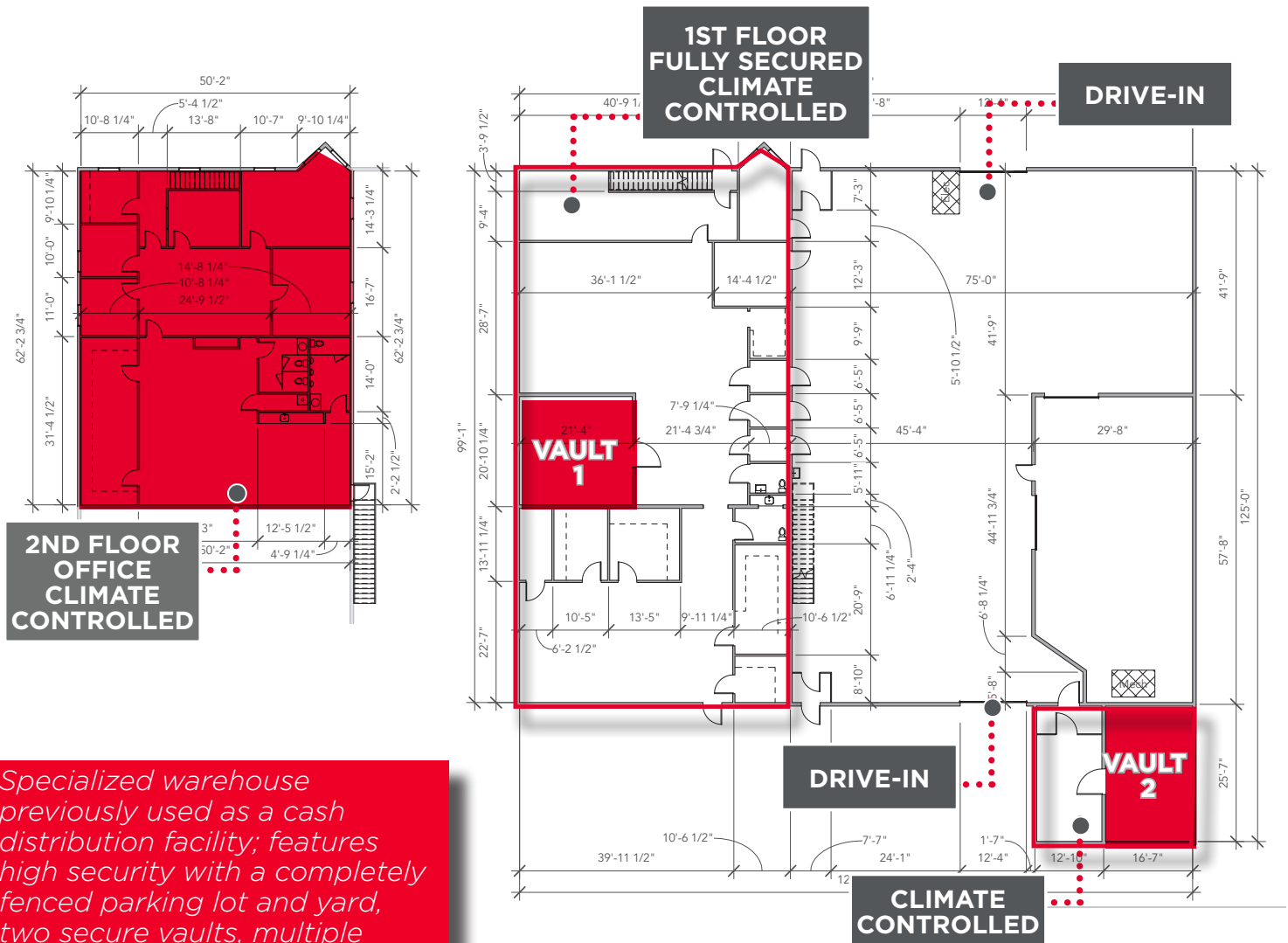

*Specialized warehouse previously used as a cash distribution facility; features high security with a completely fenced parking lot and yard, two secure vaults, multiple counting rooms, generator and high security entrance.*

ALLAN MEADORS, SIOR

+1 405 778 9158

ameadors@commercialoklahoma.com

OKLAHOMA  
CITY

204 N Robinson Ave, Suite 2000, Oklahoma City, OK 73102  
+ 1 405 563 5000  
commercialoklahoma.com



©2025 Cushman & Wakefield | Commercial Oklahoma. Independently Owned and Operated / A Member of the Cushman & Wakefield Alliance All rights reserved. The information contained in this communication is strictly confidential. This information has been obtained from sources believed to be reliable but has not been verified. No warranty or representation, express or implied, is made as to the condition of the property (or properties) referenced herein or as to the accuracy or completeness of the information contained herein, and same is submitted subject to errors, omissions, change of price, rental or other conditions, withdrawal without notice, and to any special listing conditions imposed by the property owner(s). Any projections, opinions or estimates are subject to uncertainty and do not signify current or future property performance.