

APPROX. 4,040 SF OFFICE / MEDICAL SPACE FOR LEASE

At One of the Valley's Busiest Upscale Commercial and Professional Areas

**MOVE-IN
READY!**

Your Business Name

47250 Washington Street, Suite A, La Quinta, CA

Ideal for Medical or Variety of Professional Businesses



www.baxleyproperties.com
Phone: 760-773-3310
Fax: 760-773-3013
73712 Alessandro Drive, Ste B-4
Palm Desert, CA 92260

For Lease: \$1.95/SF + (\$.53/SF) NNN

Approx. 4,040 SF

Irene Di Vito

760-799-1821

irene@baxleyproperties.com

DRE License # 01369784

DISCLAIMER:

The information above has been obtained from sources believed reliable. While we do not doubt its accuracy, we have not verified it and make no guarantee, warranty or representation about it. It is your responsibility to independently confirm its accuracy and completeness. Any projections, opinions, assumptions or estimates used are for example only, and do not represent the current or future performance of the property.

APPROX. 4,040 SF OFFICE / MEDICAL SPACE FOR LEASE

47250 Washington Street, Suite A, La Quinta, CA



DISCLAIMER:
The information above has been obtained from sources believed reliable. While we do not doubt its accuracy, we have not verified it and make no guarantee, warranty or representation about it. It is your responsibility to independently confirm its accuracy and completeness. Any projections, opinions, assumptions or estimates used are for example only, and do not represent the current or future performance of the property.

APPROX. 4,040 SF OFFICE / MEDICAL SPACE FOR LEASE

47250 Washington Street, Suite A, La Quinta, CA

- Well-Appointed Interior
- Convenient Mid-Valley Location
- Great Signage & Easy Access
- Close to Major Medical & Retail Centers
- Newer Construction & Distinctive Architecture
- Current Population Within 5 Mile Radius - 178,604 and Growing

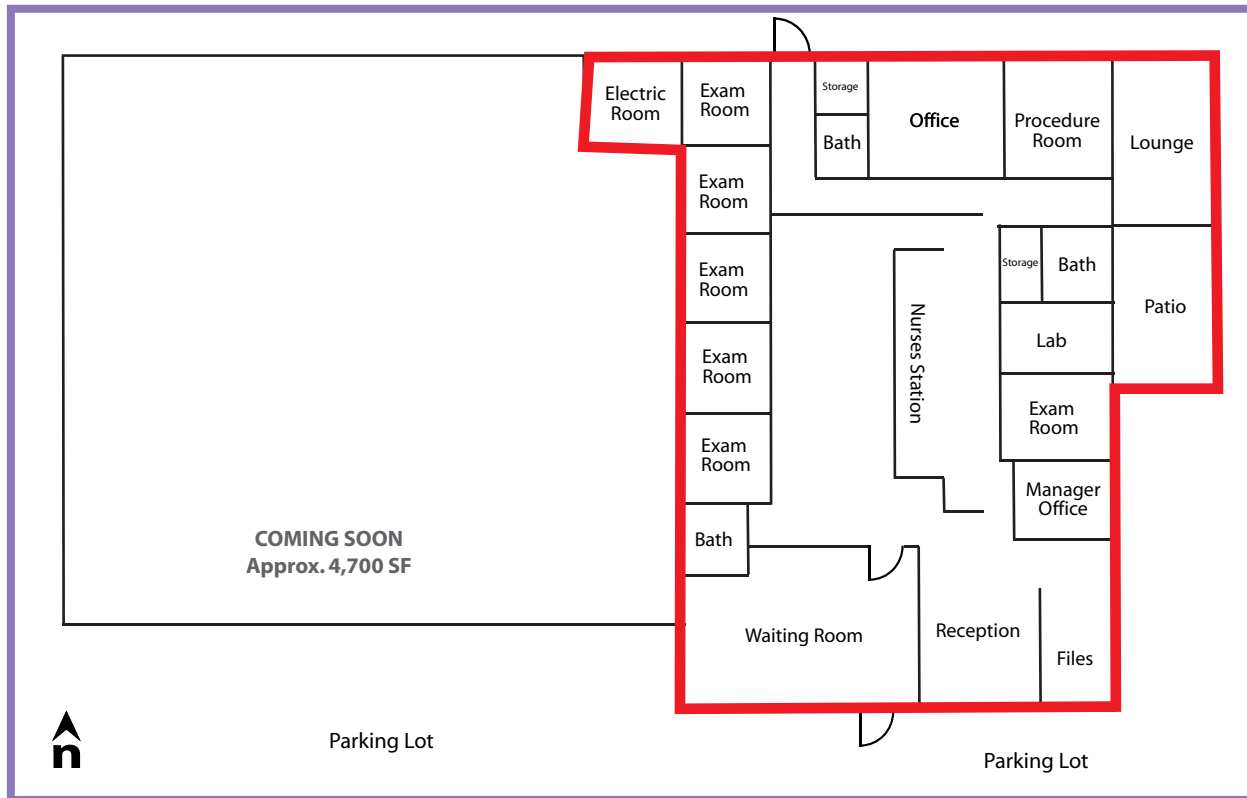

- Eight (8) Offices
- Three (3) Bathrooms
- Large Reception / Waiting Area
- Lounge with Patio

