



WHITEHALL TECHNOLOGY CENTER

Whitehall I **Whitehall II** **Whitehall III**
2745 Whitehall 2915 Whitehall 2705 Whitehall
Park Drive Park Drive Park Drive

**Class-A Business Park in Charlotte's
master-planned Whitehall community**



FOR MORE INFORMATION

Bill Wood | 704.906.2763 | wpw@trinity-partners.com





MASTER-PLANNED COMMUNITY

Part of Charlotte's master-planned Whitehall community, a fully-integrated, mixed-use regional center and one of Charlotte's fastest growing areas

UNMATCHED ACCESS

Located at Arrowood Road and I-485, with immediate access to I-485, I-77, I-85 and minutes from Charlotte Douglas International Airport and the Intermodal Yard

SURROUNDED BY AMENITIES

Immediately accessible to Ayrley and Whitehall Commons, large retail and mixed-use developments with numerous restaurants, hotels, and services

RESPECTED CORPORATE NEIGHBORS

Home to Cimtec Automation, Octapharma, Toshiba, Ryland Homes, Xerox, Cable, Westinghouse, and Weyerhaeuser

FOR MORE INFORMATION

Bill Wood | 704.906.2763 | wpw@trinity-partners.com



2915 Whitehall Park Drive | Suite 600 | ±12,000 SF

- ±5,026 sf existing office
- Three (3) dock high doors
(2 doors have hydraulic pit levelers in place)
- 20' clear height
- Fully air-conditioned
- Heavy power - 1000 AMP service at 480/277
- Available 4/01/26

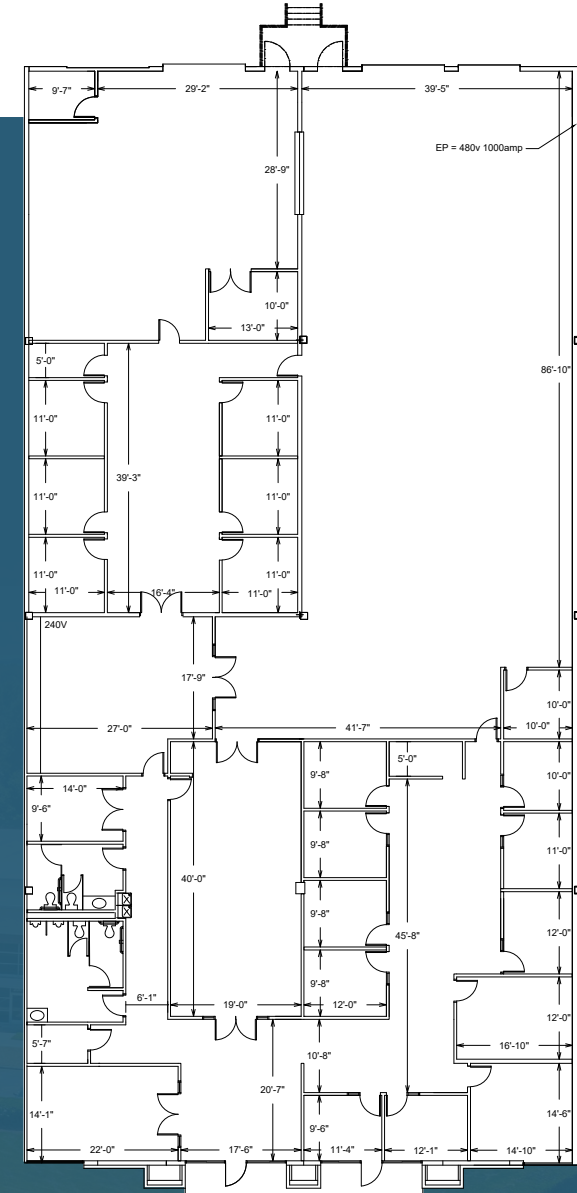



WHITEHALL TECHNOLOGY CENTER

Class-A Business Park in Charlotte's
master-planned Whitehall community.

Whitehall I

2745 Whitehall
Park Drive

Whitehall II

2915 Whitehall
Park Drive

Whitehall III

2705 Whitehall
Park Drive

FOR MORE INFORMATION

Bill Wood | 704.906.2763 | wpw@trinity-partners.com

CIP REAL ESTATE

TRINITY
PARTNERS