



**MOUNTAIN WEST**  
COMMERCIAL REAL ESTATE



# DESERET DRIVE

3287 EAST DESERET DRIVE • ST. GEORGE • UTAH • 84790

## FOR LEASE

### PROPERTY SPECS

- Available: 27,800 SF
- Lease rate: \$0.75/SF full service
- Millcreek Industrial Park
- 2 Dock high overhead doors
- Metal building with 26' to 32' ceiling height
- Zoning: M-2



### CONTACT:

**TROY SCHEEL**

tscheel@mtwest.com  
direct 435.256.8774  
[View Profile](#)

**DOUG SCHEEL**

dscheel@mtwest.com  
direct 435.256.8773  
[View Profile](#)



Best Commercial  
Real Estate  
Of Southern Utah

**RETAIL - INVESTMENT - INDUSTRIAL - LAND - OFFICE - URBAN - MULTIFAMILY - HOSPITALITY**

335 E. St George Blvd, Suite 202 | St. George, Utah 84770 | Office 435.656.5500 | [www.mtnwest.com](http://www.mtnwest.com)

This statement with the information it contains is given with the understanding that all negotiations relating to the purchase, renting or leasing of the property described above shall be conducted through this office. The above information while not guaranteed has been secured from sources we believe to be reliable.

# DESERET DRIVE

UNIT	TENANT
A	Storage Design
B	Storage Design
C	Global Vinyl Solutions
D	Mozaik
E	Moto United
F	Available   27,800 SF

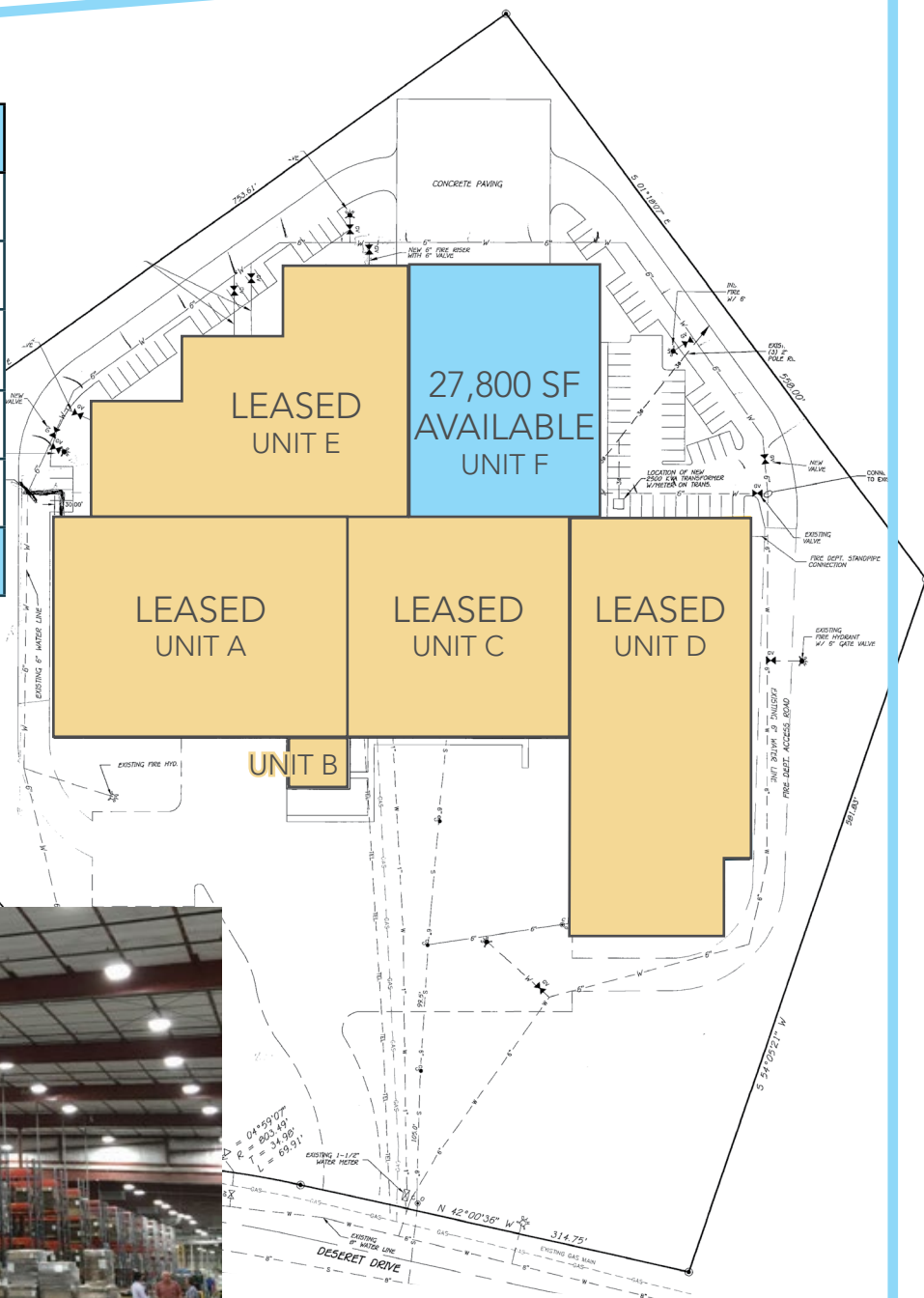

## CONTACT:

**TROY SCHEEL**

tscheel@mtwest.com  
direct 435.256.8774  
[View Profile](#)

**DOUG SCHEEL**

dscheel@mtwest.com  
direct 435.256.8773  
[View Profile](#)



Best Commercial  
Real Estate  
Of Southern Utah

RETAIL - INVESTMENT - INDUSTRIAL - LAND - OFFICE - URBAN - MULTIFAMILY - HOSPITALITY

335 E. St George Blvd, Suite 202 | St. George, UT 84770 | Office 435.656.5500 | [www.mtnwest.com](http://www.mtnwest.com)

This statement with the information it contains is given with the understanding that all negotiations relating to the purchase, renting or leasing of the property described above shall be conducted through this office. The above information while not guaranteed has been secured from sources we believe to be reliable.