

# AVAILABLE LAND

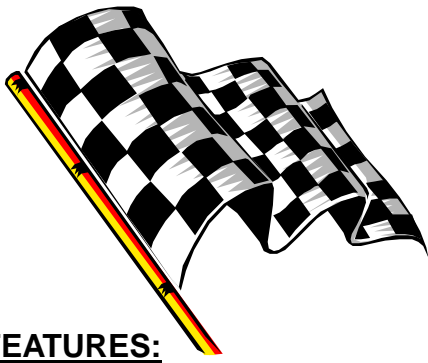

# GRAND PRIX SERIES

A FULLY FINISHED PARCEL

## FEATURES:

- Part of the Master Planned Ontario Center (Previously the Ontario Motor Speedway)
- Near the I-10 & I-15 freeways
- Ontario's Most Prestigious Address

## AMENITIES:

- Toyota Bank Arena.
- Ontario International Airport.
- Ontario Mills Mall.
- Ontario Convention Center.
- Multiple restaurants which include Black Angus, El Torito, and Benihana.
- Hotels include the Ontario Airport, LaQuinta Inn, and the Element.

## APPROVED USES:

- Retail, Office, Hotel, Restaurant, and Potential Residential.

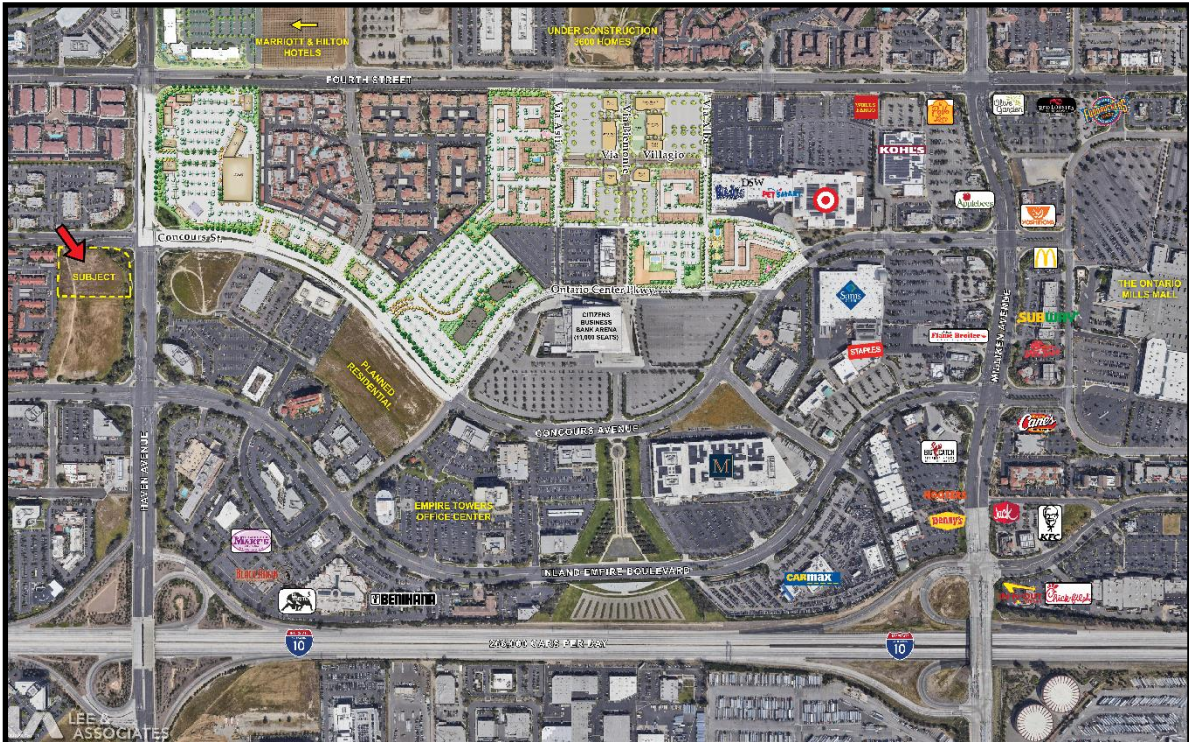

AVAILABLE LAND

# GRAND PRIX SERIES

FINISHED LOT READY TO BUILD



Build-to-Suit – Joint Venture or  
Ground Lease

**PARCEL SIZE:** 3.5 Acres

**APN:** 0210-182-60-0000

FOR FURTHER INFORMATION CONTACT:

CAROL PLOWMAN

909.373.2905

[cplowman@lee-assoc.com](mailto:cplowman@lee-assoc.com)

DRE # 00849369

Lee & Associates-Ontario  
3535 Inland Empire Blvd.  
Ontario, CA 91764

 **LEE &  
ASSOCIATES**  
COMMERCIAL REAL ESTATE SERVICES

Corporate ID # 00976995

Information contained herein has been obtained from sources we deem reliable. We have no reason to doubt its contents; however, we do not guarantee it.

AVAILABLE LAND

# GRAND PRIX SERIES

## PARCEL MAP

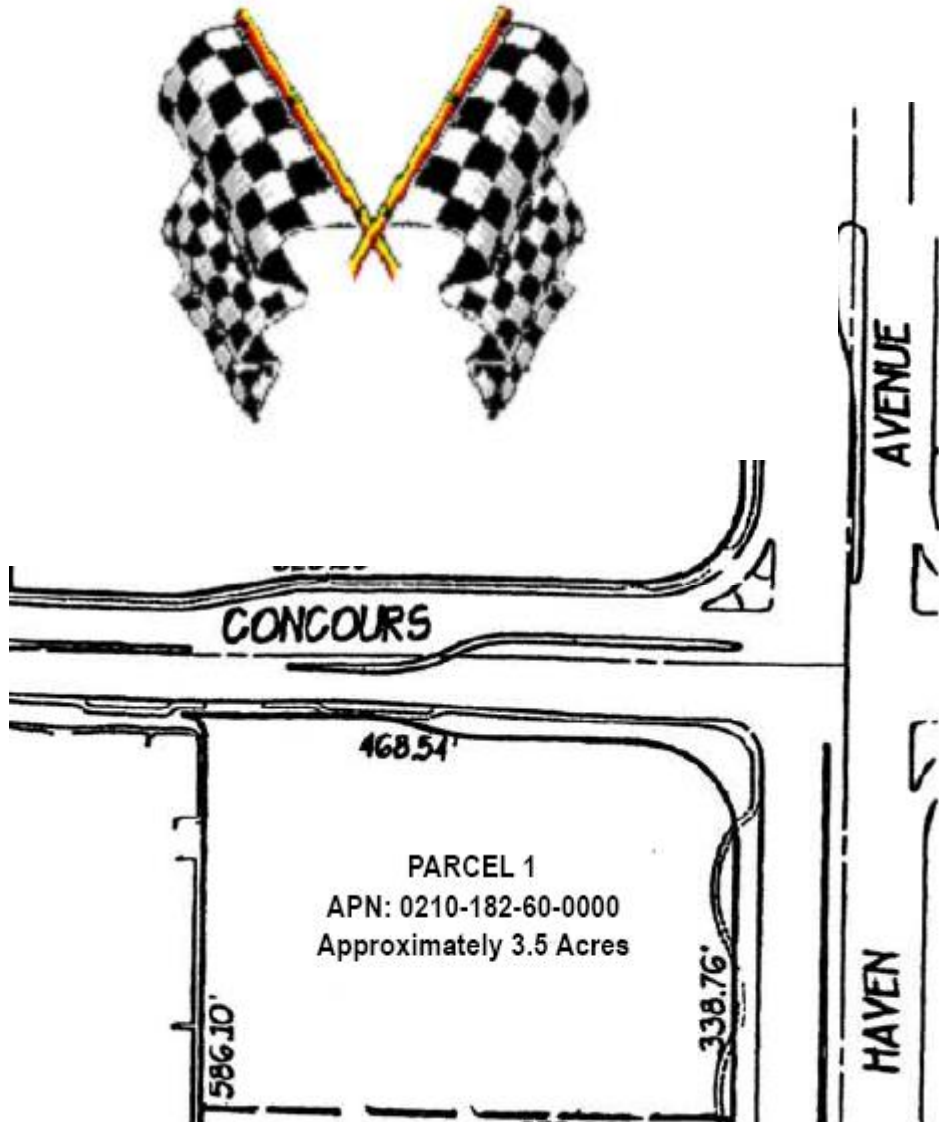

FOR FURTHER INFORMATION CONTACT:

CAROL PLOWMAN  
909.373.2905  
cplowman@lee-assoc.com  
DRE # 00849369

Lee & Associates-Ontario  
3535 Inland Empire Blvd.  
Ontario, CA 91764

 **LEE &  
ASSOCIATES**  
COMMERCIAL REAL ESTATE SERVICES

Corporate ID # 00976995

Information contained herein has been obtained from sources we deem reliable. We have no reason to doubt its contents; however, we do not guarantee it.