

**NOTES:**

- BOUNDARY INFORMATION SHOWN HEREON WAS DERIVED FROM THE LAND RECORDS OF SUSSEX COUNTY, DE AND WAS SUPPORTED BY BOUNDARY MONUMENTS FOUND/LOCATED DURING OUR FIELD RUN LAND SURVEY.
- A TITLE SEARCH WAS NEITHER REQUESTED NOR PREPARED FOR THE SUBJECT PARCEL. THE SURVEYOR HAS NO KNOWLEDGE OF ANY EASEMENTS AND/OR RIGHTS OF WAY WHICH MAY AFFECT THIS PARCEL.
- THE INTENT OF THIS SURVEY IS TO TRACE THE BOUNDARY SHOWN HEREON TO THE SUBJECT PARCEL'S BOUNDARY.

**SURVEYORS CERTIFICATION**

I, STEVEN M. ADKINS, HEREBY ATTEST THAT I AM A REGISTERED LAND SURVEYOR IN THE STATE OF DELAWARE AND THAT THE INFORMATION SHOWN HEREON WAS PREPARED UNDER MY DIRECT SUPERVISION AND IN ACCORDANCE WITH THE STANDARDS ESTABLISHED BY THE STATE OF DELAWARE.

STEVEN M. ADKINS      LS-700      DATE

**STEVEN M. ADKINS**  
 Land Surveying, LLC  
 28724 Seaford Road  
 Laurel, DE 19856  
 (302) 876-5555 - Office

**LOCATION SURVEY**  
 OF THE LANDS OF NOW OR FORMERLY  
 PARKS BERGAMO LLC  
 MORRIS MILL ROAD  
 INDIAN RIVER HUNDRED  
 SUSSEX COUNTY, DELAWARE

PROJECT #:	DATE:
2020034.00	07/10/2020
SCALE:	DRAWN BY:
1" = 100'	N.C.E.
BOUNDARY SURVEY	DRAWING NUMBER
232-20-22	

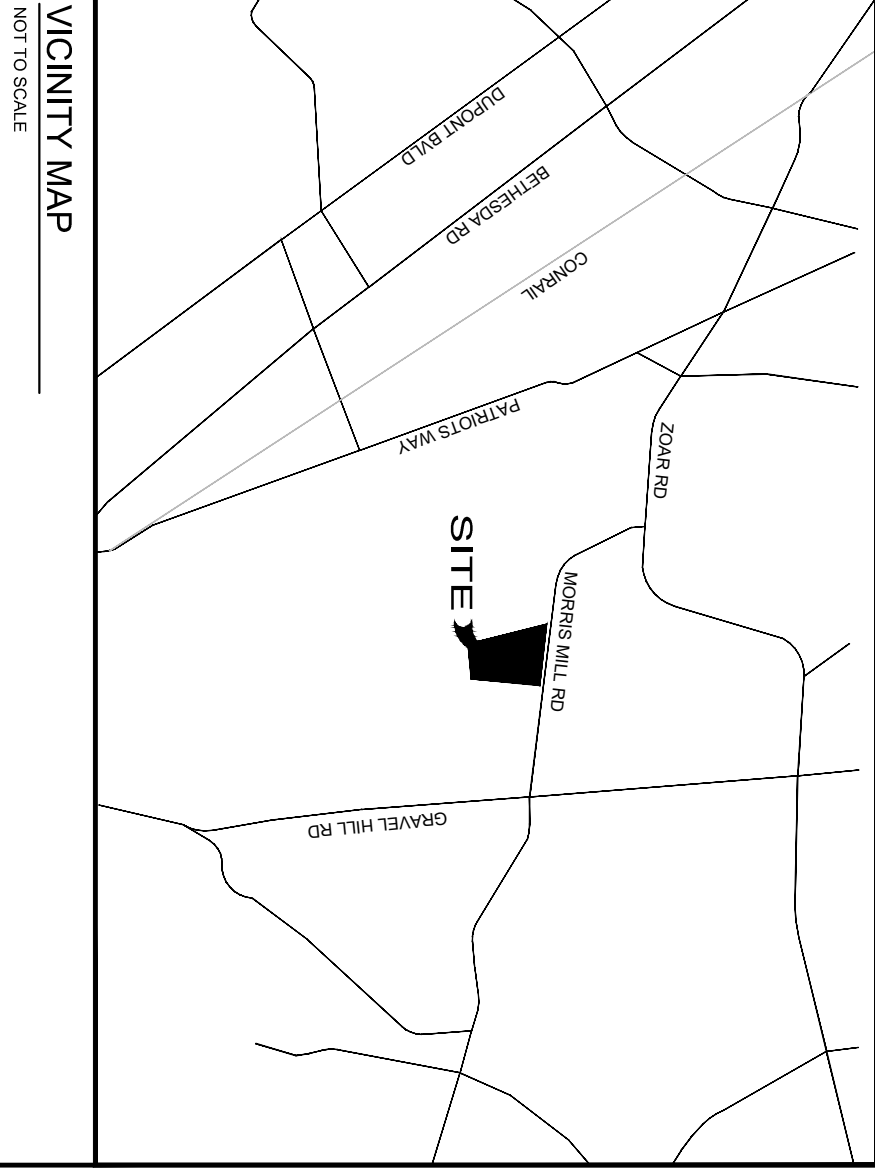

- LEGEND**
- FOUND CONCRETE MONUMENT
  - FOUND CAPPED IRON ROD
  - FOUND IRON REBAR
  - SET CAPPED IRON ROD

**SITE DATA**

OWNER:	PARKS BERGAMO LLC
SURVEYOR:	560 CORBETT PLACE STEVEN M. ADKINS 26283 DUKES LUMBER ROAD LAUREL, DE 19856
TAX MAP:	232.9100-22.00
DEED REF:	BOOK 4399, PAGE 232
LOT AREA:	TOTAL ACREAGE: 46.116 ACRES
LOT USE:	PARCEL 22.00: RESIDENTIAL, AGRICULTURAL, FORESTLANDS
SEWER/WATER:	PRIVATE
SETBACKS:	FRONT: 40 REAR: 20
ZONING:	AR-1
ROAD FRONTAGE:	PARCEL 22.00: 1060.87 FEET (SCR 297 - MORRIS MILL ROAD)
NEAREST TOWN:	MILLSBORO, DE