

For Sublease

Chadbourn Building

2500 N Brevard Street

18,331 SF available



Features & Amenities:

- 6/30/2031 LEX
- Furniture negotiable
- Nearby LYNX Light Rail stations:
 - 25th St Station - 0.2 mi
 - Parkwood Station - 0.7 mi
- Parking ratio: 3.0/0,000
 - Free surface parking
- Nearby retail includes:
 - Sunflour Baking Company - 0.1 mi
 - Urban District Market - 0.2 mi
 - Rhino Market & Deli - 0.3 mi
 - Night Swim Coffee - 0.5 mi
 - Optimist Hall - 1 mi

Virtual Tour



2nd Floor - 18,331 SF

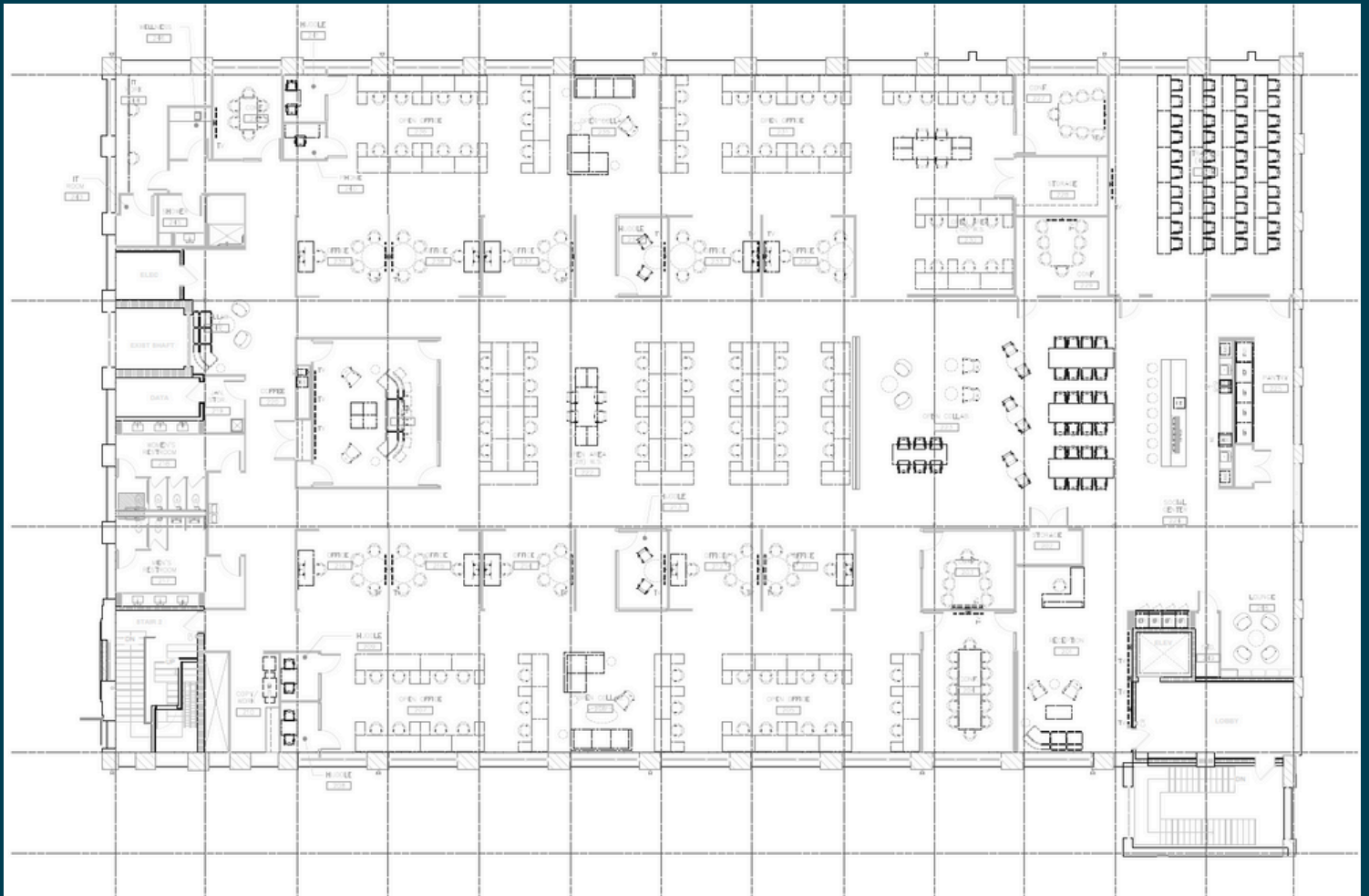

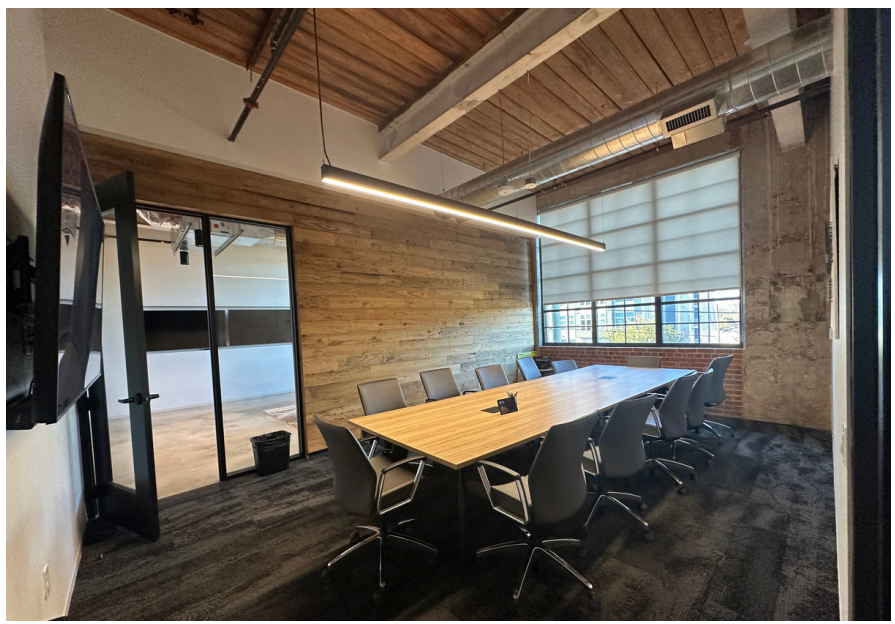
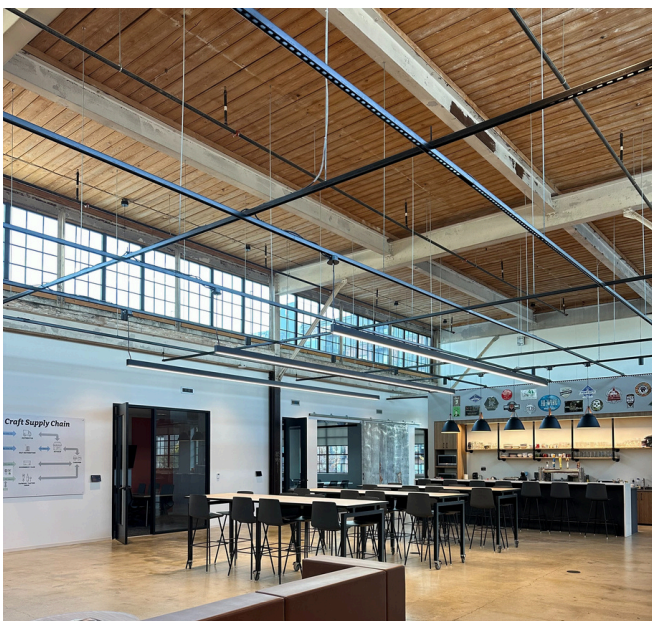

Contact Us

Bryan White
Executive Managing Director
bryan.white@jll.com
+1 704 724 6121

Ross Howard
Managing Director
ross.howard@jll.com
+1 336 456 5569