

Building Sketch

Borrower	John A Nixon, Nixon Enterprises LLC				
Property Address	1908 N State Highway 95				
City	Bastrop	County	Bastrop	State	TX
Zip Code	78602				
Lender/Client	Classic Bank, N.A.				

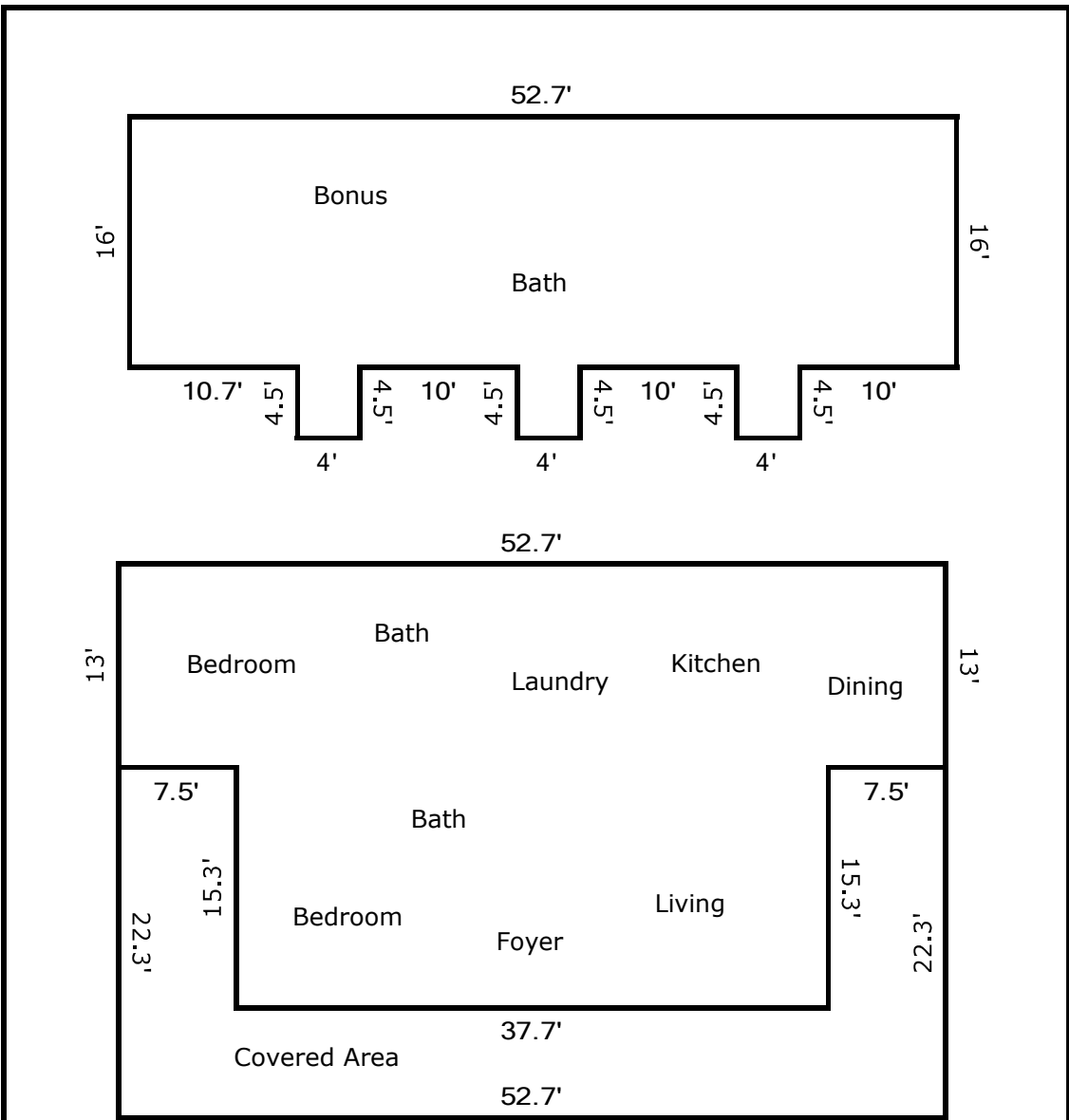

TOTAL Sketch by a la mode

Area Calculations Summary

Living Area	Calculation Details	
First Floor	1261.91 Sq ft	37.7 × 15.3 = 576.81 52.7 × 13 = 685.1
Second Floor	897.2 Sq ft	52.7 × 16 = 843.2 4 × 4.5 = 18 4 × 4.5 = 18 4 × 4.5 = 18
Total Living Area (Rounded):	2159 Sq ft	
Non-living Area		
Covered Porch	598.4 Sq ft	52.7 × 7 = 368.9 7.5 × 15.3 = 114.75 7.5 × 15.3 = 114.75