



4721 Country Club Road
+/- 2,468 SF Office Space
4721 Country Club Road Winston-Salem, NC 27104



Cassie Taylor

VP of Investment Real Estate

Office: 336-733-1504 CTaylor@HubbardRealty.com

Hubbard Realty
1598 Westbrook Plaza Drive, Suite 200
Winston-Salem, NC 27103



OVERVIEW



Available:

Suite 110 +/- 2,468 SF
Lease Rate: \$12.00/PSF for Shell Space
Tenant Upfit Allowance TBD

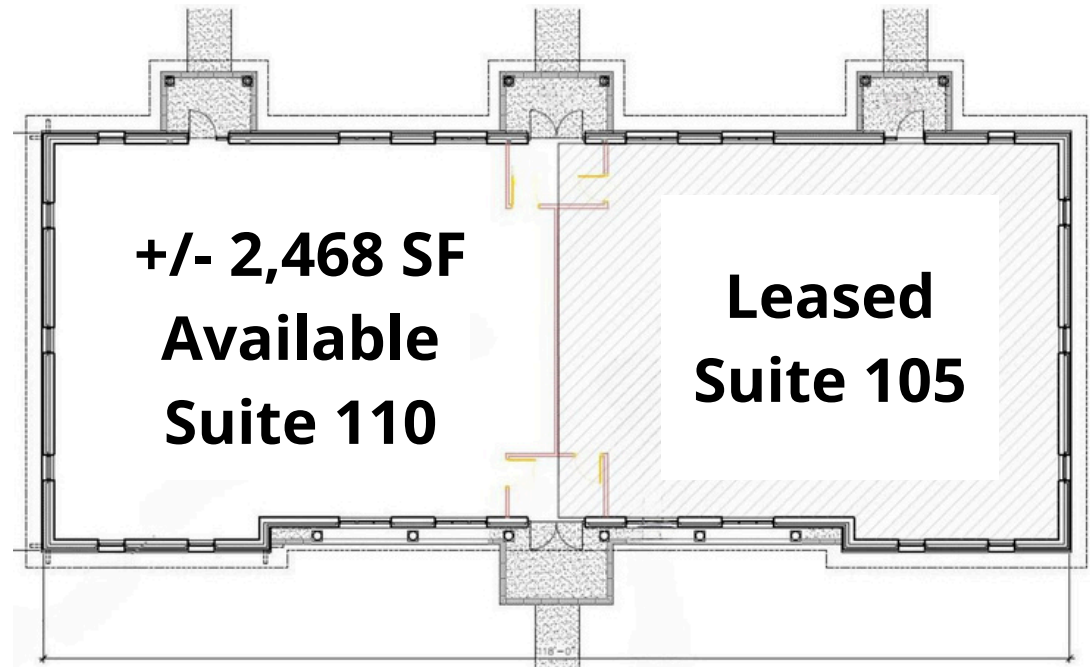

Location:

4721 Country Club Road, Suite 110
Winston-Salem, NC 27104
Located at the intersection with Queensbury Road.



PROPERTY DETAILS

YEAR BUILT/RENOVATED:
2020

BUILDING SIZE:
+/- 5,485 SF

ZONING:
LO-S

TICAM:
\$2.00/PSF Est.

USES:
See WS/FC UDO. Professional Office; Offices;
Miscellaneous; Medical and Surgical Offices;
Neighborhood Organization

New Construction building completed in 2020 with high visibility and easy access to Country Club Road. Near the intersection of Jonestown Road and Country Club, this property offers convenient access to 421 and Hanes Mall Blvd.

No warranty or representation is made to the accuracy of the information contained herein.
All information is subject to change or withdrawal. No liability is assumed for any inaccuracy of any information.

Demographics

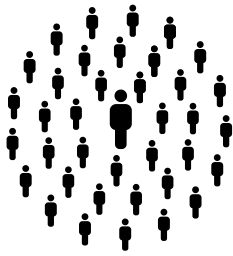

Population

1 Mile 9,663 people

3 Mile 55,912 people

5 Mile 137,860 people

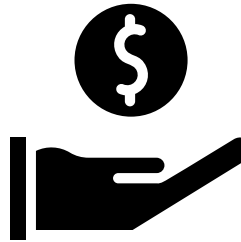

Average Household Income

1 Mile \$79,827

3 Mile \$127,173

5 Mile \$127,343



Households

1 Mile 4,989

3 Mile 25,386

5 Mile 61,238



Traffic Count

21,500 +/-

vehicles per day

Demographics prepared by ESRI on 8/14/2025.