

1239 - 1309 MONROE STREET NORTHWEST, NEW PHILADELPHIA, OH 44663



PROPERTY DESCRIPTION

Professionally managed plaza located in the heart of Dover/New Philadelphia. Monroe Plaza offers a convenient location with plenty of free parking.

NNN fee is \$2.59 / SF / YR and includes Real Estate taxes, insurance, snowplowing & salt, landscaping, exterior windows, security lighting and trash.

Co-Broke Fee offered for qualified tenants.

| SPACES | LEASE RATE | SPACE SIZE |
|---|---------------|------------|
| 1251 - 2,370 SQ.FT. RETAIL/OFFICE/MEDICAL SPACE | \$10.00 SF/yr | 2,370 SF |
| 1261 - 1,900 SQ.FT. RETAIL/OFFICE/MEDICAL SPACE | \$13.25 SF/yr | 1,900 SF |

LOCATION DESCRIPTION

Join tenants like Shelter Insurance, Doering Vision Center, Giggle Monster Photos, CrossFit Gym, Vapor & Smoke, Endless Ink, Eagle Healthworks, Hair Dye-Agnostics, Inside Out Nutrition, Jackpot Fever and Safelite in an established and busy shopping and service plaza in New Philadelphia, Ohio.

Directions: I-77 to Exit #83, Dover, Route 39 turn left and veer right on Tuscarawas, thru town, left on Wabash, left at Monroe ST NW.

OFFERING SUMMARY

| | |
|-----------------------|--------------------------|
| Lease Rate: | \$10 - 13.25 SF/yr (NNN) |
| Available SF: | 1,900 - 2,370 SF |
| Lot Size: | 1.7 Acres |
| Building Size: | 23,510 SF |

Saylor Putman

Vice President - Senior Sales Associate
330.495.8292
saylor@putmanproperties.com

Spencer Hartung

Vice President, Senior Sales Associate
330.936.0276
spencer@putmanproperties.com



This information is from a reliable source but is not guaranteed and is subject to change. All dimensions are approximate, are not guaranteed, and the property is subject to prior disposition. Some images may have been digitally enhanced for marketing purposes and may not reflect current property conditions.

1239 - 1309 MONROE STREET NORTHWEST, NEW PHILADELPHIA, OH 44663

AVAILABLE SPACES

| SUITE | TENANT | SIZE (SF) | LEASE TYPE | LEASE RATE | DESCRIPTION |
|---|-----------|-----------|------------|---------------|---|
| 1251 - 2,370 SQ.FT. RETAIL/OFFICE/MEDICAL SPACE | Available | 2,370 SF | NNN | \$10.00 SF/yr | 2,370 Sq.ft. office/medical space for lease that includes a waiting/reception area, two offices, three exam rooms, xray room, two therapy rooms, storage rooms and two restrooms. Total rent is \$2,486.53/ month + utilities. |
| 1261 - 1,900 SQ.FT. RETAIL/OFFICE/MEDICAL SPACE | Available | 1,900 SF | NNN | \$13.25 SF/yr | 1,900 Sq.ft. retail, office or medical space for lease that includes large open area, reception and waiting space, kitchenette with coffee bar/sink including washer/dryer hookup and one (1) ADA restroom. Total rent is \$2,508.00/ month + utilities. Vacant & available now. Formerly leased to Spectrum Orthopedics. |

Saylor Putman

Vice President - Senior Sales Associate
330.495.8292
saylor@putmanproperties.com

Spencer Hartung

Vice President, Senior Sales Associate
330.936.0276
spencer@putmanproperties.com



This information is from a reliable source but is not guaranteed and is subject to change. All dimensions are approximate, are not guaranteed, and the property is subject to prior disposition. Some images may have been digitally enhanced for marketing purposes and may not reflect current property conditions.

MONROE PLAZA

FOR LEASE

1239 - 1309 MONROE STREET NORTHWEST, NEW PHILADELPHIA, OH 44663

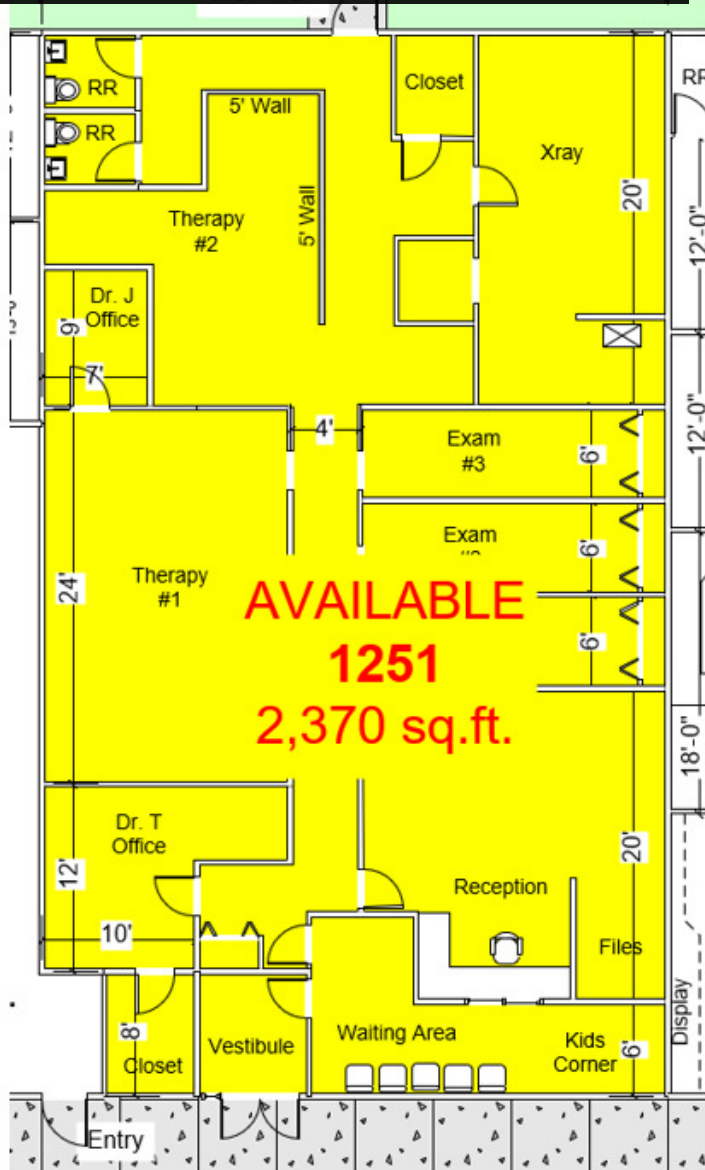

Saylor Putman

Vice President - Senior Sales Associate
330.495.8292
saylor@putmanproperties.com

Spencer Hartung

Vice President, Senior Sales Associate
330.936.0276
spencer@putmanproperties.com



This information is from a reliable source but is not guaranteed and is subject to change. All dimensions are approximate, are not guaranteed, and the property is subject to prior disposition. Some images may have been digitally enhanced for marketing purposes and may not reflect current property conditions.

MONROE PLAZA

1239 - 1309 MONROE STREET NORTHWEST, NEW PHILADELPHIA, OH 44663

FOR LEASE



Saylor Putman

Vice President - Senior Sales Associate
330.495.8292
saylor@putmanproperties.com

Spencer Hartung

Vice President, Senior Sales Associate
330.936.0276
spencer@putmanproperties.com



This information is from a reliable source but is not guaranteed and is subject to change. All dimensions are approximate, are not guaranteed, and the property is subject to prior disposition. Some images may have been digitally enhanced for marketing purposes and may not reflect current property conditions.

MONROE PLAZA

FOR LEASE

1239 - 1309 MONROE STREET NORTHWEST, NEW PHILADELPHIA, OH 44663



Saylor Putman

Vice President - Senior Sales Associate
330.495.8292
saylor@putmanproperties.com

Spencer Hartung

Vice President, Senior Sales Associate
330.936.0276
spencer@putmanproperties.com



This information is from a reliable source but is not guaranteed and is subject to change. All dimensions are approximate, are not guaranteed, and the property is subject to prior disposition. Some images may have been digitally enhanced for marketing purposes and may not reflect current property conditions.

MONROE PLAZA

FOR LEASE

1239 - 1309 MONROE STREET NORTHWEST, NEW PHILADELPHIA, OH 44663



Saylor Putman

Vice President - Senior Sales Associate
330.495.8292
saylor@putmanproperties.com

Spencer Hartung

Vice President, Senior Sales Associate
330.936.0276
spencer@putmanproperties.com



This information is from a reliable source but is not guaranteed and is subject to change. All dimensions are approximate, are not guaranteed, and the property is subject to prior disposition. Some images may have been digitally enhanced for marketing purposes and may not reflect current property conditions.

MONROE PLAZA

FOR LEASE

1239 - 1309 MONROE STREET NORTHWEST, NEW PHILADELPHIA, OH 44663



Map data ©2025 Imagery ©2025 Airbus, CNES / Airbus, Landsat / Copernicus, Maxar Technologies, USDA/FPAC/GEO

Saylor Putman

Vice President - Senior Sales Associate
330.495.8292
saylor@putmanproperties.com

Spencer Hartung

Vice President, Senior Sales Associate
330.936.0276
spencer@putmanproperties.com



This information is from a reliable source but is not guaranteed and is subject to change. All dimensions are approximate, are not guaranteed, and the property is subject to prior disposition. Some images may have been digitally enhanced for marketing purposes and may not reflect current property conditions.

MONROE PLAZA

1239 - 1309 MONROE STREET NORTHWEST, NEW PHILADELPHIA, OH 44663

FOR LEASE

POPULATION

| | 1 MILE | 3 MILES | 5 MILES |
|----------------------|--------|---------|---------|
| Total Population | 9,202 | 30,405 | 38,082 |
| Average Age | 42 | 42 | 43 |
| Average Age (Male) | 40 | 41 | 41 |
| Average Age (Female) | 44 | 44 | 44 |

HOUSEHOLDS & INCOME

1 MILE 3 MILES 5 MILES

| | 1 MILE | 3 MILES | 5 MILES |
|---------------------|-----------|-----------|-----------|
| Total Households | 3,994 | 12,697 | 15,888 |
| # of Persons per HH | 2.3 | 2.4 | 2.4 |
| Average HH Income | \$75,738 | \$83,487 | \$89,344 |
| Average House Value | \$177,610 | \$201,820 | \$213,971 |

Demographics data derived from AlphaMap

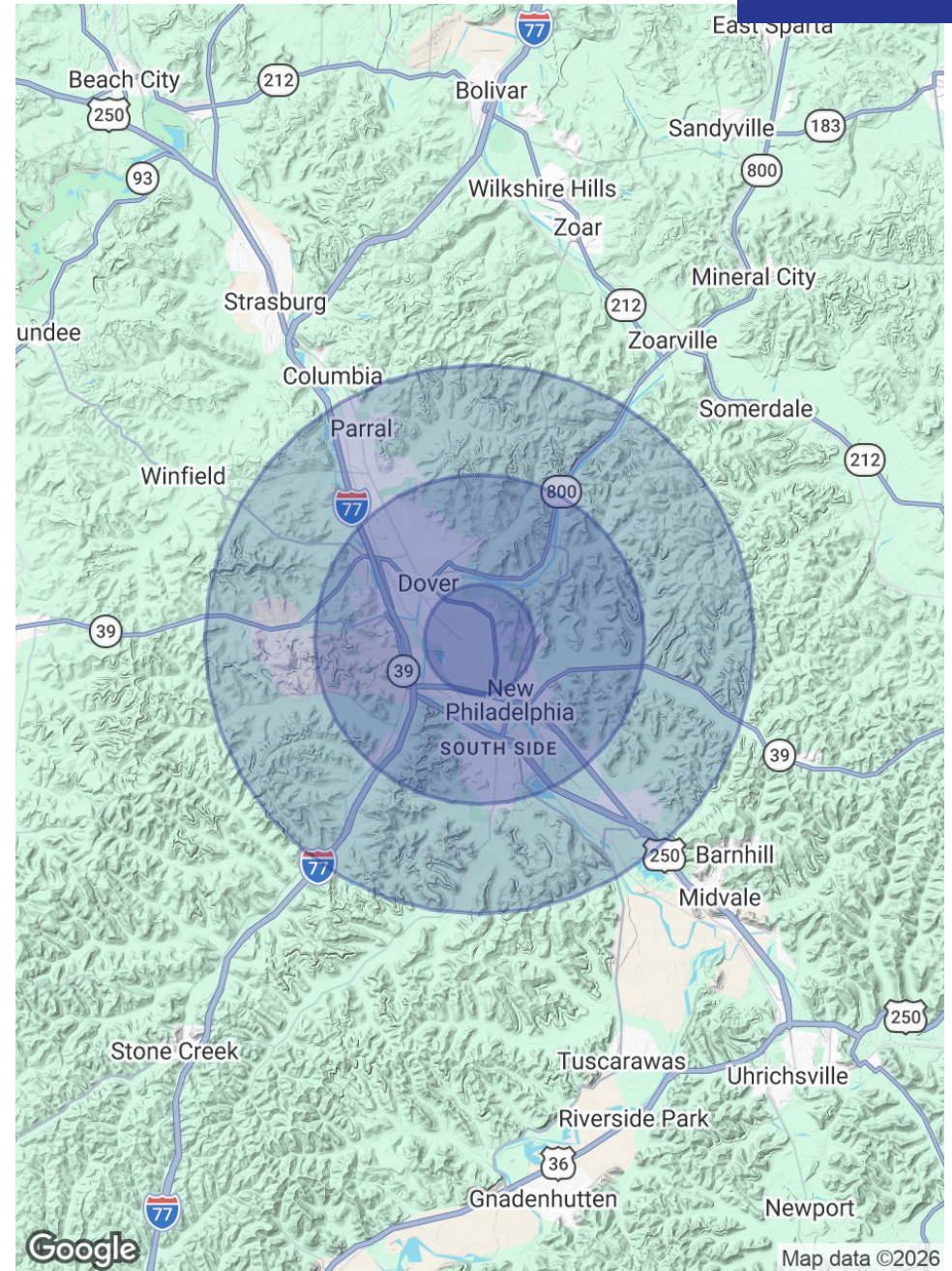

Saylor Putman

Vice President - Senior Sales Associate
330.495.8292
saylor@putmanproperties.com

Spencer Hartung

Vice President, Senior Sales Associate
330.936.0276
spencer@putmanproperties.com



This information is from a reliable source but is not guaranteed and is subject to change. All dimensions are approximate, are not guaranteed, and the property is subject to prior disposition. Some images may have been digitally enhanced for marketing purposes and may not reflect current property conditions.