

519-525 W. TERRACE DRIVE  
SAN DIMAS, CALIFORNIA



±24,948 SF DIVISIBLE INDUSTRIAL BUILDING AVAILABLE FOR SALE



NORTH PALISADE  
PARTNERS



LEE &  
ASSOCIATES

# SITE PLAN

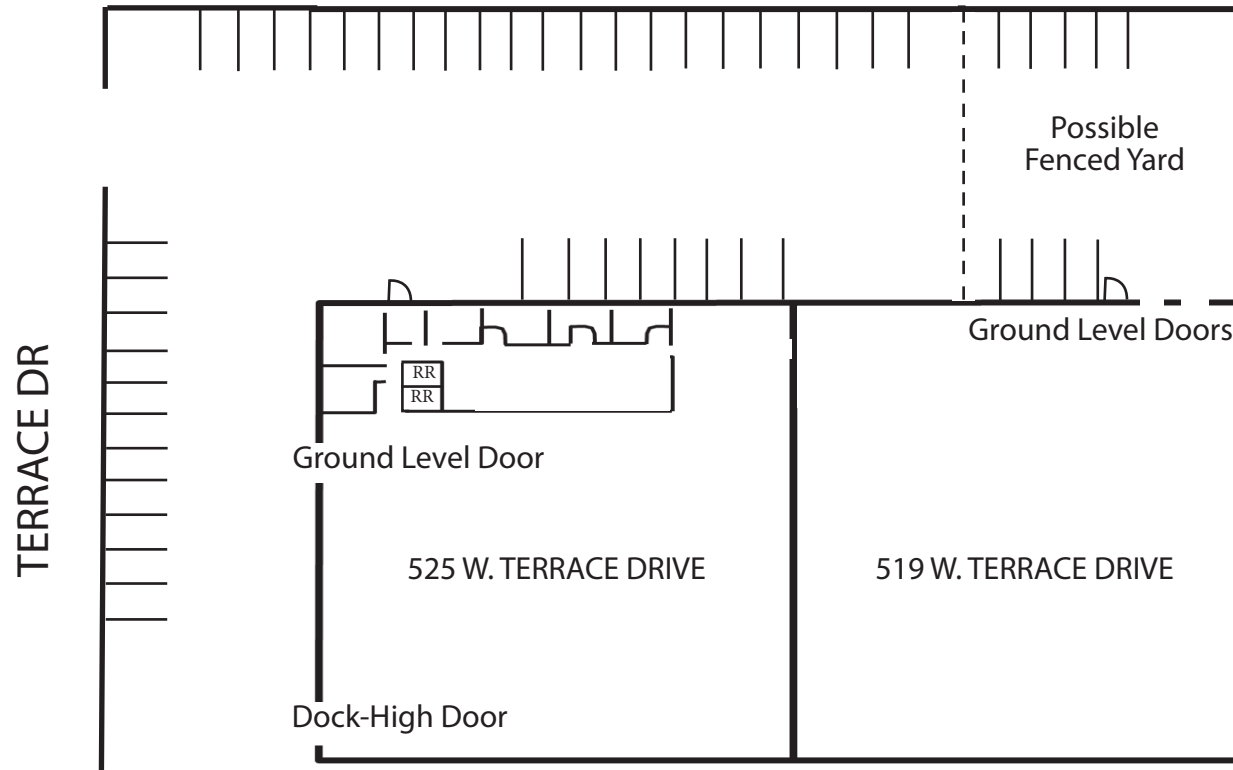

## BUILDING HIGHLIGHTS

### 519 W. Terrace Drive

- ±12,474 SF
- Ground Level Loading
- Possible Fenced Yard

### 525 W. Terrace Drive

- ±12,474 SF
- ±1,850 SF Office Space
- Ground Level and Dock-High Loading

### 519 W. Terrace Drive &

### 525 W. Terrace Drive

- ± 24,948 SF
- 18' Clear Height
- Ample Parking
- Immediate Access to 57, 210, 10, and 71 Freeways

# LOCATION MAP



# SUBMARKET MAP

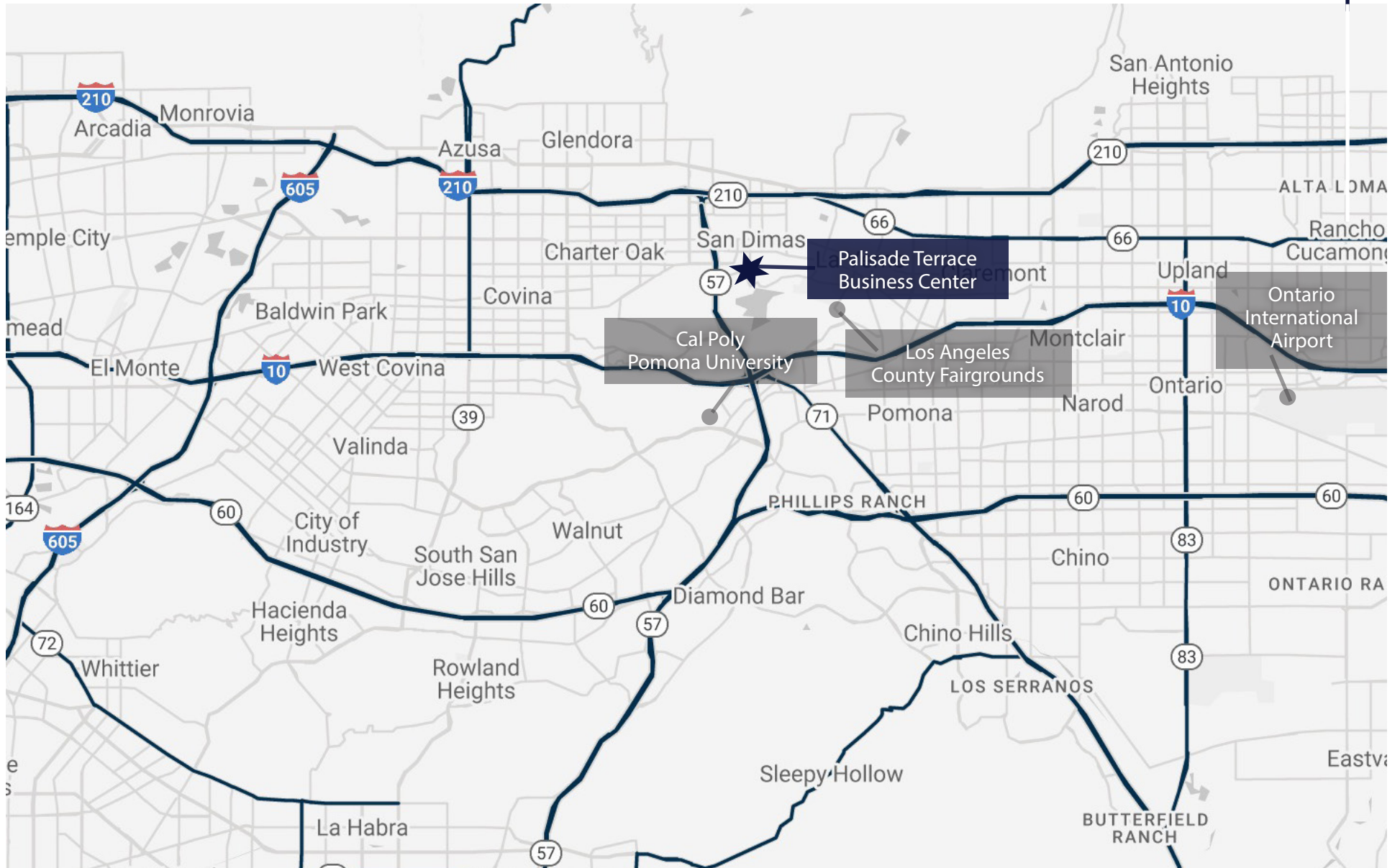

# SITE PHOTOS





## CONTACTS

TODD LAUNCHBAUGH  
SENIOR VICE PRESIDENT/PRINCIPAL  
Lic: 01059250  
(909) 373-2911  
tlaunchbaugh@lee-assoc.com

JUSTIN LEEWOOD  
SENIOR VICE PRESIDENT/PRINCIPAL  
Lic: 01837452  
(909) 373-2989  
jleewood@lee-assoc.com