



Accelerating success.

Developed By:

**FARAH & FARAH**  
Protecting you and your family since 1979.



**For Lease**

## Contact

**Gary Montour**  
Senior Vice President  
+1 904 861 1116  
gary.montour@colliers.com

**Ryan Montour**  
Client Service Specialist  
+1 904 861 1129  
ryan.montour@colliers.com

**Reid Featherngill**  
Client Service Specialist  
+1 904 861 1143  
reid.featherngill@colliers.com

**Colliers**  
76 S. Laura St., Ste. 1500  
Jacksonville, FL 32202  
P: +1 904 358 1206  
colliers.com/jacksonville

# Retail Shopping Center

1539 Blanding Blvd. | Middleburg, FL 32068

## Property Highlights

- Retail/office space to lease from 1,352± - 2,882± SF (will divide)
- Outdoor seating available for restaurant, bank, etc.
- Access through Speedway Gas to traffic light at Blanding Blvd./Henley Rd.
- 166' of frontage on Blanding Blvd.
- 11,000± AADT on Henley Rd.
- 41,000± AADT on Blanding Blvd.
- Existing tenants: Trulieve and Farah & Farah
- Major anchors include St. Vincent's Hospital, Lowe's, Home Depot and Aldi
- Minutes from new First Coast Expressway
- Pricing
  - \$25.00/SF base rent
  - \$7.00/SF NNN | CAM (estimate)

# Location



## Drive Times

First Coast Expressway	1.8 mi (4 min)
Orange Park	5.6 mi (11 min)
Downtown	29.2 mi (28 min)
I-295	8.0 mi (14 min)
Fleming Island	7.6 mi (13 min)

# Aerial View



## Area Demographics

Source: ESRI Business Analyst, 2023



**Population**  
(2023)

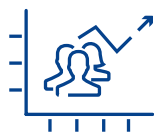

**Population Projection**  
(2028)



**Average Household Income** (2023)

	Population (2023)	Population Projection (2028)	Average Household Income (2023)
<b>1 Mile</b>	4,397	4,526	\$83,854
<b>3 Miles</b>	34,777	35,548	\$95,723
<b>5 Miles</b>	102,631	104,926	\$107,007

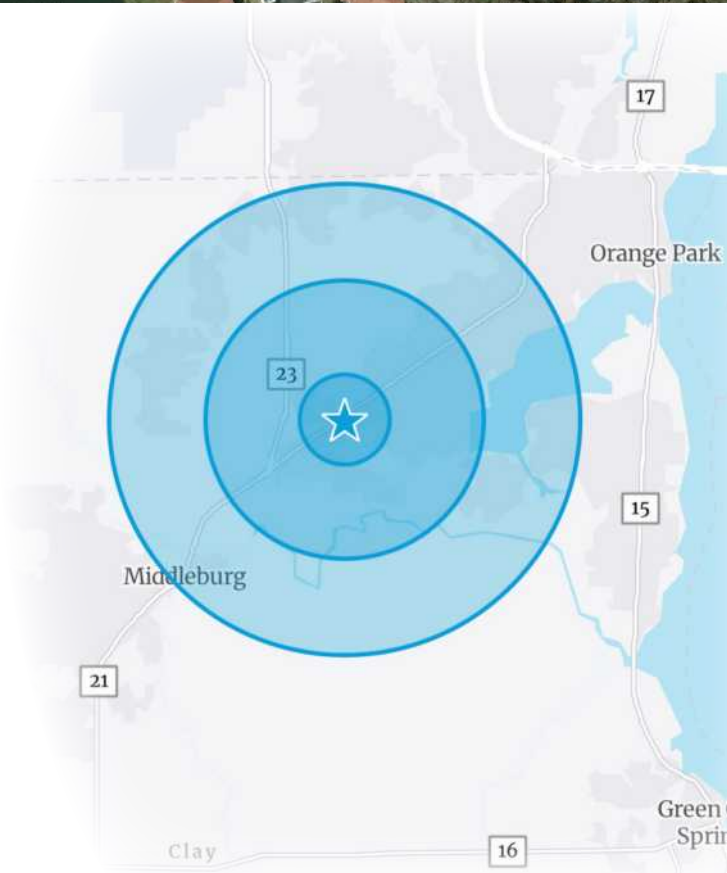

# Photo Gallery



# Signage



**WALL SIGN ALLOWANCES BY OCCUPANT**

FRONT FOOT (by occupant)  
 MAX SIGN AREA (by occupant)

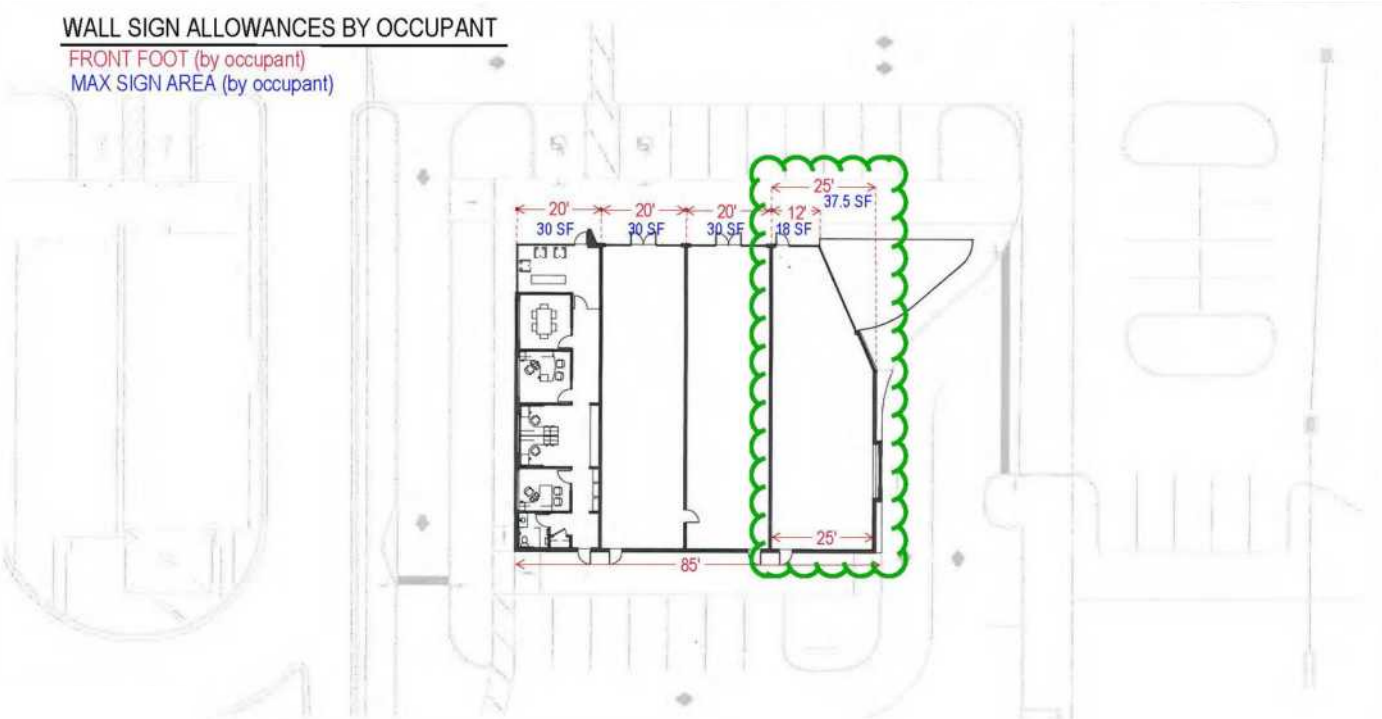

# Floor Plan with Leaseable SF

Blanding Blvd

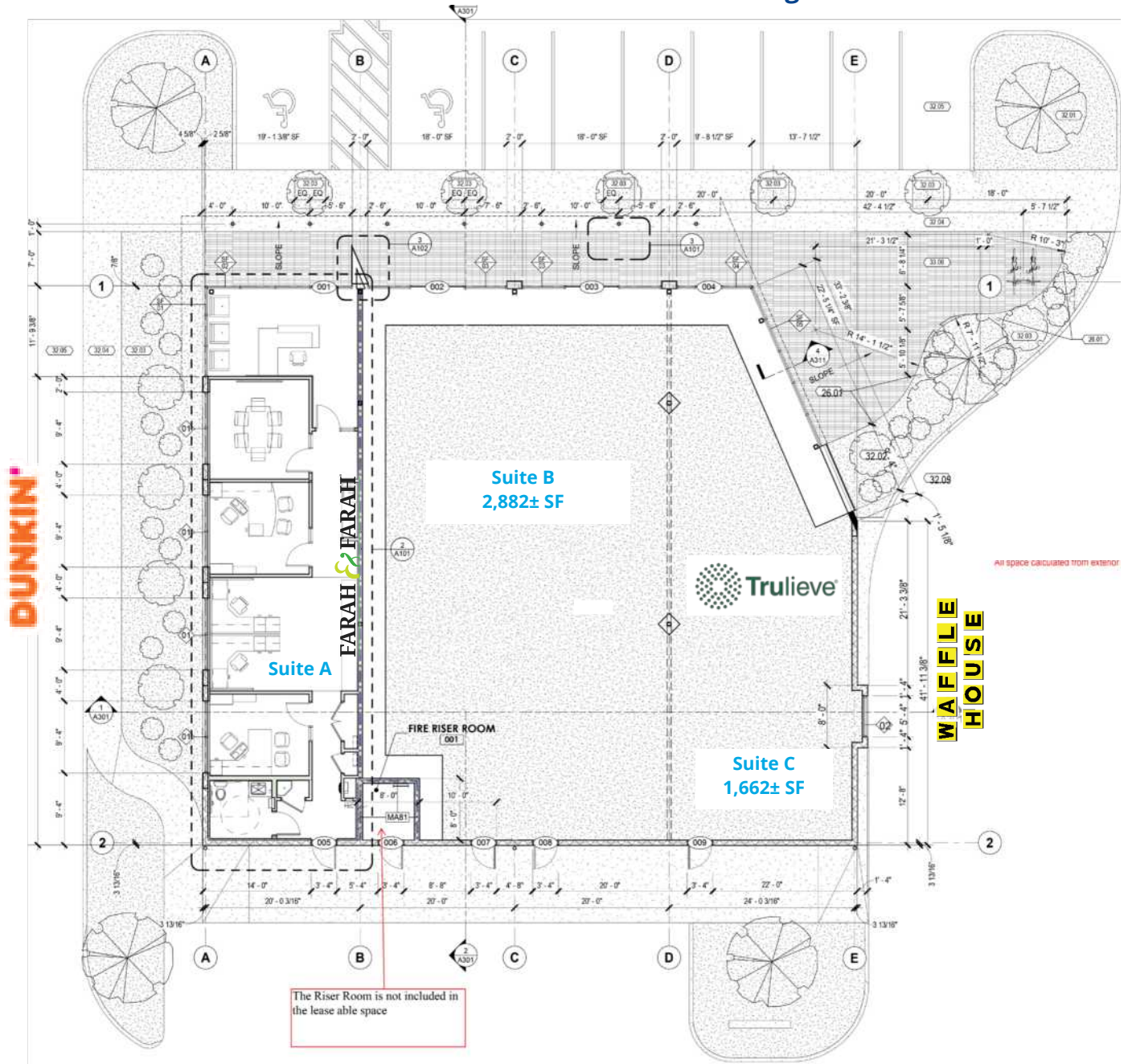

Suite	Size	Tenant	Note
C	1,662± SF	Trulieve	Opening 4th quarter 2024
B	2,882± SF	Vacant	Adjacent to Trulieve (can be subdivided)
A	1,600± SF	Farah & Farah	Open

# Survey

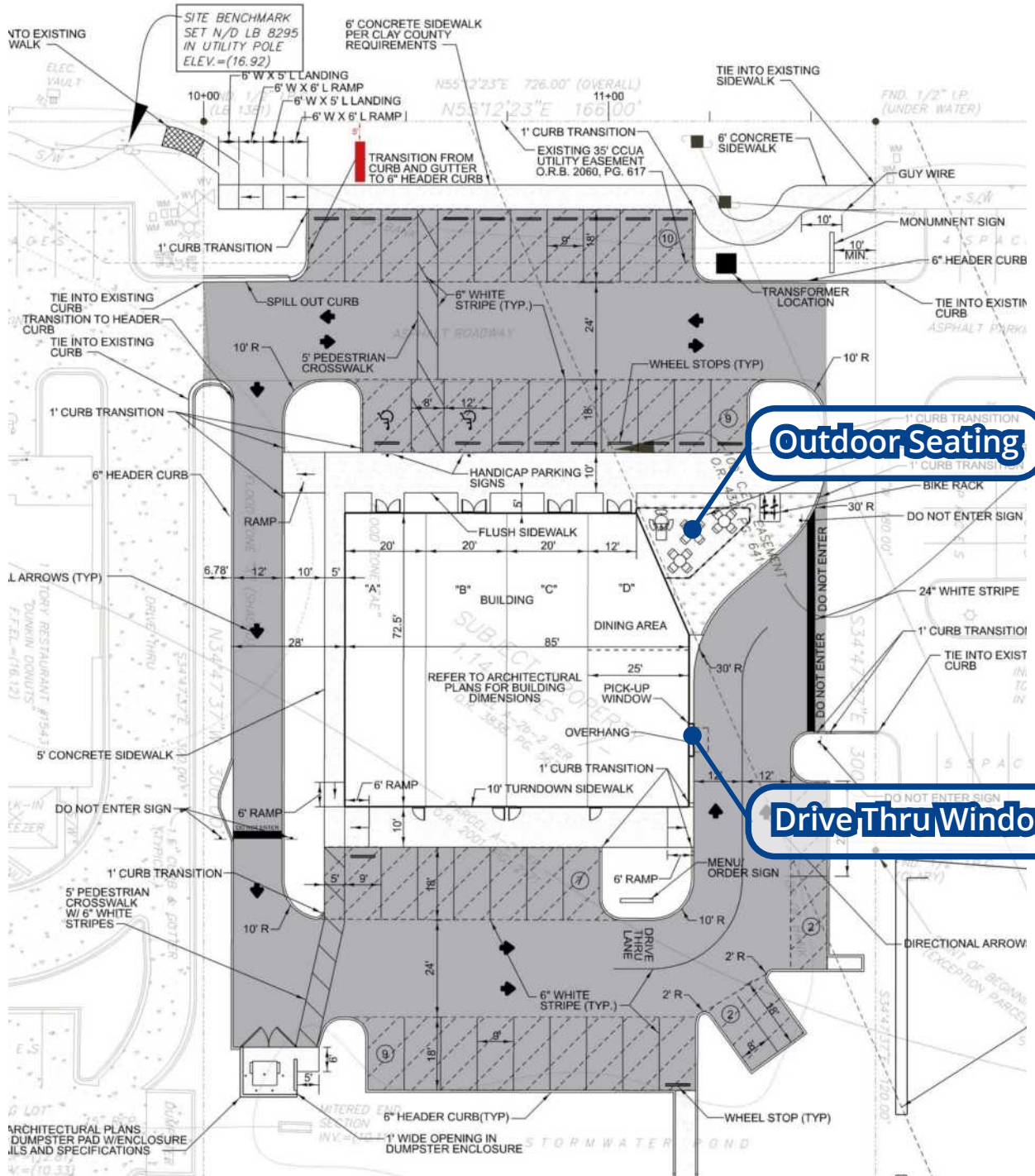

**Disclaimer:** This document/email has been prepared by Colliers for advertising and general information only. Colliers makes no guarantees, representations or warranties of any kind, expressed or implied, regarding the information including, but not limited to, warranties of content, accuracy and reliability. Any interested party should undertake their own inquiries as to the accuracy of the information. Colliers excludes unequivocally all inferred or implied terms, conditions and warranties arising out of this document and excludes all liability for loss and damages arising therefrom. This publication is the copyrighted property of Colliers and/or its licensor(s). ©2023. All rights reserved. This communication is not intended to cause or induce breach of an existing listing agreement. Colliers International Florida, LLC

