

# 4,998 SF

Flex Space For Lease



## Prologis Beacon Centre 10



1914 NW 84<sup>th</sup> Avenue  
Doral, FL 33126 USA

### LOCATION

- Easy access to Miami International Airport and PortMiami
- Direct access to SR 836 (Dolphin Expressway), with easy access to SR 826 (Palmetto Expressway), and Florida's Turnpike

### FACILITY

- ±4,998 SF of office available
- 15' Clear height
- Column spacing 30' X 40'
- Parking ratio 3.92:1,000
- Available December 2024

### ADVANTAGES AND AMENITIES

- Beacon Centre is a 205 acre secured master-planned business park located in the heart of the Airport West /Doral submarket.
- Nearby amenities include numerous restaurants, hotels, banks and shopping centers.
- [Prologis Clear Lease](#)<sup>®</sup> – Know your lease expenses and capital cost with greater certainty before your sign.

**Your single-source service for efficient move-in and operations: [prologisessentials.com](https://www.prologisessentials.com)**

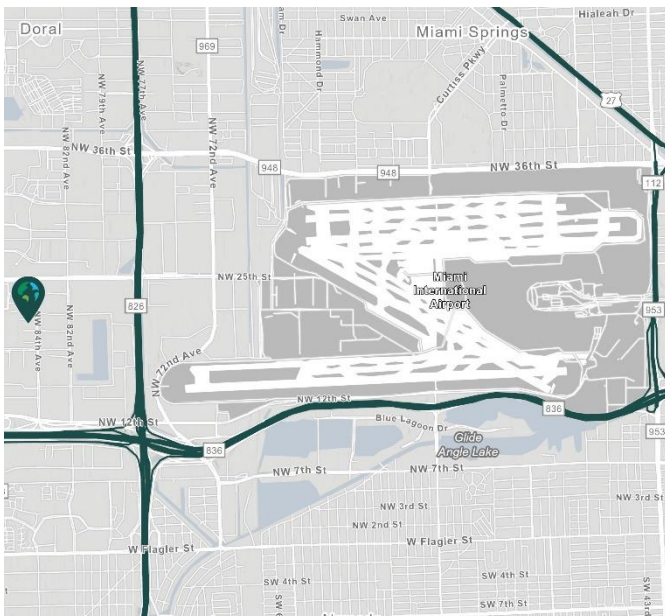

Scan the QR code for more info!

# 4,998 SF

Flex Space For Lease



## Prologis Beacon Centre 10

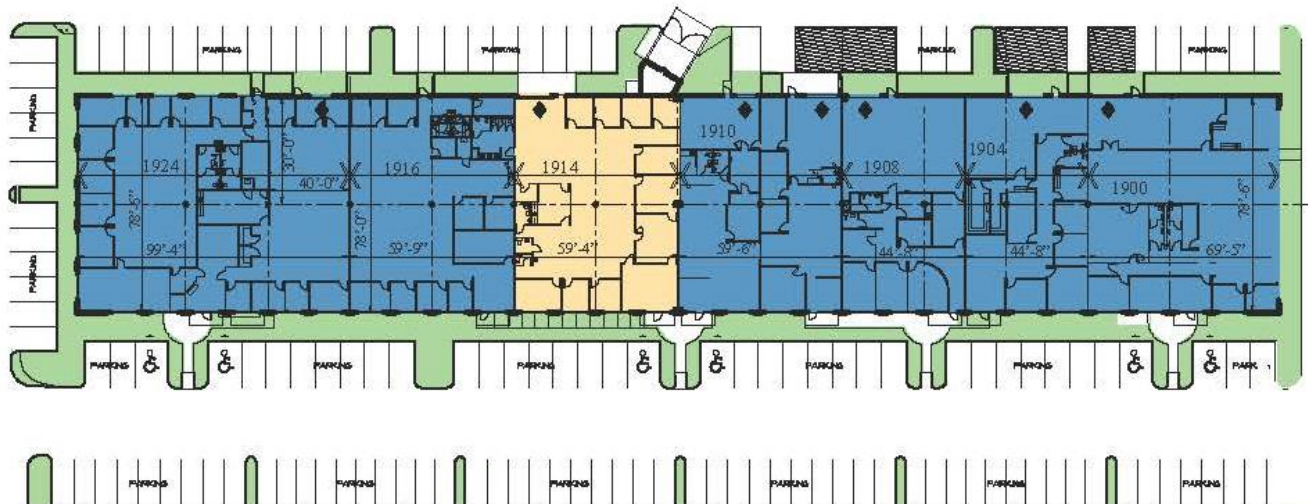

- AVAILABLE
- LEASED
- BACKGROUND LAND
- DOCK DOOR
- DRIVE-IN DOOR



### State Street Realty

George Pino, SIOR  
gpino@statestreetre.com  
ph +1 305 447 3390  
cell +1 786 402 7387  
8319 NW 12 Street  
Doral, FL 33126 USA

### State Street Realty

Brian Cabiellas, SIOR  
bcabiellas@statestreetre.com  
ph +1 305 447 3390  
cell +1 305 606 7109  
8319 NW 12 Street  
Doral, FL 33126 USA

### Prologis

Diana T. Escobar  
descobar@prologis.com  
ph +1 305 599 6221  
8355 NW 12 Street  
Doral, FL 33126 USA