

22 WEST 21

Flatiron District Full Floor New Pre-built Opportunity

11,498 RSF AVAILABLE



[View Full Gallery](#)

Space Highlights

- Entire 4th floor
- 4 Single stalled bathrooms
- 7 Offices
- Glass front offices & conference rooms
- Brand new open pantry
- 2 Elevators
- 2 Freight elevator
- Attended lobby

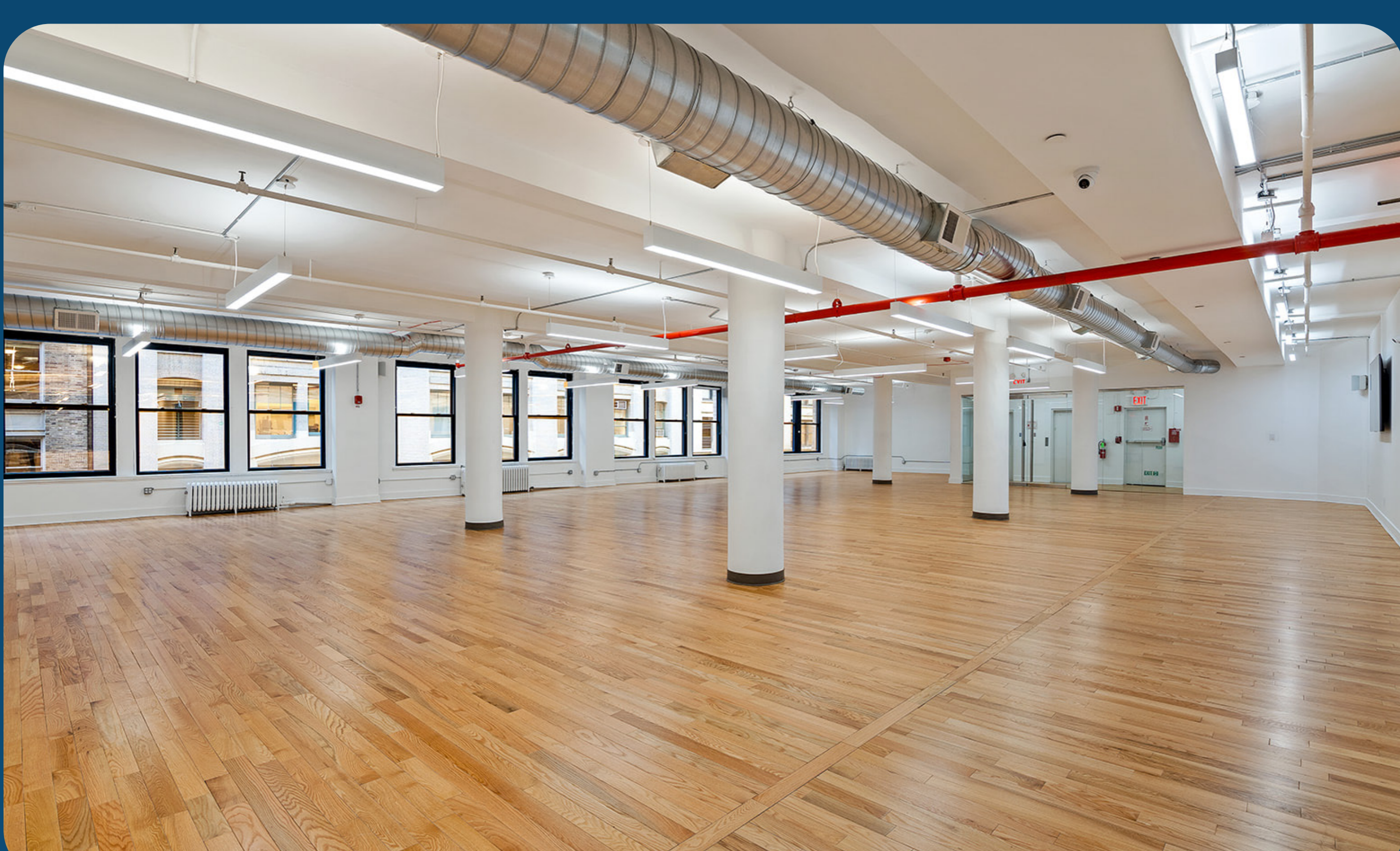

[View Full Gallery](#)

Welcome to the Flatiron District



Full Floor of 11,498 RSF Available

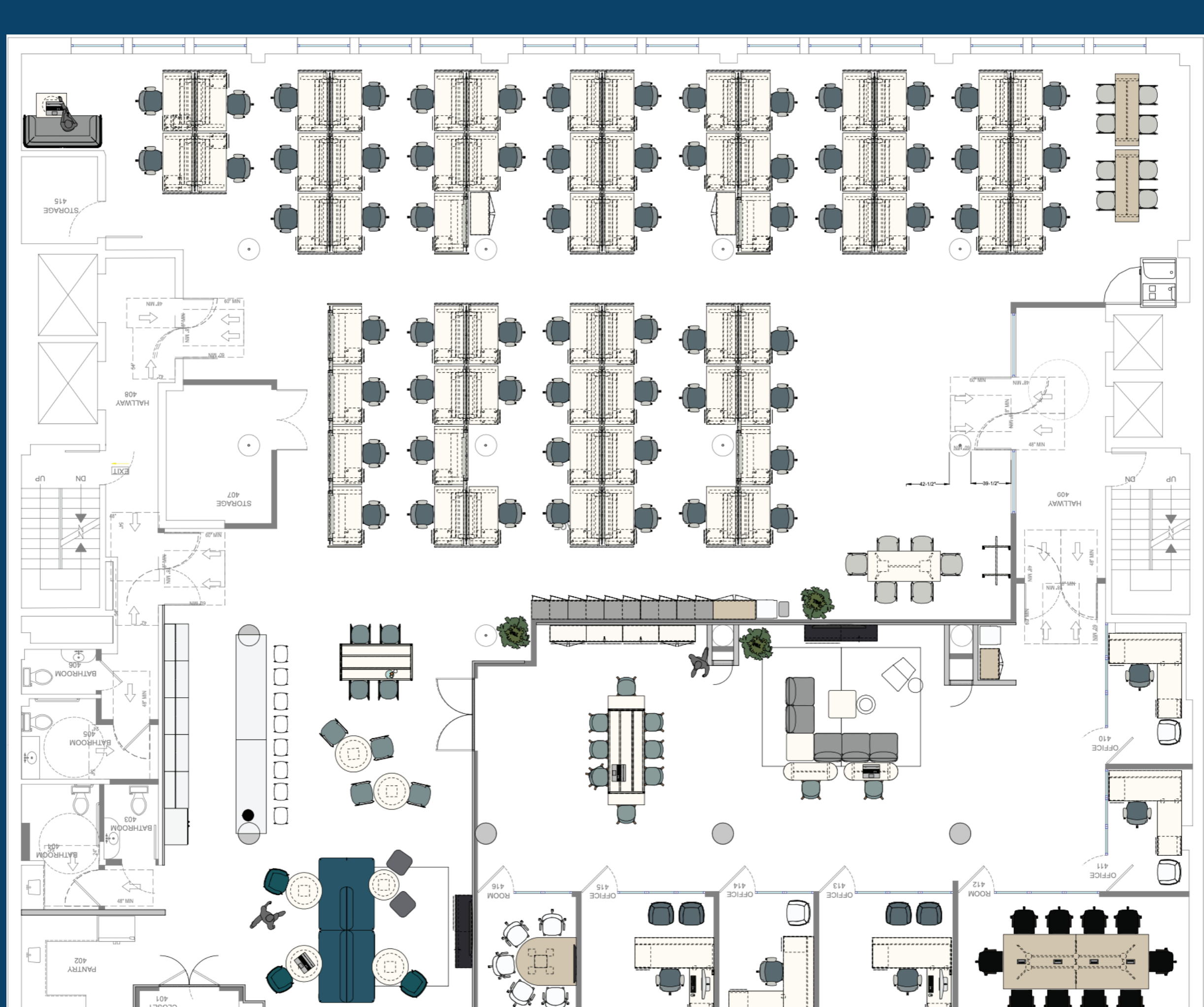

[Download Test-Fit](#)

For leasing information, please contact:

Andre Belgrave
908-812-8029
Andre@RDEadvisors.com

Ali Reslan
212-858-0158
Ali@RDEadvisors.com

Jeremy Birns
201-655-5092
Jeremy@RDEadvisors.com

