

FOR LEASE

1,540-1,870 SF PROFESSIONAL OFFICE AVAILABLE

**LEE &
ASSOCIATES**
COMMERCIAL REAL ESTATE SERVICES
PASADENA

DISCOUNTED RATE UTILITIES INCLUDED!



**790 W Chestnut Ave., #201
Monrovia, CA 91016**

CONTACT



CHRIS JOHNSON

Senior Vice President

chris.johnson@lee-associates.com

626.240.2786

License ID 01934154

All information furnished regarding property for sale, rental or financing is from sources deemed reliable, but no warranty or representation is made to the accuracy thereof and same is submitted to errors, omissions, change of price, rental or other conditions prior to sale, lease or financing or withdrawal without notice. No liability of any kind is to be imposed on the broker herein.

FOR LEASE

1,540-1,700 SF PROFESSIONAL OFFICE AVAILABLE

790

W CHESTNUT AVE., #201

MONROVIA, CA 91016

OFFERING INFORMATION

- + Asking Rate: \$1.60/SF
- + Suite Size | 201: ±1540-1870 SF
- + Total Building SF: ±28,000 SF
- + Year Built: 1982
- + Parking Ratio: 4:1000

PROPERTY HIGHLIGHTS

- + Below Market Asking Rate
- + Move in ready condition
- + Functional layout



FOR LEASE

1,540-1,700 SF PROFESSIONAL OFFICE AVAILABLE

790

W CHESTNUT AVE., #201
MONROVIA, CA 91016

SUITE 201 | FLOOR PLAN

±1,540-1,870 SF

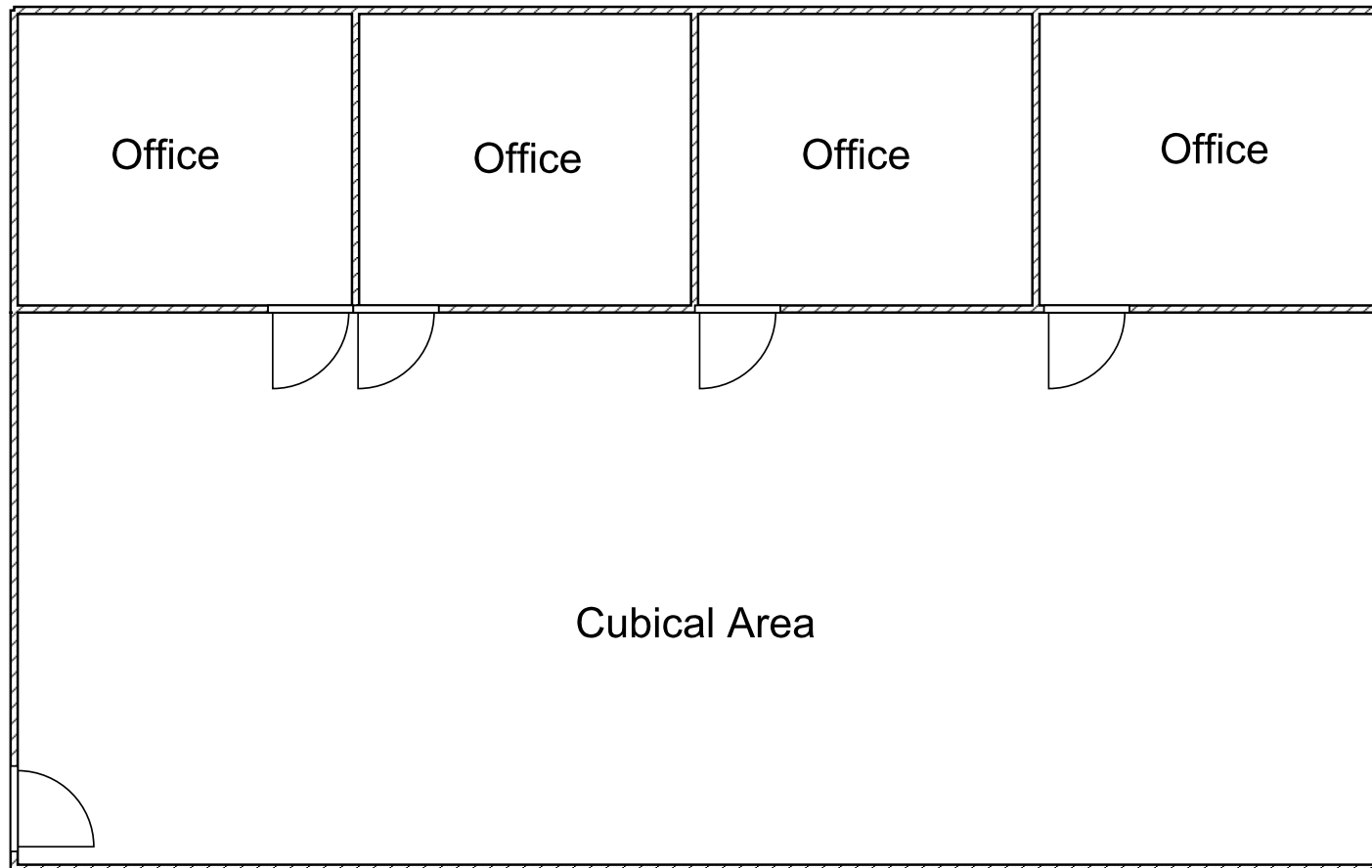

1,540-1,700 SF PROFESSIONAL OFFICE AVAILABLE

790

W CHESTNUT AVE., #201

MONROVIA, CA 91016

- + Great access to the 210 freeway

