

Riverview Commerce Park

10084 East Kemper Road
Symmes Township, Ohio 45140

5,800 Square Feet Total
\$12.00/SF MG for Lease



Property Highlights

5,800 SF of office, divisible to 2,900
Large monument signage facing E. Kemper
Move in ready office space with high ceilings
G-Heavy Industrial ([link to zoning text](#))
Abundant surface parking lot
Located in Symmes Township
Asking \$12.00/SF MG for lease + utilities

Nick Barela
President, Principal
nick.barela@republic-cre.com

Direct: (513) 549-5440
Main: (513) 549-0090
Fax: (513) 549-0070

www.republic-cre.com

Ed Mathis
Vice President
ed.mathis@republic-cre.com

Direct: (513) 549-0440
Main: (513) 549-0090
Fax: (513) 549-0070

www.republic-cre.com



REPUBLIC
COMMERCIAL REAL ESTATE

Office - Warehouse Plan (1st Floor)

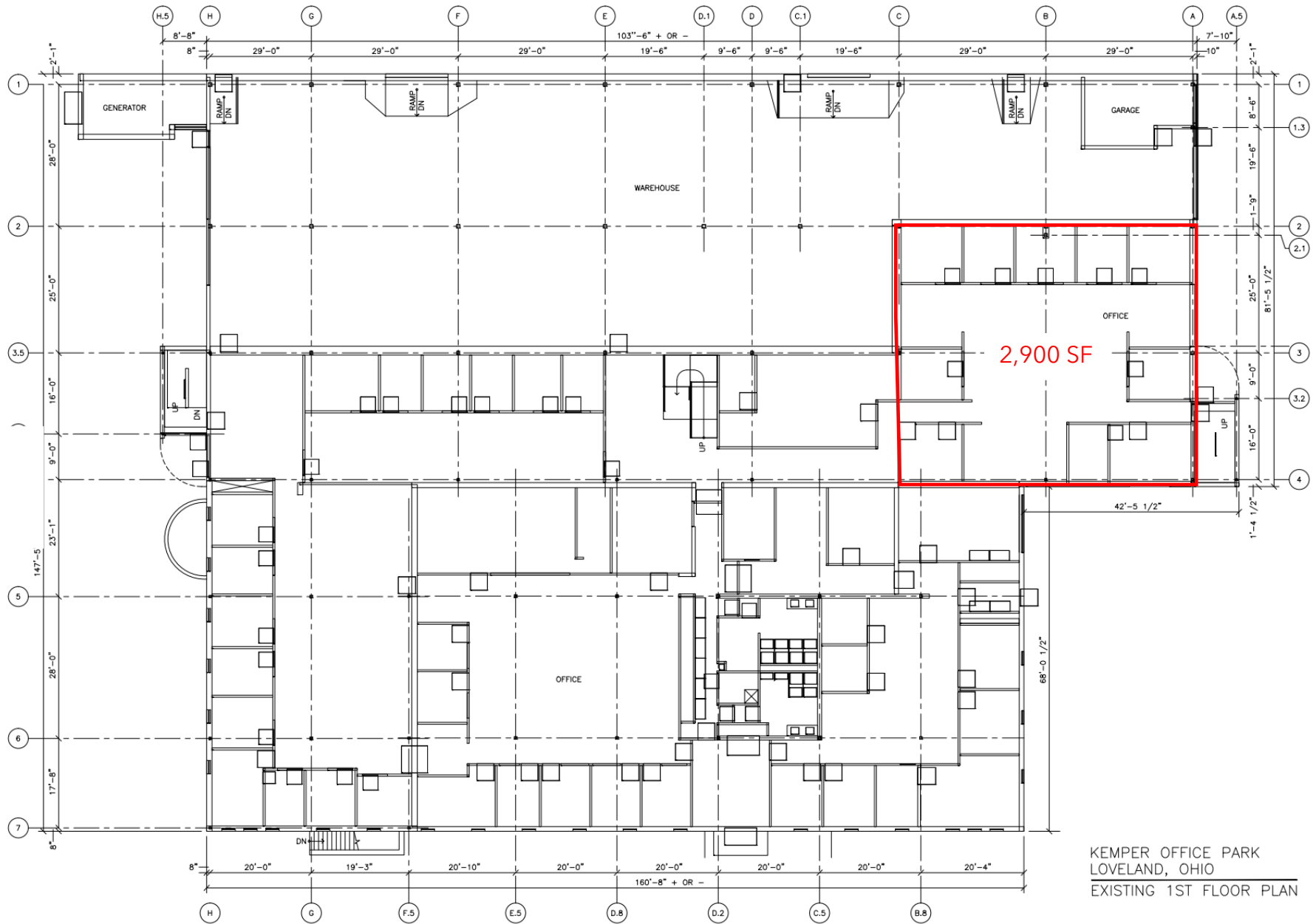

Office Floor Plan (2nd Floor)

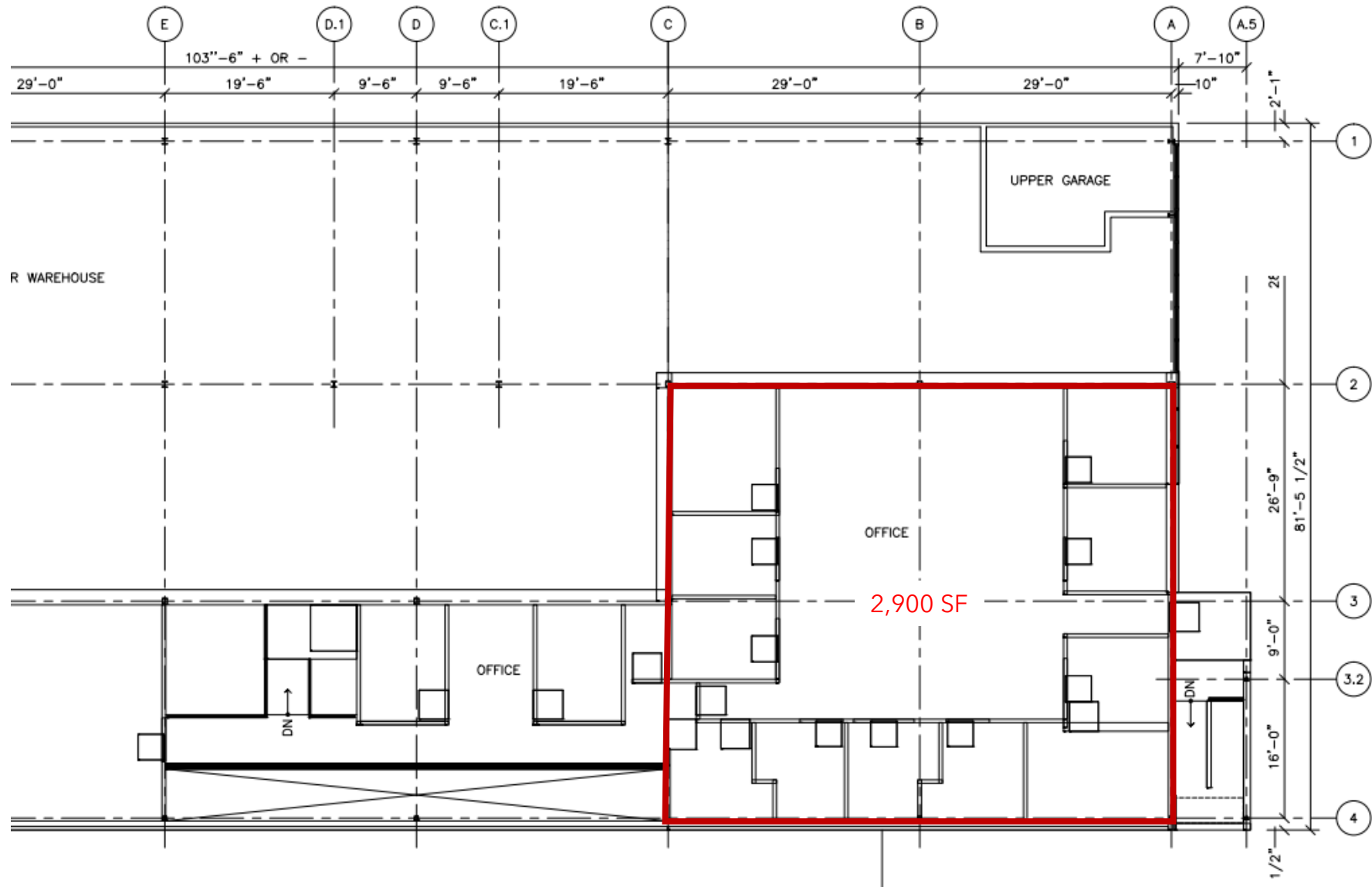

2,900 SF of office meeting space (available separately)

10084 East Kemper Photos



Demographic Information

Location Facts & Demographics

Demographics are determined by a 10 minute drive from 10084 E Kemper Rd, Loveland, OH 45140



INCOME BY HOUSEHOLD

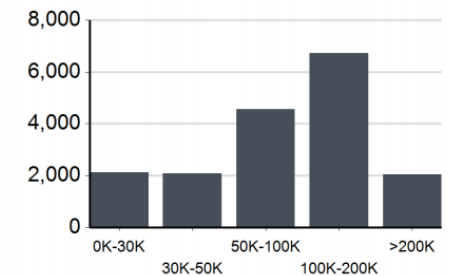

HH SPENDING

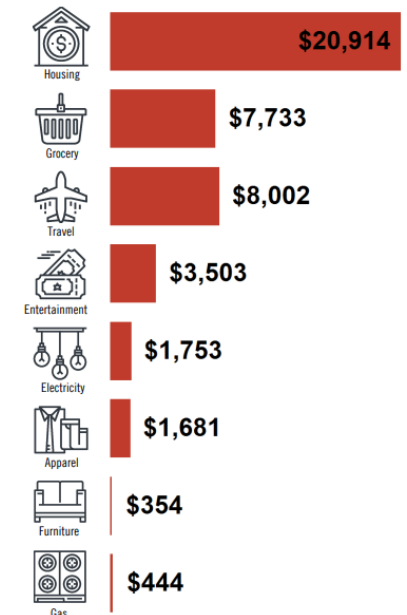

CITY, STATE

Loveland, OH

POPULATION

38,872

AVG. HH SIZE

2.64

MEDIAN HH INCOME

\$98,246

HOME OWNERSHIP



EMPLOYMENT

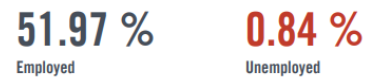
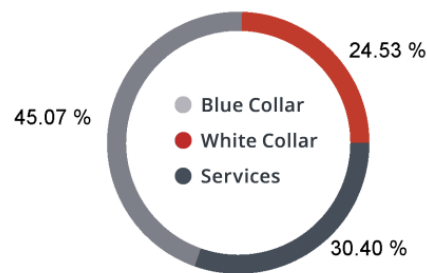

EDUCATION

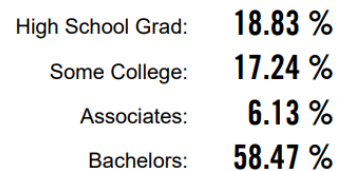

GENDER & AGE

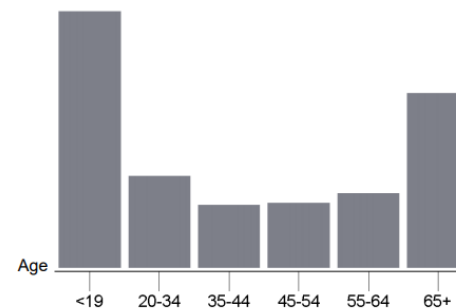

RACE & ETHNICITY

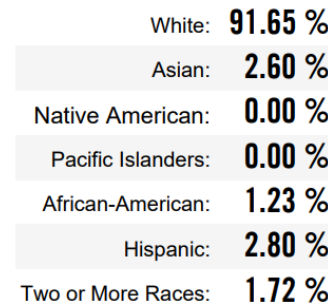

This information supplied herein is from sources we deem reliable. It is provided without any representation, warranty or guarantee, expressed or implied as to its accuracy. Prospective Buyer or Tenant should conduct an independent investigation and verification of all matters deemed to be material, including, but not limited to, statements of income and expenses. Consult your attorney, accountant, or other professional advisor.

Loveland Riverview Office Park

MOOG	SPACE FOR LEASE
LOVELAND Music Academy	MR DEMO Cincinnati · Dayton · Louisville · Columbus

10084 E. Kemper Rd.



A map of the Loveland, Ohio area, highlighting the location of 10084 E. Kemper Rd. The map shows major roads like I-75, I-275, and US-22, as well as local landmarks such as Bethesda North Hospital, Castle Skateland, and the Oasis Conference Center. A red pin marks the specific address.

<p>Nick Barela President, Principal nick.barela@republic-cre.com</p> <p>Direct: (513) 549-5440 Main: (513) 549-0090 Fax: (513) 549-0070</p> <p>www.republic-cre.com</p>	<p>Ed Mathis Vice President ed.mathis@republic-cre.com</p> <p>Direct: (513) 549-0440 Main: (513) 549-0090 Fax: (513) 549-0070</p> <p>www.republic-cre.com</p>	 <p>REPUBLIC COMMERCIAL REAL ESTATE</p>
---	---	---