



For lease

4206 N 68th St, Tampa, FL 33610

3,032 SF warehouse | 2,105 SF office
3.27 AC of industrial outdoor storage

 **JLL** SEE A BRIGHTER WAY

Highlights

| | | | |
|----------------------|--|------------------|--|
| Available | January 1, 2026 | Warehouse | 3,032 SF |
| Total SF | 5,137 SF | Loading | Four (4) grade-level doors |
| Acres | 3.27 AC | Office | 2,105 SF |
| Site Features | <ul style="list-style-type: none">• 800ft of linear frontage on I-4• Monument signage on I-4• 7,000V electric fence surrounding property• 0.3 miles from MLK Jr/I-4 interchange | | |
| | | Features | <ul style="list-style-type: none">• Six (6) private offices• One (1) conference room• Reception area• Two (2) restrooms |



Floor plans

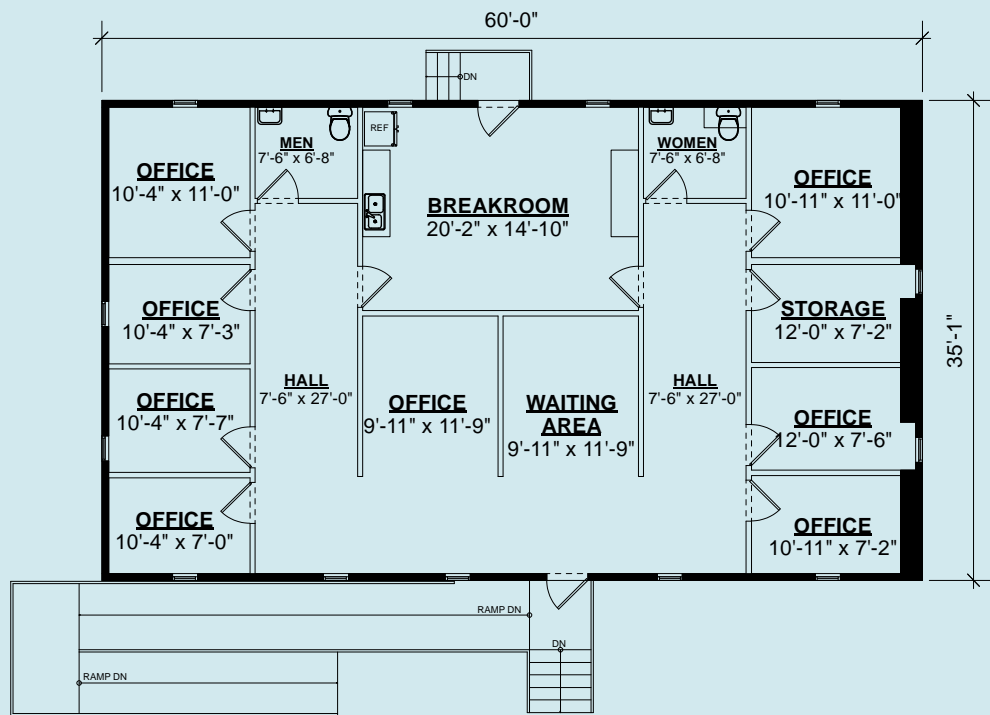

Office 2,105 SF

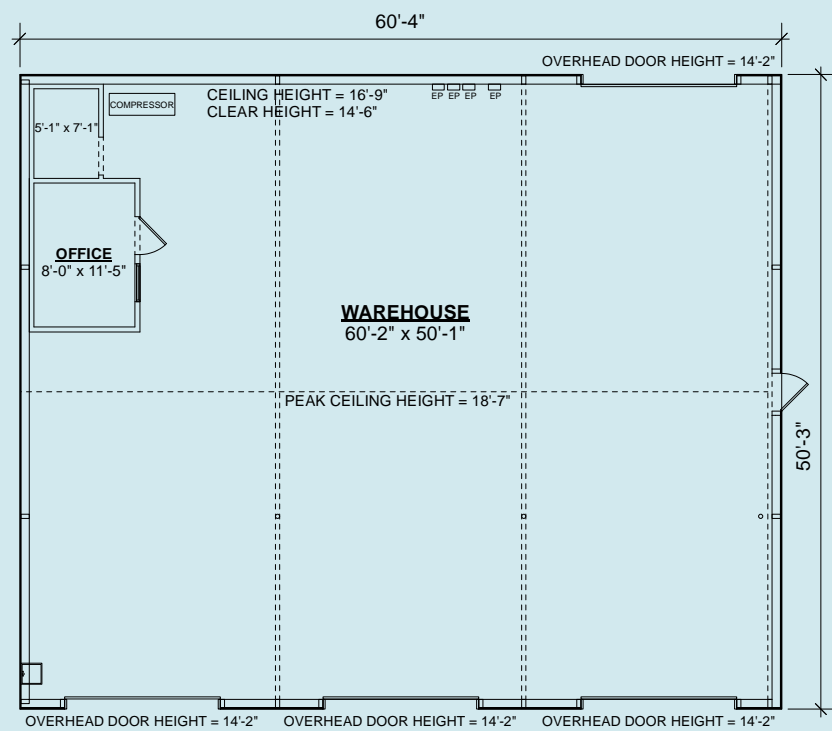

Warehouse 3,032 SF

Access map



Location map

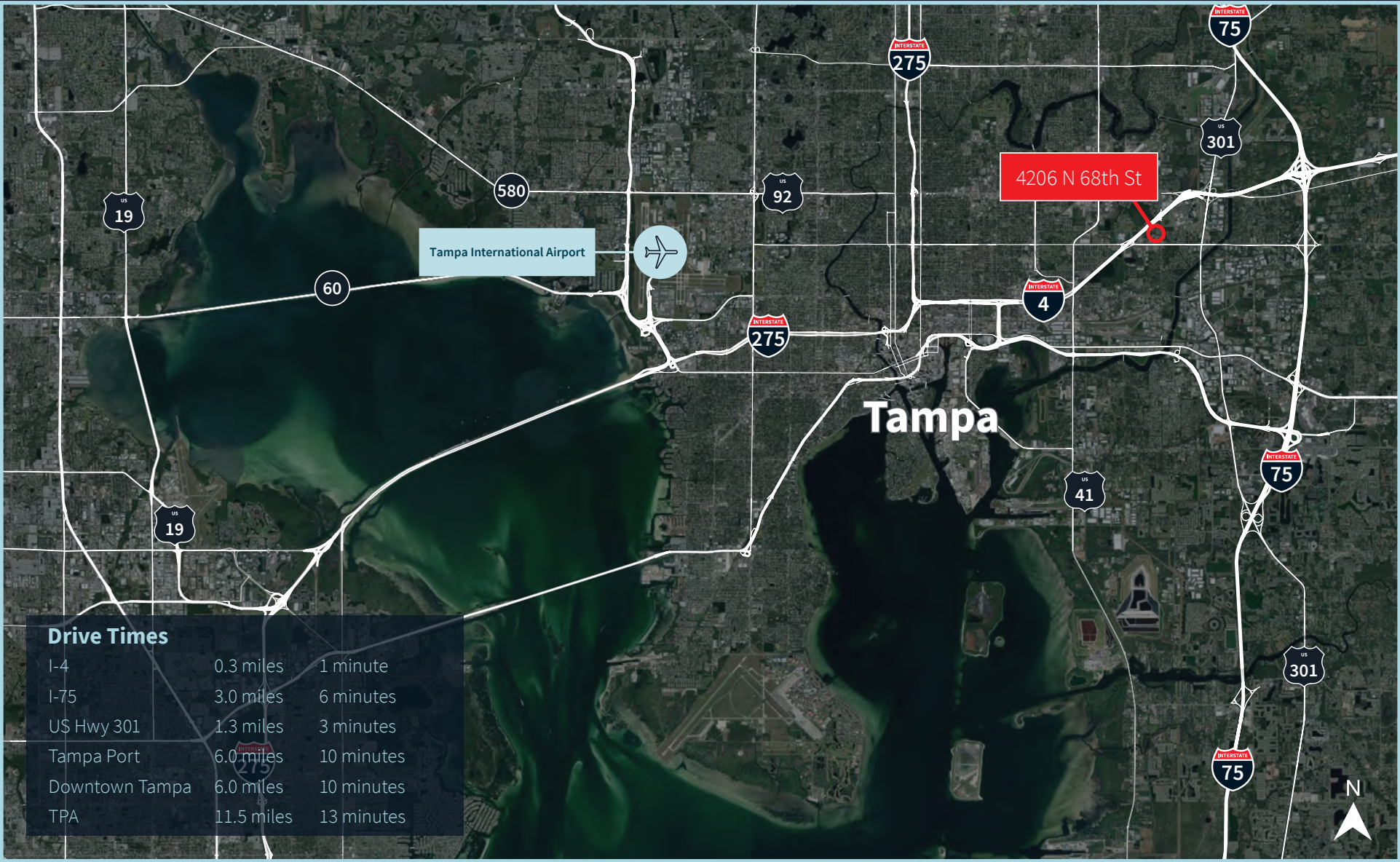

Contact:**Harrison Pithers***Associate*

+1 813 610 0239

harrison.pithers@jll.com

Olivia Brock*Associate*

+1 813 387 1320

olivia.brock@jll.com