

VENTURE COMMERCE CENTER

42225 REMINGTON AVENUE, UNIT A-3, TEMECULA, CA 92590

AVAILABLE FOR LEASE

±2,853 SF INDUSTRIAL CONDOMINIUM



FOR MORE INFORMATION, PLEASE CONTACT:

CAREY PASTOR | Senior Vice President

(951) 297-7434 | cpastor@cbcsocalgroup.com

CalDRE License # 01403298



**COLDWELL BANKER
COMMERCIAL**
SC

VENTURE COMMERCE CENTER

42225 REMINGTON AVENUE, UNIT A-3, TEMECULA, CA 92590

AVAILABLE FOR LEASE
±2,853 SF INDUSTRIAL CONDOMINIUM

PROPERTY HIGHLIGHTS

- ±2,853 SF industrial space available for lease
- Modern architecture design
- Floor plan includes: Reception, 1 private office, restroom and warehouse
- 10'w x 12'h front loading roll-up door
- 18' warehouse clear height
- FIOS enabled
- Offered for Lease at \$3,892.00 Base Rent + \$530.00 OA Fee per month



VENTURE COMMERCE CENTER

42225 REMINGTON AVENUE, UNIT A-3, TEMECULA, CA 92590

AVAILABLE FOR LEASE
±2,853 SF INDUSTRIAL CONDOMINIUM

SITE PLAN AND FLOOR PLAN

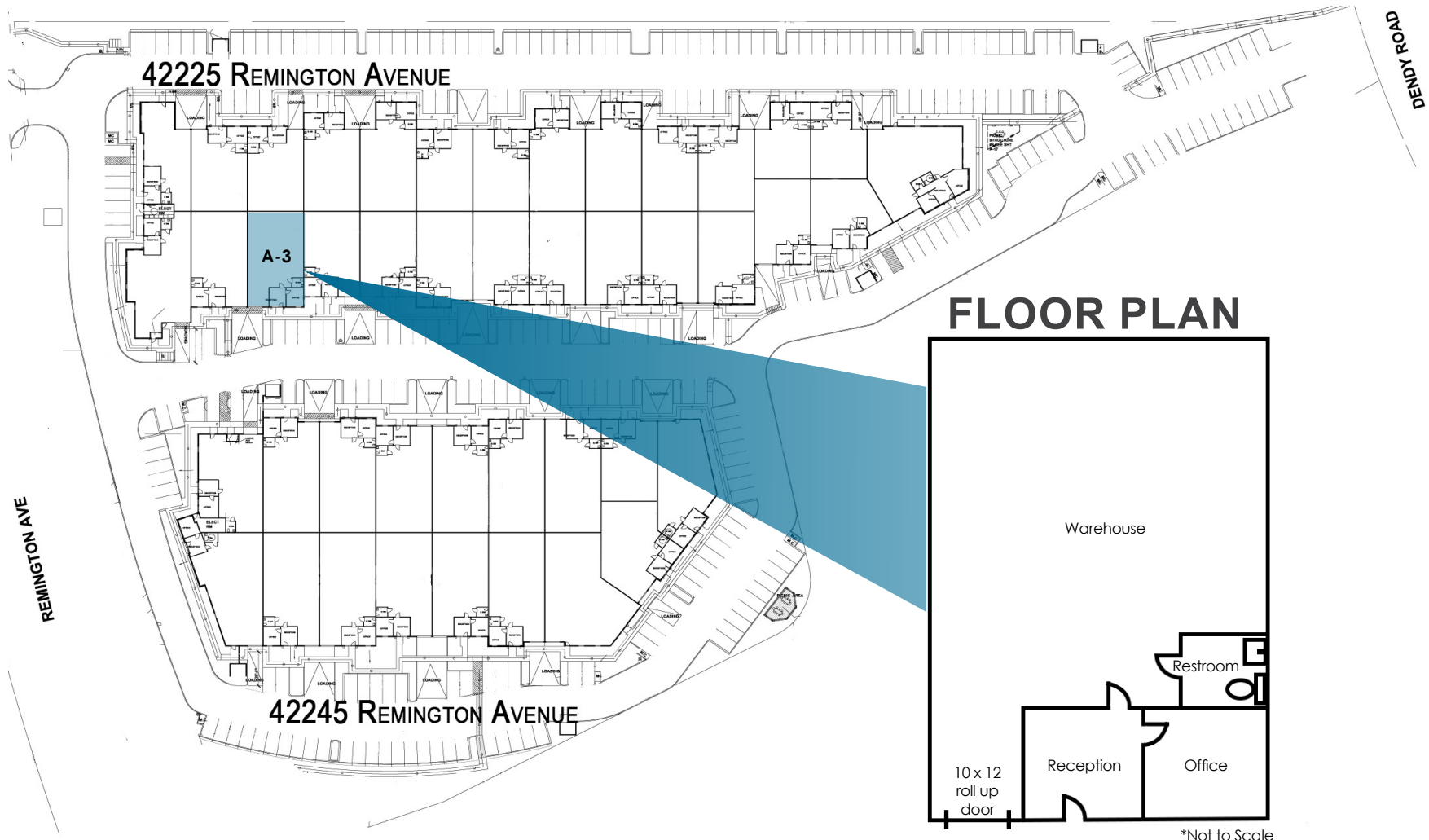

VENTURE COMMERCE CENTER

42225 REMINGTON AVENUE, UNIT A-3, TEMECULA, CA 92590

AVAILABLE FOR LEASE
±2,853 SF INDUSTRIAL CONDOMINIUM

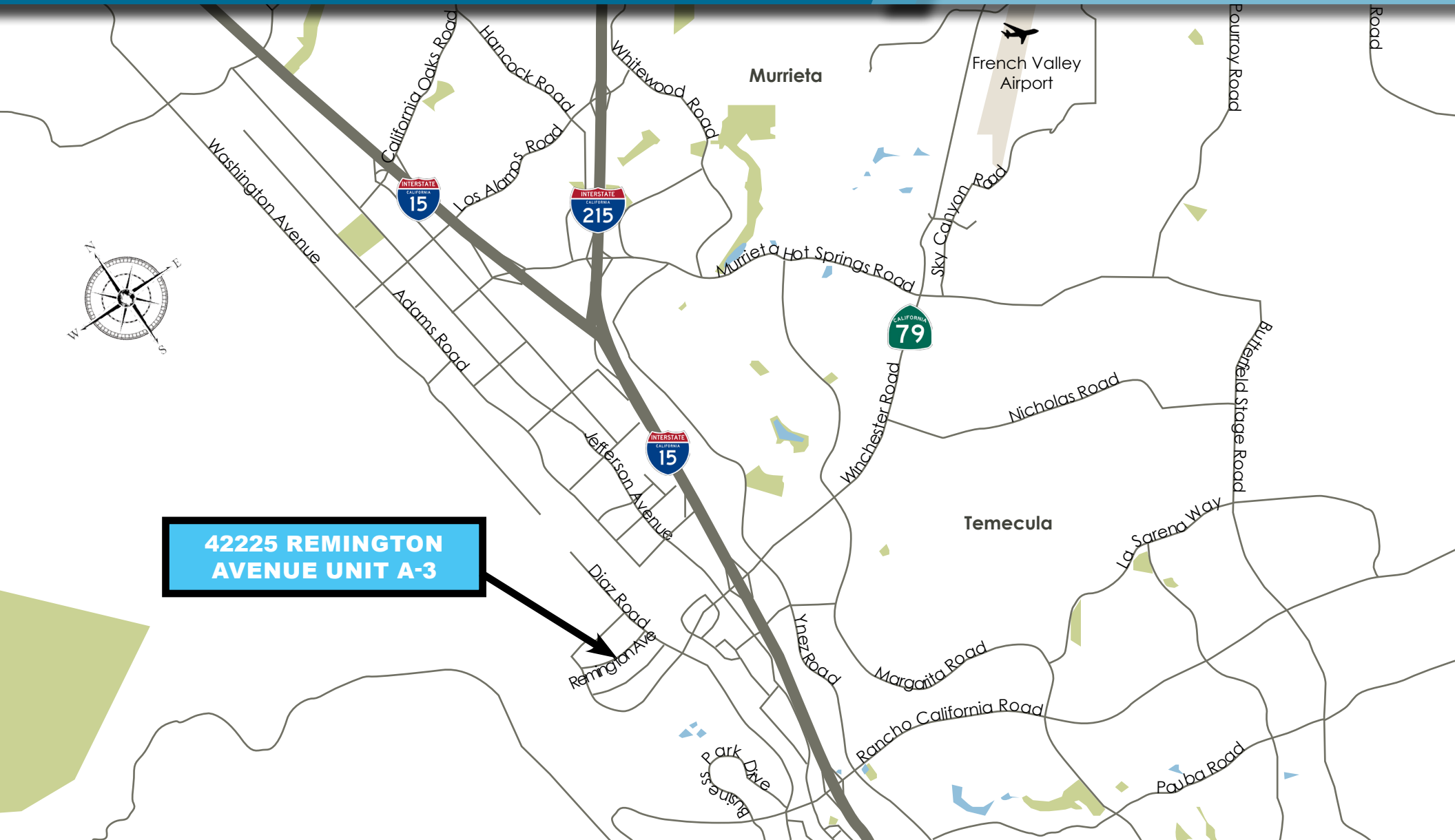

VENTURE COMMERCE CENTER

42225 REMINGTON AVENUE, UNIT A-3, TEMECULA, CA 92590

AVAILABLE FOR LEASE
±2,853 SF INDUSTRIAL CONDOMINIUM



FOR MORE INFORMATION, PLEASE CONTACT:

CAREY PASTOR

Senior Vice President

951.297.7434

cpastor@cbcsocalgroup.com

CalDRE # 01403298

27368 Via Industria | Suite 102
Temecula | California | 92590
t 951.200.7683 | f 951.239.3147
cbcsocalgroup.com



**COLDWELL BANKER
COMMERCIAL**
SC