

Plat of 3rd West Addition to the Village of St. Maries, Idaho

Scale: 100ft. to 1 inch. Surveyed June 10, 1907, by O.H. TODD, Licensee of Surveyor.

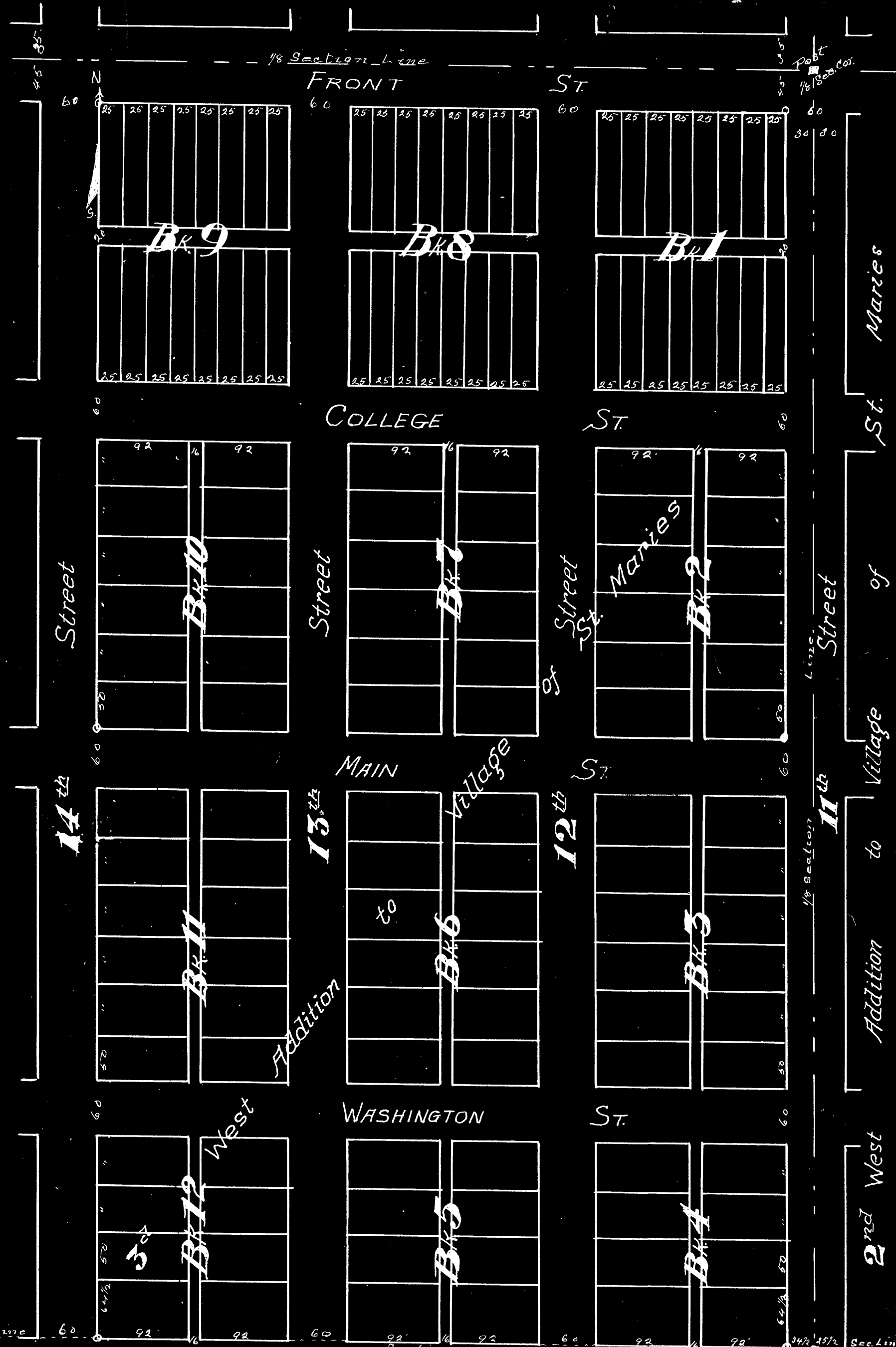

Filed Russell
31 July 7 9 14
Plat 143
T. A. Charles

Know all men by these presents that the St. Maries Land Company, a corporation, the terms of that portion of the South-west quarter of the South-east quarter of Section 29, Township 46 N. R. 6 E. 10 W. as shown on the attached plat of 3rd West Addition to the Village of St. Maries, Idaho, have hereby covenanted and dedicated to the use of the general public for school purposes, all the streets, avenues and alleys indicated on the attached plat of said 3rd West Addition. In witness whereof the said corporation has caused its name and seal to be affixed to this 27th day of July, 1907.

Attest:
C. W. Speck, Secretary
Seal
Notary Public
County of Kootenai, Idaho. On this 27th day of July, 1907, before me William F. Sargent a notary public personally appeared Ford G. Russell known to me the said notary public to be the president of the corporation that executed the above covenanted and acknowledged these 3rd West Addition to the Village of St. Maries, Idaho, for approval and that the same was lawfully and lawfully executed and that the same were duly and lawfully approved. In witness whereof I have hereunto set my hand and official seal this 27th day of July, 1907.

William F. Sargent, Notary Public
I, Thomas C. Webb, Village Clerk
I, Alvin A. Todd, Licensed Land Surveyor of the State of Idaho, hereby certify that the above plat is correct and in accordance with a survey made by me in June, 1907, and that it is identical in the East half of the South-east quarter (1/4) of Section 29, Township 46 N., Range 6 E., 10 W., Boise Meridian, being in Kootenai County, Idaho. Since worked & run out at all corners marked on this plat.
Alvin A. Todd, Licensed Surveyor, July 23, 1907.

Town of Spirit Lake, Idaho, on the I & N.W. Railroad

Part of Sections 5 & 6, Kootenai Co., Idaho



Filed Russell
31 July 7 9 14
Plat 143
T. A. Charles

Know all men by these presents that the Spirit Lake Land Co., a corporation, duly organized and existing under and by virtue of the laws of the State of Idaho, has caused to be filed in the office of the County Clerk of Kootenai County, Idaho, a certain plat of land, the terms of which are as follows: All of the South-west quarter of Section 5, Township 46 N., Range 6 E., 10 W., Idaho, a part of the North-west quarter of said Section 5, Township 46 N., Range 6 E., 10 W., Idaho, as shown on the attached plat of said Spirit Lake, Idaho, have hereby covenanted and dedicated to the use of the general public for school purposes, all the streets, avenues and alleys indicated on the attached plat of said Spirit Lake, Idaho. In witness whereof the said corporation has caused its name and seal to be affixed to this 27th day of July, 1907.

Attest:
C. W. Speck, Secretary
Seal
Notary Public
County of Kootenai, Idaho. On this 27th day of July, 1907, before me William F. Sargent a notary public personally appeared Ford G. Russell known to me the said notary public to be the president of the corporation that executed the above covenanted and acknowledged these Spirit Lake, Idaho, for approval and that the same was lawfully and lawfully executed and that the same were duly and lawfully approved. In witness whereof I have hereunto set my hand and official seal this 27th day of July, 1907.

William F. Sargent, Notary Public
I, Thomas C. Webb, Village Clerk
I, Alvin A. Todd, Licensed Land Surveyor of the State of Idaho, hereby certify that the above plat is correct and in accordance with a survey made by me in June, 1907, and that it is identical in the East half of the South-east quarter (1/4) of Section 5, Township 46 N., Range 6 E., 10 W., Boise Meridian, being in Kootenai County, Idaho. Since worked & run out at all corners marked on this plat.
Alvin A. Todd, Licensed Surveyor, July 23, 1907.