



**A RETAIL LEASING OPPORTUNITY:**

---

# Wall Street Place

---

**61 WALL STREET, NORWALK CT**



**HATHAWAY**



CONTACT 203.814.3361 • [RENTALS@HATHAWAYPM.COM](mailto:RENTALS@HATHAWAYPM.COM)  
HATHAWAY, INC. • 1387 SEAVIEW AVENUE, BRIDGEPORT, CT 06607 • [HATHAWAYPM.COM](http://HATHAWAYPM.COM)

## RETAIL SPACE M

Scale = 1/16" = 1'-0"

- 13,698 NSF

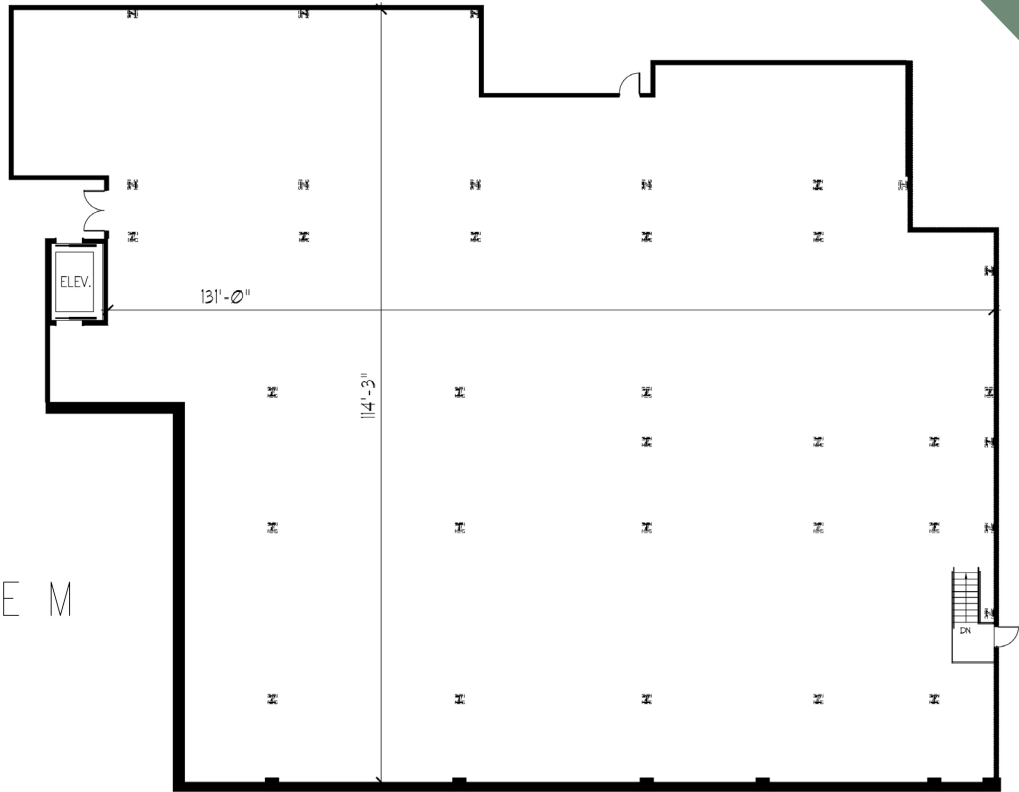

**County:** Fairfield

**City:** Norwalk

**Available S.F.:** 13,698

**Terms:** \$15/S.F. NNN

**Lease Length Desired:** 3-5 years

**Availability:** July 2026

### PROPERTY OVERVIEW:

Available for lease in 2026, "Suite M" is a lower-level space with 13,698 S.F. There are a variety of designed possibilities in the space, including a potential fitness center or storage facility. Enjoy flexibility with a three to five-year lease. Employee and customer parking is available in the convenient Art Park Lot as well as on-street parking.

### LOCATION OVERVIEW:

Wall Street Place is close to the Norwalk Public Library, Norwalk Post Office, the Wall Street Theater and Freese Park, as well as public transportation to easily access other parts of the city and region. Residents will benefit from the City of Norwalk's investment in the surrounding area, including safer intersections, wider sidewalks, public outdoor event spaces, outdoor dining spaces, bike and walking trail connections, and increased street parking. For additional information about Norwalk's Renaissance, please visit [Norwalkct.gov/3207/Project-Design-Status](http://Norwalkct.gov/3207/Project-Design-Status).



CONTACT 203.814.3361 • [RENTALS@HATHAWAYPM.COM](mailto:RENTALS@HATHAWAYPM.COM)

HATHAWAY, INC. • 1387 SEAVIEW AVENUE, BRIDGEPORT, CT 06607 • [HATHAWAYPM.COM](http://HATHAWAYPM.COM)



**HATHAWAY**

WALL  
STREET  
PLACE