

# FOR SALE | Vineyards Christian Fellowship Church



Offered at: \$1,400,000  
Available: 42,201 SF

221 East Martin Luther King Junior Boulevard  
Yakima, WA 98901

218 S Sgt Pendleton Way 509.966.3800: O  
Yakima, WA 98901 509.969.8747: C

Chris Sentz  
csentz@almoncommercial.com

# Executive Summary

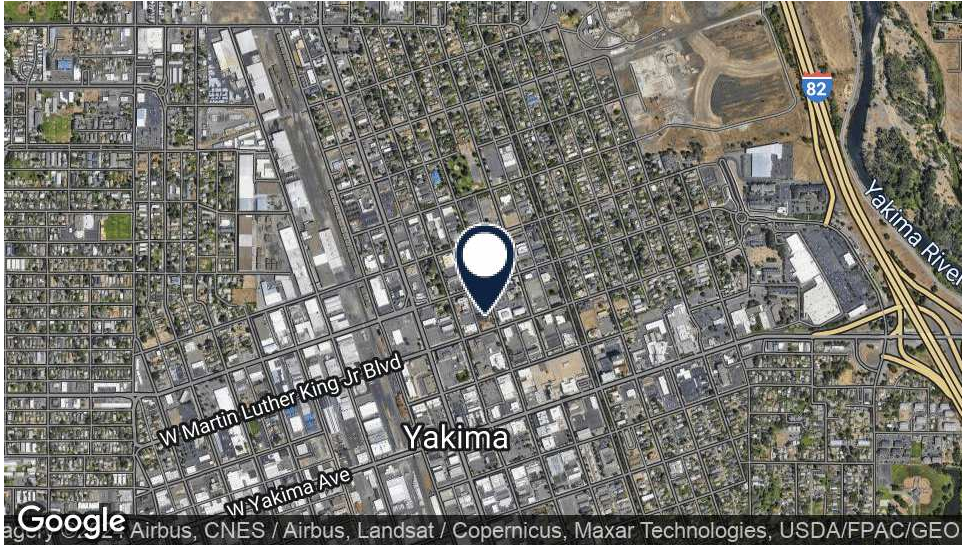

## OFFERING SUMMARY

Sale Price:	\$1,400,000
Building Size:	42,201SF
Lot Size:	0.52 acres
Price / SF:	\$33.17
Year Built:	1908
Zoning:	Commercial

## PROPERTY OVERVIEW

THIS OFFERING is for the opportunity to purchase a historic building with timeless charm and character. Constructed in 1908 this property offers ample space for congregations or community gatherings, multiple large classrooms, private offices, full commercial kitchen, coffee shop, theater area with stage, full basement with workshop and small apartment. Constructed from stone and brick the building includes its original grand stained-glass windows and tile roof. Conveniently located in the heart of downtown Yakima, this property provides ready access to many of Yakima’s sought after amenities.

Whether looking to grow your congregation or use this historic building as your blank canvas, this building provides potential for renovation and customization to meet your needs.

# Highlights



## PROPERTY HIGHLIGHTS

- Centrally located in downtown with good visibility and easy access to public transportation
- Impressive auditorium/sanctuary capable of seating 300
- Commercial zoning provide for numerous uses including retail trade, office, community service and health and social services
- Walking distance to public parking, numerous popular restaurants, tasting rooms, coffee houses, etc.
- Seller financing available for qualified buyers
- Basement 15,589 SF, School 17,463 SF, Church 6,858 SF, Balcony 1,400 SF, Upstairs Offices 720 SF (Approximate Sizes)

## DEMOGRAPHICS

	0.3 MILES	0.5 MILES	1 MILE
Total Households	421	1,770	5,587
Total Population	1,156	4,713	16,698
Average HH Income	\$46,162	\$44,510	\$46,315

# Floor Plan - Main Floor

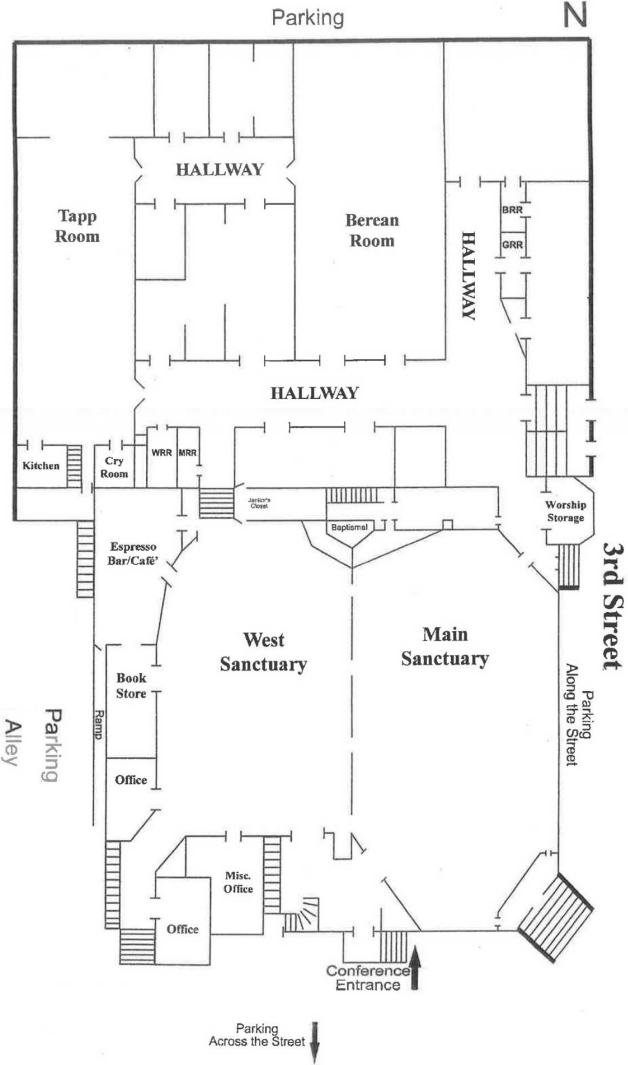

# Floor Plan - Basement & Third Floor

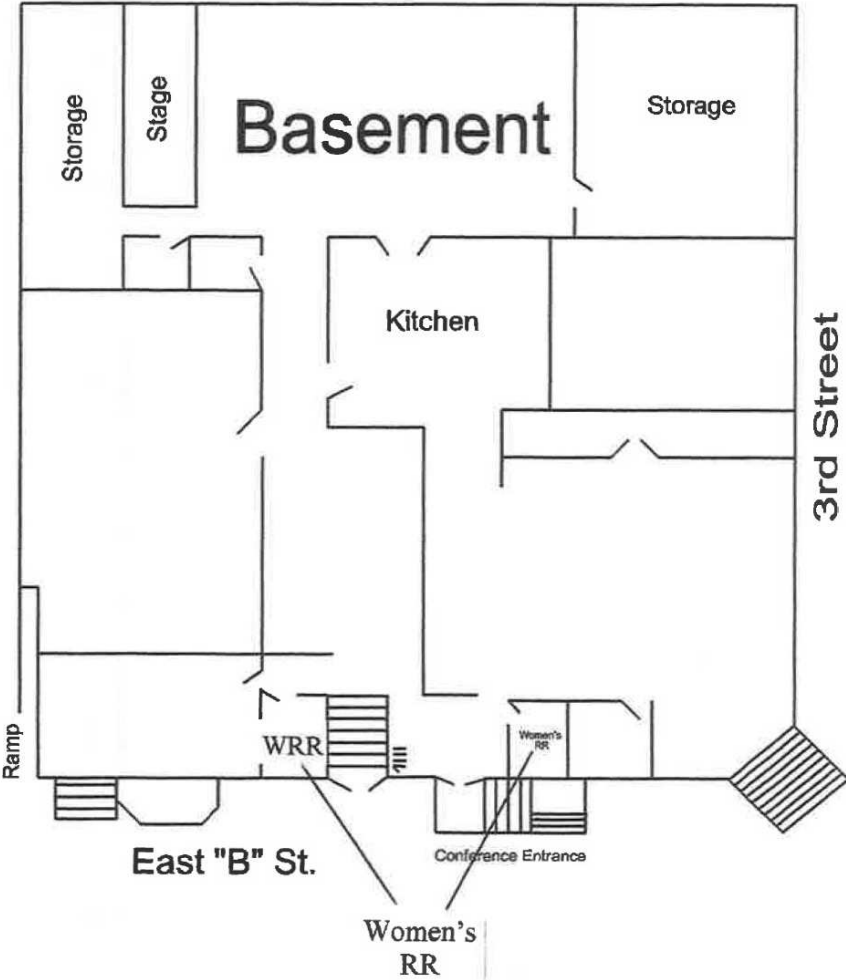
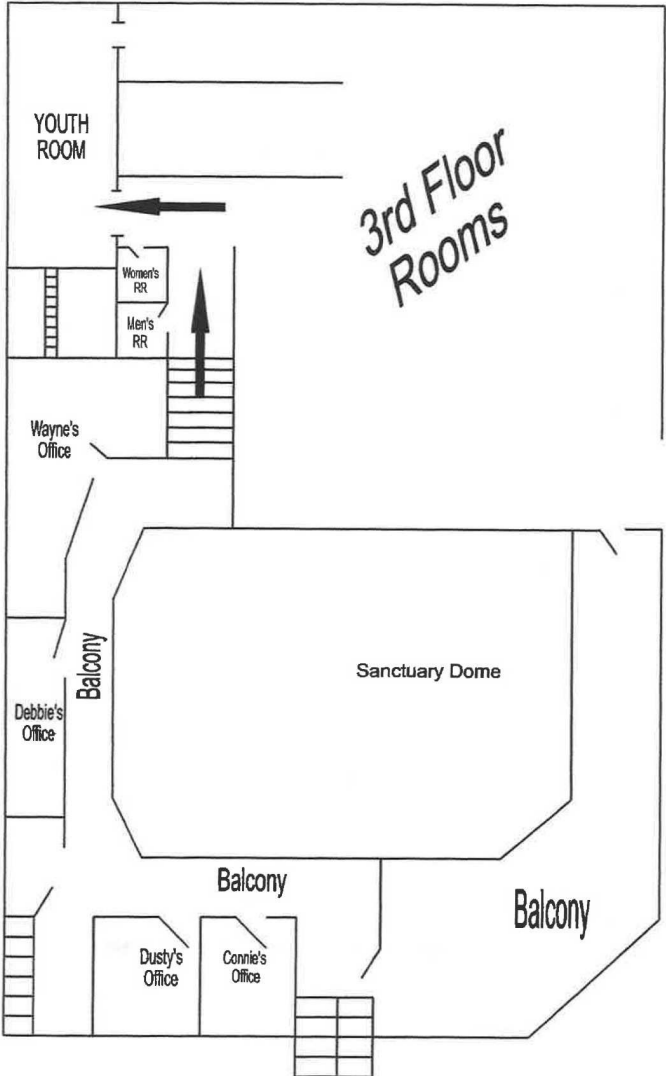

---

## Additional Photos

---



## Additional Photos

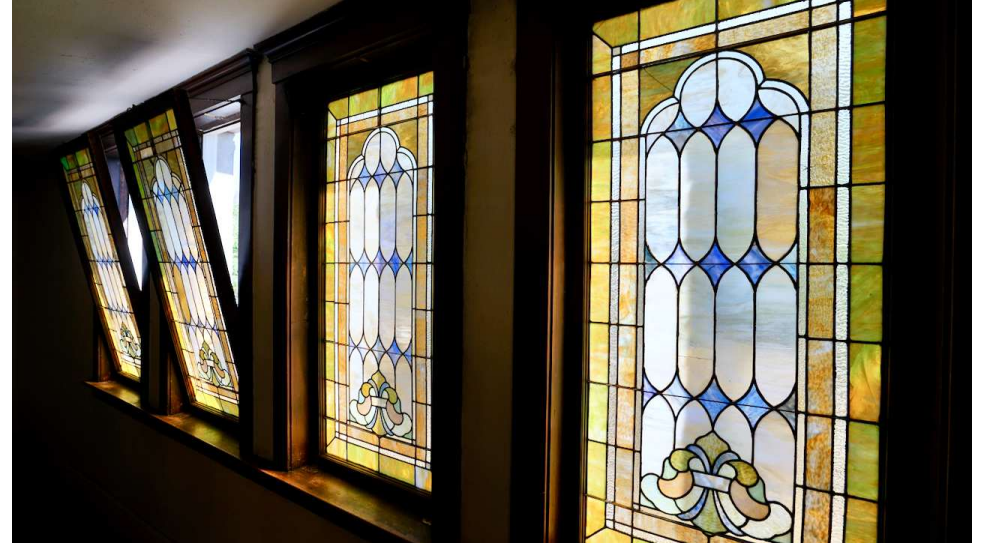

---

## Meet The Team

---



**CHRIS SENTZ**

Broker

**Direct:** 509.966.3800 **Cell:** 509.969.8747  
csentz@almoncommercial.com