

FOR LEASE

Historic Church located between the Hawthorne & Richmond Neighborhoods

1975 SE 30th Avenue, Portland, OR
Corner of SE 30th Avenue & SE Harrison Street



Historic Colonial Heights Church Building and Grounds For Lease

26,222+/- Square Feet | Call Broker for Lease Rate

- Church facility available with large campus and off-street parking
- Located in a residential neighborhood of Close-in SE Portland
- Ideal opportunity for religious institution, private school, childcare, or performing arts center

DANIEL SILVEY, CCIM, MRED, MBA

Commercial Real Estate Broker Licensed in OR & WA

Investment Sales & Commercial Leasing

📞 503-201-8537

✉️ danielsilvey@kniperealty.com

FOR LEASE

Historic Church located between the Hawthorne & Richmond Neighborhoods

1975 SE 30th Avenue, Portland, OR
Corner of SE 30th Avenue & SE Harrison Street



Pristine Historic Church Facility For Lease

- Large stunning chapel plus a secondary performance auditorium with stage.
- Over 20 classrooms/meeting rooms of various sizes.
- Administrative office space.
- Large Commercial Kitchen and one smaller service kitchen.
- 56 parking spaces.
- Facilities are professionally managed and move-in ready.
- Built 1929.
- 1.83 acre beautifully landscaped campus with prominent corner location.
- New Boiler and Heating Systems.

FOR LEASE

Historic Church located between the Hawthorne & Richmond Neighborhoods

1975 SE 30th Avenue, Portland, OR
Corner of SE 30th Avenue & SE Harrison Street

Floor Plan Upper Level

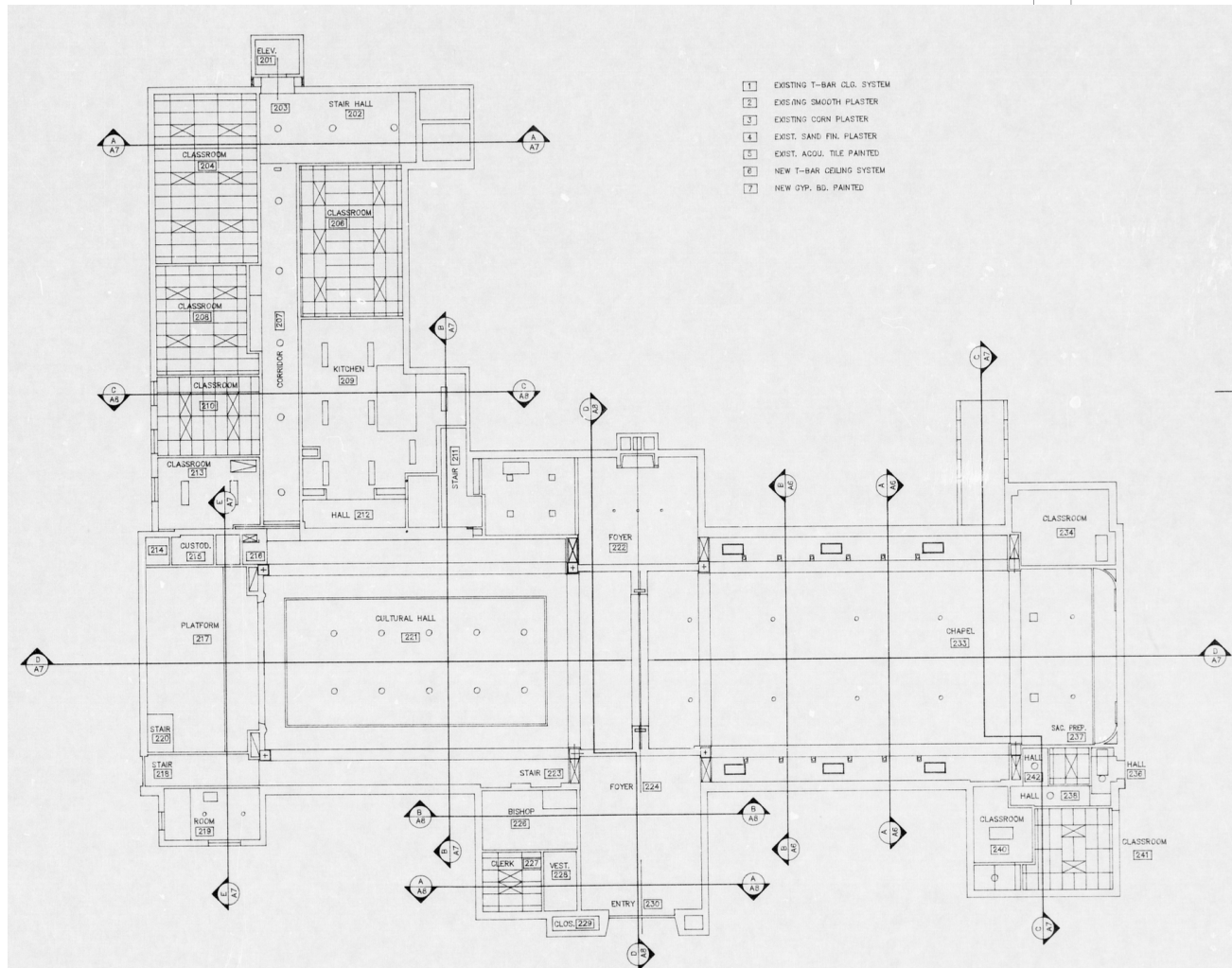

DANIEL SILVEY, CCIM, MRED, MBA
Commercial Real Estate Broker Licensed in OR & WA
Investment Sales & Commercial Leasing

503-201-8537
danielsilvey@kniperealty.com



FOR LEASE

Historic Church located between the Hawthorne & Richmond Neighborhoods

1975 SE 30th Avenue, Portland, OR
Corner of SE 30th Avenue & SE Harrison Street

Floor Plan
Lower Level

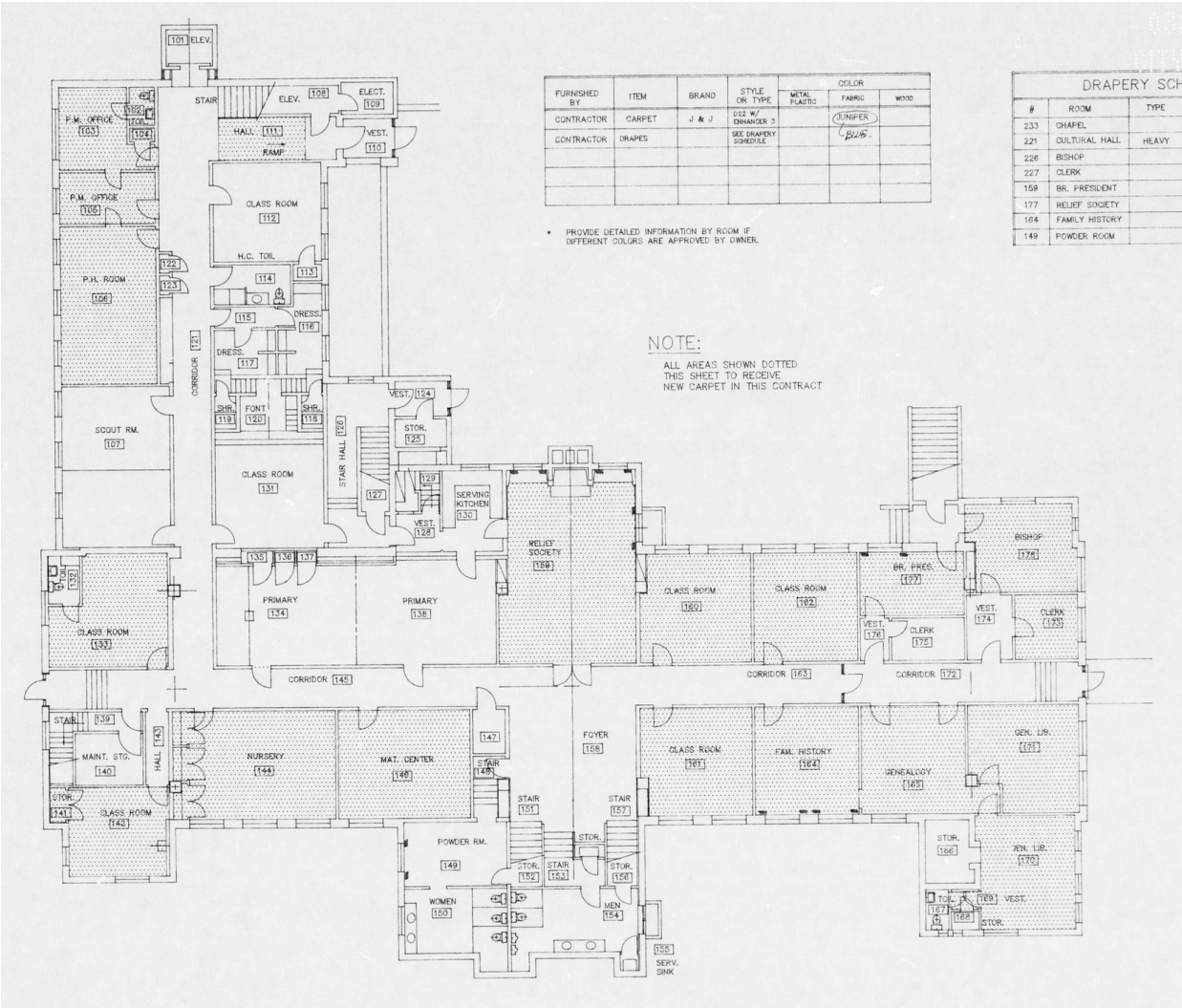

FOR LEASE

Historic Church located between the Hawthorne & Richmond Neighborhoods

1975 SE 30th Avenue, Portland, OR
Corner of SE 30th Avenue & SE Harrison Street



DANIEL SILVEY, CCIM, MRED, MBA
Commercial Real Estate Broker Licensed in OR & WA
Investment Sales & Commercial Leasing

503-201-8537
danielsilvey@kniperealty.com

KR COMMERCIAL
DIVISION
ERA

FOR LEASE

Historic Church located between the Hawthorne & Richmond Neighborhoods

1975 SE 30th Avenue, Portland, OR
Corner of SE 30th Avenue & SE Harrison Street



DANIEL SILVEY, CCIM, MRED, MBA
Commercial Real Estate Broker Licensed in OR & WA
Investment Sales & Commercial Leasing

503-201-8537
danielsilvey@kniperealty.com



FOR LEASE

Historic Church located between the Hawthorne & Richmond Neighborhoods

1975 SE 30th Avenue, Portland, OR
Corner of SE 30th Avenue & SE Harrison Street



DANIEL SILVEY, CCIM, MRED, MBA
Commercial Real Estate Broker Licensed in OR & WA
Investment Sales & Commercial Leasing

503-201-8537
danielsilvey@kniperealty.com



FOR LEASE

Historic Church located between the Hawthorne & Richmond Neighborhoods

1975 SE 30th Avenue, Portland, OR

Corner of SE 30th Avenue & SE Harrison Street



DANIEL SILVEY, CCIM, MRED, MBA

Commercial Real Estate Broker Licensed in OR & WA

Investment Sales & Commercial Leasing



503-201-8537



danielsilvey@kniperealty.com

7420 SW Bridgeport Rd, #210 | Portland, OR 97224

