



FOR LEASE

21463 FOOTHILL BLVD, HAYWARD, CA

 **TCI PROPERTIES**

DENNIS DANIELIAN CORPORATION
CA Broker 00939644

JESSE GOLDSTEIN INCORPORATED
CA Broker 00939643

650-598-0555 | TCI@TCIPROPERTIES.COM

PROPERTY HIGHLIGHTS

- High Traffic Corner Location
- 49,020 Daily Traffic Count on Foothill Blvd
- 7,423 Daily Traffic Count on Grove
- Proven Retail Location
- Dock High Loading at Rear of Building
- Close to 580 and 238 Exits

FOR LEASE SUMMARY

| | | |
|------------------------------|--------|------------|
| 14,928 | \$1.60 | NNN |
| RENTABLE SF | PER FT | LEASE TYPE |
| 61 | | |
| PARKING NON DEDICATED SPACES | | |

FLOOR PLAN

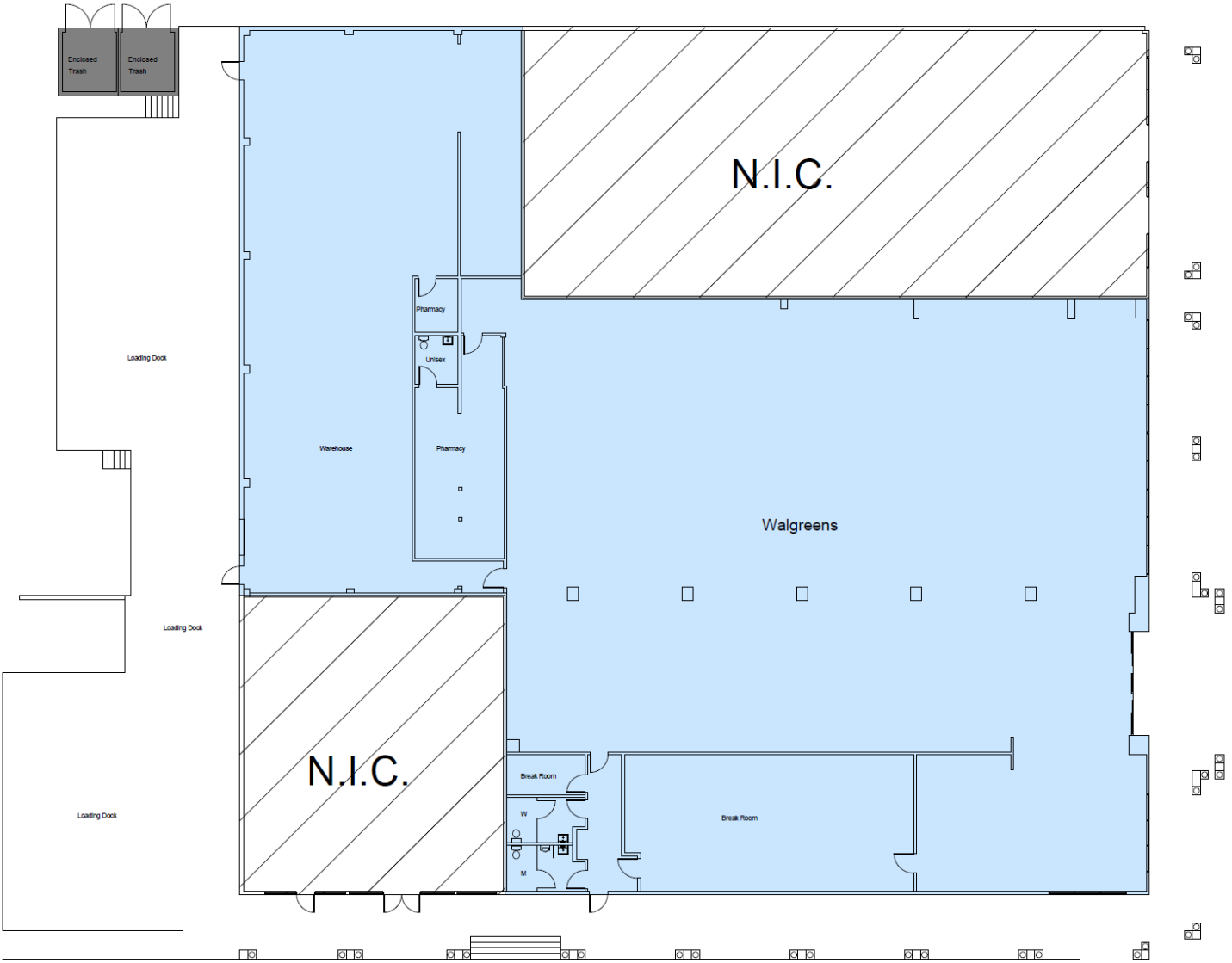

DEMOGRAPHICS

| | 2 MILE | 3 MILES | 5 MILES |
|--------------------------------------|-----------|-----------|-----------|
| POPULATION | 128,970 | 219,199 | 364,834 |
| HOUSEHOLDS | 44,986 | 75,363 | 124,032 |
| AVERAGE HOUSEHOLD SIZE | 2.8 | 2.9 | 2.9 |
| OWNER OCCUPIED HOUSING UNITS | 19,251 | 38,435 | 168,502 |
| RENTER OCCUPIED HOUSING UNITS | 25,200 | 36,928 | 54,005 |
| MEDIAN AGE | 38 | 39 | 38.9 |
| MEDIAN HOUSEHOLD INCOME | \$90,815 | \$96,909 | \$100,560 |
| AVERAGE HOUSEHOLD INCOME | \$110,261 | \$117,168 | \$122,733 |

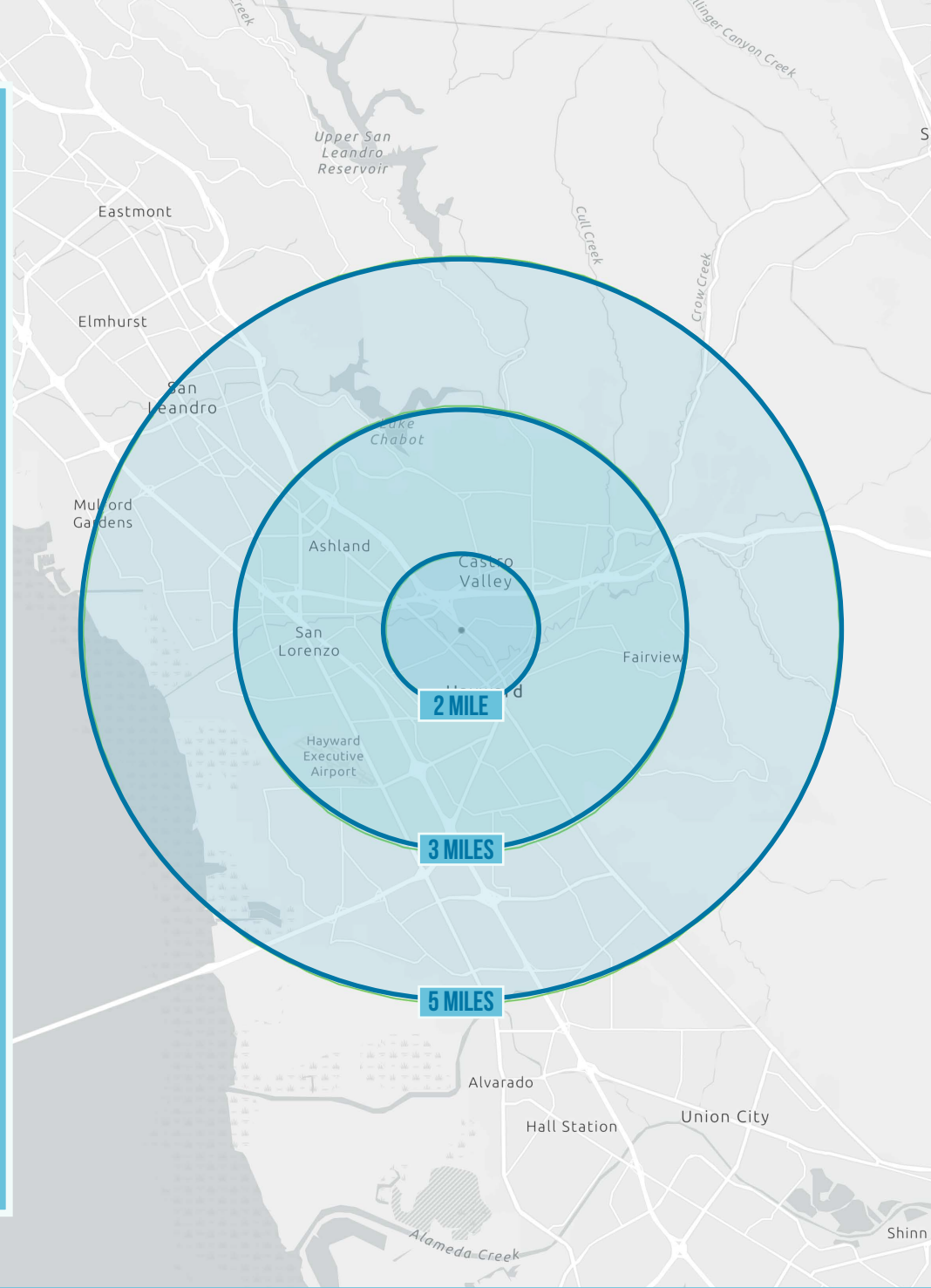

AERIAL MAP





