



Winchester Corporate Center

3435 Winchester Rd
Allentown, Pennsylvania 18104

Property Overview

- Four-story office building
- Professional Park setting
- Ample parking
- Ridge Farm mixed use development currently underway
- Located less than a mile to Route 22
- Convenient access to Route 309, I-78, and I-476 (Northeast Extension/PA Turnpike)
- Area amenities include Target, Weis, Rite Aid, restaurants, and banks

Offering Summary

Lease Rate:	\$19.25 SF/yr (MG)
Building Size:	83,095 SF
Available SF:	4,287 - 8,480 SF

For More Information

Sarah Finney Miller

O: 610 871 1719
sfinney@naissummit.com

Jenn Kennedy

O: 610 871 1707
jennkennedy@naissummit.com

3435 Winchester – 3rd Floor

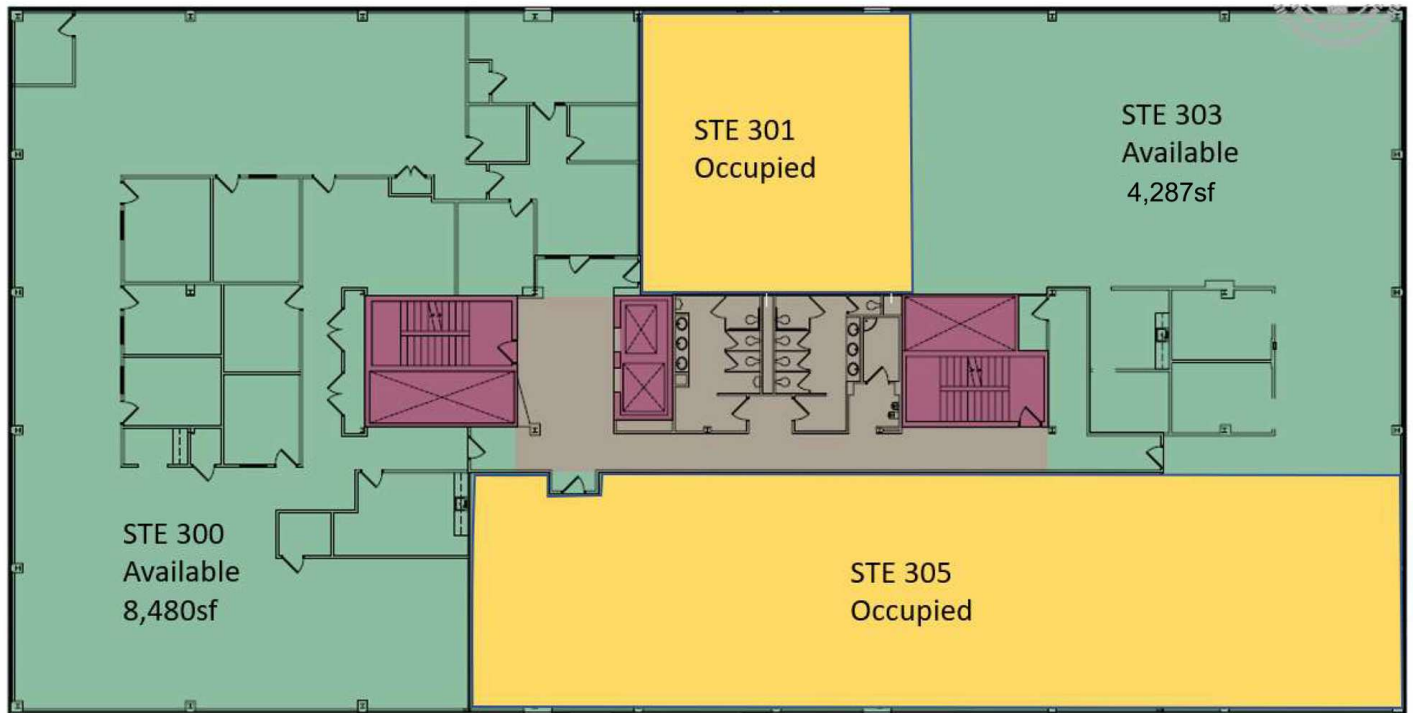

Lease Information

Lease Type:	MG	Lease Term:	Negotiable
Total Space:	4,287 - 8,480 SF	Lease Rate:	\$19.25 SF/yr

Available Spaces

Suite	Tenant	Size (SF)	Lease Type	Lease Rate
Suite 300	Available	8,480 SF	Modified Gross	\$19.25 SF/yr
Suite 303	Available	4,287 SF	Modified Gross	\$19.25 SF/yr

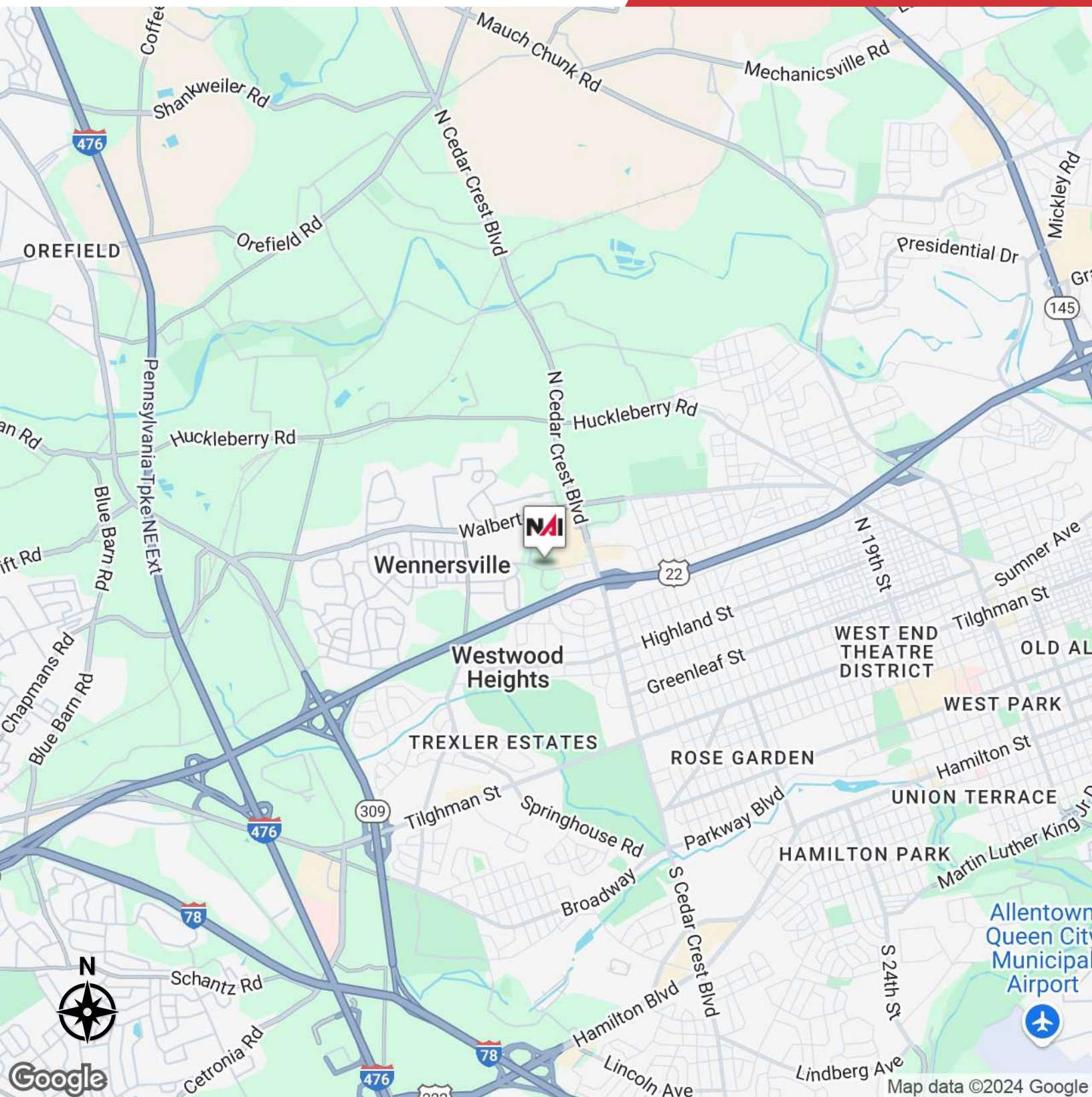

We obtained the information above from sources we believe to be reliable. However, we have not verified its accuracy and make no guarantee, warranty or representation about it. It is submitted subject to the possibility of errors, omissions, change of price, rental or other conditions, prior sale, lease or financing, or withdrawal without notice. We include projections, opinions, assumptions or estimates for example only, and they may not represent current or future performance of the property. You and your tax and legal advisors should conduct your own investigation of the property and transaction.

1620 Pond Road, Suite 150
Allentown, PA 18104
610 264 0200 tel
naisummit.com

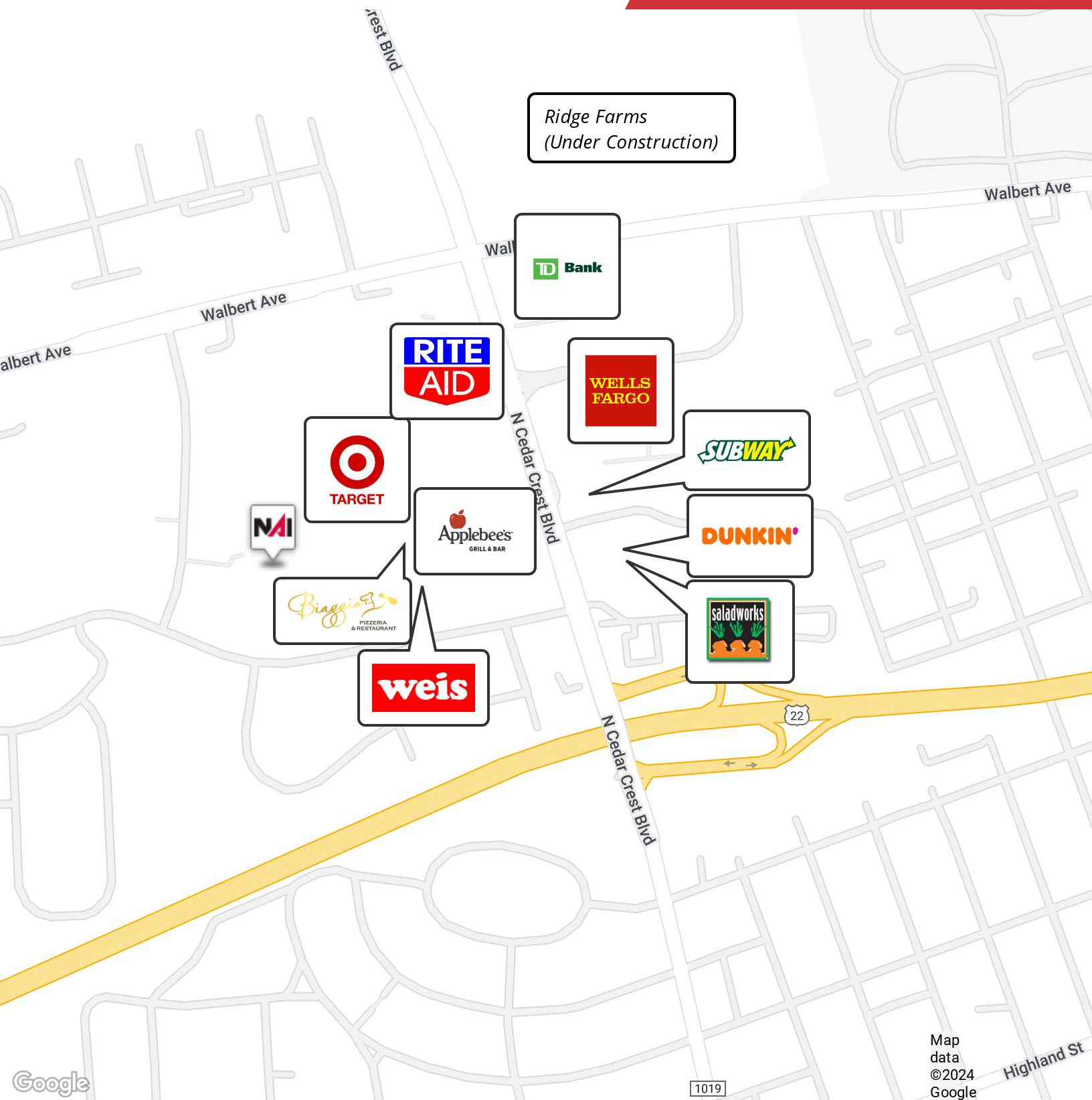

Map data
©2024
Google

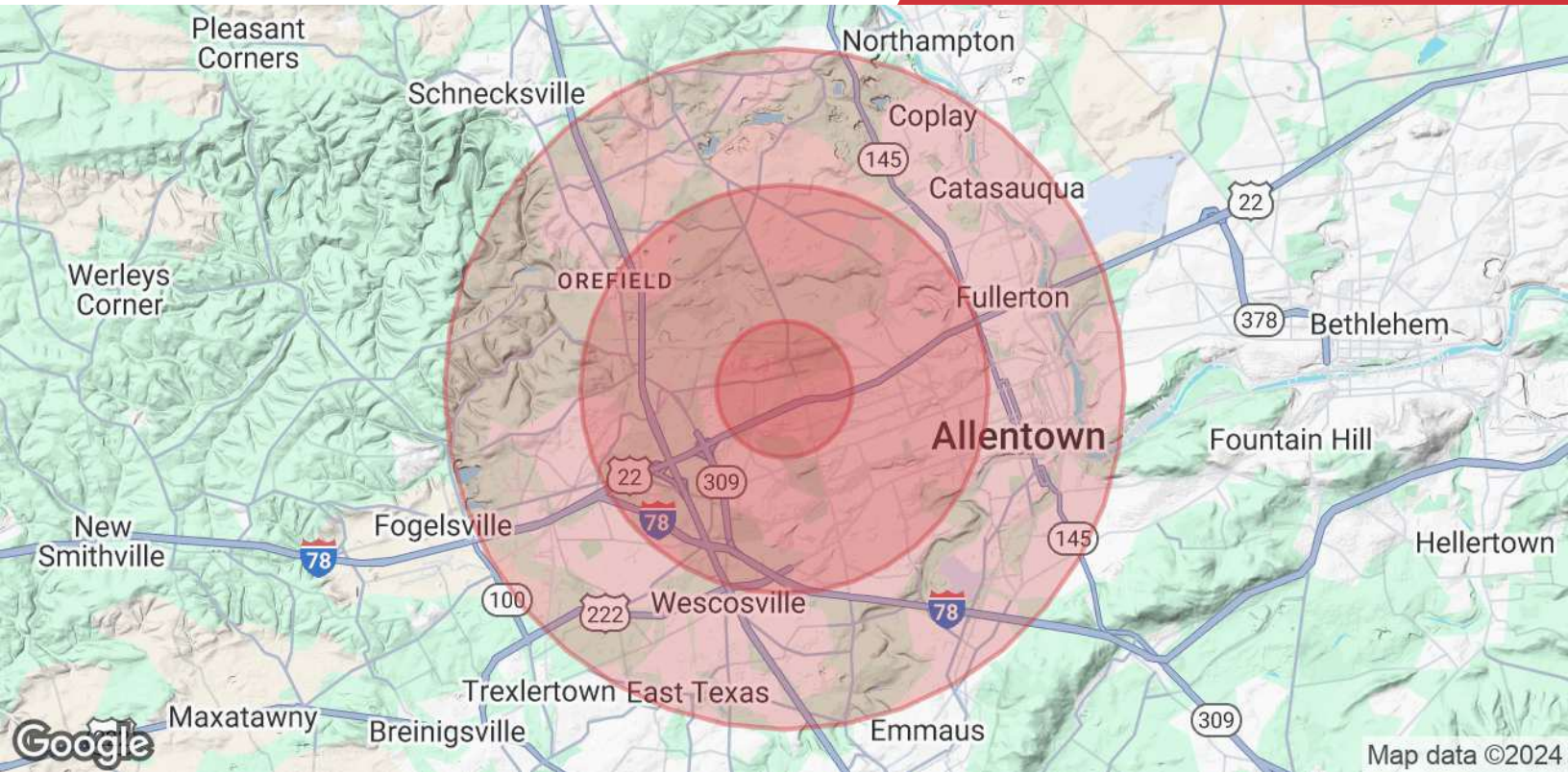

	1 Mile	3 Miles	5 Miles
Population			
Total Population	5,393	75,664	199,305
Average Age	43.1	38.9	38.3
Households & Income			
Total Households	2,201	29,270	78,925
# of Persons per HH	2.5	2.6	2.5
Average HH Income	\$105,317	\$82,169	\$74,533
Traffic Counts			
N. Cedar Crest Blvd	14,093/day		

2020 American Community Survey (ACS)