

BOYNTON BEACH, FL

8543 BOYNTON BEACH BLVD

3,600 SF AVAILABLE FOR LEASE





PROJECT DETAILS

8543 BOYNTON BEACH BLVD • 3,600 SF AVAILABLE FOR LEASE • RETAIL

PROPERTY HIGHLIGHTS

- Proposed 9,400 SF multi-tenant building
- 3,600 SF available
- Ownership will demise for the right tenants
- Remote ATM can be accommodated for financial institutions
- Delivery: Q4 2024
- 2 Acres with 66 parking spaces
- Cross parking with adjacent development
- Signalized access on Boynton Beach Blvd (36,000 ADT)
- High growth market with Median Household Income greater than \$100,000

DEMOGRAPHICS

	1 MILE	3 MILE	5 MILE	7 MILE
 TOTAL POPULATION	6,093	60,492	150,212	338,962
 MEDIAN HH INCOME	\$119,600	\$103,287	\$89,808	\$76,645

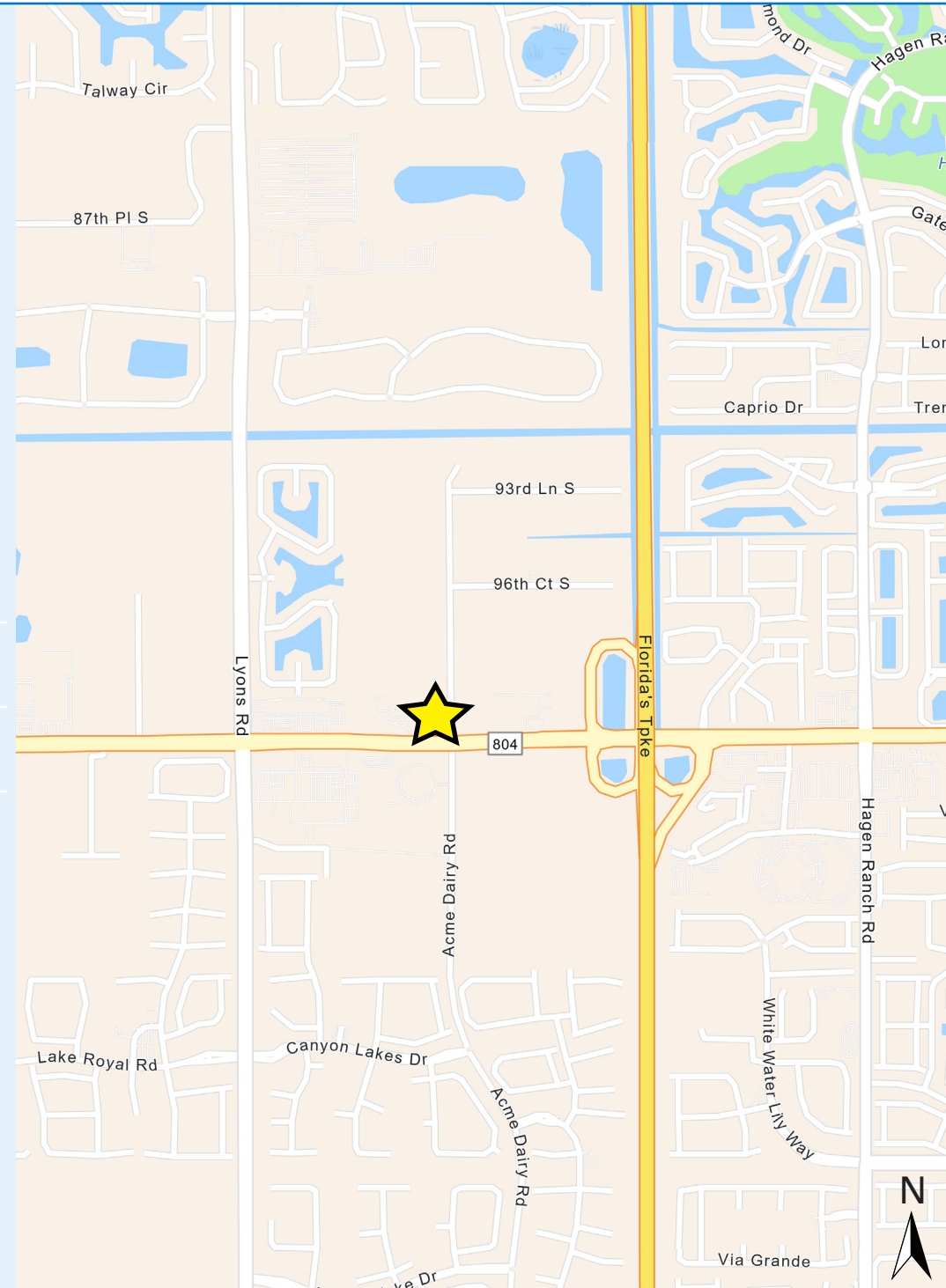

AERIAL



SITE

PROPOSED



THE DISTRICT
PROPOSED
500K SF MIXED USE
DEVELOPMENT

SELF
STORAGE



Boynton Beach Blvd

36,000 ADT

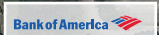

SUNSET PALMS
ELEMENTARY
SCHOOL

PROPOSED
MULTI-FAMILY
316 UNITS



SUNSET PALMS
MIDDLE SCHOOL
2023
12,000 STUDENTS

Lyons Rd Extension
11,200 ADT

Acme Dairy Rd

SITE PLAN

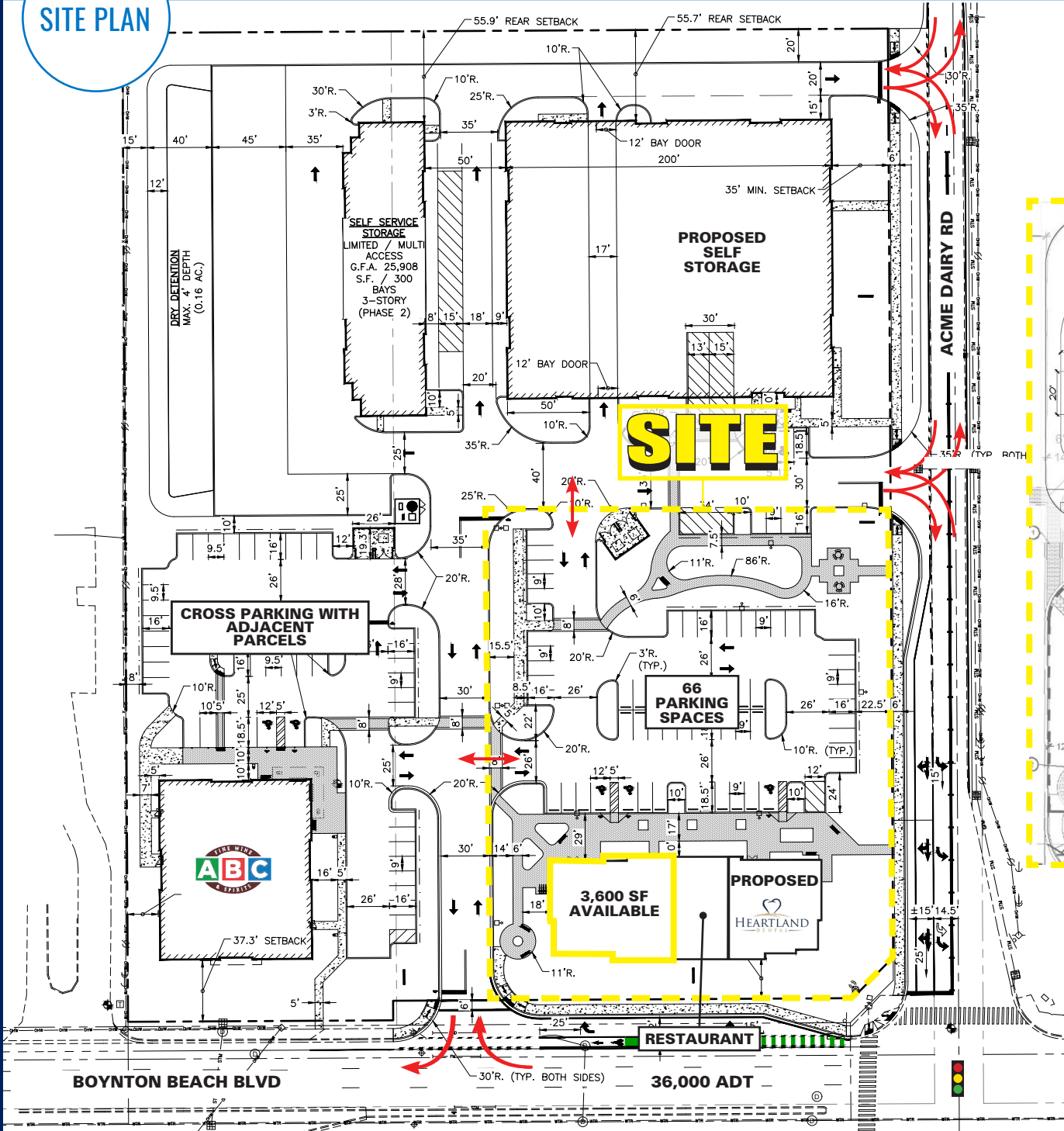

REMOTE ATM SITE PLAN

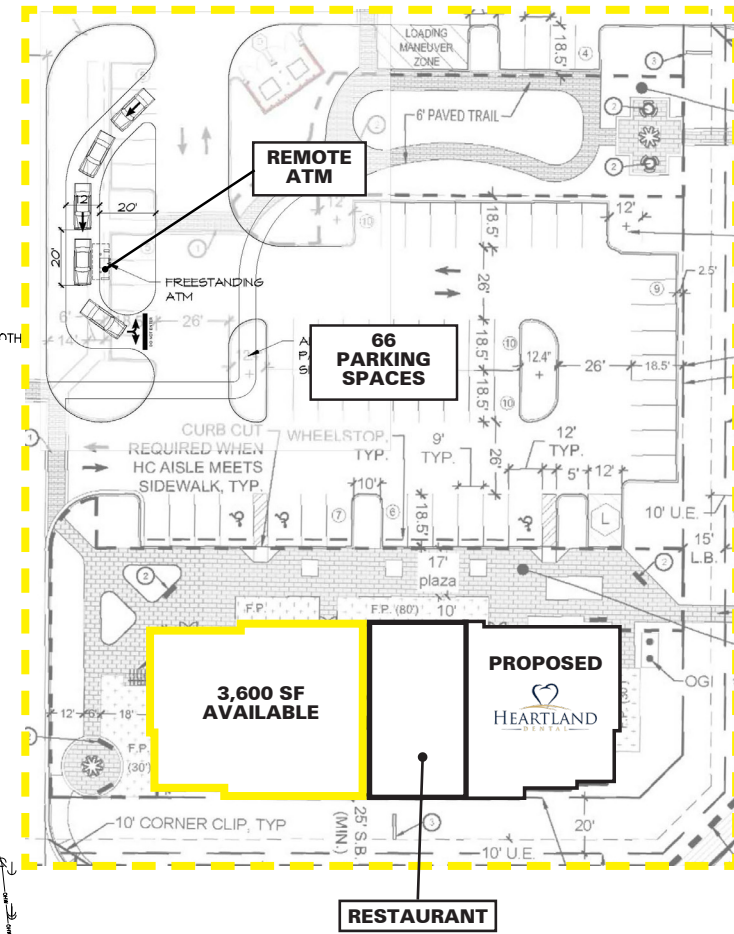



BOYNTON BEACH, FL

8543 BOYNTON BEACH BLVD

3,600 SF AVAILABLE FOR LEASE | RETAIL

ROSS WATERS

561.424.3014
 RWATERS@ATLANTICRETAIL.COM

MATT LYNCH

561.424.3019
 MLYNCH@ATLANTICRETAIL.COM



ALBANY
ATLANTA
BOSTON
CHARLOTTE
LOS ANGELES
NEW YORK CITY
ORLANDO
PITTSBURGH
WEST PALM BEACH
 HOLTEC BUILDING
 1001 N US HWY ONE, SUITE 600
 JUPITER, FL 33477
 561.427.6699

WWW.ATLANTICRETAIL.COM

LINKEDIN.COM/COMPANY/ATLANTIC-RETAIL-PROPERTIES
 INSTAGRAM.COM/ATLANTIC_RETAIL/

