

FOR LEASE

1530 HARMONY CIRCLE, AVENUE ANAHEIM, CALIFORNIA

+6,000 SQUARE FEET AVAILABLE



Voit

REAL ESTATE SERVICES

2020 Main Street | Suite 100 | Irvine, California 92614 | 949.851.5100 | 949.261.9092 Fax | www.VoitCo.com

GARRETT MCCLELLAND

Senior Vice President

Lic #01848147

949.263.5302

gmcclelland@voitco.com

ERIK SIKES

Senior Associate

Lic #02103320

949.263.5344

esikes@voitco.com

1ST FLOORPLAN

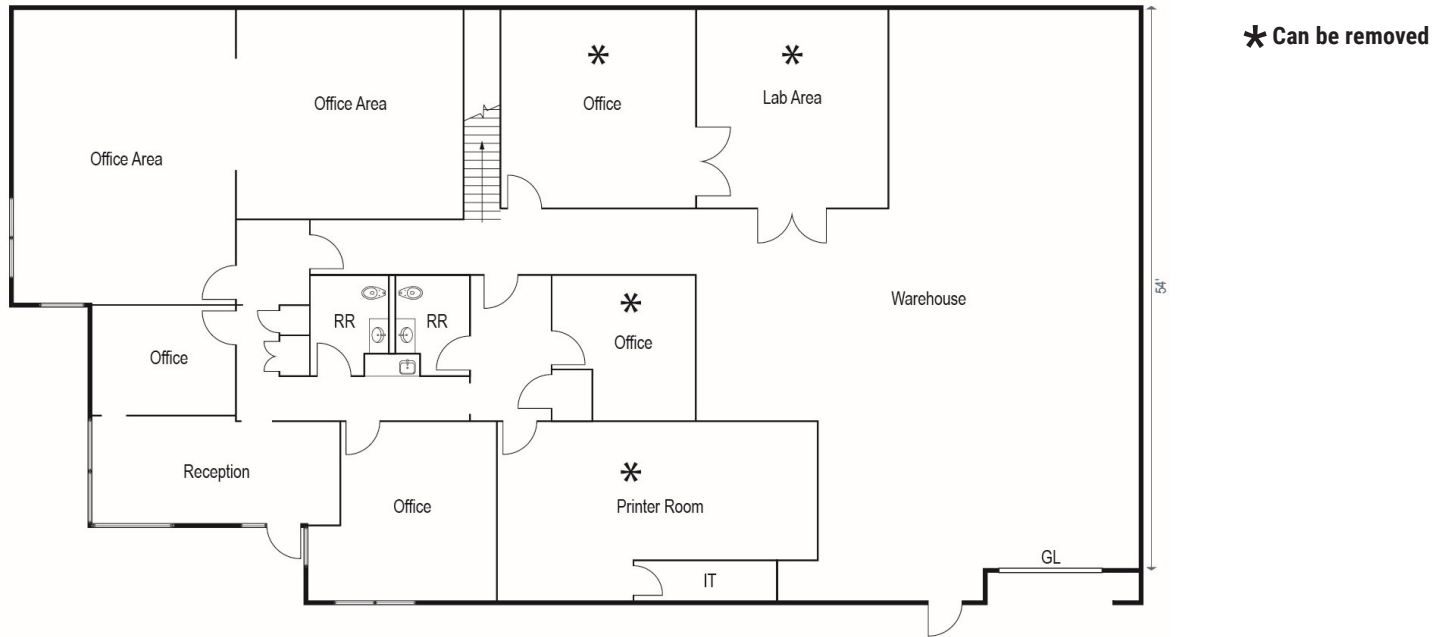

2ND FLOORPLAN

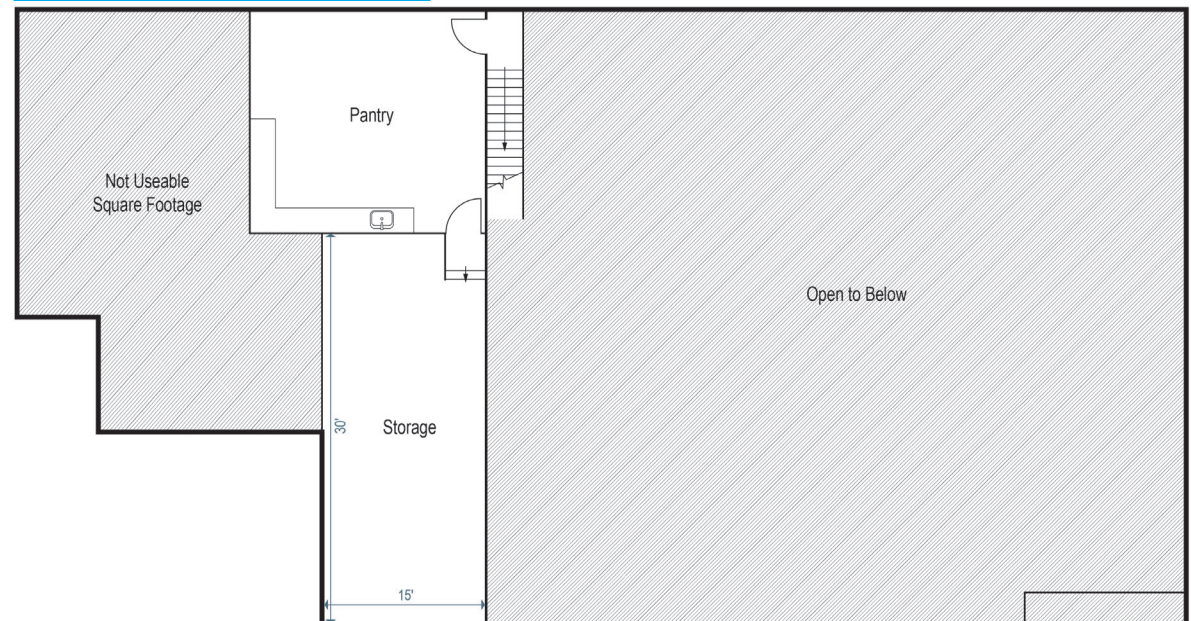

BUILDING FEATURES

- BUILDING SIZE: 6,000 SF
- 2,760 SF OF ORIGINAL OFFICE SPACE. SOME PORTIONS CAN BE REMOVED
- ± 870 SF BONUS MEZZANINE
- LOT SIZE: 0.24 ACRES
- YEAR BUILT: 1992
- CLEARANCE: 20'
- LOADING: ONE (1) GROUND LEVEL DOOR
- POWER: 1,200 AMPS (277/480V)
- PARKING: 2.20/1,000 SF

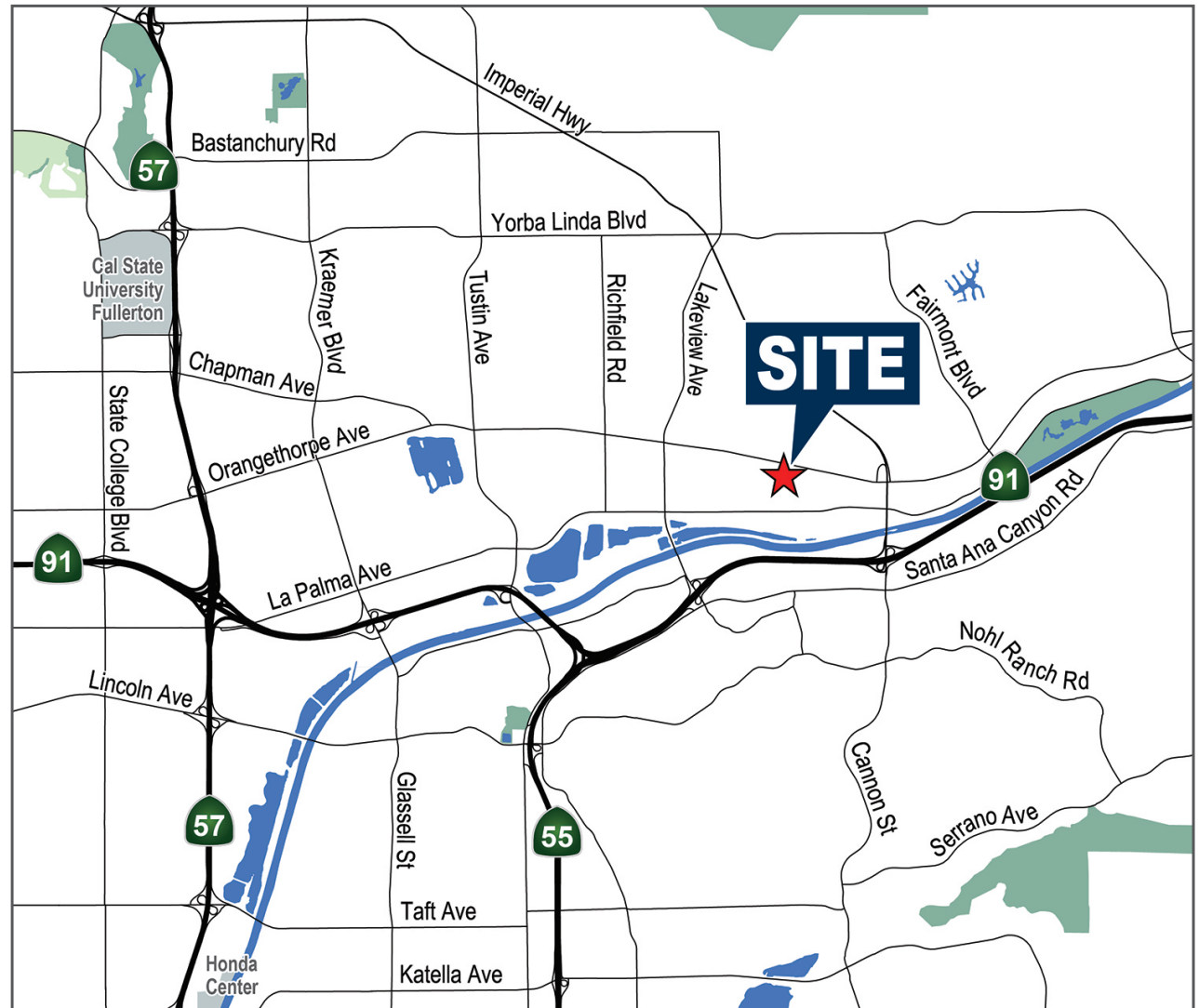

FOR LEASE

1530 HARMONY CIRCLE, AVENUE ANAHEIM, CALIFORNIA

+6,000 SQUARE FEET AVAILABLE



Harmony Cir

Voit

REAL ESTATE SERVICES

2020 Main Street | Suite 100 | Irvine, California 92614 | 949.851.5100 | 949.261.9092 Fax | www.VoitCo.com

GARRETT MCCLELLAND

Senior Vice President

Lic #01848147

949.263.5302

gmcclelland@voitco.com

ERIK SIKES

Senior Associate

Lic #02103320

949.263.5344

esikes@voitco.com