

HIGH-END
SPEC SUITES
AVAILABLE AT

**Midtown
Center**

1100 15TH Street, NW
WASHINGTON DC

5TH FLOOR

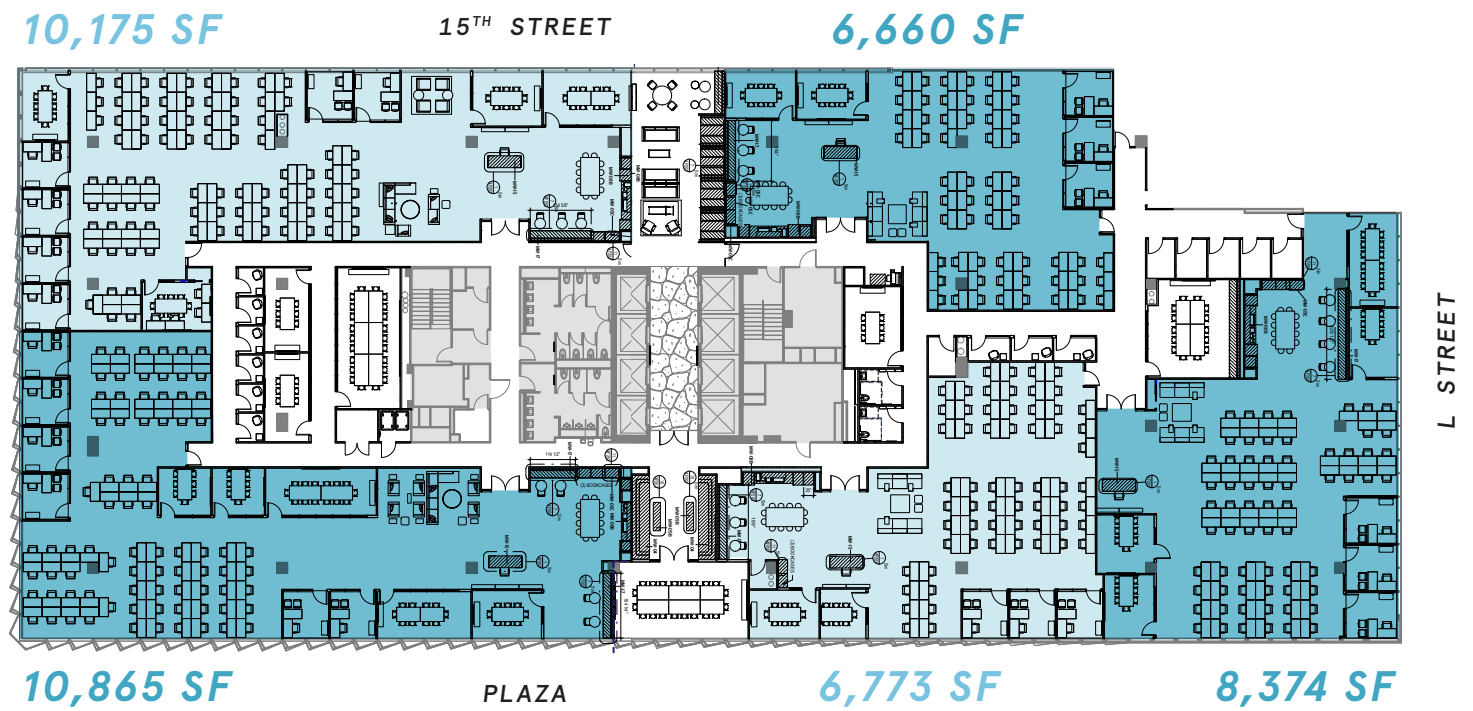



WeWork Midtown Center is located in the heart of the city and offers members a dynamic work environment full of vibrant activity.



Building amenities include a state of the art fitness center with lockers, showers, & towel service



On-site parking garage equipped with a bike room and electric car charging stations

Steps away from McPherson Square (Orange, Blue and Silver Lines) and Farragut North (Red Line)

WeWork Midtown Center Highlights



6,000 - 10,000 SF
SUITES AVAILABLE



ON-SITE
PARKING



MAIL
SERVICES



CONFERENCE
FACILITY ACCESS



FITNESS
CENTER ACCESS



TERM
FLEXIBILITY



IMMEDIATE
OCCUPANCY



WIFI &
TECHNOLOGY