



For **sublease**

# Creative office and production space – full building available

3668 Albion Pl. N, Seattle, WA 98103

## SPACE PROFILE

22,685 SF

Total SF

11/1/2026

Availability  
(potentially sooner)

Negotiable

Rental rate

4/30/2027

Term

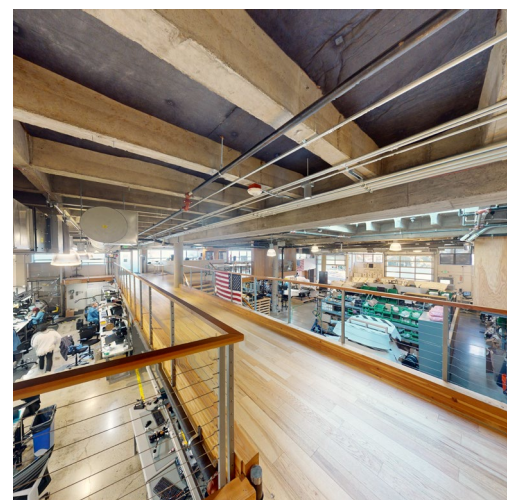



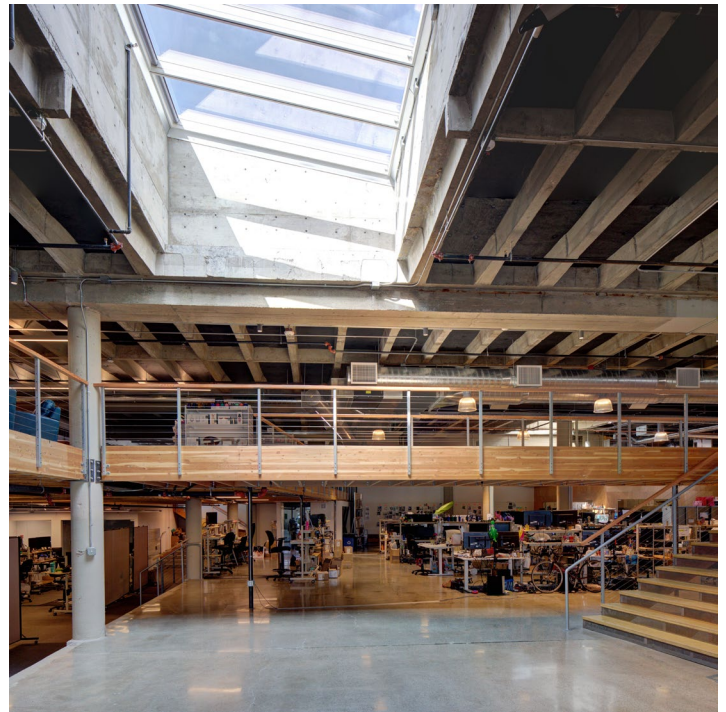

- Expansive exposed ceilings with skylights and electronic shades deliver exceptional natural light
- Upgraded acoustic treatments throughout the space
- Roll-up doors and operable windows provide ventilation and flexibility
- Private single-stall restrooms throughout the building

- Modern digital climate control and overhead fans in every room for enhanced comfort and air circulation
- 21 on-site parking stalls plus abundant street parking; Includes bike storage and showers
- Located in vibrant Fremont – steps from cafes, restaurants, shops, and breweries
- Excellent connectivity to I-5, SR-99, and nearby public transportation options







ENTIRE BUILDING

22,685 SF Available

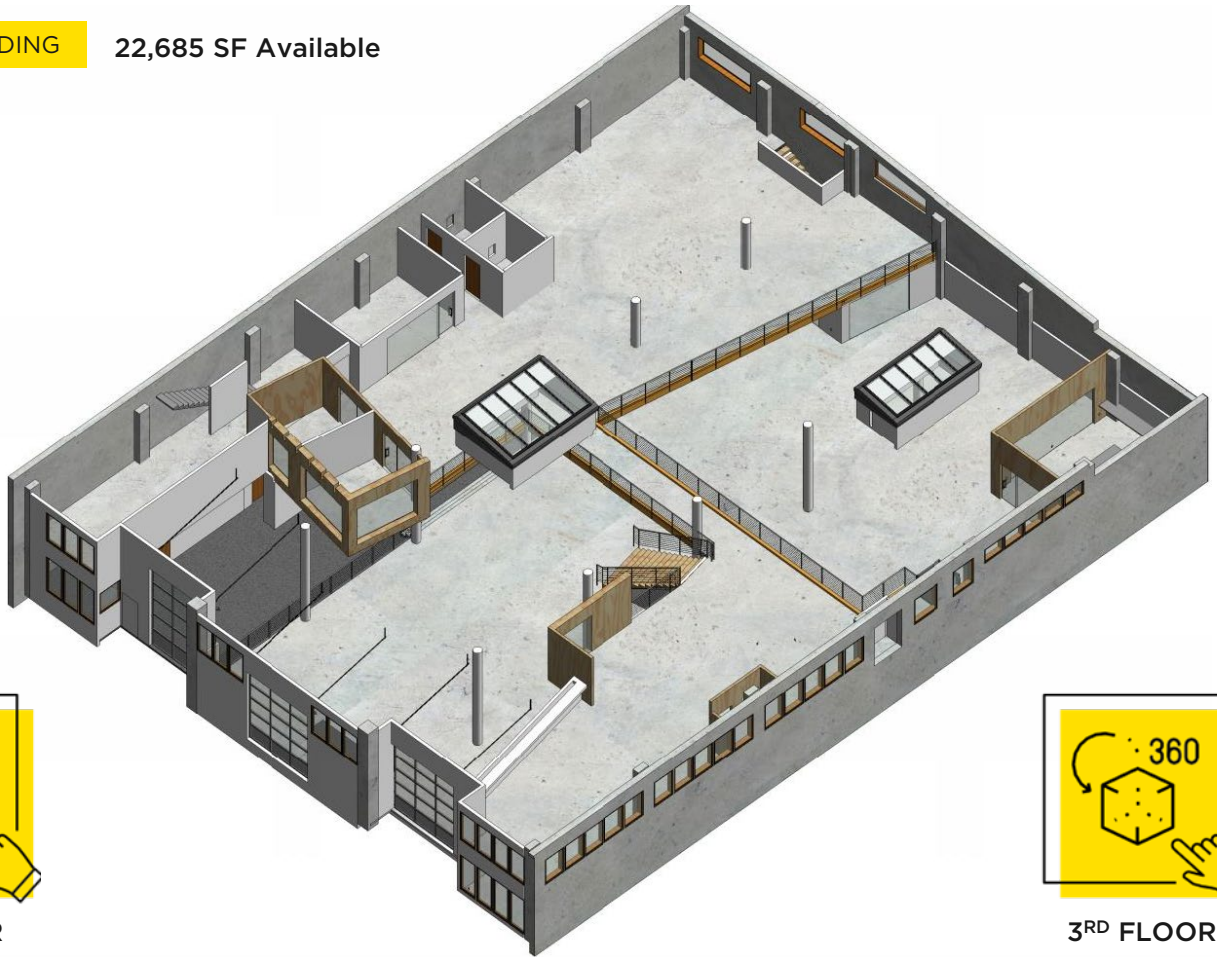

2ND FLOOR

3RD FLOOR





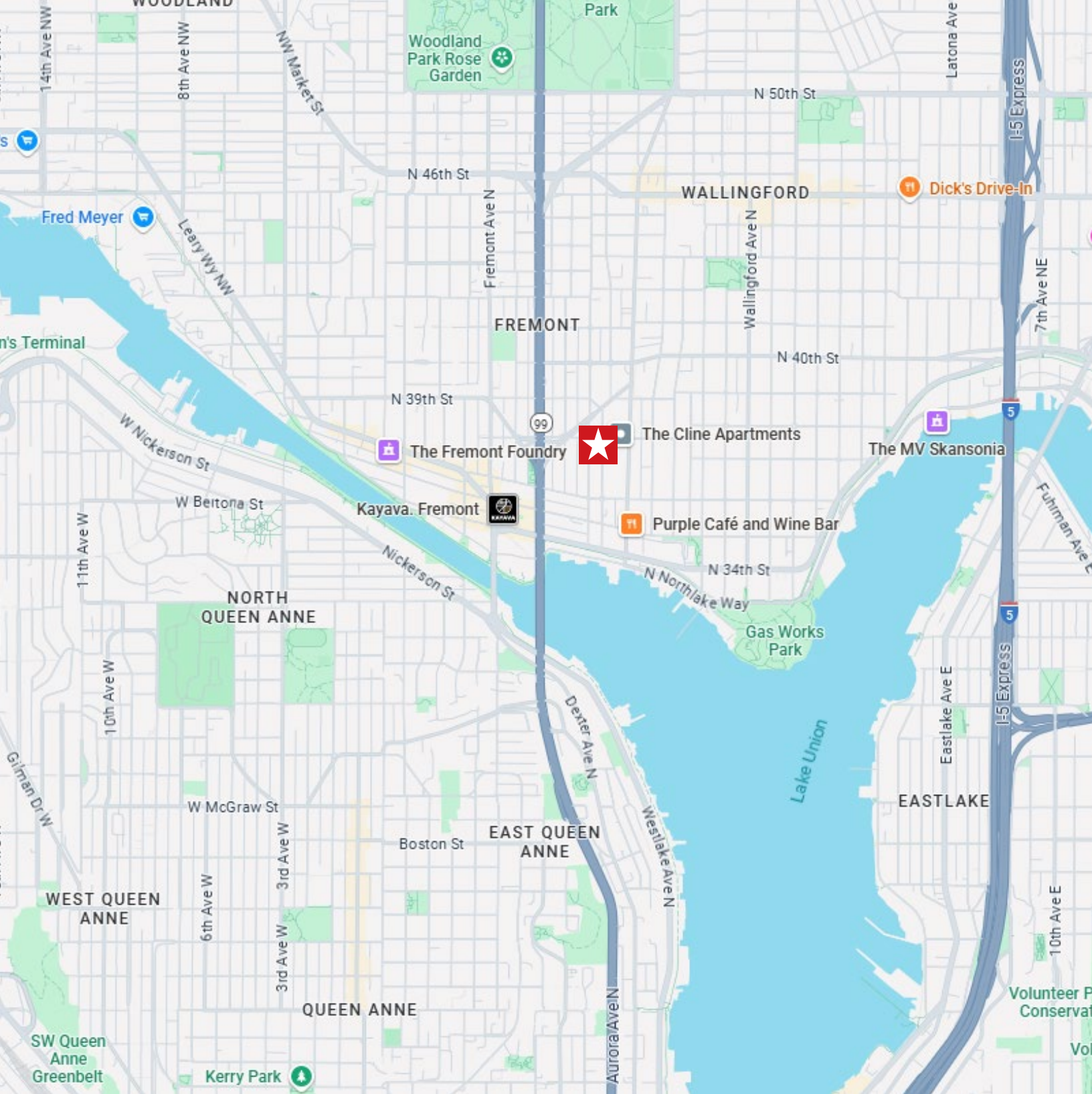

**Eric Blohm**

+1 206 660 5769  
eblohm@savills.us

**Luke Troedson**

+1 808 389 9224  
ltroedson@savills.us

© 2025 Savills. All rights reserved. The information contained in this communication has been obtained from a variety of sources believed to be reliable but has not been verified. NO WARRANTY OR REPRESENTATION, EXPRESS OR IMPLIED, IS MADE AS TO THE CONDITION OF THE PROPERTY OR ACCURACY OR COMPLETENESS OF THE INFORMATION CONTAINED HEREIN AND SAME IS SUBMITTED SUBJECT TO ERRORS, OMISSIONS, CHANGE OF PRICE, RENTAL OR OTHER CONDITIONS, WITHDRAWAL WITHOUT NOTICE AND TO ANY SPECIFIC CONDITIONS IMPOSED BY THE PROPERTY OWNER OR LESSOR.