

FOR LEASE

451 EAST MAIN STREET DENVER, NJ

AVAILABLE SPACE

- Unit 457: +/- 1140 sf
- New window, door, LED lighting
- Warehouse with 2 private restrooms
- Partition wall separating reception & working space
- Fully air conditioned & heated

BUILDING FEATURES

- 14' ceiling height
- New exterior façade
- On site parking
- Route 53/Main St. visibility
- 1 Mile to Route 80/46
- 2 Miles to Route 10
- [Zoning I-1](#)

Rental Rate: \$15.00/psf NNN



For more information contact:

DEBORAH MYERS

C: 973.493.8508

O: 973.884.4444 ext. 15

dmyers@newmarkrealestate.com

DAVID TOMLIN

C: 973.310.2994

O: 973.884.4444 ext. 33

dtomlin@newmarkrealestate.com

NewmarkRealEstate.com | 973.884.4444 | 7 E. Frederick Place Suite 500 Cedar Knolls New Jersey 07927

2026 Newmark Associates CRE. Information obtained from sources deemed to be reliable. However, no guarantee, warrant or representation is made as to accuracy of the information presented which is submitted subject to errors, omission, change of price, rental or other conditions, prior sale lease, financing or withdrawal without notice. Projections, opinions, assumptions or estimates are provided for example only, and may not represent current or future performance. Interested parties should consult their tax and legal advisors and conduct a thorough investigation of the property and any prospective transaction.

FLOOR PLAN

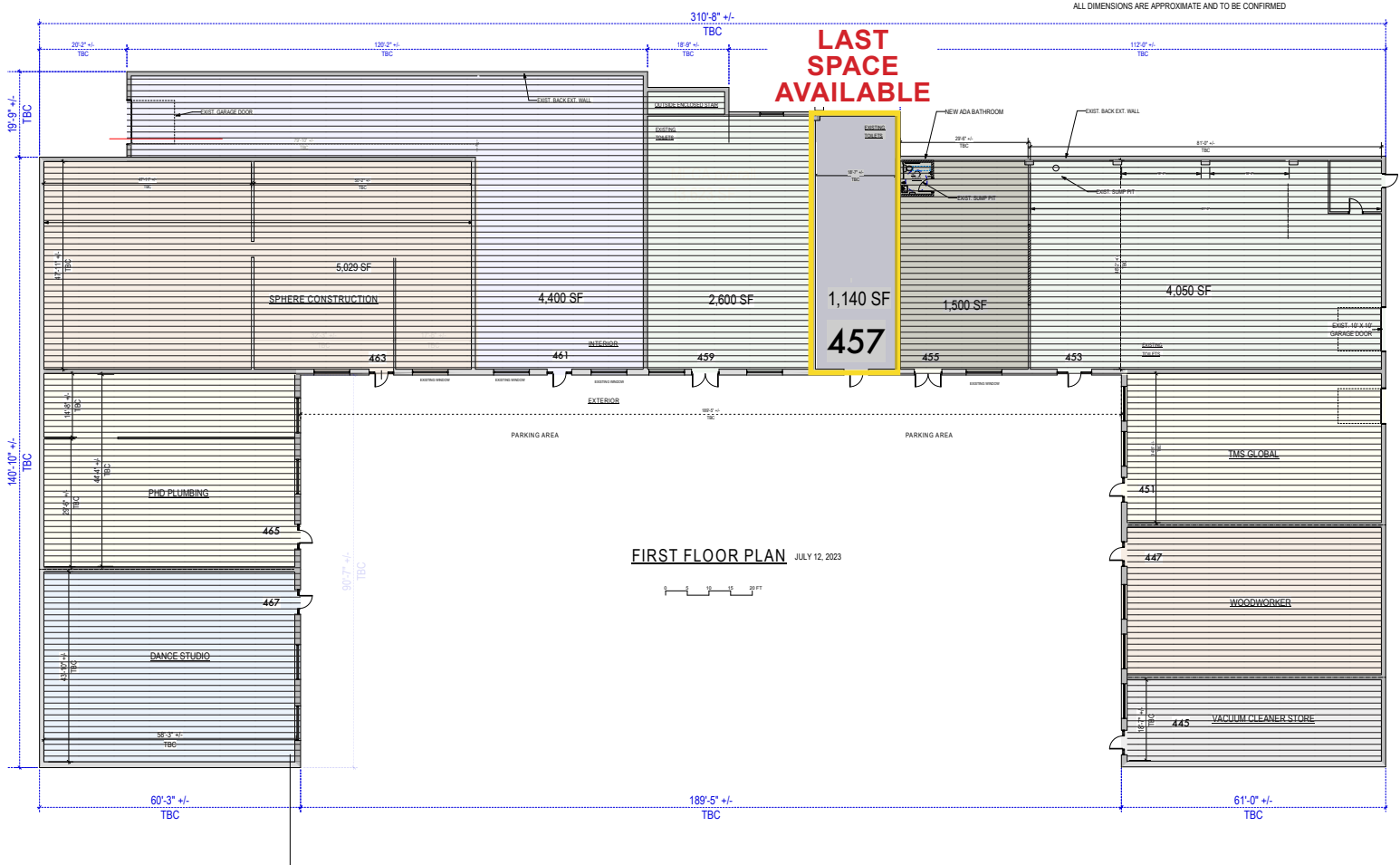

FLOOR PLAN MAY NOT BE DRAWN TO SCALE

NewmarkRealEstate.com | 973.884.4444 | 7 E. Frederick Place Suite 500 Cedar Knolls New Jersey 07927

2026 Newmark Associates CRE. Information obtained from sources deemed to be reliable. However, no guarantee, warrant or representation is made as to accuracy of the information presented which is submitted subject to errors, omission, change of price, rental or other conditions, prior sale lease, financing or withdrawal without notice. Projections, opinions, assumptions or estimates are provided for example only, and may not represent current or future performance. Interested parties should consult their tax and legal advisors and conduct a thorough investigation of the property and any prospective transaction.