

Fully Approved Addition
Expandable to Total of ± 22,631 SF



PROPERTY DESCRIPTION

Development Associates is pleased to offer For Lease +/- 15,583 Square Foot of Office/Industrial space with ample parking located in an established Industrial Park setting in Chicopee, MA.

Space ideal for Professional Office, Industrial, Assembly, Lab/Medical.

Fully approved addition - expandable to a total of 22,631 SF



PROPERTY HIGHLIGHTS

- Available for Immediate Occupancy
- Ample On-Site Parking
- Floor plan can be customized to suit your requirements.
- Close proximity to local amenities
- High Quality, Corporate Profile
- Conveniently located near Mass Pike and easy access to I-91 and other major highways.

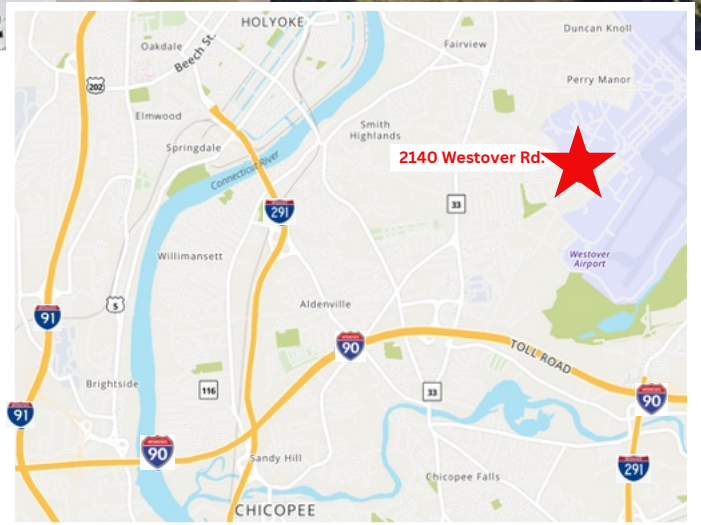

Developers and Brokers of Commercial Properties

200 Silver Street, Suite 201 | Agawam, MA 01001

DISCLOSURE: BROKER HAS A FINANCIAL INTEREST IN THIS PROPERTY.

KEN VINCUNAS
(413) 789-3720

kvincunas@devassociates.com

www.Devassociates.com

EXISTING TOTAL SQUARE FOOTAGE: ± 15,583
EXPANDABLE ADDITION: Up to ± 22,631 Total SF

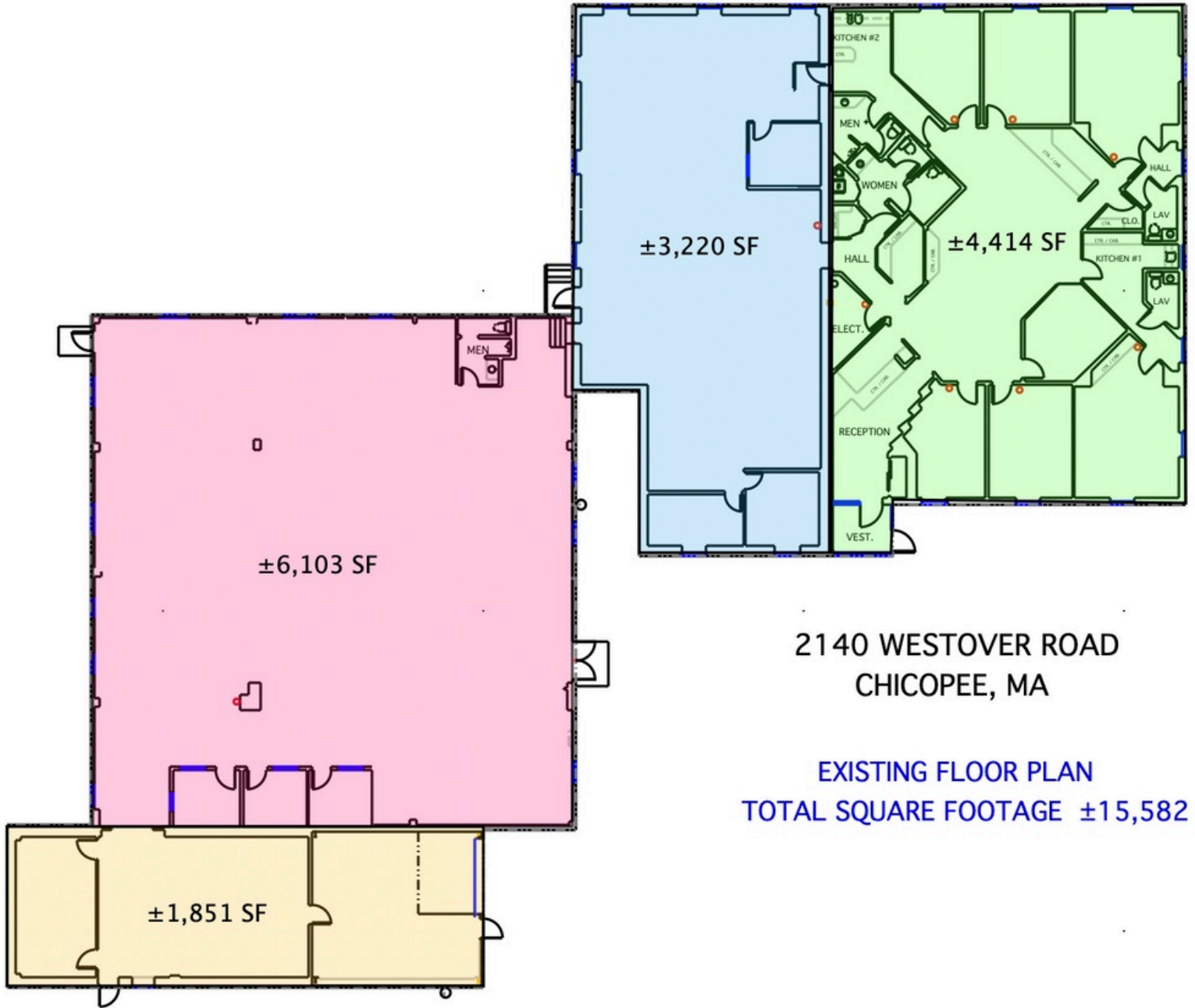

2140 WESTOVER ROAD
CHICOPEE, MA

EXISTING FLOOR PLAN
TOTAL SQUARE FOOTAGE ±15,582