

# FOR LEASE

3,150 SF AVAILABLE

3201 Skylane Dr, Suite 100-101, Carrollton, TX  
Metropolitan Submarket



Suite 100-101  
3,150-sf



# FOR LEASE

**3,150 SF AVAILABLE**  
**3201 Skylane Dr, Suite 100-101, Carrollton, TX**  
**Metropolitan Submarket**



## SPACE FOR LEASE - INFORMATION

- **3,150 SF Available**
  - **1,018 SF Office**
  - **2,132 SF Warehouse**
- **12' Clear Height**
- **100% HVAC**
- **75' Building Depth**
- **2 Grade-Level Doors**
- **Front Park | Rear Load**
- **2022 Roof Recover**
- **2023 Make Ready**
  - **Warehouse Whitebox**
  - **Warehouse LEDs**
  - **Office Renovation**
- **Addison Airport: 1.6 miles**
- **Immediate Availability**

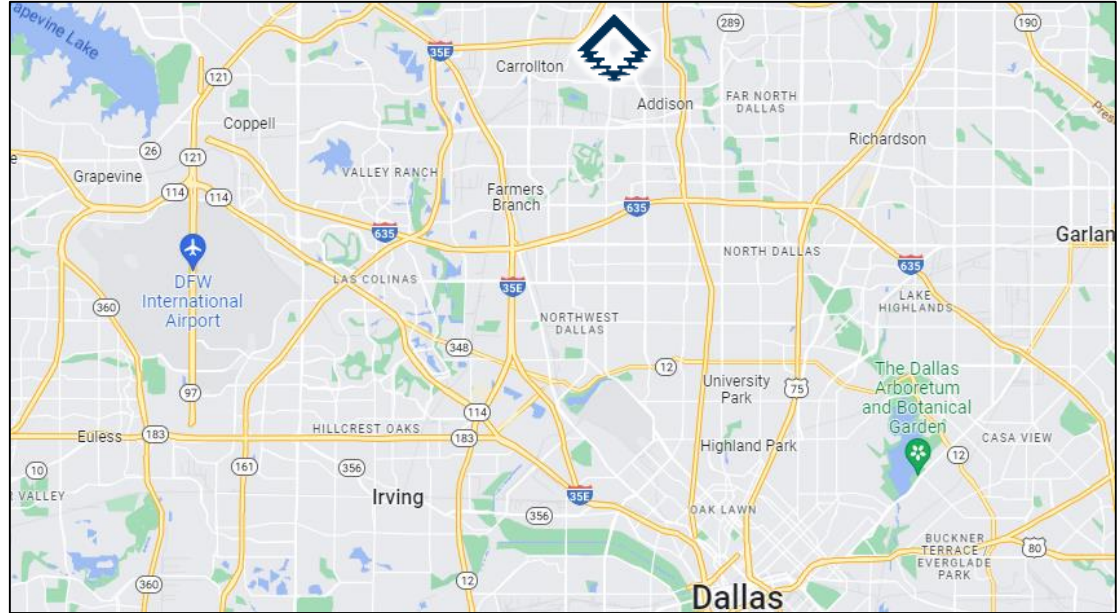

### MARKETED BY:

**JASON FINCH**

JFINCH@BRADFORD.COM  
(972)-948-8262

**JUSTIN GREENWOOD**

JGREENWOOD@BRADFORD.COM  
(817)-587-8464



# FOR LEASE

**3,150 SF AVAILABLE**  
**3201 Skylane Dr, Suite 100-101, Carrollton, TX**  
**Metropolitan Submarket**

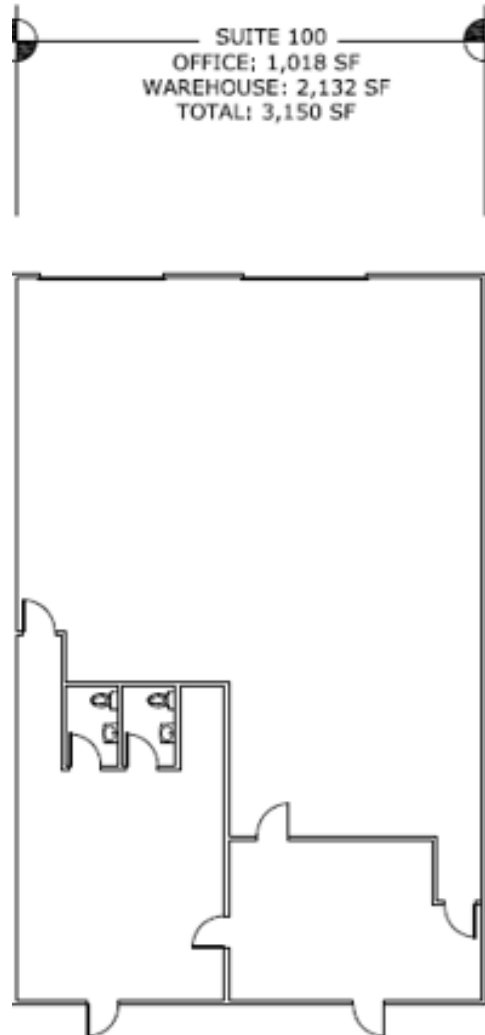



# FOR LEASE

3,150 SF AVAILABLE  
3201 Skylane Dr, Suite 100-101, Carrollton, TX  
Metropolitan Submarket



Addison Airport

Suite 100-101  
3,150-sf

Skylane Dr





# FOR LEASE

3,150 SF AVAILABLE  
3201 Skylane Dr, Suite 100-101, Carrollton, TX  
Metropolitan Submarket



2023 Make Ready



LED Lighting

Warehouse Whitebox

Painted Hazard Columns

# FOR LEASE

3,150 SF AVAILABLE  
3201 Skylane Dr, Suite 100-101, Carrollton, TX  
Metropolitan Submarket



**2023 Office Renovation**

**LED Lighting**

**New Interior Paint**

**New Flooring**



# FOR LEASE

3,150 SF AVAILABLE  
3201 Skylane Dr, Suite 100-101, Carrollton, TX  
Metropolitan Submarket



**2023 Office Renovation**

**New Restrooms**

**LED Lighting**

**New Interior Paint**

**New Flooring**

# FOR LEASE

3,150 SF AVAILABLE  
3201 Skylane Dr, Suite 100-101, Carrollton, TX  
Metropolitan Submarket



**2023 Office Renovation**

**LED Lighting**

**New Interior Paint**

**New Flooring**



# FOR LEASE

3,150 SF AVAILABLE  
3201 Skylane Dr, Suite 100-101, Carrollton, TX  
Metropolitan Submarket



Suite 100-101  
3,150-sf

