



THE RETAIL AT
329 BROADWAY

Williamsburg, Brooklyn



VIRTUAL TOUR



VIDEO TOUR

329 BROADWAY



SPACE HIGHLIGHTS

329 BROADWAY

SPACE		RETAIL - GROUND LEVEL
AVAILABLE SPACES	1,200 - 5,700 SF	DESCRIPTION Sparkling new steel-and-glass mixed-use development unveiled in the heart of Williamsburg Brooklyn, with five floors of divisible Retail and Office space-for-lease, featuring triple-glazed floor-to-ceiling windows, high ceilings, and non-stop foot traffic from the JMZ Express subway and bus terminal across the street. Located at the intersection of where 'old-meets-new' in Williamsburg: Peter Luger's, Patricia's, and the Williamsburg Bridge are a couple blocks West, and the white-hot and trendy Bedford Avenue is a short walk North.
LOCATION	Broadway & Rodney	
CEILING HEIGHT	13 FT	
FRONTAGE	100 FT	
ZONING	R6	
DIMENSIONS	80' x 70'	HIGHLIGHTS <ul style="list-style-type: none">• New Development• Divisible• 100' of Frontage• High Ceilings• High Foot Traffic• Triple-Paned Windows (Soundproof)• Floor-to-Ceiling Windows• Whiteboxed• Corner Space is White-Boxed
OCCUPANCY	Immediate	
ASKING PRICE	\$60-\$85 PSF	

FLOORPLANS & DETAILS (Ground Floor)

329 BROADWAY

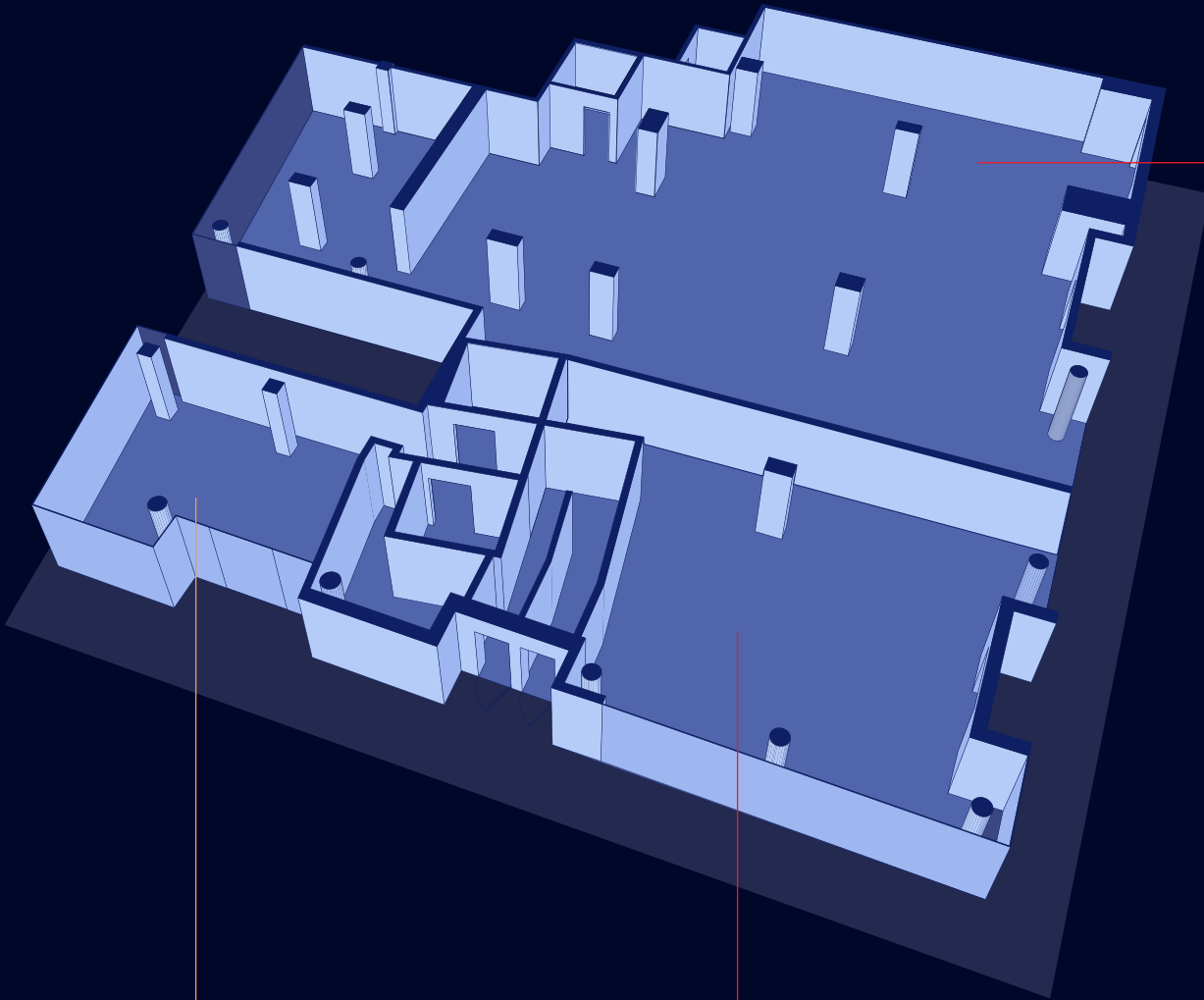

INLINE SPACE - 4,500 SF

COMMUNITY FACILITY

CORNER SPACE - 1,200 SF





CORNER SPACE



CORNER SPACE



INLINE SPACE



INLINE SPACE

NEIGHBORHOOD DEMOGRAPHICS

329 BROADWAY

191,930

POPULATION
WITHIN 1-MILE
RADIUS

36.90 Yrs

AVERAGE
POPULATION
AGE

32.02%

POPULATION
GROWTH
SINCE 2010

\$108,216

AVERAGE HHI
WITHIN 1-MILE
RADIUS

5,231

TOTAL BUSINESSES
WITHIN 1-MILE
RADIUS

\$1.2 bn

ANNUAL SPENDING
WITHIN 1-MILE
RADIUS



NEIGHBORHOOD & TRANSPORTATION

329 BROADWAY

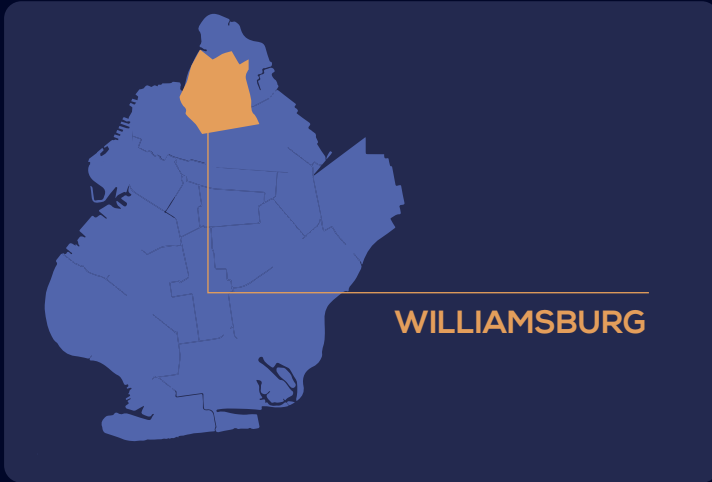

NEIGHBORHOOD TENANTS

- Peter Luger Steak House
- Brooklyn Public Library
- Walgreens
- Echo Drugs
- Blink Fitness
- Equinox Williamsburg
- UMD Urgent Medical Care
- Williamsburg Bridge
- Family Dollar
- Domino Park
- Marcy Av
- TERMINAL Art & Event Space
- McDonald's
- Pies 'n' Thighs
- Williamsburg Pizza
- Gottlieb's Restaurant
- NYC Health + Hospitals/Woodhull
- FOOD BAZAAR
- Pfizer Building
- L'Industrie Pizzeria

TRANSPORTATION

- 2 Min Walk at Marcy Avenue
- 5 Min Walk at Hewes Street
- 9 Min Walk at Broadway
- 10 Min Walk at Metropolitan Avenue

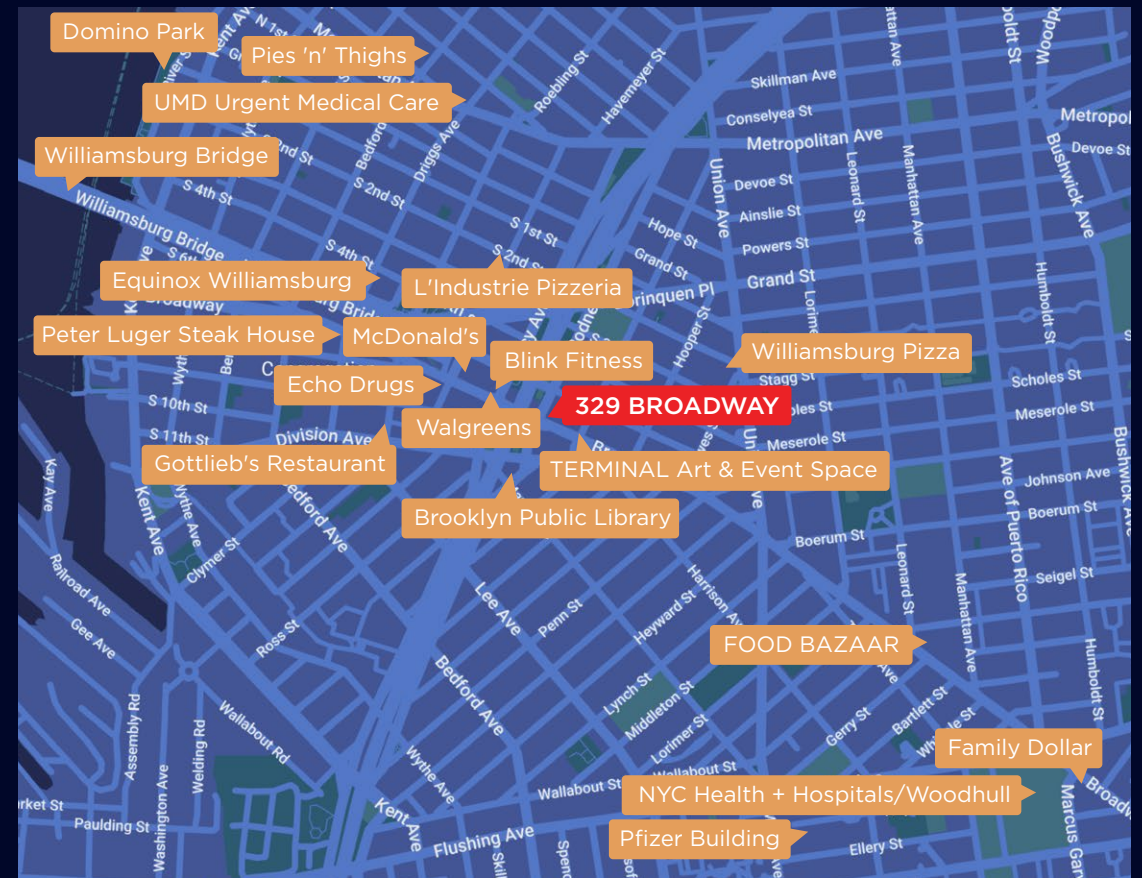

CONTACT

329 BROADWAY



JOHN LE VINE
(718) 682-7903
J@EXRNY.COM

JOSEPH DIPIAZZA
(917) 789-3009
JDIPIAZZA@EXRNY.COM

