



**226** NORTH  
LARCHMONT  
BLVD

10,135 SF OF DIVISIBLE RETAIL IN THE  
HEART OF LARCHMONT VILLAGE

LOS ANGELES | CA

# THE SPACE

**Available for the first time in 30 years**, 226 Larchmont presents a rare opportunity to lease one of the largest single buildings on Larchmont Boulevard. Offering 10,000 SF on the ground floor, the space can be divided to accommodate a variety of concepts. With 160 on-site parking spots and prime visibility, the property is surrounded by a vibrant mix of local favorites and national brands, including Larchmont Village Wine & Cheese, Faherty, Buck Mason, Salt & Straw, Levain Bakery, Malin + Goetz, Great White and the just newly opened Max & Helen.

## APPROXIMATE SIZE

Ground Floor: 10,135 SF

\*Divisible

## FRONTAGE

88 FT on N Larchmont Boulevard

## CEILING HEIGHT

16 FT

## SITE STATUS

Formerly Rite Aid

## TERM

Long Term

## POSSESSION

Arranged

## COMMENTS

- One of the largest single building on the street
- Space can be demised
- 160 on-site parking spaces with validation

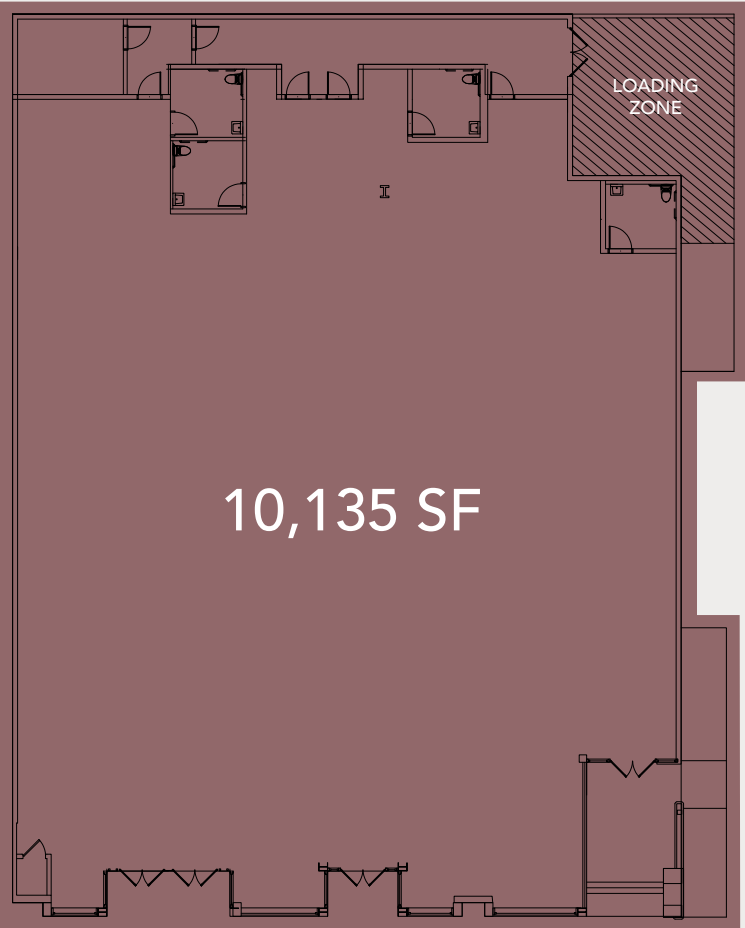

88 FT

NORTH LARCHMONT BOULEVARD

## \*DEMISED PLAN

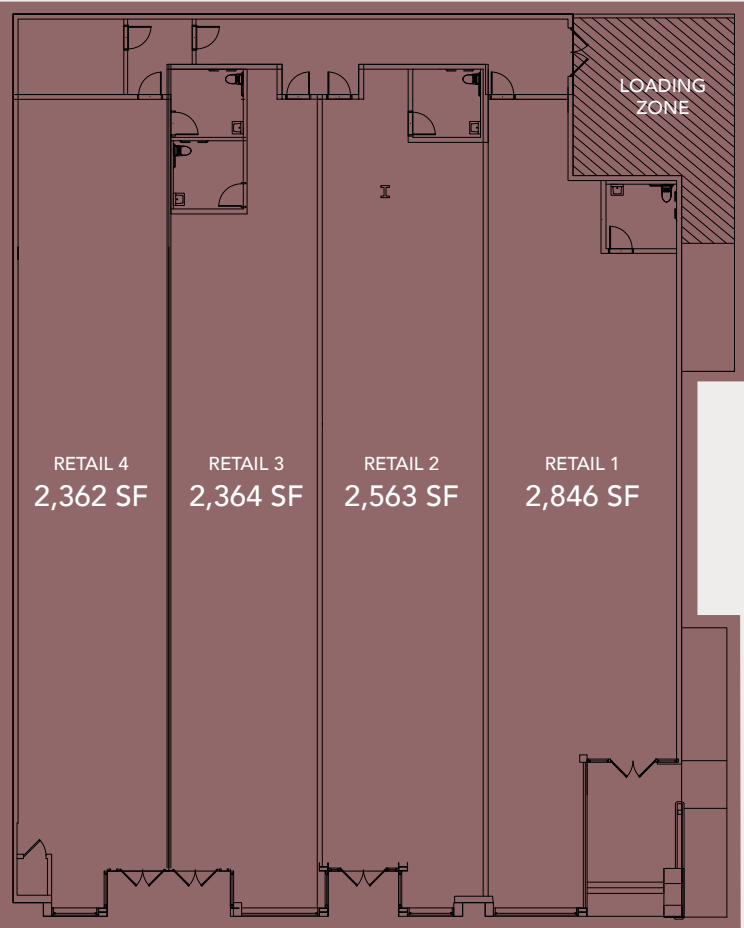

20 FT 20 FT 22 FT 26 FT



# HANCOCK PARK

Hancock Park is a historic and affluent neighborhood celebrated for its grand estates, tree-lined avenues, and rich architectural heritage. This serene residential enclave offers a rare blend of tranquility and accessibility - just moments away from the energy of Larchmont Village, Koreatown, Paramount Studios, and the Miracle Mile. One of the city's rare walkable communities where residents can enjoy the unique convenience of strolling from home to charming boutiques, cafes, and daily essentials - all within reach.





AREA  
DEMOGRAPHICS

RADIUS	 DAYTIME POPULATION	 AVG. HOUSEHOLD INCOME	 MEDIAN AGE
1 MILE	+45,000	+\$110,000	36 years
3 MILES	+480,000	+\$85,000	35 years



226 NORTH  
LARCHMONT  
BLVD

# CONTACT EXCLUSIVE AGENTS

ROBERT COHEN

VICE CHAIRMAN

310-593-0770

ROBERT.COHEN@NMRK.COM

LIC #01800848

BEN COHEN

ASSOCIATE

310-407-6579

BEN.COHEN@NMRK.COM

LIC #02079447

NEWMARK | PACIFIC

125 PARK AVENUE | NEW YORK , NY 10017 | Licensed in New York as Newmark Retail, Real Estate Broker

©2025 NEWMARK The information contained herein has been obtained from sources deemed reliable but has not been verified and no guarantee, warranty or representation, either express or implied, is made with respect to such information. Terms of sale or lease and availability are subject to change or withdrawal without notice.

