



**FOR LEASE**

• 13,000 SF Industrial Building

## FEATURES:

- 13,000 SF Building
- 100% HVAC
- ± 3,000 SF Office Space
- 400 Amps of Power
- Six (6) Private Offices
- Two (2) Grade Level Loading Doors
- Prime Irvine Business Complex Location
- Conveniently Located to the 55, 405, & 5 Freeways



**1824-1826 Kaiser Avenue, Irvine, CA 92614**

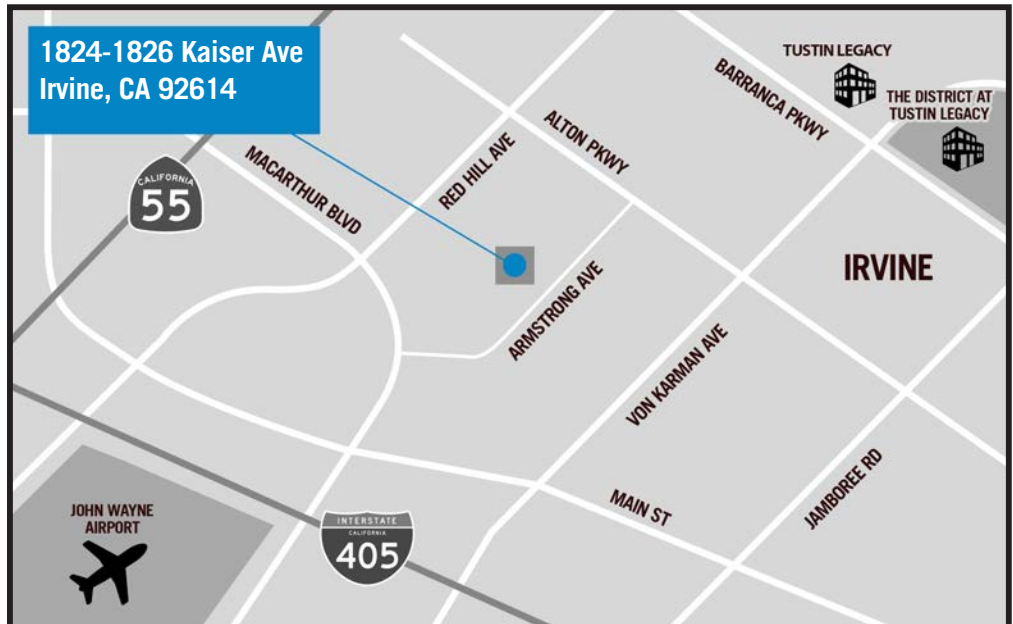

This information has been furnished from sources which we deem reliable; however, we do not guarantee its accuracy and assume no liability. Do not rely on any of the information contained herein without verifying it yourself directly with the listing broker or owner.

## FOR FURTHER DETAILS:

**PARKER ROBERTS**

parker@tricoirealty.com  
BRE#01994597

**DAVID KLING**

david@tricoirealty.com  
BRE#01965659

**Trico Realty, Inc.**

3100-A Pullman Street  
Costa Mesa, CA 92626  
(714) 751-4420 • License #00342120

For additional information  
Visit our Website at [www.TricoRealty.com](http://www.TricoRealty.com)



1824-1826 Kaiser Avenue  
Irvine, CA 92614

**FOR LEASE**

• 13,000 SF Industrial Building

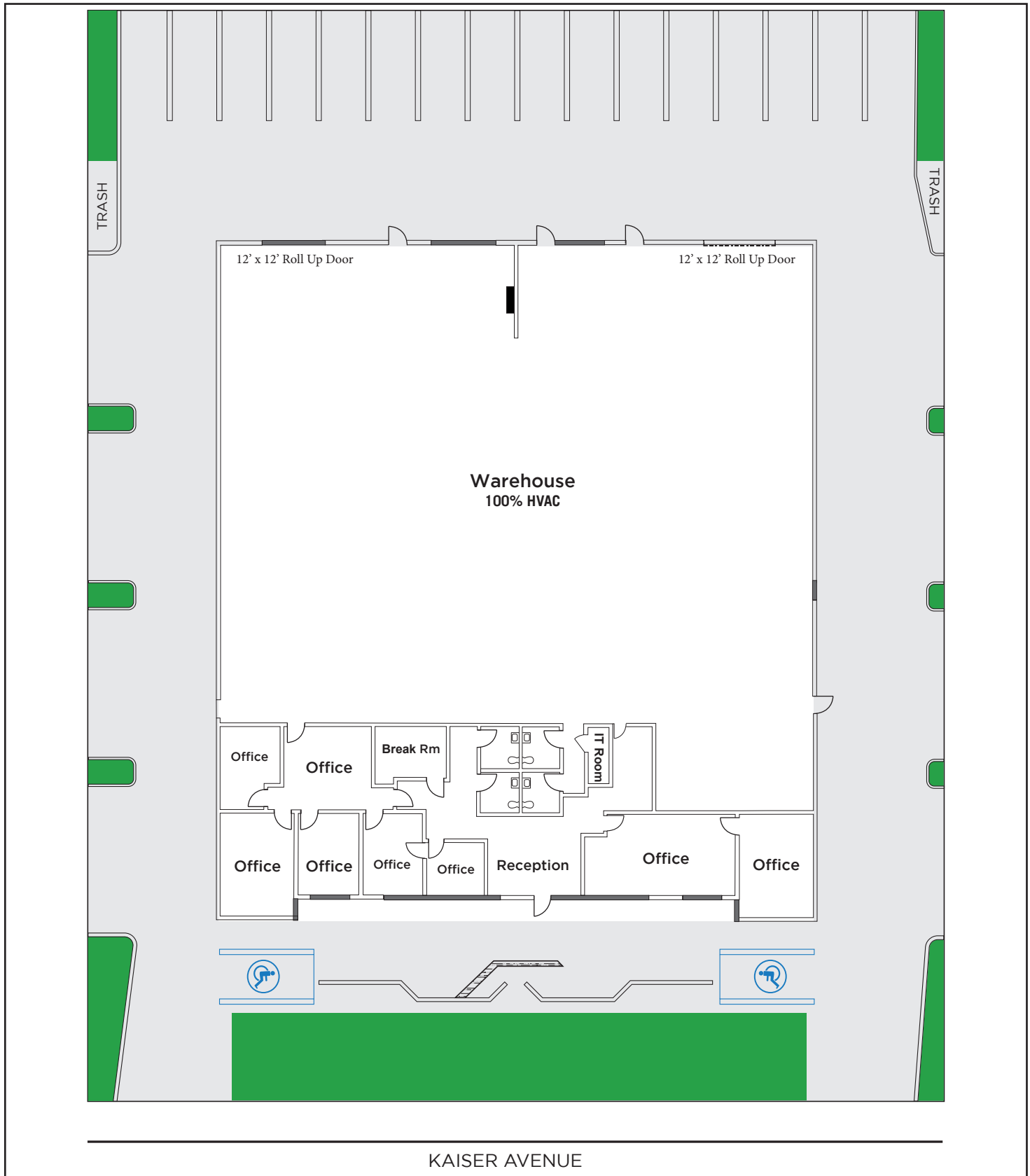

**Trico Realty, Inc.**

3100-A Pullman Street  
Costa Mesa, CA 92626

(714) 751-4420 • License #00342120

For additional information  
Visit our Website at [www.TricoRealty.com](http://www.TricoRealty.com)



1824-1826 Kaiser Avenue  
Irvine, CA 92614

**FOR LEASE**

• 13,000 SF Industrial Building

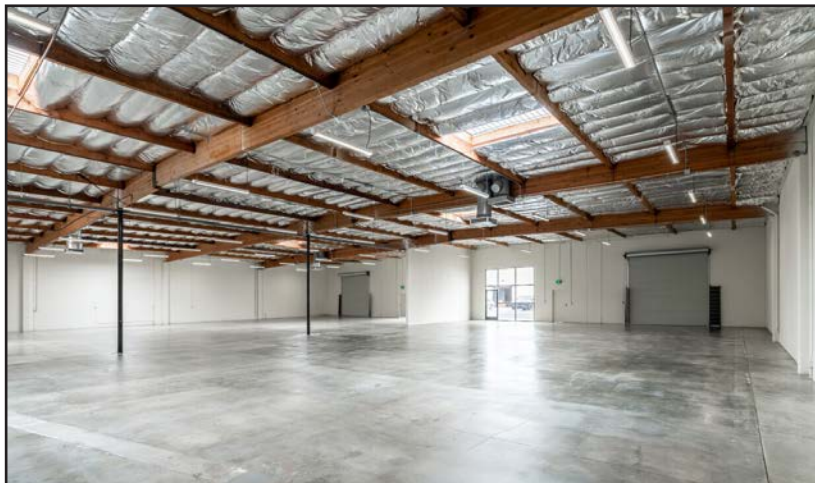

**Trico Realty, Inc.**

3100-A Pullman Street  
Costa Mesa, CA 92626

(714) 751-4420 • License #00342120

For additional information  
Visit our Website at [www.TricoRealty.com](http://www.TricoRealty.com)

