



WEST PENN HARDWOODS
120,000+/- SQUARE FEET AVAILABLE
1405 DEBORAH HERMAN ROAD
CONOVER, NORTH CAROLINA





BINSWANGER

5950 FAIRVIEW ROAD, SUITE 650, CHARLOTTE, NC 28210
704-377-0801 • FAX: 704-552-1626 • E-MAIL: INFO@BINSWANGER.COM

WEST PENN HARDWOODS 1405 DEBORAH HERMAN ROAD CONOVER, NC 28613

SIZE:	Approximately 120,000 sq. ft. available
DIMENSIONS:	400' x 300'
CONDITION OF PROPERTY:	Excellent
DATE OF CONSTRUCTION:	2000
CONSTRUCTION:	Floor: 6" reinforced concrete Walls: Insulated metal with 7' liner panel Columns: Steel Roof: Insulated standing seam metal
COLUMN SPACING:	30' x 50', 25' x 42' and 25' x 54'
CEILING HEIGHT:	21' eaves and 24' clear center below the main structural steel.
LIGHTING:	LED – UFO fixtures. Skylights in 37,500 SF
WATER:	Supplied by Town of Conover 10" main; 8" line
SEWER:	Supplied by Town of Conover
GAS:	Supplied by Piedmont Natural Gas

The information contained herein is from sources deemed reliable but no warranty of representation is made as to the accuracy thereof.

REGIONAL • NATIONAL • INTERNATIONAL REAL ESTATE

REGIONAL OPERATIONS: Atlanta, GA • Charlotte, NC • Chicago, IL • Dallas, TX • Denver, CO • Detroit, MI • King of Prussia, PA • Los Angeles, CA • Melville, NY • Miami, FL • Minneapolis, MN • Nashville, TN • Natick, MA • New York, NY • Newport Beach, CA • Owings Mills, MD • Oxford, MS • Philadelphia, PA • Tampa, FL • Toledo, OH • Washington, D.C. • Woodland Hills, CA • Bangkok • Buenos Aires • Caracas • Hanoi • Hamburg • Lima • London • Madrid • Mexico City • Mumbai • Paris • Quito • Sao Paulo • Santiago • Seoul • Shanghai • Singapore • Tel Aviv • Taipei • Tokyo • Toronto • Warsaw • Zurich

160 Offices Worldwide
North America • South America
Europe • Middle East
Asia • Australia
www.binswanger.com

**1405 DEBORAH HERMAN ROAD
CONOVER, NC
PAGE 2**

POWER:	Supplied by Duke Energy Company <ul style="list-style-type: none">- 1,200 amp, 480/277 volt, 3 phase, 4 wire switchgear- 750 VA pad mounted transformer
HVAC	Heated by suspended gas blowers and ventilated by wall fans and louvers.
SPRINKLER SYSTEM:	100% wet system 37,500 SF is .371/3000. 82,500 SF is ESFR.
OFFICE:	Approximately 2,400 square feet of interior office and restroom area, and a small shipping office at the rear dock doors.
RESTROOMS	Men - two toilets, one urinal, one sink Women - three toilets, one sink
TRUCK LOADING:	<ul style="list-style-type: none">- Six 8' x 9' electric roll up doors with levelers, seals- One 25' W x 16' H electric drive in door.
PARKING:	Paved and marking for approx. 45 automobiles
FORMER USE:	Warehousing
ZONING:	M1 – General Manufacturing
TRANSPORTATION:	The facility is located just south of four lane Highway 70, less than 2 miles west of exit 130 on I-40.

The information contained herein is from sources deemed reliable but no warranty of representation is made as to the accuracy thereof.

REGIONAL • NATIONAL • INTERNATIONAL REAL ESTATE

REGIONAL OPERATIONS: Atlanta, GA • Charlotte, NC • Chicago, IL • Dallas, TX • Denver, CO • Detroit, MI • King of Prussia, PA • Las Vegas, Nevada
Los Angeles, CA • Melville, NY • Miami, FL • Minneapolis, MN • Natick, MA • New York, NY • Newport Beach, CA • Owings Mills, MD
Oxford, MS • Philadelphia, PA • Seattle, WA • Tampa, FL • Toledo, OH • Washington, D.C. • Woodland Hills, CA • Bangkok • Buenos Aires • Caracas • Hanoi
Hamburg • Lima • London • Madrid • Mexico City • Mumbai • Paris • Quito • Sao Paulo • Santiago • Seoul • Shanghai • Singapore • Tel Aviv • Taipei
Tokyo • Toronto • Warsaw • Zurich

160 Offices Worldwide
North America • South America
Europe • Middle East
Asia • Australia
www.binswanger.com

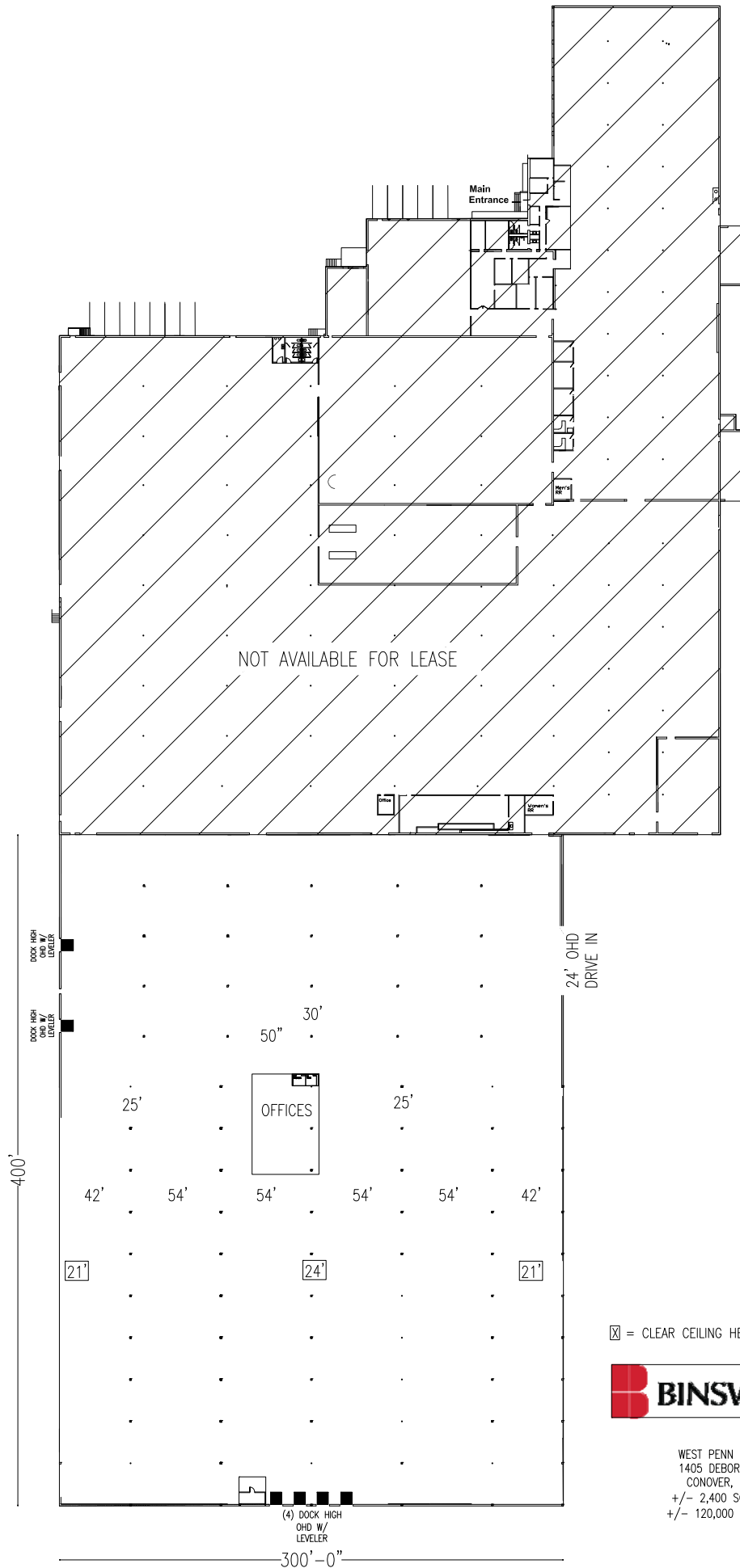

☒ = CLEAR CEILING HEIGHT



WEST PENN HARDWOODS
1405 DEBORAH HERMAN
CONOVER, NC 28613
+/- 2,400 SQ. FT. OFFICE
+/- 120,000 SQ. FT. TOTAL

NOTE: INFORMATION CONTAINED IN THIS DRAWING IS DERIVED FROM SOURCES DEEMED RELIABLE, BUT IS NOT GUARANTEED. DRAWING IS DIAGNOSTIC, ALL LOCATIONS, MEASUREMENTS, AND DIMENSIONS ARE APPROXIMATE.



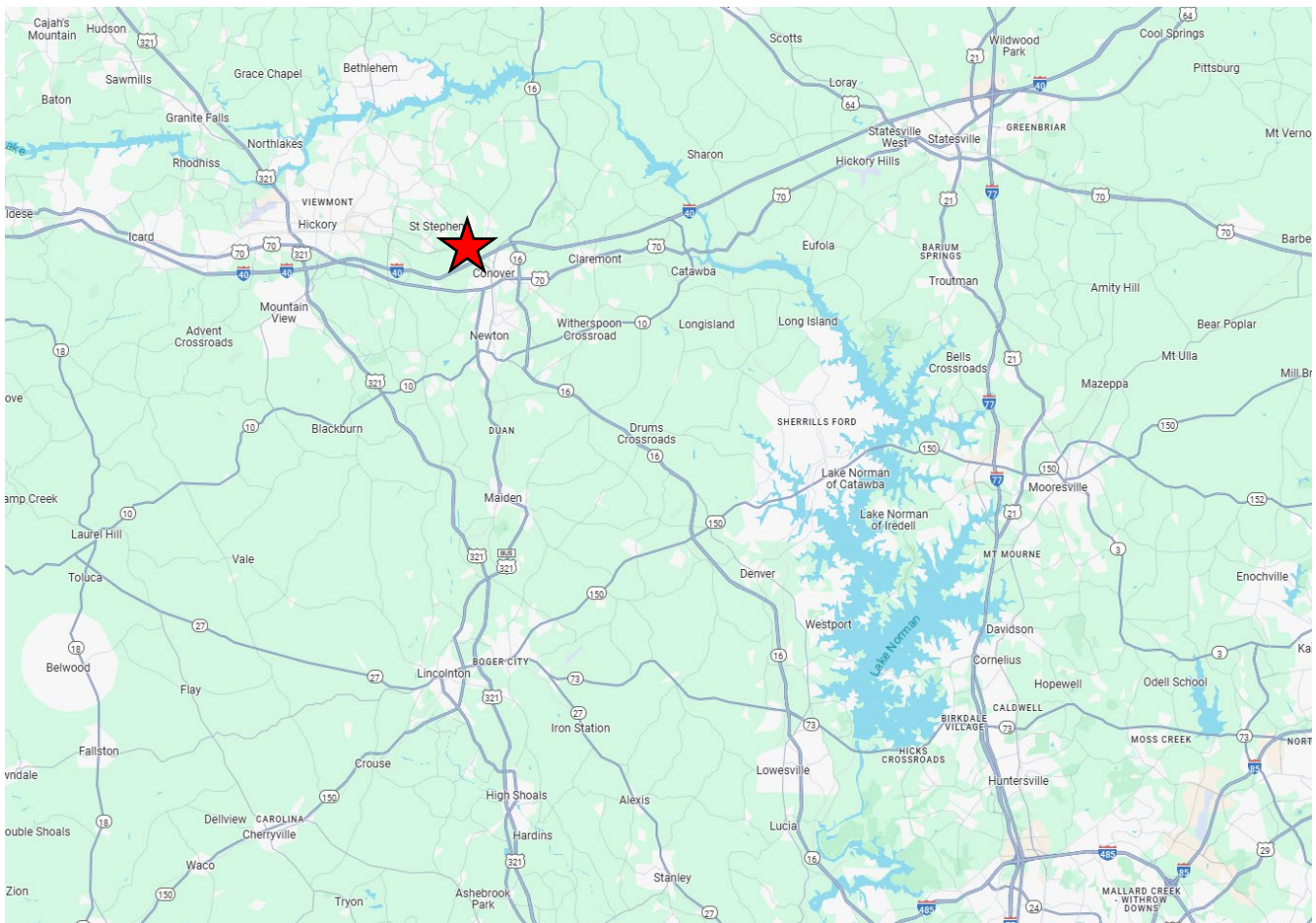

1405 DEBORAH HERMAN ROAD
CONOVER, NC