

# Northpoint Business Center

Class A Industrial - ±66,772 SF For Lease

3101 N. Lamb Blvd. | Las Vegas, NV 89115



**CBRE**

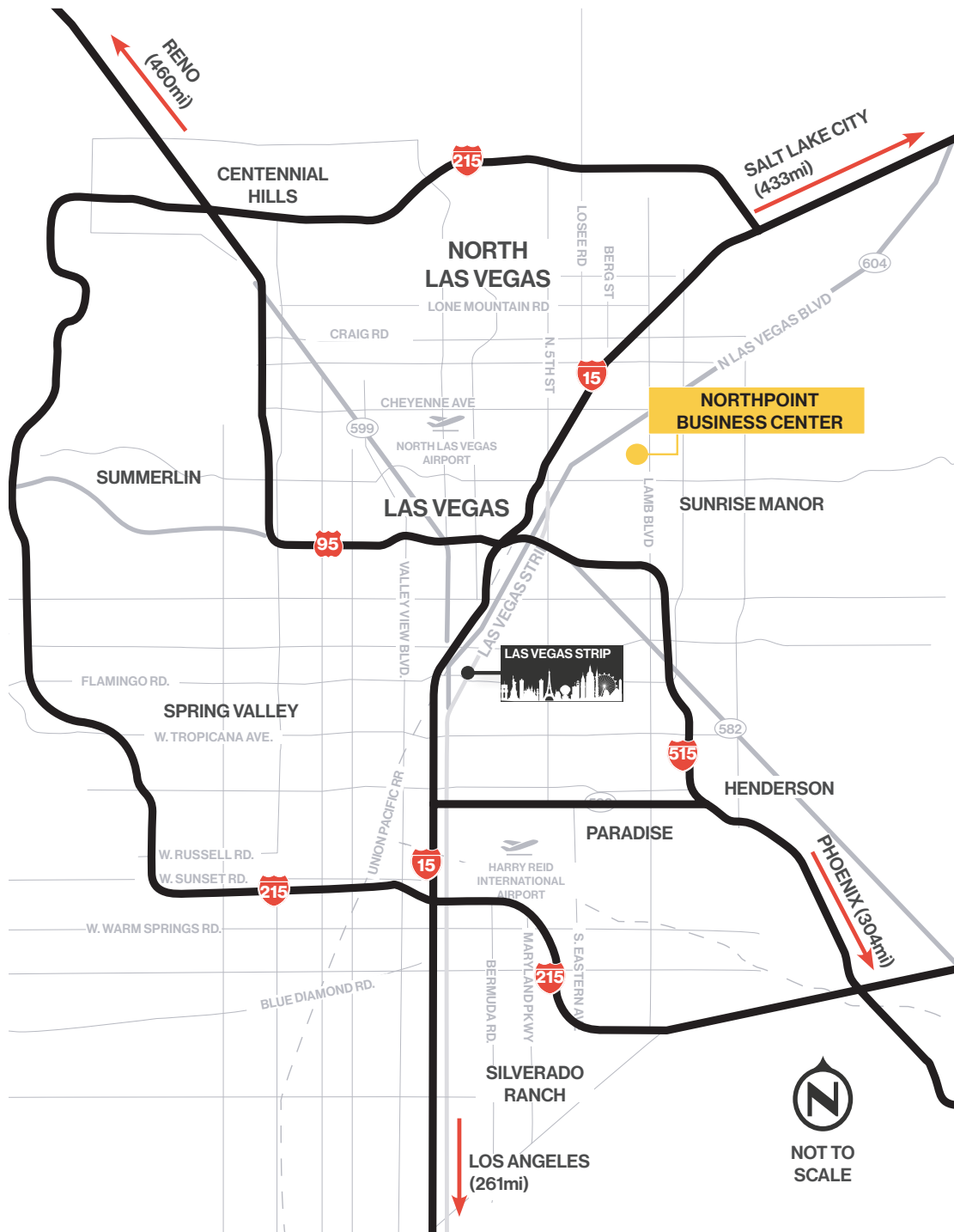

# Location Highlights

- Access to I-15 via Cheyenne Ave.
- Jurisdiction: Clark County
- Zoned M-1 (Light Manufacturing)

# Property Highlights

- ±66,772 SF
- ±2,000 SF office
- Frontage of Lamb Blvd.
- Front loaded unit
- Column spacing:  
50' x 50' typical column spacing  
50' x 65' loading bay
- ESFR sprinkler system
- 32' clear height
- 19 dock doors, 1 grade door
- 6 dock levelers
- 1.5% Skylights
- ±140' truck court with 60' concrete dock apron
- 600 A, 277/480 V, 3-Phase Power
- 2006 construction
- Available Now
- **Rental Rate: \$0.92 PSF NNN**

# Project Site Plan

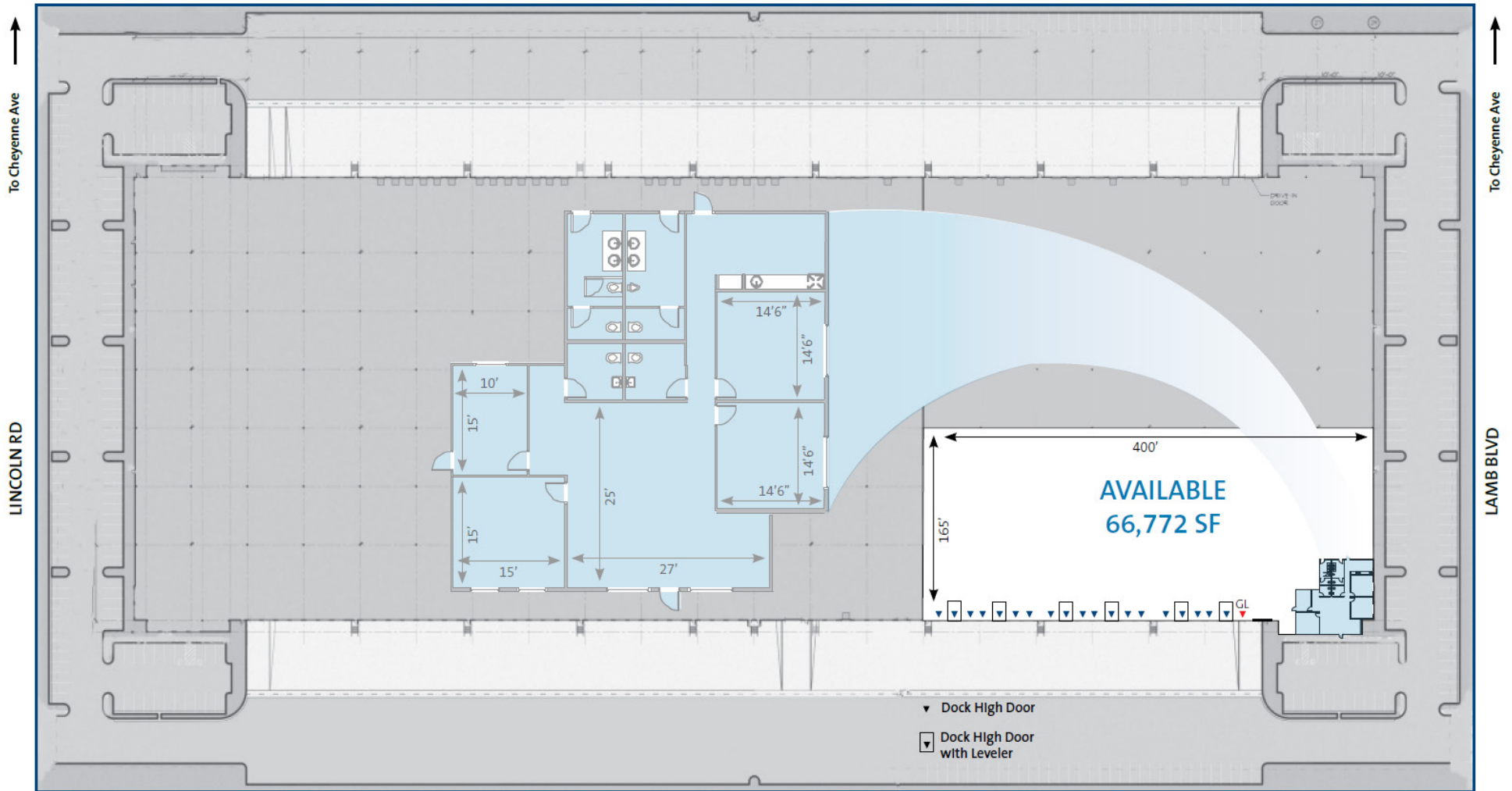



# Interior Photos





# Location Map

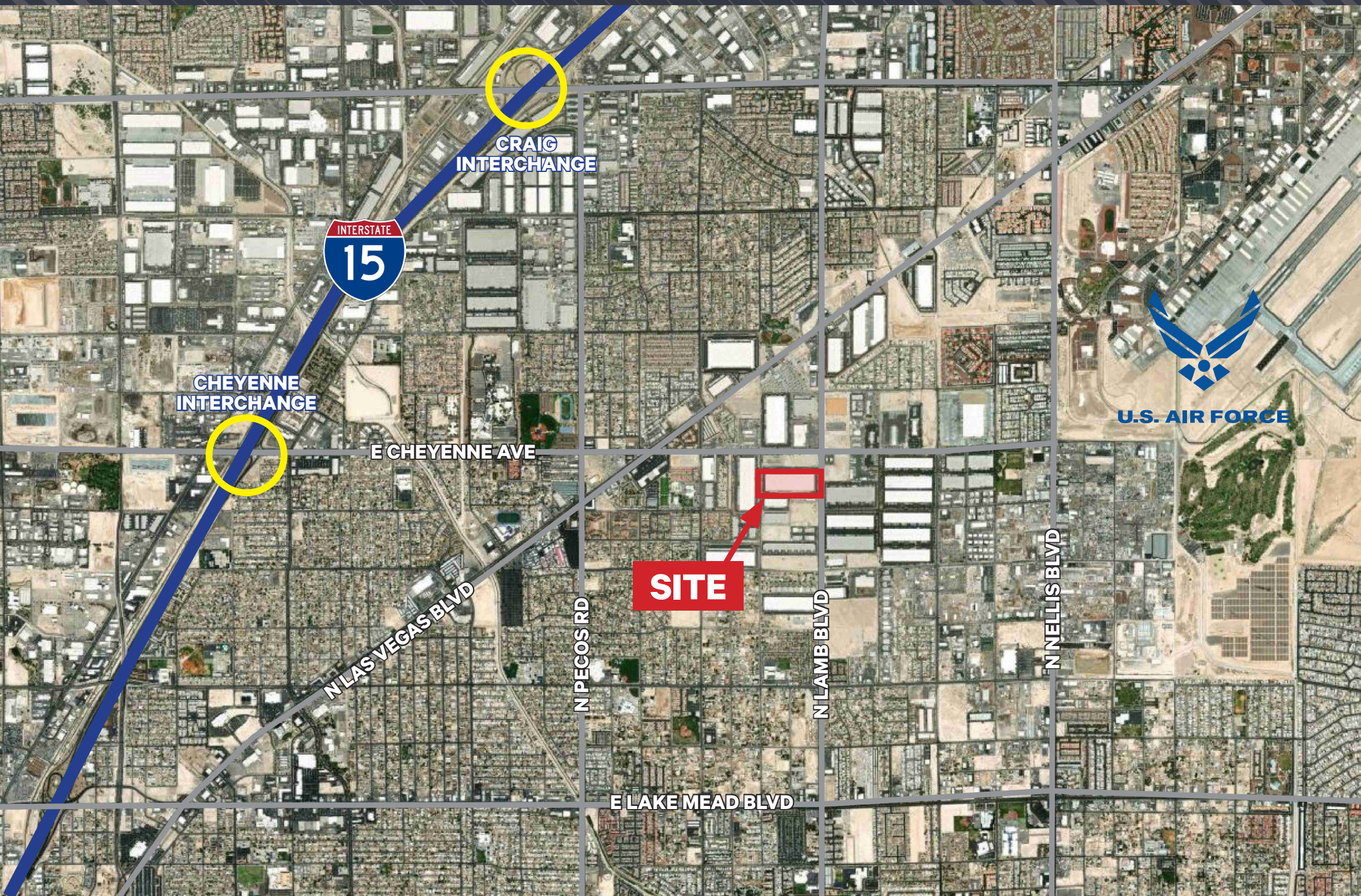



# Regional Advantage

## Location & Transportation

- I-15 Interchange is  $\pm 2.3$  miles via Cheyenne Ave.
- US-95 interchange is  $\pm 9.7$  miles
- Harry Reid Airport is  $\pm 11.6$  miles
- The Las Vegas Strip is  $\pm 11.3$  miles

## Shipping & Mailing Services

- FedEx Freight 2.3 Miles
- FedEx Ship Center 4.2 Miles
- FedEx Air Cargo 13.2 Miles
- FedEx Ground 5.0 Miles
- UPS Freight Service Center 2.5 Miles
- UPS Customer Center 6.4 Miles
- UPS Air Cargo 13.9 Miles
- US Post Office 7.8 Miles

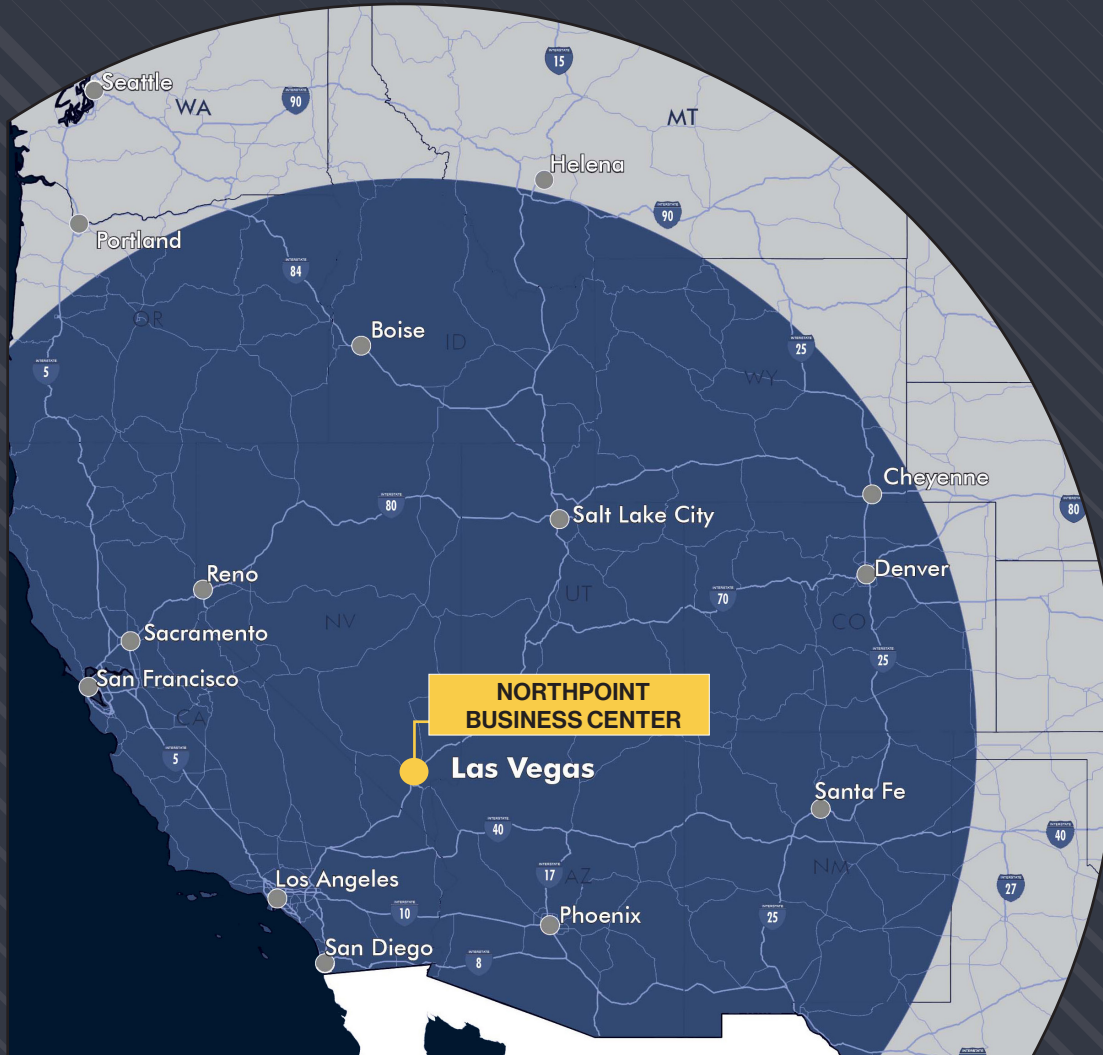

### Transit Analysis From Las Vegas, NV

	Distance (mi.)	Time (est.)		Distance (mi.)	Time (est.)
Los Angeles, CA	262	4 hrs, 1 min	Boise, ID	636	9 hrs, 49 min
Phoenix, AZ	335	5 hrs, 25 min	Santa Fe, NM	640	9 hrs, 8 min
San Diego, CA	323	4 hrs, 58 min	Denver, CO	761	11 hrs, 14 min
Salt Lake City, UT	433	6 hrs, 19 min	Cheyenne, WY	846	12 hrs, 44 min
Reno, NV	447	7 hrs, 4 min	Helena, MT	914	13 hrs, 11 min
San Francisco, CA	561	8 hrs, 35 min	Portland, OR	975	15 hrs, 50 min
Sacramento, CA	564	8 hrs, 36 min	Seattle, WA	1,126	17 hrs, 14 min

# Las Vegas Business Facts



## Nevada Tax Climate

- No Corporate Income Tax
- No Admissions Tax
- No Personal Income Tax
- No Unitary Tax
- No Franchise Tax on Income
- No Inventory Tax



## Business Assistance Programs

- Sales and Use Tax Abatement
- Modified Business Tax Abatement
- Personal Property Tax Abatement
- Real Property Tax Abatement for Recycling
- TRAIN Employees Now (TEN)
- Silver State Works Employee Hiring Incentive



## Labor

- Nevada has one of the lowest labor costs in the region
- According to the U.S. Bureau of Labor Statistics, the metro Las Vegas area has more than 105,800 workers in the distribution/transportation/warehousing and manufacturing industries
- Over 60,000 students are enrolled in the University of Nevada Las Vegas and the College of Southern Nevada
- According to CBRE-EA, over the next 5 years, manufacturing jobs are expected to grow by 1.6% and transportation and warehousing by 0.8%
- All industrial employment sectors in Las Vegas are expected to grow faster than the national averages
- Year-end 2023 employment growth was 4.1% in Las Vegas and 3.5% in Nevada, both higher than the National Average of 1.9%



3101 N. Lamb Blvd. | Las Vegas, NV 89115

# Northpoint Business Center

## CONTACTS

**Garrett Toft, SIOR**

Vice Chairman  
Lic. BS.00161824  
702.369.4858  
garrett.toft@cbre.com

**Kevin Higgins, SIOR**

Vice Chairman  
Lic. BS.0016109  
702.369.4944  
kevin.j.higgins@cbre.com

**CBRE**

© 2024 CBRE, Inc. All rights reserved. This information has been obtained from sources believed reliable but has not been verified for accuracy or completeness. CBRE, Inc. makes no guarantee, representation or warranty and accepts no responsibility or liability as to the accuracy, completeness, or reliability of the information contained herein. You should conduct a careful, independent investigation of the property and verify all information. Any reliance on this information is solely at your own risk. CBRE and the CBRE logo are service marks of CBRE, Inc. All other marks displayed on this document are the property of their respective owners, and the use of such marks does not imply any affiliation with or endorsement of CBRE. Photos herein are the property of their respective owners. Use of these images without the express written consent of the owner is prohibited.