

AVAILABLE FOR LEASE

NWC OF JENSEN & BETHEL AVENUES

SANGER, CA



Vincent Giorlando
Sales Associate
t. 559-447-6225
vincent@retailcalifornia.com
CA RE Lic. #02225390

Rachael Orlando
Senior Vice President
t. 559-447-6252
rachael@retailcalifornia.com
CA RE Lic. #01890236

Independently Owned and Operated | Corporate License #00020875 | retailcalifornia.com

FRESNO OFFICE: 7480 N. Palm Ave. #101, Fresno, CA 93711, t. 559-432-6200

The distributor of this communication is performing acts for which a real estate license is required. The information contained herein has been obtained from sources deemed reliable but has not been verified and no guarantee, warranty or representation, either express or implied, is made with respect to such information. Terms of sale or lease and availability are subject to change or withdrawal without notice.

NWC OF JENSEN & BETHEL AVENUES

SANGER, CA

PROPERTY

INFORMATION

Availability: 2,900± SF
Pad Space

PROPERTY DESCRIPTION

This high-visibility shopping center offers prime retail spaces in a well-established Sanger retail corridor. Anchored by Dollar Tree and Grocery Outlet, the center features ample parking, flexible space configurations, and strong frontage along Jensen Avenue. The mix of tenants creates a vibrant shopping destination, ideal for retail, restaurant, or service-oriented businesses looking to capture consistent community traffic.

HIGHLIGHTS

- Available Space: 2,900± SF, Pad Space
- Hardwood floors, and open layout—ready for immediate use
- Bathrooms: 2 fully functional restrooms
- High Visibility: Excellent frontage along Jensen Avenue
- Parking: Ample customer parking onsite
- Flexible Use: Ideal for retail, professional office, or service-oriented businesses

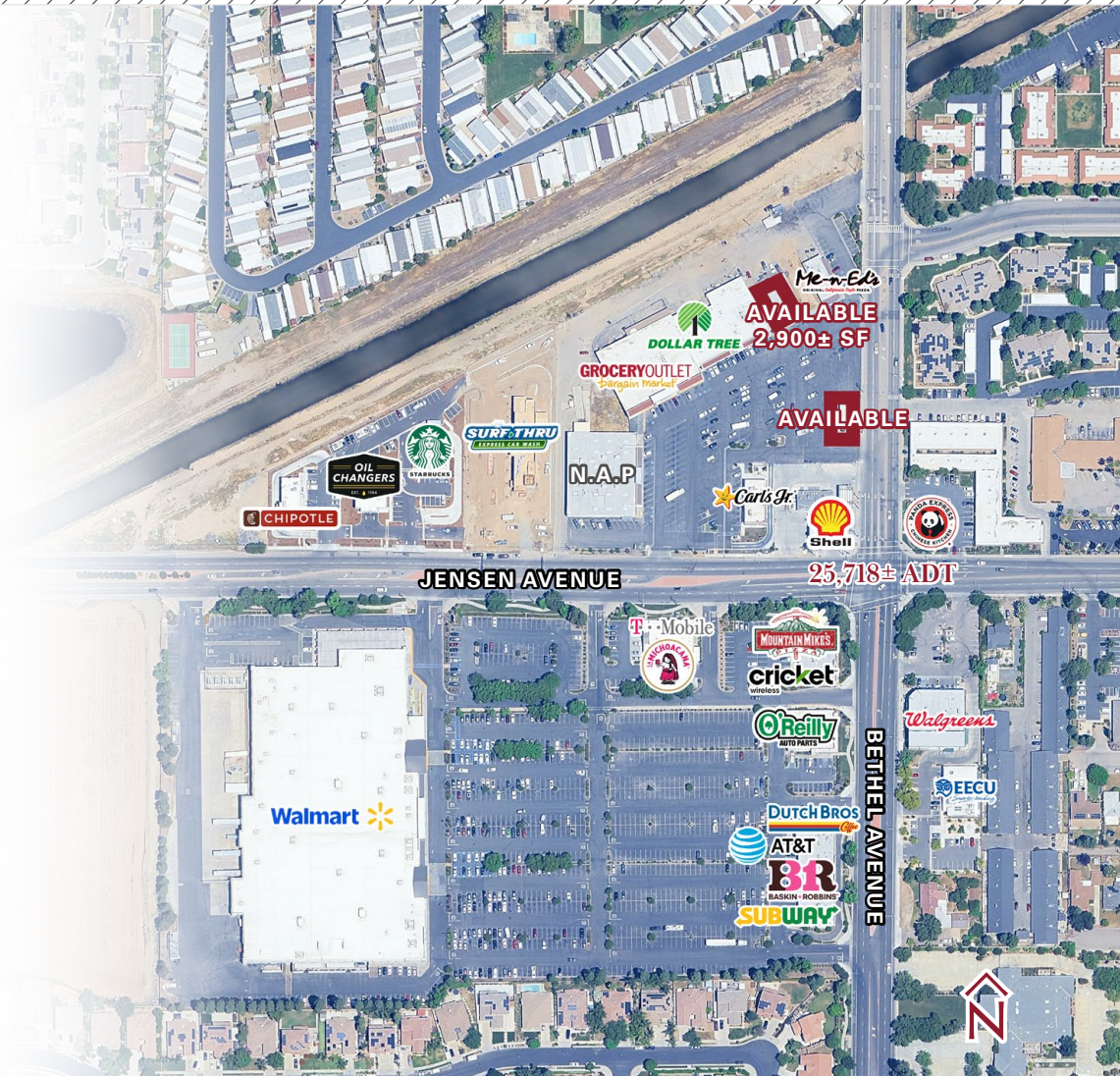

\$1.25 (PSF/Monthly)
LEASE RATE

NNN
LEASE TYPE

NWC OF JENSEN & BETHEL AVENUES

SANGER, CA

AREA
DEMOGRAPHICS

LOCATION DESCRIPTION

Situated at the northwest corner of Jensen Avenue and Bethel Avenue, the property enjoys excellent exposure to daily traffic and easy access from surrounding neighborhoods. The center is in the heart of Sanger, providing convenient proximity to residential areas, schools, and other key community amenities. Its central location positions tenants to benefit from both local and regional shoppers in a growing retail market.

POPULATION

HOUSEHOLD

DEMOGRAPHICS	1 MILE RADIUS	3 MILE RADIUS	5 MILE RADIUS
2030 Projection	13,576	29,255	34,944
2025 Estimate	13,485	29,161	34,759
2030 Projection	4,005	8,359	10,160
2025 Estimate	4,000	8,329	10,075
<i>2025 Est. Average HH Income</i>	\$110,216	\$96,045	\$98,151

Source: Claritas 2025



TRAFFIC COUNTS

25,718± ADT

Jensen Avenue at Bethel Avenue
(Intersection)

Source: Kalibrate TrafficMetrix 2025

NWC OF JENSEN & BETHEL AVENUES

SANGER, CA

SITE PLAN

AND INTERIOR IMAGES

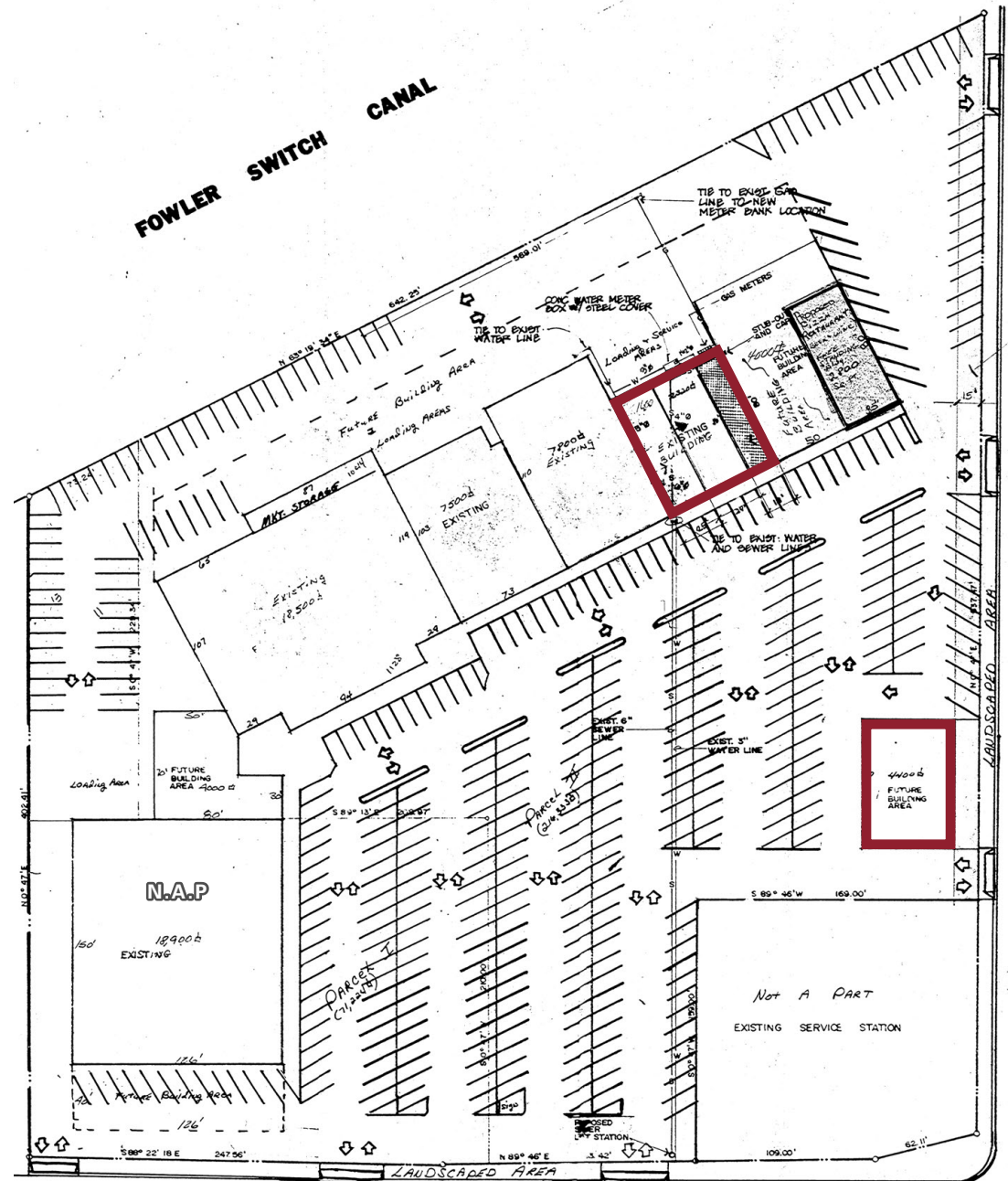

NWC OF JENSEN & BETHEL AVENUES

SANGER, CA

AERIAL

MAP



AVAILABLE FOR LEASE

NWC OF JENSEN & BETHEL AVENUES

SANGER, CA

For information, please contact:

Vincent Giorlando

Sales Associate

t 559-447-6225

vincent@retailcalifornia.com

CA RE Lic. #02225390

Rachael Orlando

Senior Vice President

t 559-447-6252

rachael@retailcalifornia.com

CA RE Lic. #01890236



Independently Owned and Operated
Corporate License #00020875
retailcalifornia.com

FRESNO OFFICE
7480 N. Palm Ave. #101
Fresno, CA 93711
t 559-432-6200

The distributor of this communication is performing acts for which a real estate license is required. The information contained herein has been obtained from sources deemed reliable but has not been verified and no guarantee, warranty or representation, either express or implied, is made with respect to such information. Terms of sale or lease and availability are subject to change or withdrawal without notice.