

Light Industrial / Flex Building

Includes ±3,600 SF Office

600 Conrad Harcourt Way
Rushville, Indiana 46173
www.cbre.com/indy





Property Information

Located in northeast Rushville, Indiana, this warehouse with office sits on approximately two acres of land.

Sale Price	\$595,000
Building Size	±8,500 SF
- Warehouse	4,900 SF
- Office	3,600 SF
Lot Size	±2.0 AC

Features

- + Ideal owner/user opportunity
- + Two (2) overhead doors
- + Paved parking
- + Partially fenced
- + Multiple warehouse/office use potential
- + 240 volt power with overcurrent-protection breakers
- + Concrete floors; floor drain
- + One-story, built in 1981

Industrial / Flex

600 Conrad Harcourt Way | Rushville, Indiana 46173

For Sale



Building Information

Building Size	8,500 SF
Lot Size	2.0 AC
Lot Dimension	±410' X 213'
Year Built	1981
Stories	One (1)
Door	Two (2) overhead
Ceiling Ht.	14' Warehouse / 10' Office

Service Voltage	240 volts
Overcurrent Protection	Breakers
Sprinklered	No
County / ID No.	Rush / 70-07-32-126-003.000-011
Construction	Steel Frame
Restrooms	Two (2) - Half-Bath
Parking	Asphalt

Floor Plan

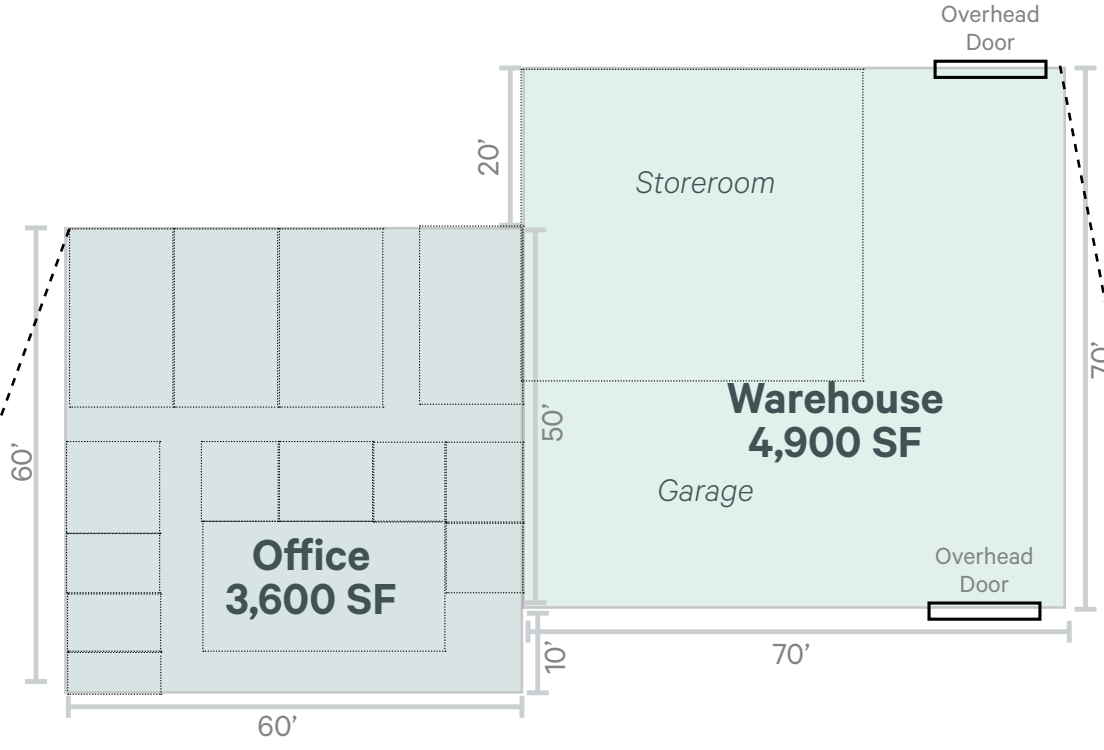

Parking Lot

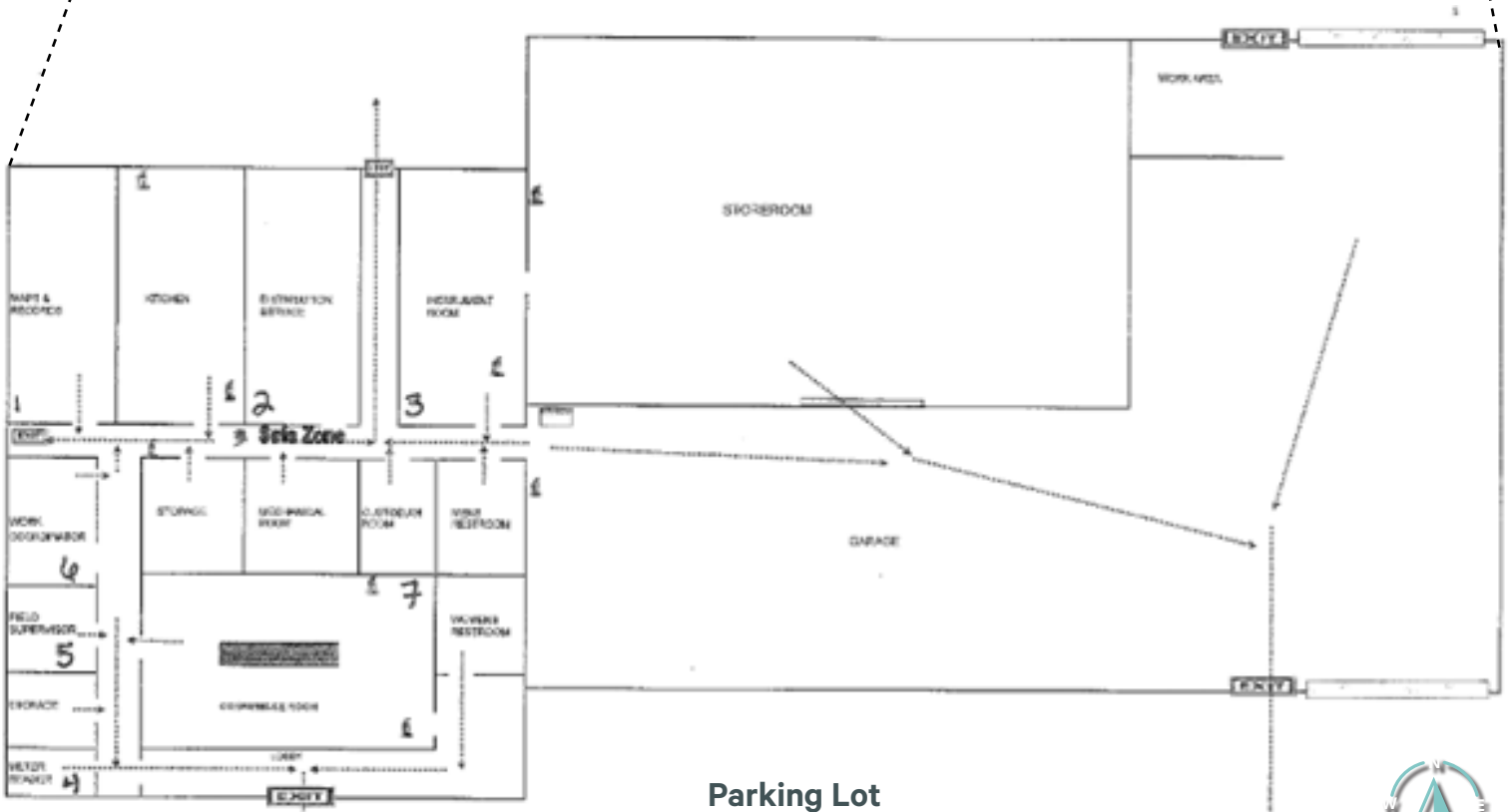

Parking Lot



Industrial / Flex

600 Conrad Harcourt Way | Rushville, Indiana 46173

For Sale



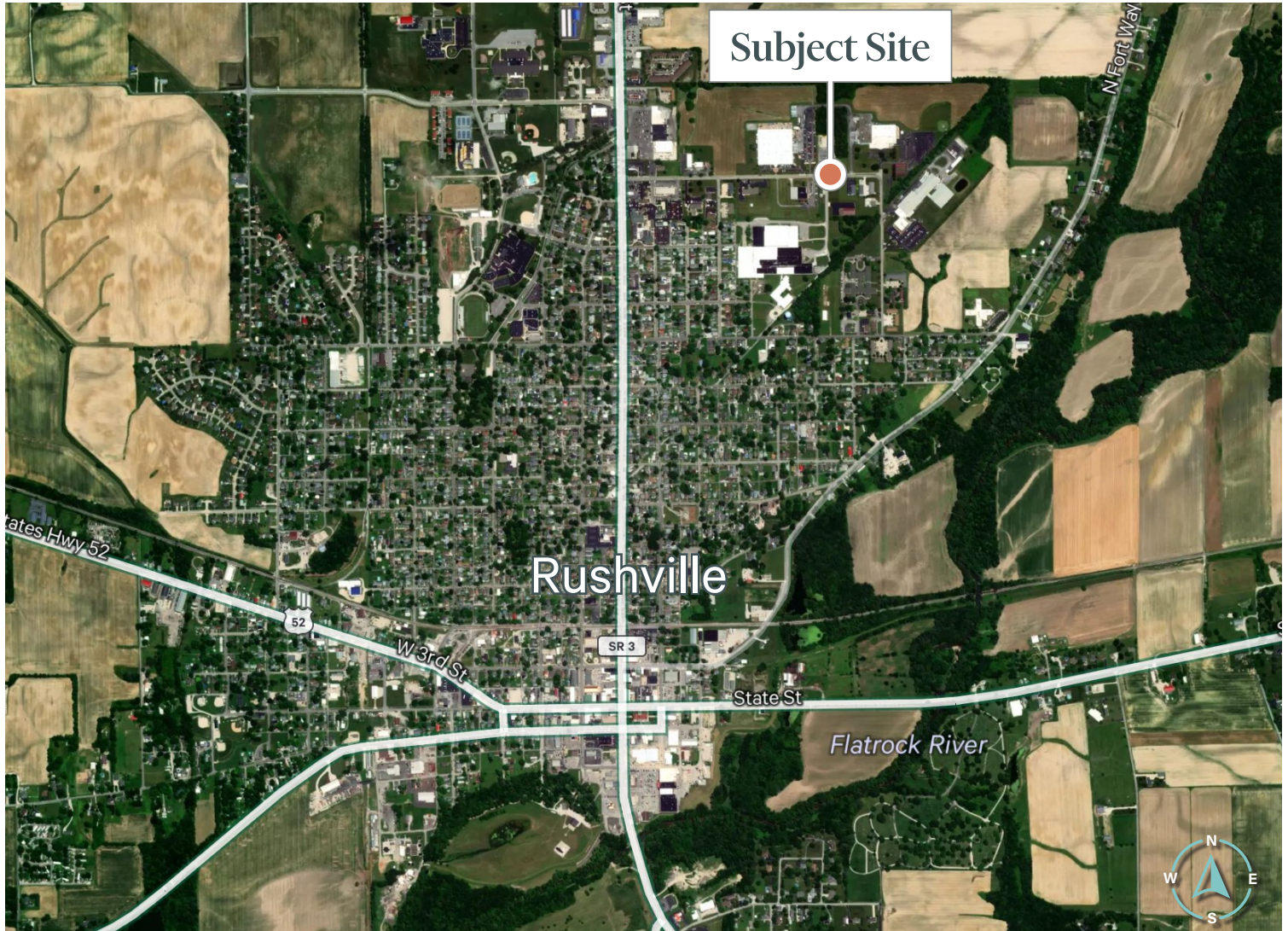

Contact Us

Kyle Powell

Vice President

+1 317 269 1064

kyle.powell@cbre.com

© 2024 CBRE, Inc. All rights reserved. This information has been obtained from sources believed reliable but has not been verified for accuracy or completeness. CBRE, Inc. makes no guarantee, representation or warranty and accepts no responsibility or liability as to the accuracy, completeness, or reliability of the information contained herein. You should conduct a careful, independent investigation of the property and verify all information. Any reliance on this information is solely at your own risk. CBRE and the CBRE logo are service marks of CBRE, Inc. All other marks displayed on this document are the property of their respective owners, and the use of such marks does not imply any affiliation with or endorsement of CBRE. Photos herein are the property of their respective owners. Use of these images without the express written consent of the owner is prohibited.062624