

# FOR LEASE

Office Space Available

4345 New Town Ave, Suite 201, Williamsburg, VA



**757.209.2990**

Vince A. Campana, III  
Vince@cwcrew.net

# Property Summary

Office Space Available



### Property Overview

The suite consists of six (6) private offices which are executive sized and can be readily subdivide for more individual offices. The suite is accessible from two private stairwell entrances and an elevator. Two bathrooms (men's / women's) are shared with Suite 202, as well as a shared kitchenette space. Suite 201 also has two private balcony spaces that are outdoors and provide a picturesque vista of New Town. Most of the offices have large windows and ample natural light. The space is ideal for a professional seeking private office space with an executive feel. This is a rare find and a must see!

### Suite Size

2,249 SF of Private Office Space  
416 SF of shared space

### Zoning

MU Mixed Use

### Demographic Facts

	1 Mile	3 Miles	5 Miles
Population	8,603	45,284	83,118
Average HH Income	\$106,061	\$109,153	\$111,094
Daytime Population	6,213	66,009	80,401

### General Information

This offering consists of a gorgeous office suite located in the heart of New Town business corridor of Williamsburg, Virginia.  
Elevator access and Private stairwell  
Call for Pricing

# Layouts

4345 New Town Ave, Suite 201, Williamsburg, VA

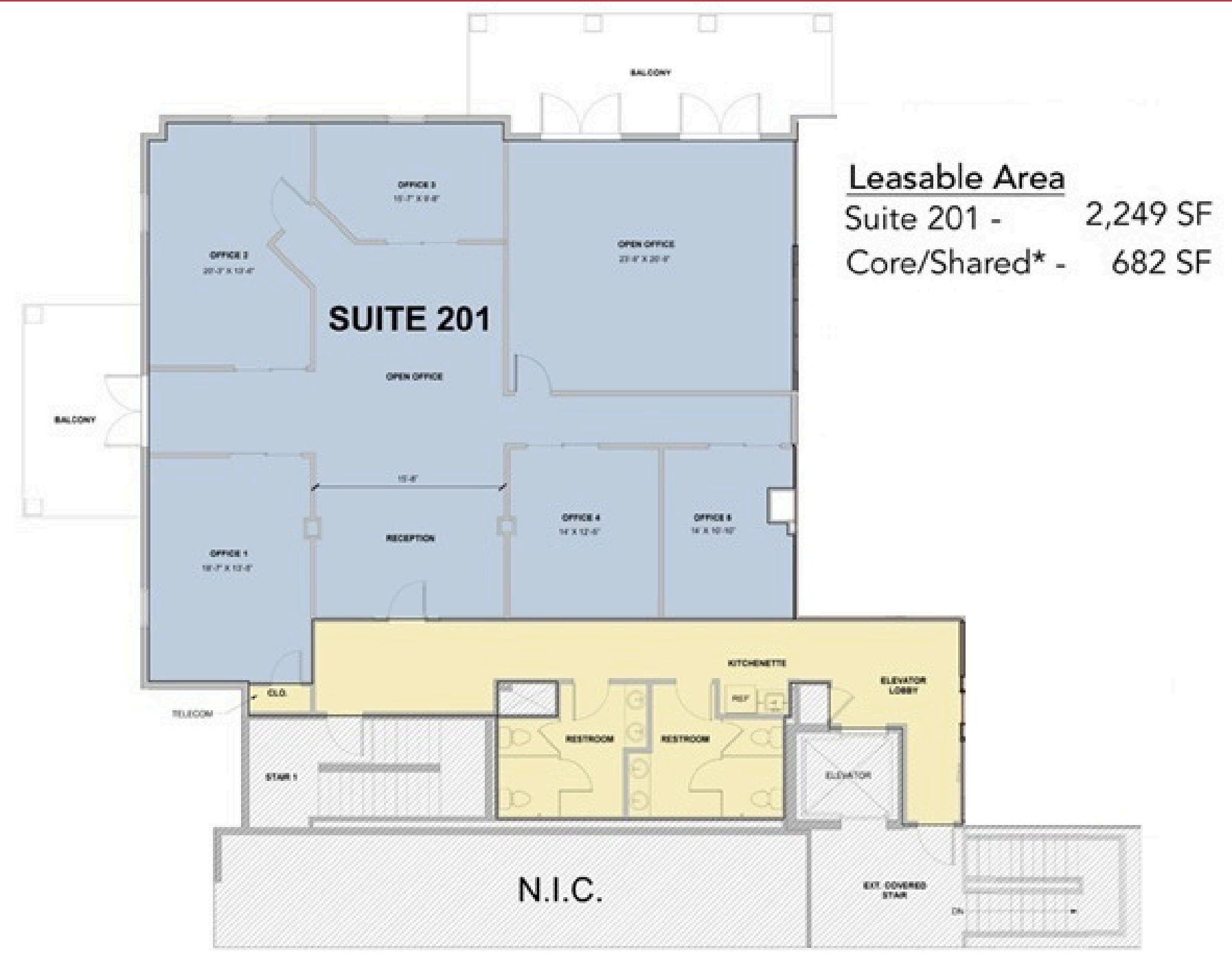

# Location

4345 New Town Ave, Suite 201, Williamsburg, VA

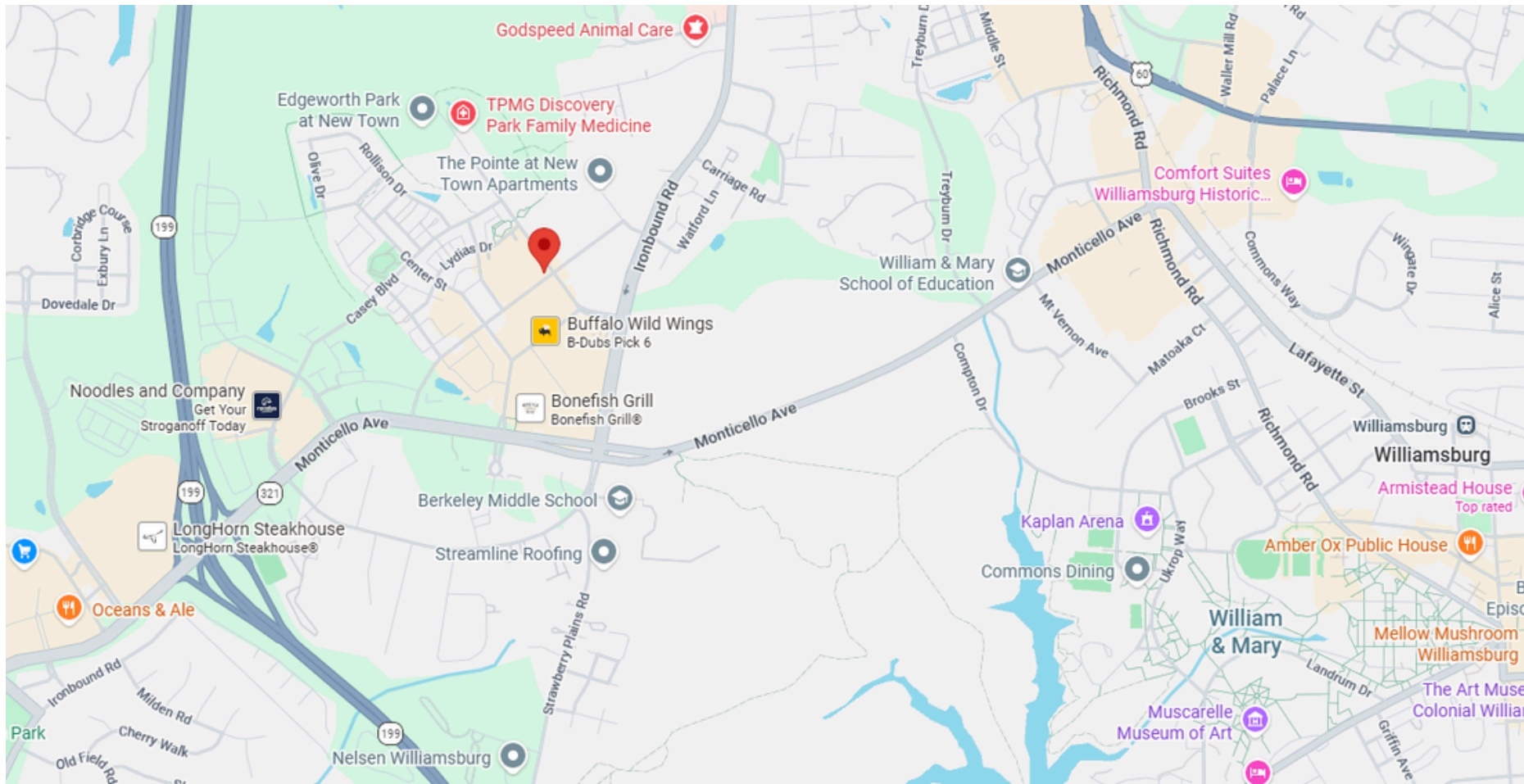

For More Information Contact:

**Vince A. Campana, III**

**Vince@cwcrew.net**

**757.209.2990**

**Disclaimer:**  
No warranty or representation, expressed or implied, is made to the accuracy or completeness of the information contained herein, and same is submitted subject to errors, omissions, change of price, rental or other conditions, withdrawal without notice, and to any special listing conditions imposed by the property owner(s). As applicable, we may make no representation as to the condition of the property in question.