



OLIV TUCSON | SHOP SPACE AVAILABLE



**TYNDALL AVE &
2ND ST**

TUCSON, AZ



property summary

AVAILABLE	±1,177 SF
PRICING	Call for Rates

TRAFFIC COUNTS

TYNDALL AVE

N N/A VPD (NB & SB)
S ±1,637 VPD (NB & SB)

SPEEDWAY BLVD

E ±39,531 VPD (EB & WB)
W ±29,665 VPD (EB & WB)

INRIX 2023, ADOT 2023

LOCATION HIGHLIGHTS

- 53,187 students attended The University of Arizona in the fall of 2023.
- Premier student living in luxury high-rises.
- 243 apartment units and 550 beds.
- Located on Speedway Blvd.
- Located next to The University of Arizona.
- Numerous student events and activities in close proximity.

NEIGHBORING TENANTS



SEC

SPACE AVAILABLE

TYNDALL AVE & 2ND ST | TUCSON, AZ



site plan

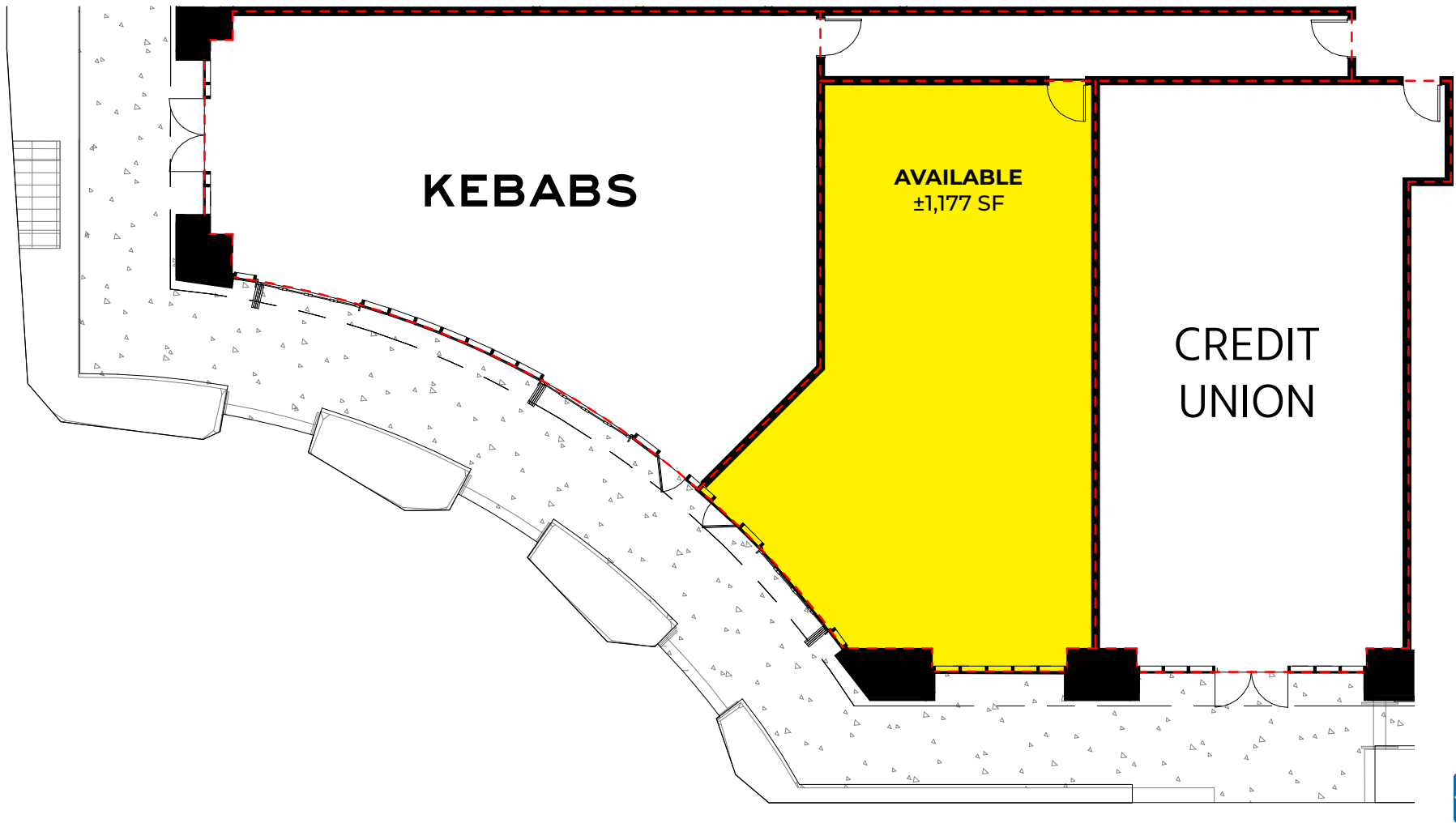

SEC

SPACE AVAILABLE

TYNDALL AVE & 2ND ST | TUCSON, AZ



zoom aerial

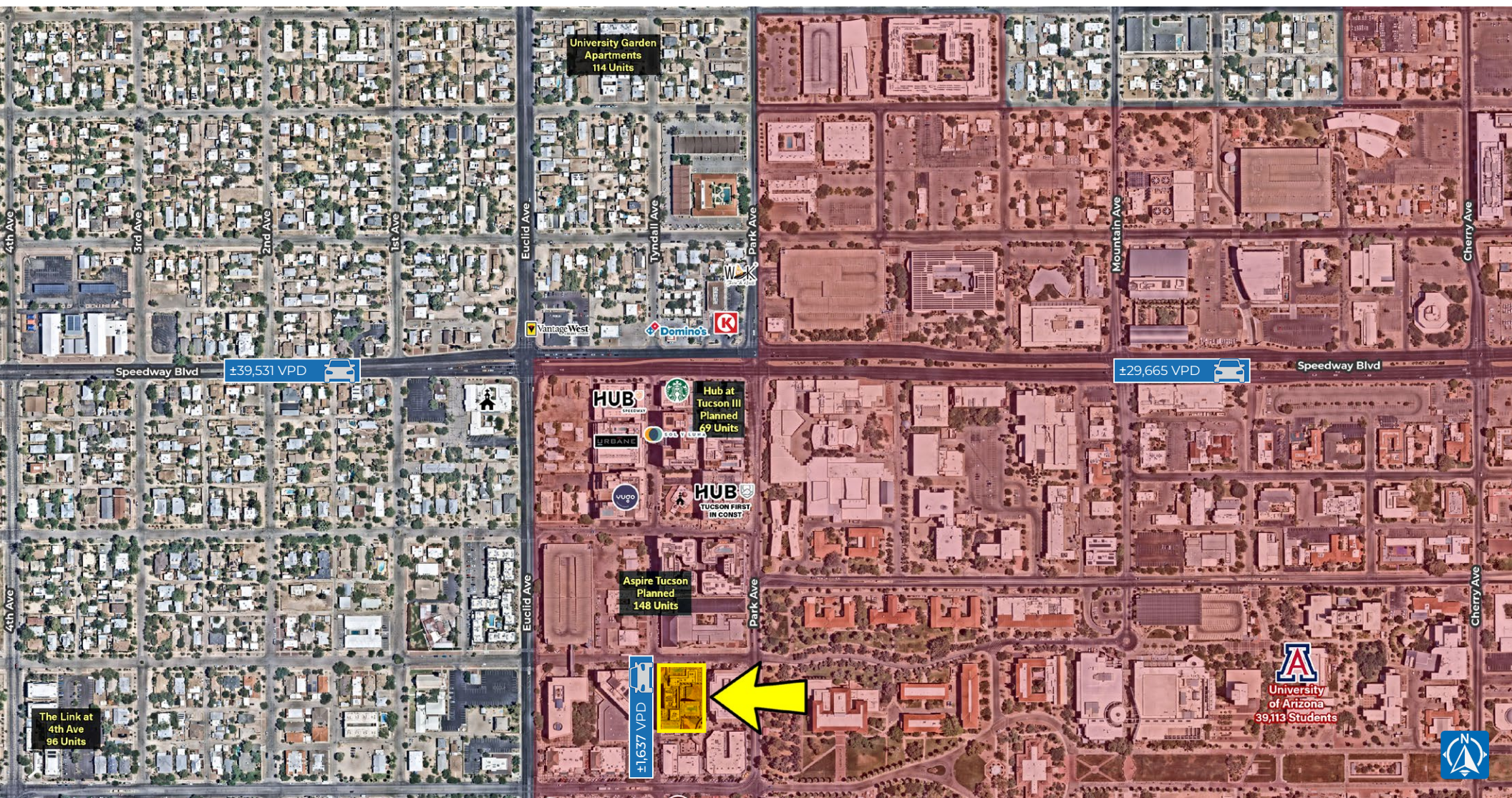

SEC

SPACE AVAILABLE

TYNDALL AVE & 2ND ST | TUCSON, AZ



wide aerial

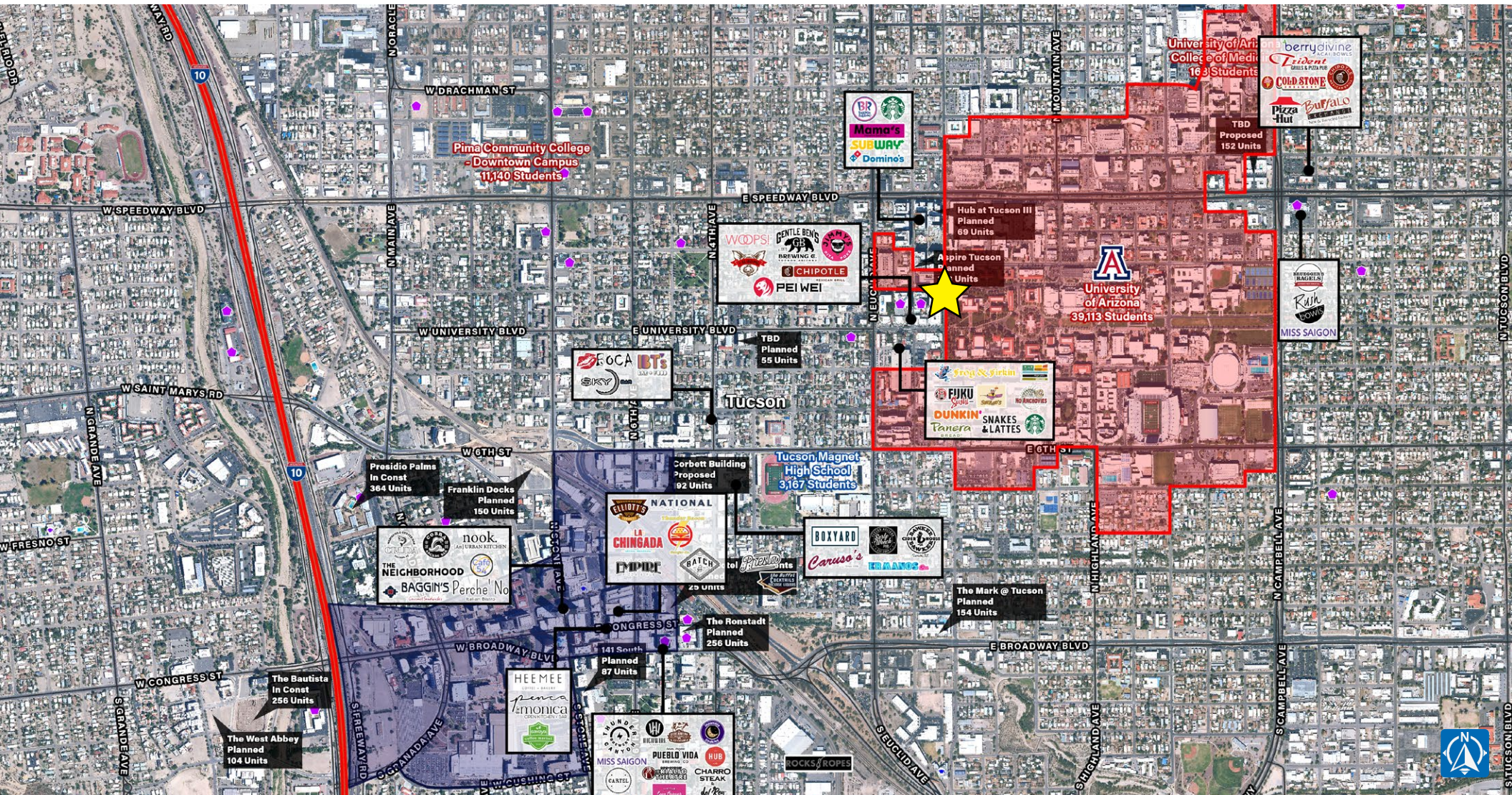

SEC



demographics

2024 ESRI

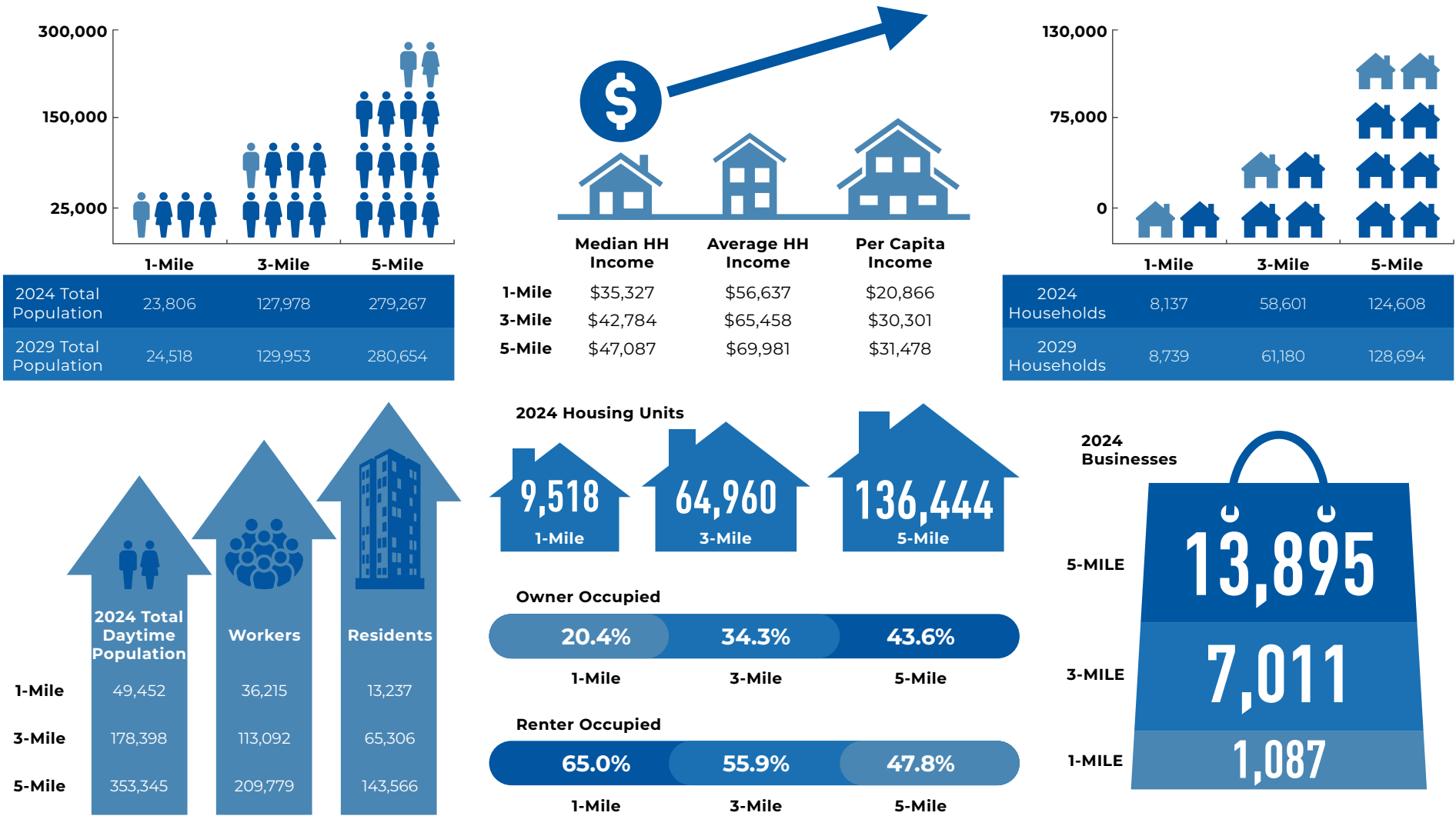

SPACE AVAILABLE

TYNDALL AVE & 2ND ST | TUCSON, AZ





EXCLUSIVELY LISTED BY:

DILLON YOUNG

(602) 288-3474

dyoung@pcaemail.com

ZACH PACE

(602) 734-7212

zpace@pcaemail.com



The information contained herein has been obtained from sources believed reliable. While we do not doubt its accuracy, we have not verified it and make no guarantee, warranty or representation about it. It is your responsibility to independently confirm its accuracy and completeness. Any projections, opinions, assumptions or estimates used are for example only, and do not represent the current or future performance of the property. The value of this transaction to you depends on tax and other factors which should be evaluated by your tax, financial and legal advisors. You and your advisors should conduct a careful, independent investigation of the property to determine to your satisfaction the suitability of the property for your needs. May 16, 2025 11:25 AM

3131 East Camelback Road, Suite 340 | Phoenix, Arizona 85016
P. (602) 957-9800 F. (602) 957-0889
phoenixcommercialadvisors.com