

OFFICE SUITE FOR LEASE

3214 W. Eisenhower Blvd., Ste. A, Loveland, CO



PROPERTY DETAILS

AVAILABLE SPACE:
Suite A: 1,912 RSF

Ideal Uses:

- Design
- Engineering
- Marketing
- Insurance
- Legal
- Financial
- Medical/Chiropractic

WEST EISENHOWER OFFICES

LEASE RATE: \$18.00/RSF NNN (\$6.00/SF)

- Rare West Loveland location office space with beautiful views of Long's Peak and Big Thompson River valley
- Direct access from US Highway 34
- Quality modern finishes with mature landscaping and abundant off-street parking
- Ideal for any medical or professional office use
- First generation space - ready to be finished out with your specific needs - Tenant finish allowance available
- Panoramic views of the front range and surrounding area from back patio
- Digital monument signage visible to US Highway 34 traffic

Rico Devlin

Senior Partner | Senior Broker
970.413.1182
rico@lcrealestategroup.com

Nathan Klein

Senior Partner | Comm. Brokerage Mngr.
970.222.2473
nathan@lcrealestategroup.com



DEMOGRAPHICS (Source: STDB Online 2024, radius)

	1 Mile	3 Mile	5 Mile
2024 Population	5,743	50,739	85,383
Avg. HH Income	\$98,875	\$104,149	\$107,285
Households	2,450	21,761	36,341
Businesses	185	2,081	3,444
Employees	1,792	19,079	32,193



TRAFFIC COUNTS (Source: STDBOnline)

W. Eisenhower Blvd. @ Property 15,000 VPD

OFFICE SUITES FOR LEASE

3214 W. Eisenhower Blvd., Loveland, CO

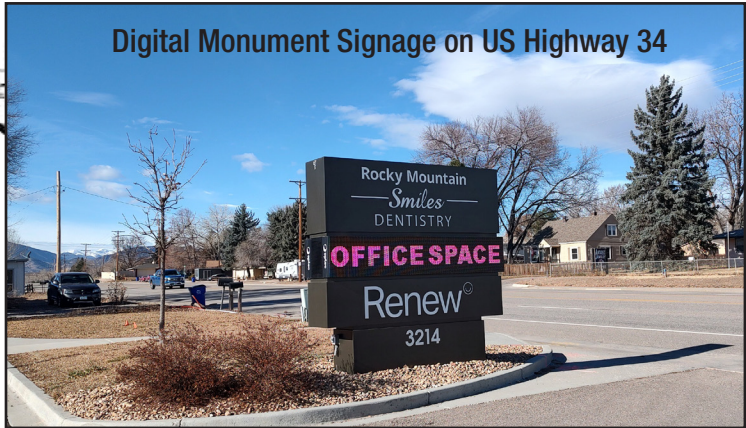

The information above has been obtained from sources believed reliable but is not guaranteed. It is your responsibility to independently confirm its accuracy and completeness. 12/19/2024

OFFICE SUITE FOR LEASE

3214 W. Eisenhower Blvd., Loveland, CO

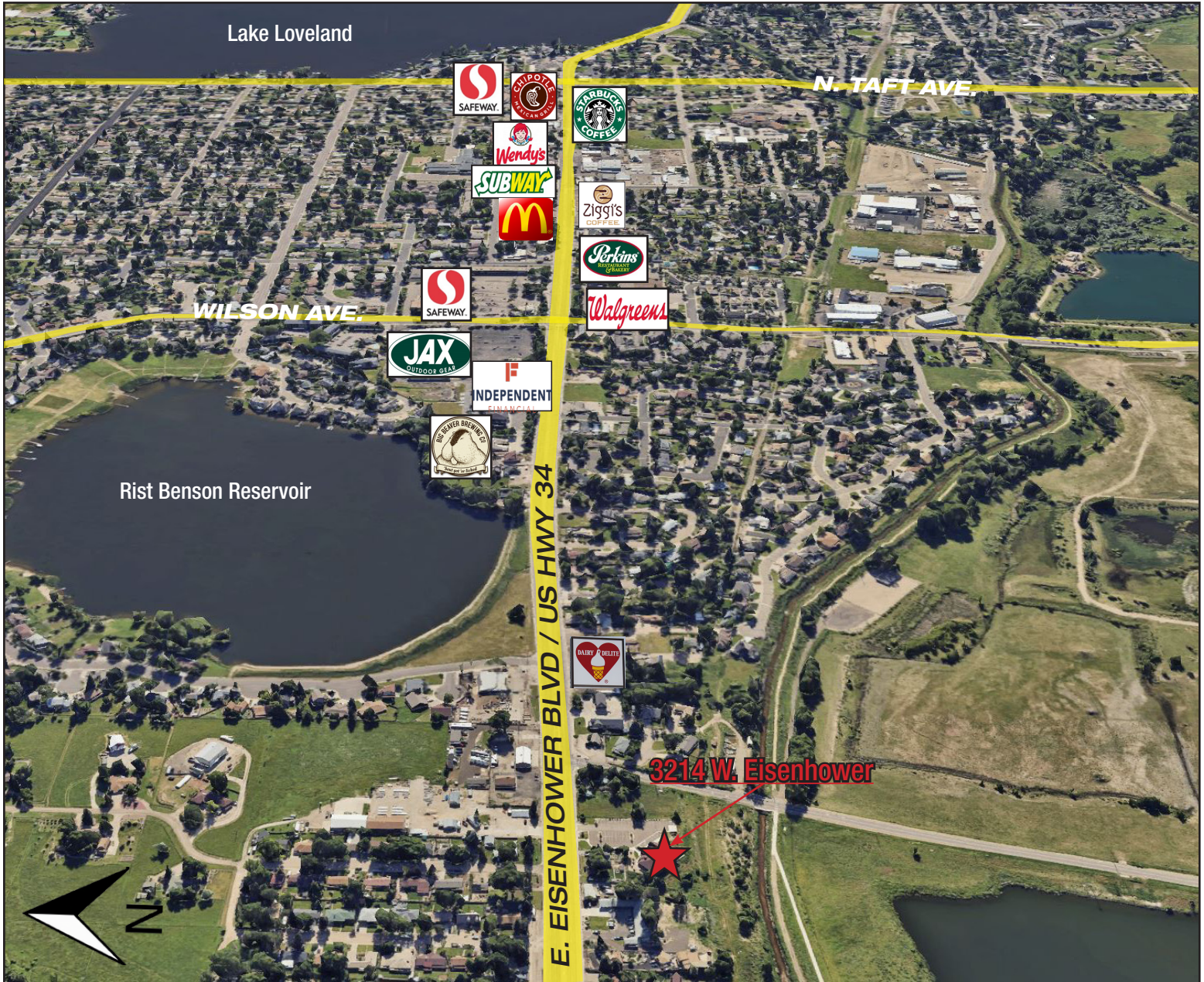

The information above has been obtained from sources believed reliable but is not guaranteed. It is your responsibility to independently confirm its accuracy and completeness. 12/19/2024